

# VOLKSWAGEN

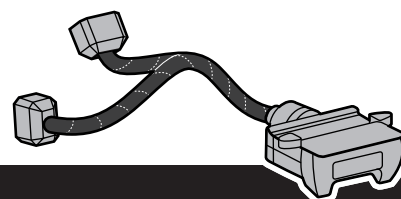

## Amarok 2017-

Part # VW-202-B5M

Only vehicles with trailer preparation

### Fitting Instructions Milford ECS Tow Bar Wiring Harness Kit to AS4177.5

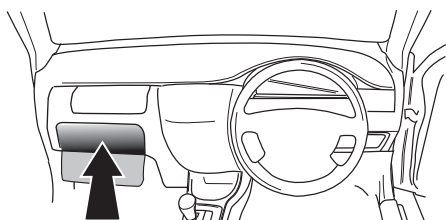

### NOTICE TO INSTALLERS & DISTRIBUTORS

You must ensure that the "User Guide" and "Warranty Information" documents are left in the vehicle's glovebox for the vehicle owner's use after installation.

A high degree of technical competence may be necessary to correctly install this product. We recommend that this tow bar wiring harness kit be installed by an authorised outlet to ensure that the installation complies with the requirements of AS 4177.5 Standard.

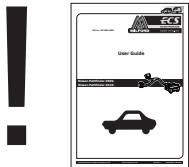

This installation kit contains sufficient components for fitment. Please check the contents carefully against the parts list enclosed before commencing the installation. Do not substitute any components.

Vehicle and/or product modification, misuse or abnormal operation can compromise the performance and operation of this product and/or vehicle and is therefore not endorsed.

These instructions must be read and clearly understood before commencing installation.

The contents of these kits and fitting instructions are subject to alteration without notice.

Do not overload circuits, the maximum loads per connection are detailed in these instructions along with the colour coding diagram. Test all circuit functions with a test box with a correct power load for each unit. A test box on which only LED's are used cannot be used in this case.

The Milford ECS Light Mate is an invaluable tool to use in testing tow bar wiring harness installations along with trouble shooting vehicle and trailer wiring systems.

**LIGHT MATE**



E & O.E. - Errors & Omissions Excepted

### Freecall Tech Line

Australia: 1800 683 577

New Zealand: 0800 134 132

[info@towbar-wiring.com](mailto:info@towbar-wiring.com)



# Parts List

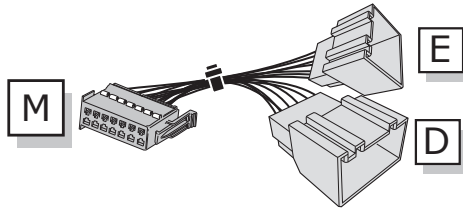
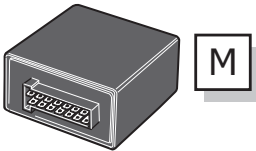
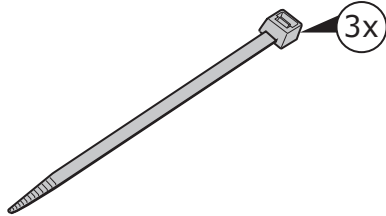
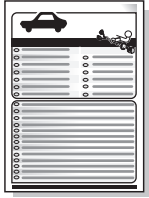
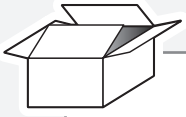

C

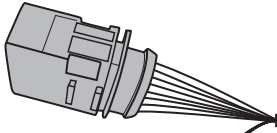

**Blue:**  
Service break  
**Blackwhite:**  
Trailer connection signal  
(earth normally closed)



X

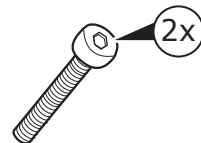

**ROUTING**

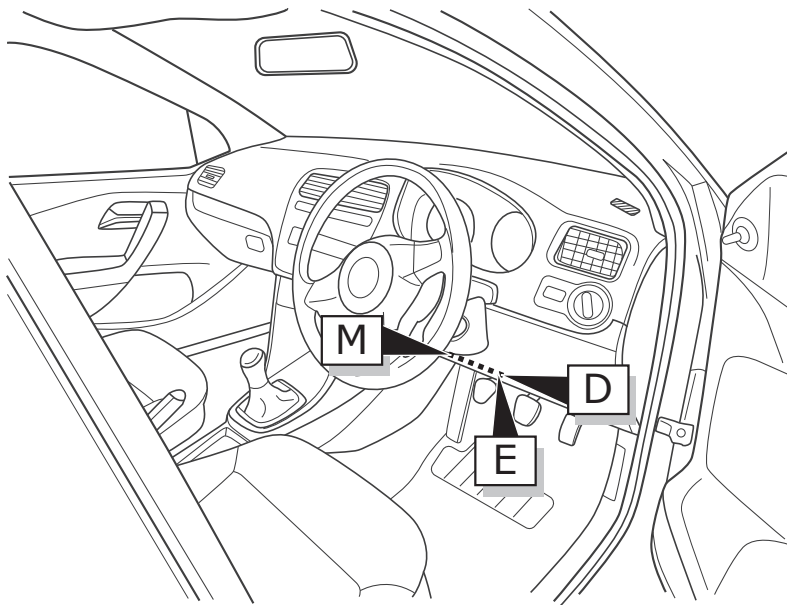
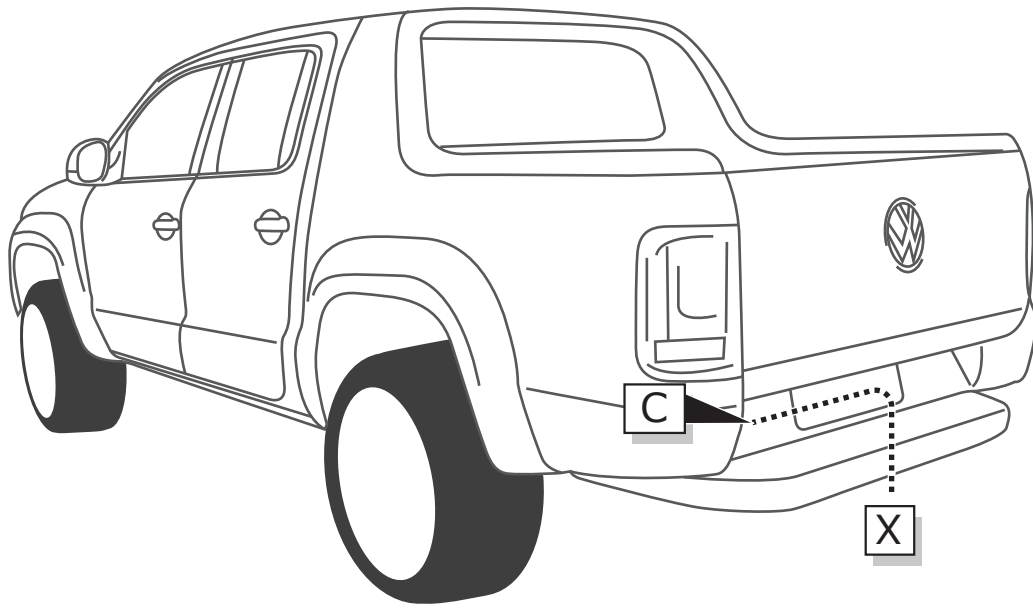

**1**

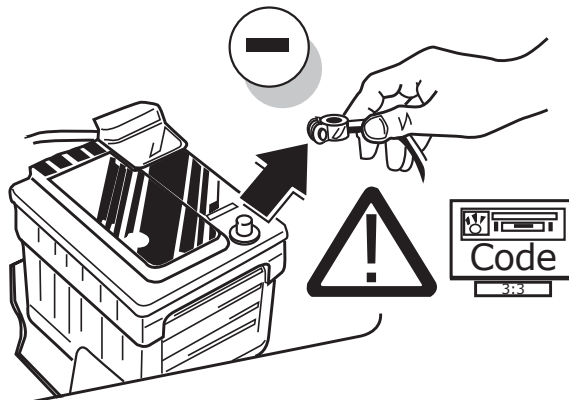

2

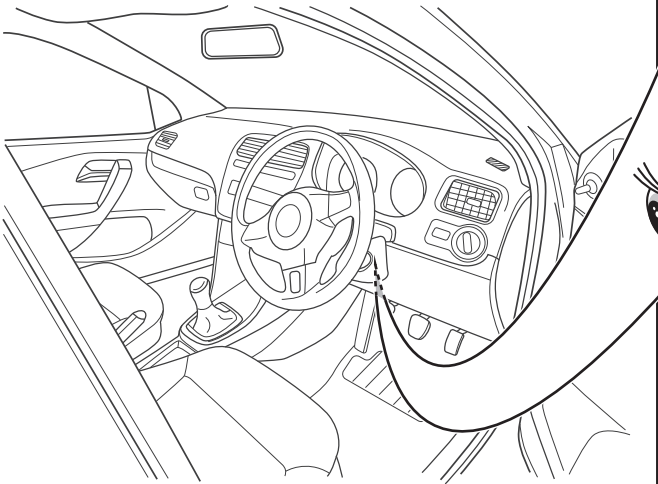
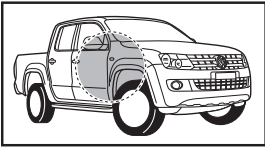

1

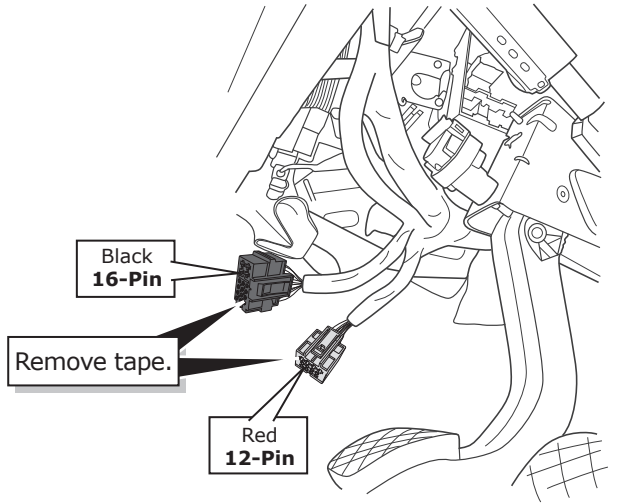

2

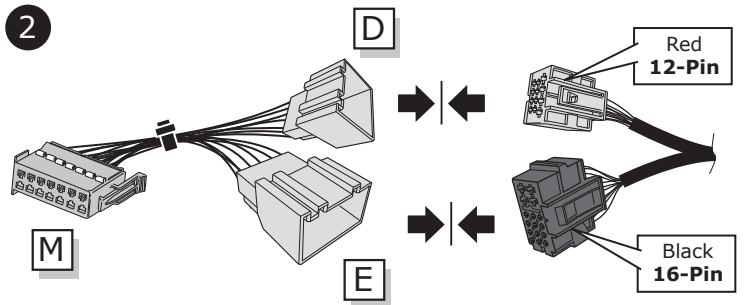

3

1

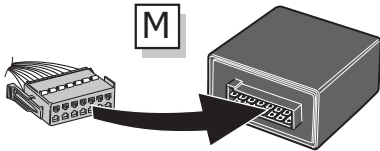

2

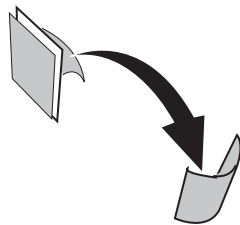
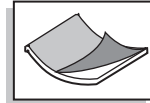

3

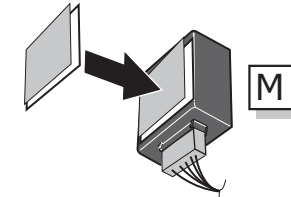

4

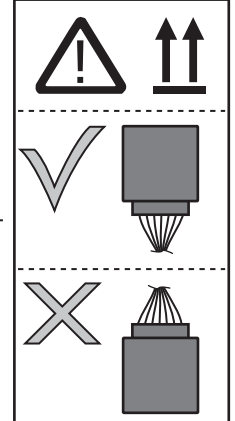
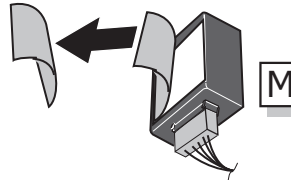

4

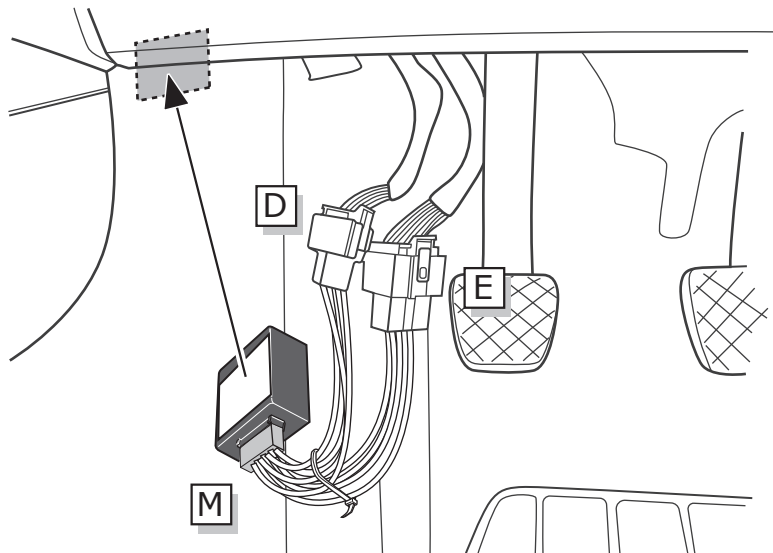
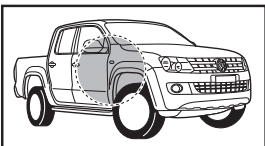

5

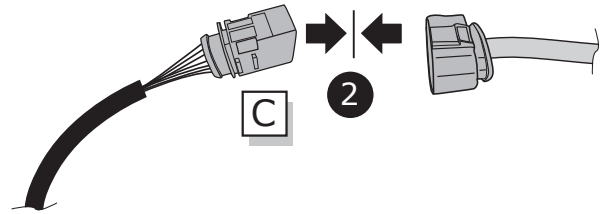
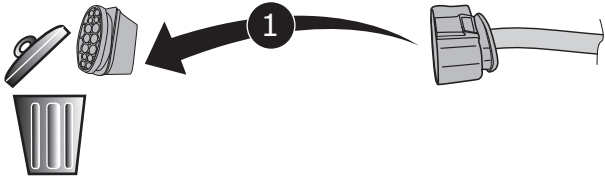
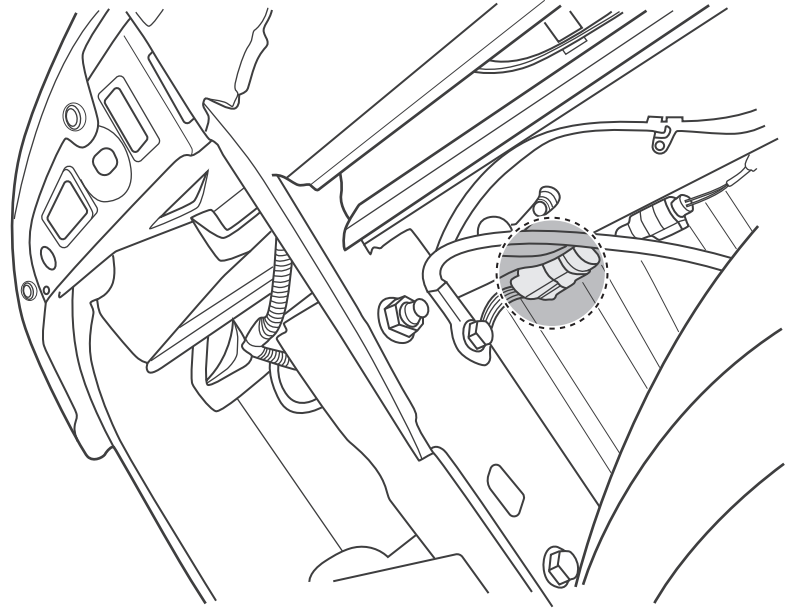
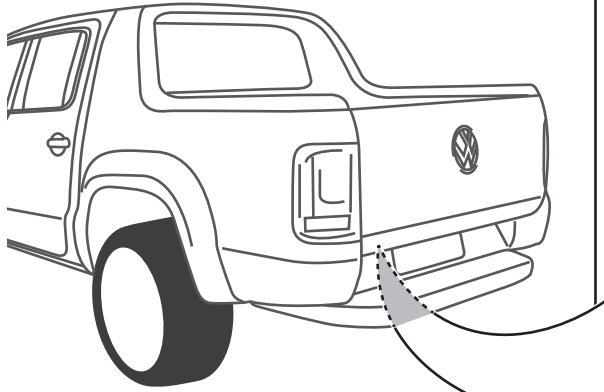

6

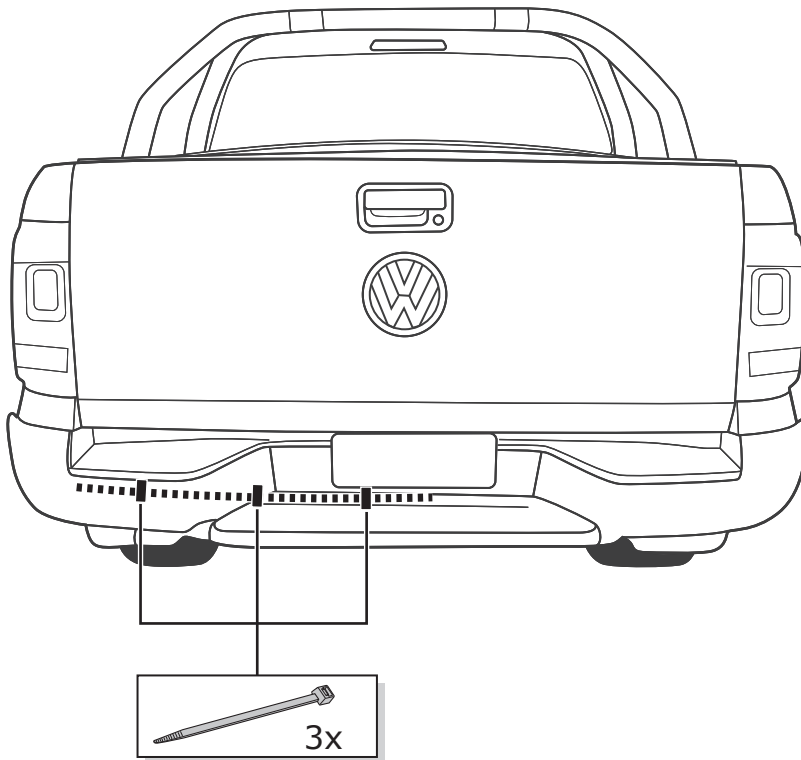

7

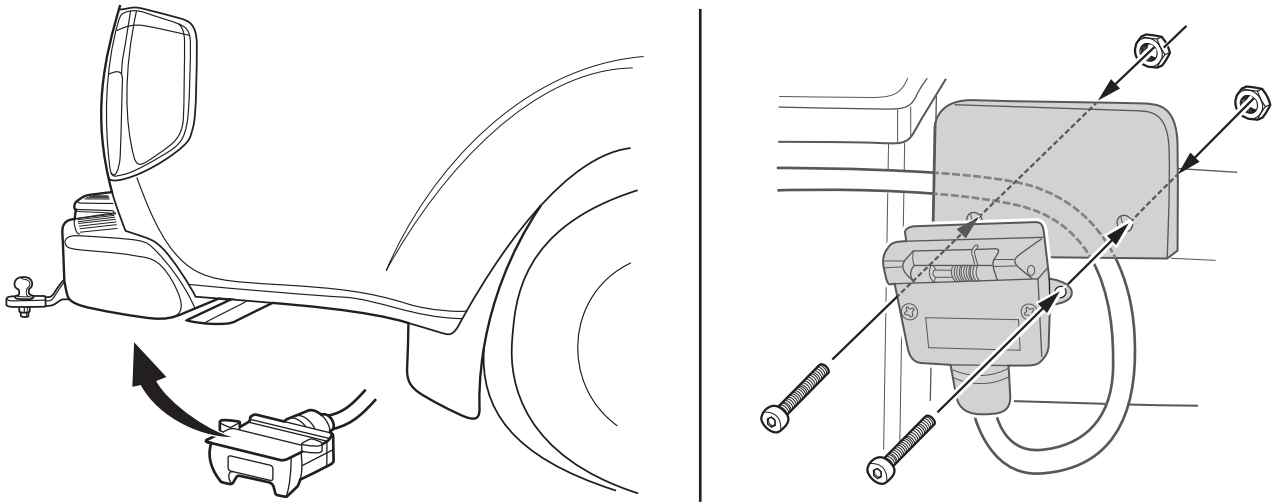

8

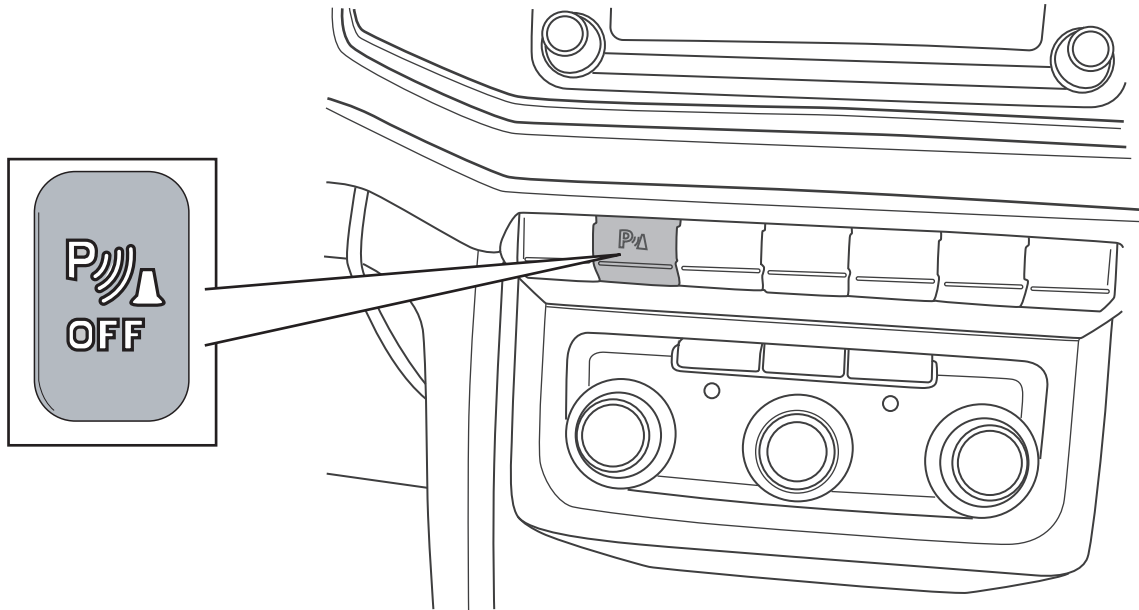

### TESTING

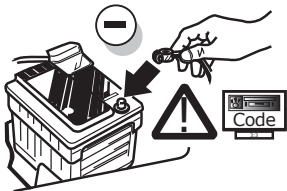

Test all circuit functions with a testbox with the correct power load for each unit. A testbox on which only LEDs are used can not be used in this case.

The **Milford ECS Lightmate** is an invaluable tool to use in testing tow bar wiring harness installations

## INFO TRAILER SOCKET CONNECTIONS

### 12 pin Flat

#### 7 pin Flat / 7 pin Round

Pin # DIN 72552 Signal	1 L	2	3 31	4 R	5	6 54	7 58	8 +30	9 +15	10	11	12 +15
	Left-hand turn	Reversing signal	Earth return	Right-hand turn	Service brakes	Stop Lamps	Tail/Rear Lamps	Battery Supply	Auxiliaries	Earth Return	Rear Fog Lamp	Auxiliaries
Max Power	21W	2x21W	N/A	21W	25W	3x21W	52W	12V/15A	12V/15A	N/A	2X21W	12V/15A
Color	Yellow	Black	White	Green	Blue	Red	Brown	Orange	Pink	White	Grey	Violet

## INFO C2

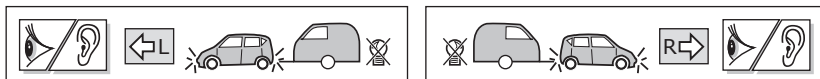

When applicable, the indicator lights on the trailer are monitored. If one of the indicators of the trailer breaks down, a buzzer will be audible and/or a visual signal will be visible on the dashboard. Check the flashing lights on the trailer.



## INFO PDC

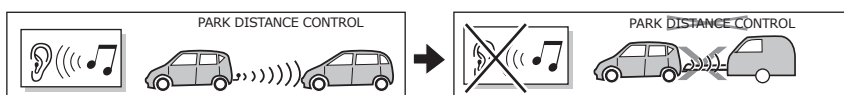

The wiring kit has a possibility to switch off any Park Distance Control in the case of a coupled trailer.



## INFO

*Contents of these kits and their fitting manuals are subject to alteration without notice, please ensure that these instructions are read and fully understood before commencing installation.*



# SPARE PARTS

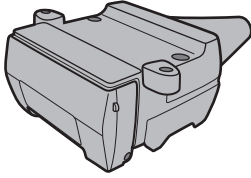

12 Pin Flat Connector  
MF-022-ZZM

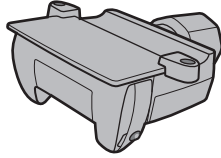

7 Pin Flat Connector  
MF-021-ZZM

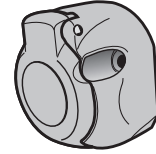

7 Pin Round Connector  
MF-023-ZZM

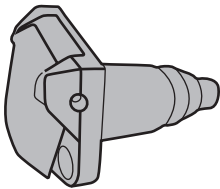

7 Pin Round Small Connector  
MF-036-ZZM

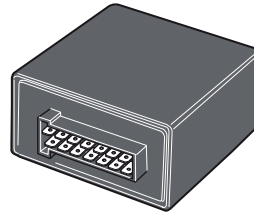

Sparepart 5F010V0306SW1109

## SPARE PARTS

[www.towbar-wiring.com](http://www.towbar-wiring.com)

**LIGHT MATE**



### Freecall Tech Line

Australia: 1800 683 577  
New Zealand: 0800 134 132  
[info@towbar-wiring.com](mailto:info@towbar-wiring.com)

