



PARTS, SERVICE & ACCESSORIES

# HILUX

July 2015 Production Onwards

## ACRYLIC BONNET PROTECTOR

### Installation Instructions

Accessory Part No. PZQ15-89300 (Clear) / PZQ15-89310 (Tinted)

Installation Time: Approx. 15 mins

Place these instructions in vehicle's glove box after installation is complete

#### Care Instructions:



Do not slam bonnet.



Clean Bonnet Protector with a mild detergent and water solution.



Do not use automatic car wash.



Do not use abrasive, spirit or solvent based cleaners.

Item	Component Name	Qty	Part number
1	Bonnet Protector (Clear)	1	PZQ15-89300
	Bonnet Protector (Tinted)	1	PZQ15-89310
2	Fixed Metal Clip	2	PZQ15-8930A
	Inner Push-on Metal Clip "B"	2	
	Outer Push-on Metal Clip "A"	2	
	Self Tapping Screw	2	
	Small Screw	6	
	Fibre Washer	6	
	Screw Plug	2	
	Anti-Abrasive Tape	6	
	Alcohol Wipe	1	
	Notice Label	1	
	Installation Instruction	1	

Item	Qty		Item	Qty	
<b>A</b>	2	Fixed Metal Clip	<b>G</b>	6	Anti-Abrasive Tape
<b>B</b>	2	Outer Push-on Metal Clip "A"	<b>H</b>	6	Fibre Washer
<b>C</b>	2	Inner Push-on Metal Clip "B"	<b>I</b>	1	Alcohol Wipe
<b>D</b>	2	Screw Plug	<b>J</b>	1	Notice Label
<b>E</b>	6	Small Screw	<b>K</b>	1	Installation Instruction
<b>F</b>	2	Self Tapping Screw			



FITTING KIT  
PZQ15-8930A

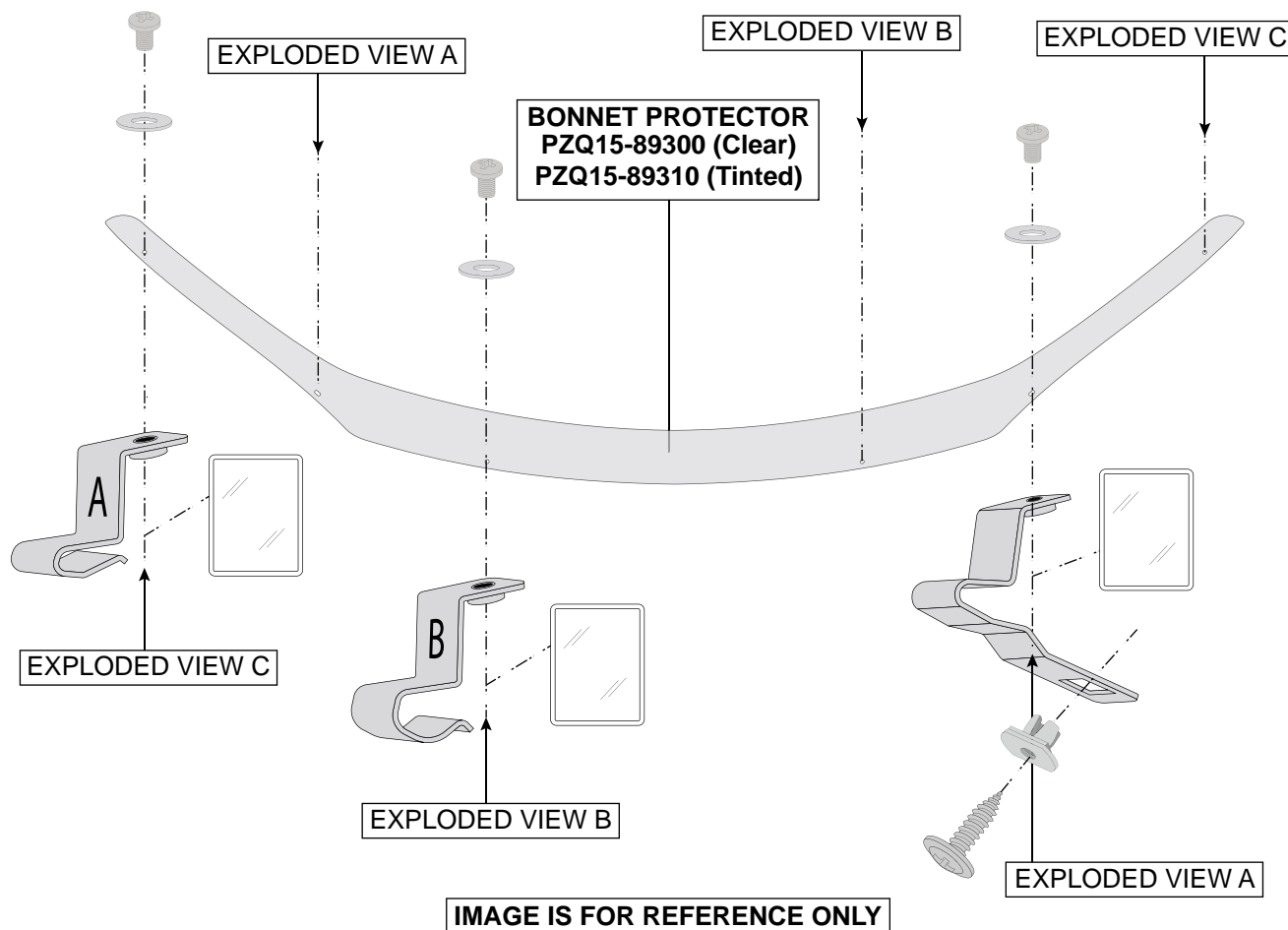

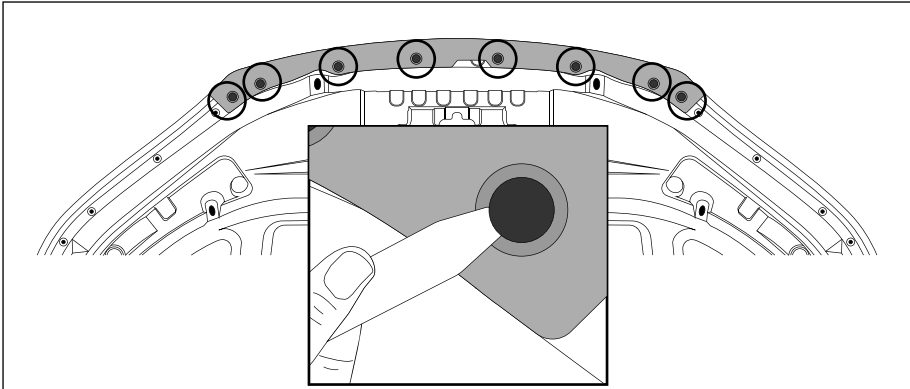

Diagram #: 1

1. Remove the eight push plugs and plastic guard.

Do not discard push plugs.

**See Dia #1**

**Note: Use pry bar or flat head screwdriver.**

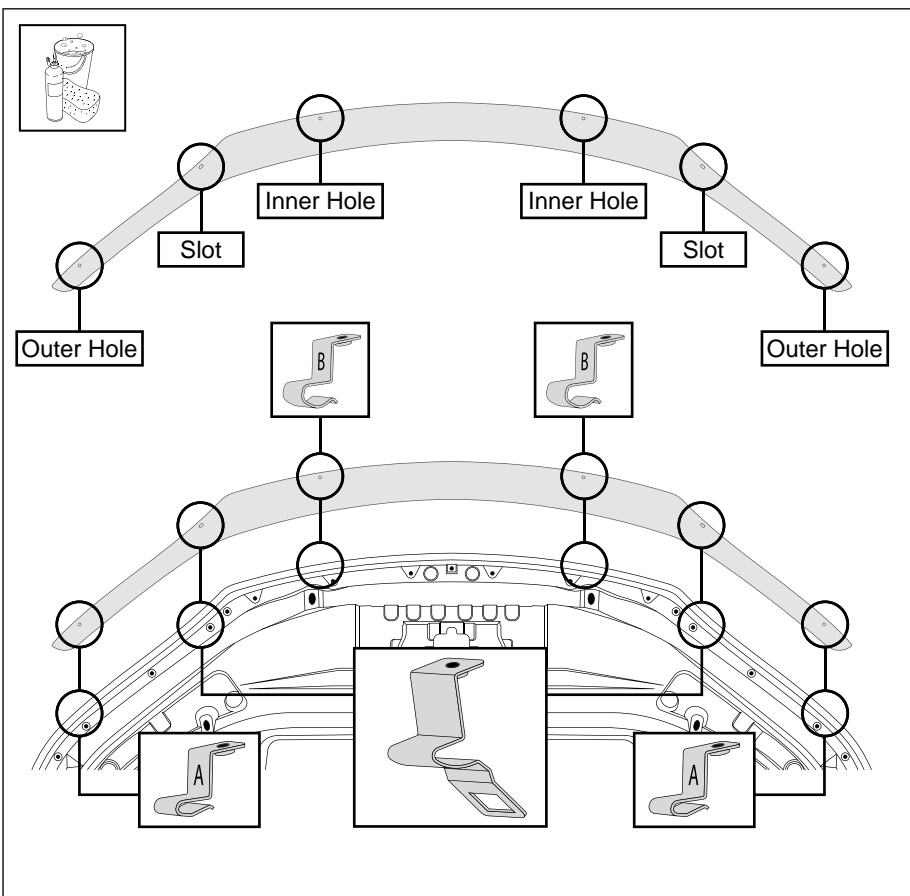

Diagram #: 2

2. Read installation instructions thoroughly before commencing installation. Open & thoroughly clean and dry the bonnet.

Trial fit the bonnet protector centrally onto bonnet.

Note where two slots in the Bonnet Protector correspond with the bonnet lip and the holes in the underside of the bonnet.

Note where the inner and outer hole positions correspond with the Bonnet Protector.

Remove Bonnet Protector.

**See Dia #2.**

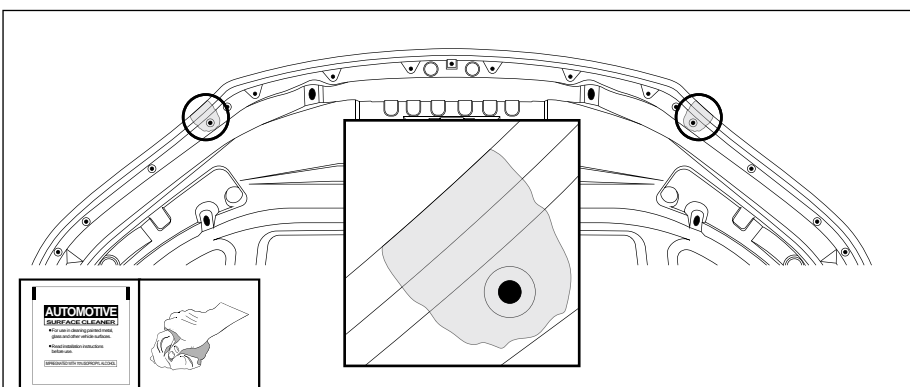

Diagram #: 3

3. Clean the top side and underside of the bonnet at the previously noted areas with the alcohol wipe provided. Wipe off any residue with a dry clean cloth

**See Dia #3.**

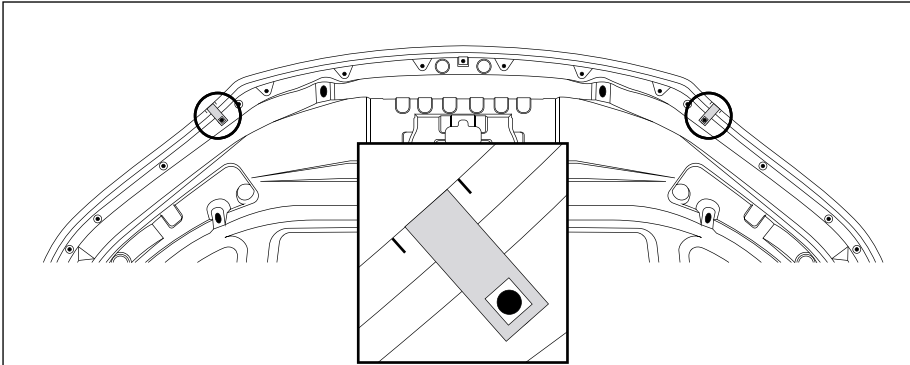

Diagram #: 4

4. Trial fit the fixed metal clips aligning the rectangular holes in the clips with the previously noted holes in the bonnet.

Mark 5mm either side of the fixed metal clips.

Remove the fixed metal clips.

**See Dia #4**

**Note: Use non-permanent marker.**

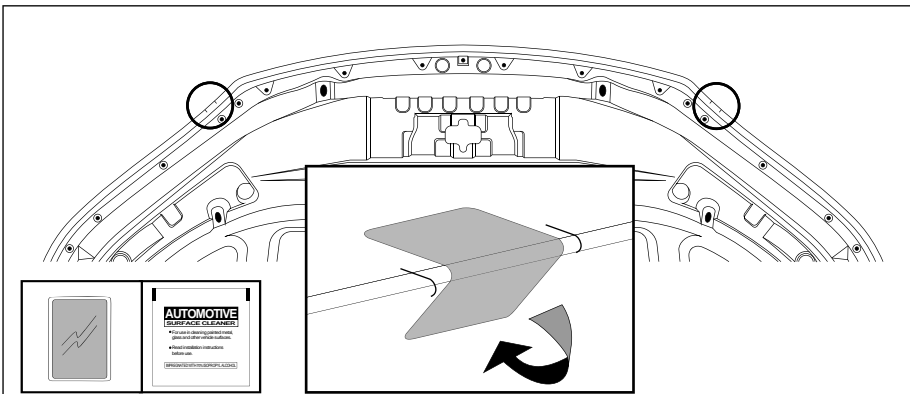

Diagram #: 5

5. Adhere the anti-abrasive tape strips centered in between the fixed metal clip marks. Apply tape so approximately half of the tape is on the topside and half is on the underside of the bonnet.

Clean off the pen marks with the alcohol wipe provided.

**See Dia #5.**

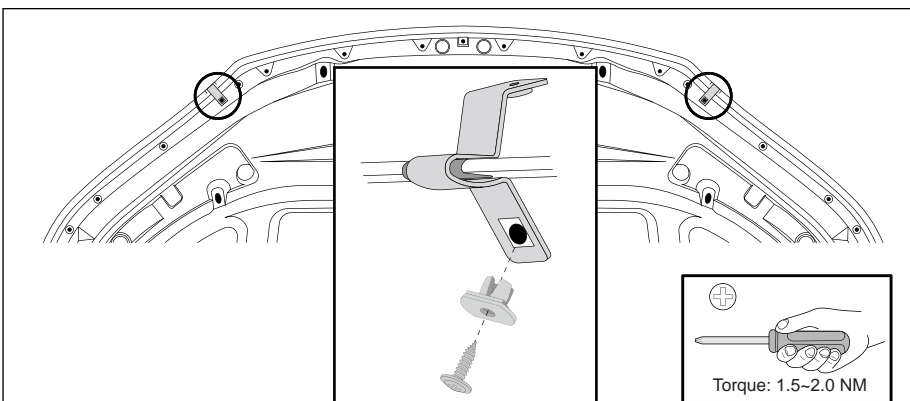

Diagram #: 6

6. Position the fixed metal clips onto the bonnet and secure the clips by pressing the screw plug through the metal clip into the bonnet. Next insert self tapping screws into the screw plugs, as shown.

**See Dia #6**

**Note: Ensure torque setting 1.5~2.0NM is used.**

**IMPORTANT: Ensure that the clips are positioned over anti-abrasive tape and does not come into contact with any of the bonnet's paint work. Failure to do so may result in permanent paint damage.**

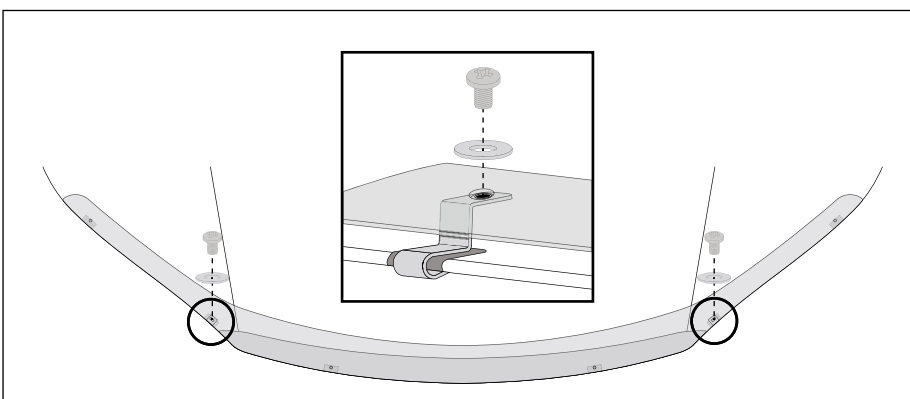
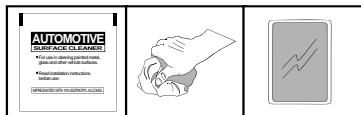

Diagram #: 7

7. Fit the bonnet protector centrally to bonnet and loosely secure to the top of fixed metal clips with the small screws and fibre washers provided.

**See Dia #7.**



8. At the inner and outer hole locations, clean bonnet with the alcohol wipe provided and wipe off any residue with a dry clean cloth.

Adhere the anti-abrasive tape strips directly below the holes in the Bonnet Protector. Apply tape so approximately half of the tape is on the topside and half is on the underside of the bonnet.

**See Dia #8.**

Diagram #: 8

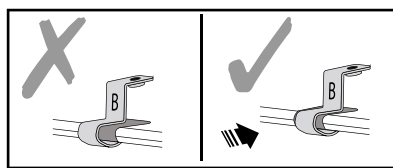

9. Slide the inner push-on metal clips "B" onto the bonnet locating them over the anti-abrasive tape strips as shown.

**See Dia #9.**

**IMPORTANT:** Ensure that the clips are positioned over anti-abrasive tape and does not come into contact with any of the bonnet's paint work. Failure to do so may result in permanent paint damage.

Diagram #: 9

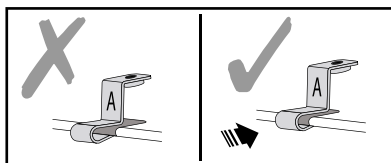

10. Slide the outer push-on metal clips "A" onto the bonnet locating them over the anti-abrasive tape strips as shown.

**See Dia #10.**

**IMPORTANT:** Ensure that the clips are positioned over anti-abrasive tape and does not come into contact with any of the bonnet's paint work. Failure to do so may result in permanent paint damage.

Diagram #: 10

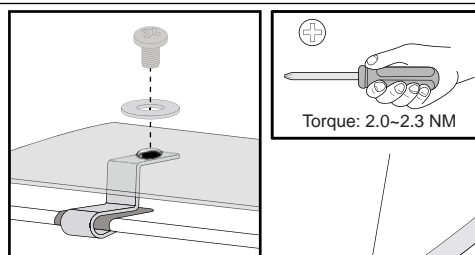

11. Loosely secure the Bonnet Protector to the four push-on metal clips with the small screws and fibre washers.

Check the Bonnet Protector is sitting centrally on the bonnet. Tighten all the screws.

**See Dia #11.**

**Note:** Ensure torque setting 2.0~2.3NM is used.

Diagram #: 11

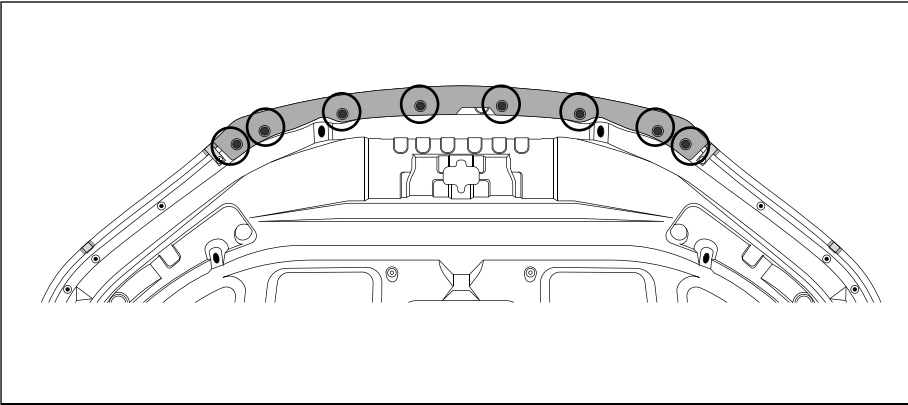

Diagram #: 12

**12.** Re-install the plastic guard and eight push plugs  
**See Dia #12.**

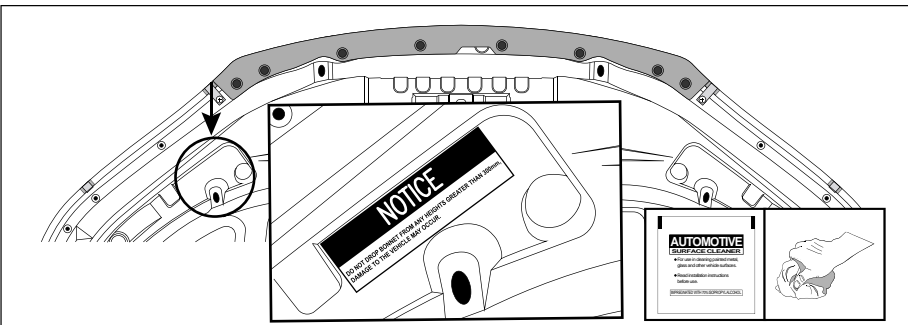

Diagram #: 13

**13.** Open the bonnet. At the indicated location clean the underside of the bonnet with the alcohol wipe provided and wipe off any residue with a dry clean cloth.

Adhere the notice label to the underside of the bonnet.  
**See Dia #13.**

**TO REMOVE:** Reverse the above procedure.

**IMPORTANT:** Conduct final inspection, ensuring all fasteners are tightened, and clips are correctly installed and not touching painted surfaces. Close bonnet and check clearances at all edges for interference and adjust if necessary.