



PARTS, SERVICE & ACCESSORIES

RAV 4

December 2012 Production Onwards

ACRYLIC WEATHERSHIELDS

Installation Instructions

Accessory Part No. PZQ21-42050

Installation Time: Approx. 20 mins

Place these instructions in vehicle's glove box after installation is complete

Care Instructions:



Clean Weathershields with a mild detergent and water solution.



Do not use automatic car wash.



Do not use abrasive, spirit or solvent based cleaners.

Item	Component Name	Qty	Part number
1	Slimline Weathershield Set	1	PZQ21-42050
2	Metal Clips	10	PZQ21-4205A
	Primer Pencil	2	
	Alcohol Wipe	4	
	Installation Instructions	1	

Item	Qty		Item	Qty	
A	10	Metal Clips	C	4	Alcohol Wipe
B	2	Primer Pencil	D	1	Installation Instruction

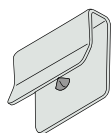

A

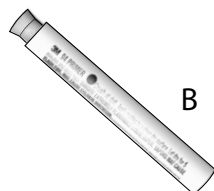

B



C

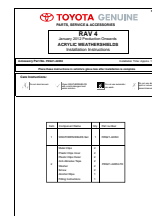

D

FITTING KIT
PZQ21-4205A

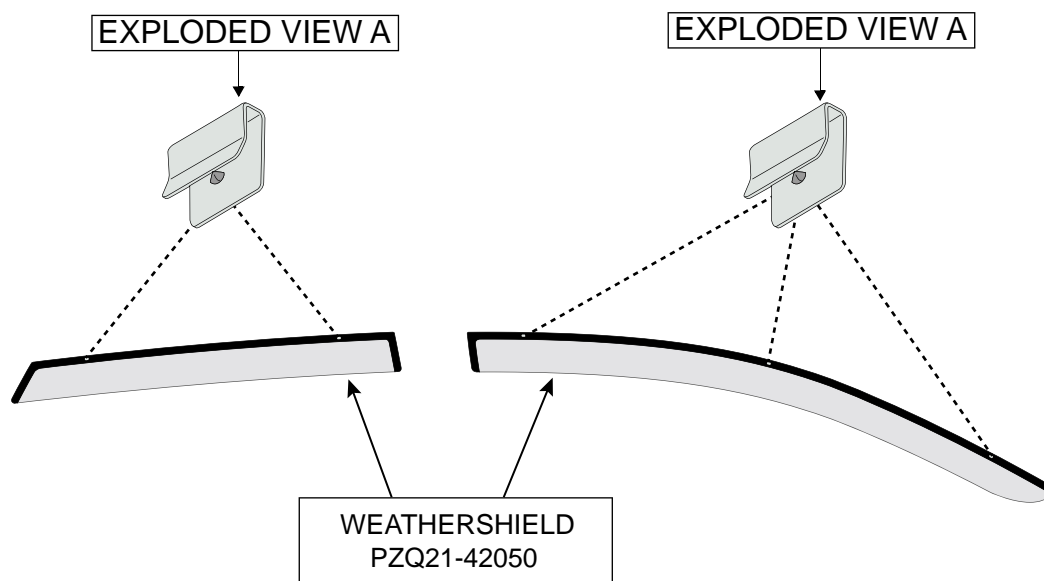

LHS part is mirror image

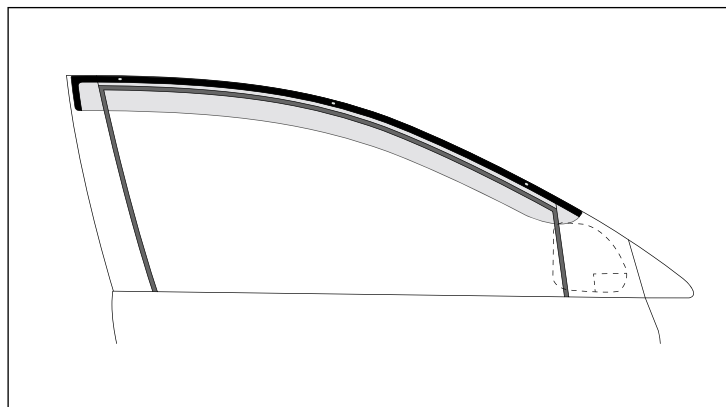

FRONT WEATHERSHIELD.

1. Read through installation instructions before installation. Thoroughly clean and dry door frame prior to fitment. Trial fit Weathershield flush with the top edge of the door. Push Weathershield forward to ensure the foam tape seals against the mirror sail. Note the tape attachment areas on the door frame. Remove Weathershield.

See Dia #1.

Diagram #: 1

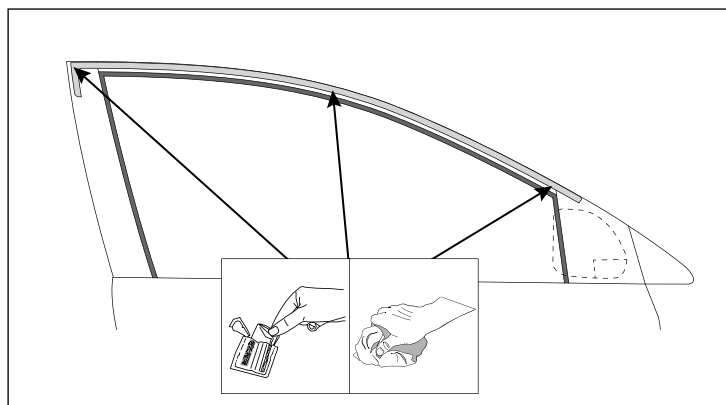

2. Clean previously noted tape attachment areas thoroughly with the alcohol wipe provided. Wipe away any residue with a dry clean cloth.

See Dia #2.

Note: To save time prepare both the front and rear door at the same time.

Diagram #: 2

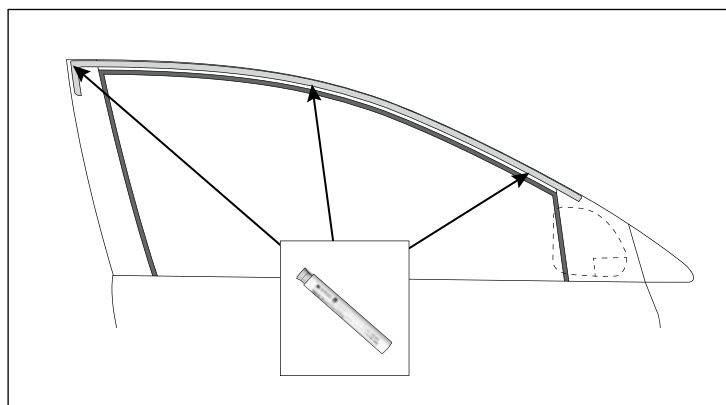

3. Apply primer pencil to attachment area, as shown. Carefully read the instructions on the primer pencil before use.

See Dia #3.

Important notes:

1. Allow 5 minutes drying time of the promoter.
2. Keep out of contact with skin and eyes.
3. Do NOT inhale or swallow.

Note: Without this step, adhesive strength of the weathershield is not guaranteed.

Note: Prepare front and rear doors at the same time to prevent primer pencil from drying out. (One primer pencil per side of vehicle)

Diagram #: 3

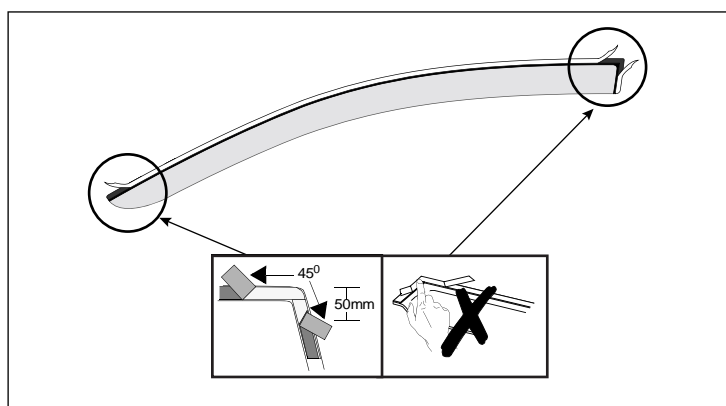

4. Peel approximately 50mm of red tape-liner from both ends of the double-sided tape attached to the Weathershield. Fold the tape liner at 45°, as shown. **See Dia #4.**

IMPORTANT: DO NOT TOUCH EXPOSED TAPE SURFACE AREAS.

Diagram #: 4

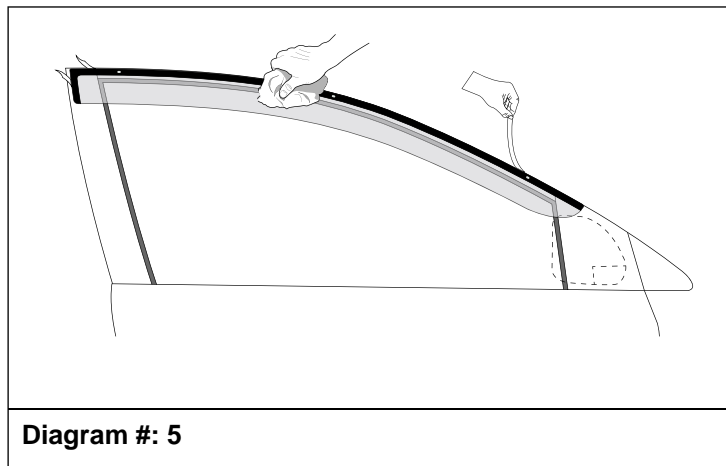

5. Place the Weathershield onto the door, as shown in Dia. #1. Ensure that the Weathershield is correctly positioned by aligning it flush with the top of the door frame and the foam tape seals against the mirror sail. Gently pull the tape liner so that it peels away from the Weathershield completely and then push down all the double-sided tape areas with a soft cloth 3 - 4 times to achieve maximum adhesion.

See Dia #5.

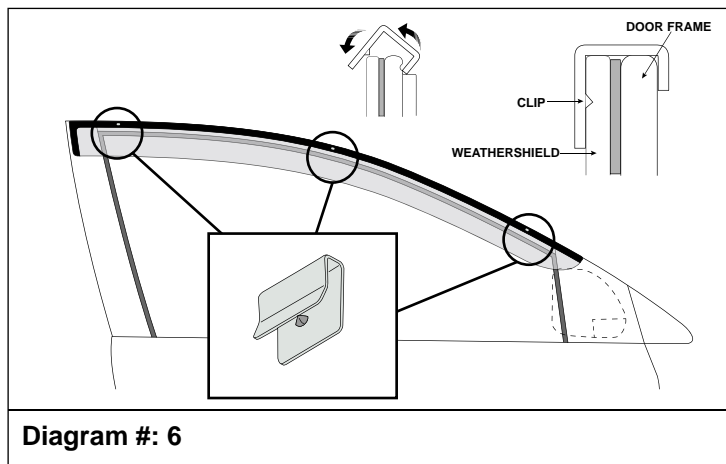

6. Note the three slot positions in the Weathershield. Install three metal clips at the noted positions.

See Dia #6.

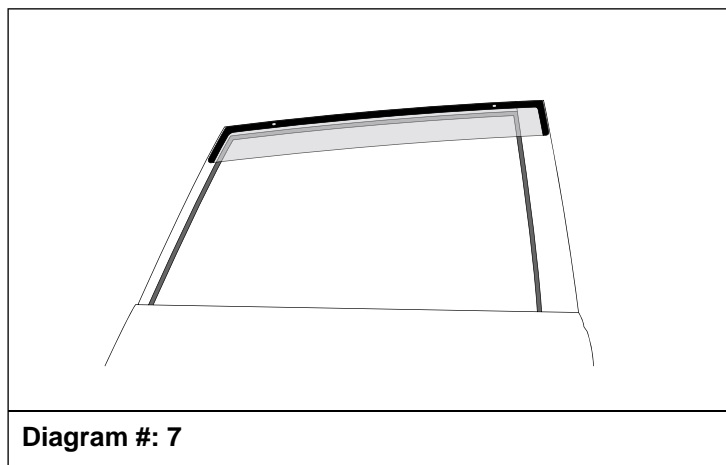

REAR WEATHERSHIELD.

7. Thoroughly clean and dry door frame prior to fitment. Trial fit Weathershield flush with the top edge of the door. Note the tape attachment areas on the door frame. Remove Weathershield.

See Dia #7.

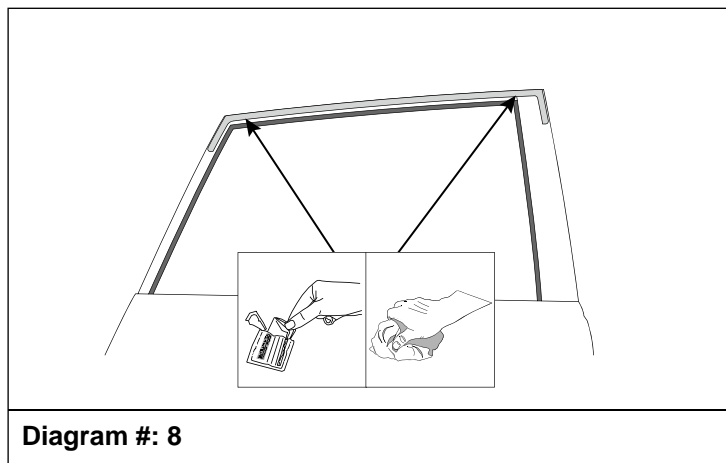

8. Clean previously noted tape attachment areas thoroughly with the alcohol wipe provided. Wipe away any residue with a dry clean cloth.

See Dia #8.

Note: To save time prepare both the front and rear door at the same time.

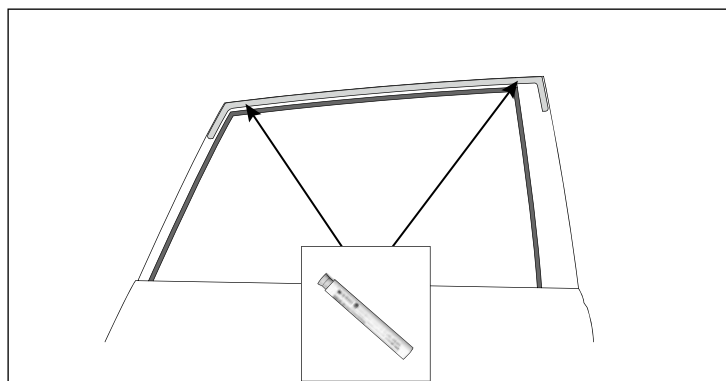

Diagram #: 9

9. Apply primer pencil to attachment area, as shown. Carefully read the instructions on the primer pencil before use.

See Dia #9.

Important notes:

1. Allow 5 minutes drying time of the promoter.
2. Keep out of contact with skin and eyes.
3. Do NOT inhale or swallow.

Note: Without this step, adhesive strength of the weathershield is not guaranteed.

Note: Prepare front and rear doors at the same time to prevent primer pencil from drying out. (One primer pencil per side of vehicle)

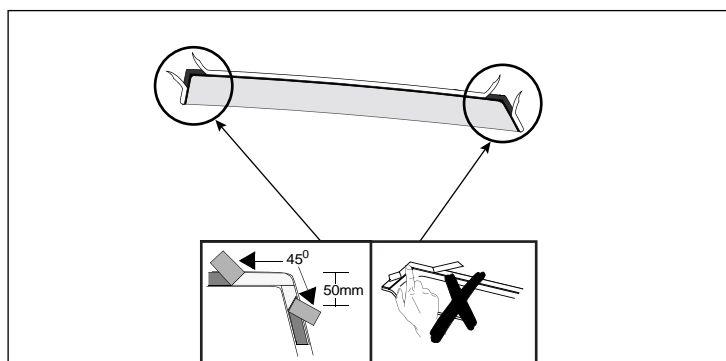

Diagram #: 10

10. Peel approximately 50mm of red tape-liner from both ends of the double-sided tape attached to the Weathershield. Fold the tape liner at 45°, as shown. **See Dia #10.**

IMPORTANT: DO NOT TOUCH EXPOSED TAPE SURFACE AREAS.

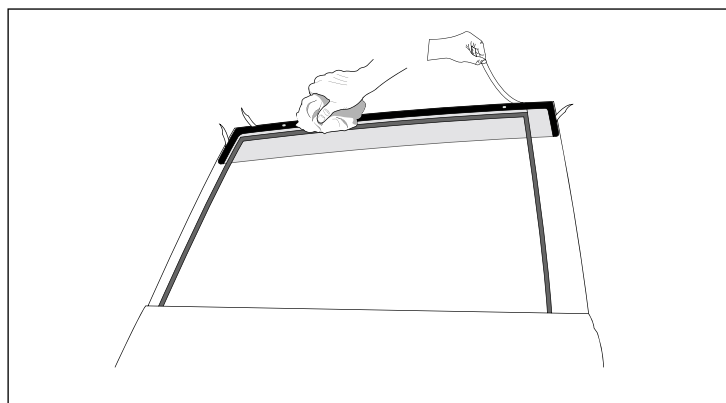

Diagram #: 11

11. Place the Weathershield onto the door, as shown in Dia. #7. Ensure that the Weathershield is correctly positioned by aligning it flush with the top of the door frame. Gently pull the tape liner so that it peels away from the Weathershield completely and then push down all the double-sided tape areas with a soft cloth 3 - 4 times to achieve maximum adhesion.

See Dia #11.

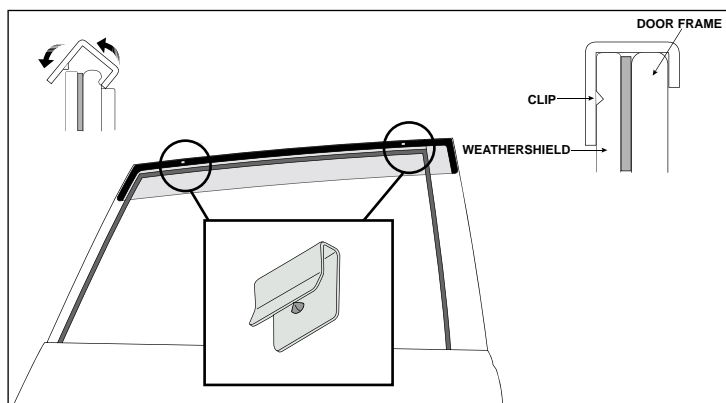

Diagram #: 12

12. Note the two slot positions in the Weathershield. Install two metal clips at the noted positions.

See Dia #12.