

## 200 SERIES LANDCRUISER CARGO BARRIER

Installation Instructions - **Rear Position Only**  
 To Suit ALL Models

Production From Sept 07 Onwards-



Accessory Part No. PZQ72 60060

Installation Time: Approx 1hr

Place these Instructions in the vehicles glove box after installation is complete

**IMPORTANT:** The installation kit contains sufficient components to fit the cargo barrier. A high degree of technical competence is necessary to correctly install this product. We recommend this Cargo Barrier be installed by a Toyota Dealer to ensure the barrier is installed in a correct and safe manner. These instructions must be read and clearly understood before commencing installation. Strict compliance with installation instructions is essential for this safety product to meet its rated capacity.

### Parts List

**Important:** Check contents of kit before commencing fitment and report any discrepancies.

Item	Component Name	Part No.	Qty
1	Cargo Barrier Assembly (Not shown)		1
2	Mounting plate	PZQ72 60060FK	6
3	Mounting Plate Seal		2
4	CSK Screw $\frac{5}{16}$ x 1"		12
5	Cover Plate Seal		6
6	Pan Head Screw M10 x 20mm		6
7	Rust Preventative Sealer (Not shown)		1
8	Installation Tool		2
9	Cleaning Pad (Not shown)		1
10	Template—Card (Not shown)		1
11	Warning Label		1
12	Milbolt M10 x 1.5 x 24mm	PZQ72 60060MK	6
13	Crinkle Washer	PZQ72 60060MK	6
14	Floor Bracket—Large (Passenger side)	PZQ72 60060BK	1
15	Floor Bracket—Large (Drivers side)		1
16	Floor Bracket Small		2

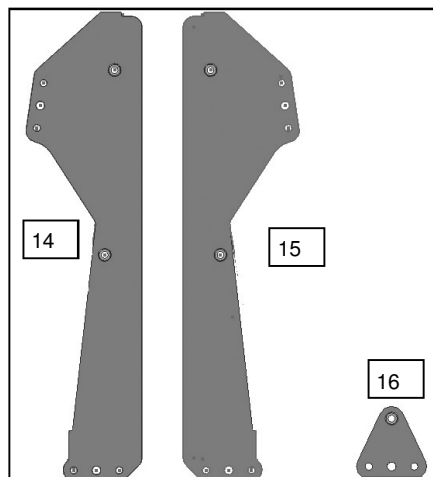
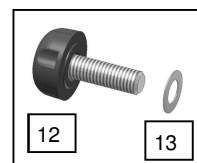
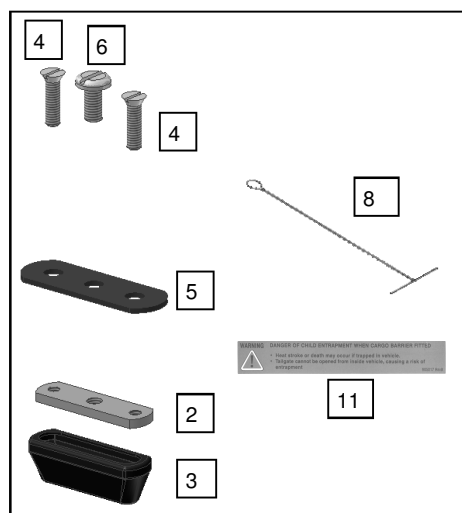

## TOOLS REQUIRED

- |                                                       |                                                              |
|-------------------------------------------------------|--------------------------------------------------------------|
| <input type="checkbox"/> Hammer                       | <input type="checkbox"/> Trim Removal Tool                   |
| <input type="checkbox"/> Screwdriver—Large Flat Blade | <input type="checkbox"/> Torque Wrench (37Nm : 27ft.lbs)     |
| <input type="checkbox"/> Power Drill                  | <input type="checkbox"/> Ratchet Wrench & 14mm AF Socket     |
| <input type="checkbox"/> Masking Tape                 | <input type="checkbox"/> Scissors                            |
| <input type="checkbox"/> Marker                       | <input type="checkbox"/> Sharp Knife                         |
| <input type="checkbox"/> Centre Punch                 | <input type="checkbox"/> Magnetic Pickup Tool                |
| <input type="checkbox"/> 5mm, 9mm Drill Bits          | <input type="checkbox"/> Rust Preventative Sealer Applicator |
| <input type="checkbox"/> Drill stop's                 | <input type="checkbox"/> Vacuum Cleaner                      |
| <input type="checkbox"/> 22mm Hole Saw                | <input type="checkbox"/> Cover sheet / Drop sheet            |
| <input type="checkbox"/> 20mm Vinyl Cutter            |                                                              |
| <input type="checkbox"/> Tape Measure                 |                                                              |
| <input type="checkbox"/> Hole De-Burring Tool         |                                                              |

## FITTERS ADVICE

**Note:** To fit the Cargo Barrier the following is essential:

- ☐ Always drill perpendicular to surface (Unless stated otherwise).
- ☐ A positive drill stop should always be used to prevent accidental damage to external panels, fuel lines etc.
- ☐ Ensure Safety Eye Protection and Gloves are worn as required when using cutting tools.
- ☐ When cutting metal panels be very careful of sharp edges, for risk of skin cuts etc.
- ☐ Care should be taken when applying Rust Preventative Sealer to all holes drilled, to negate the possibility of skin and eye irritation.
- ☐ Check screws in relevant components by hand before installation. Should there be resistance re-tap threads and re-check.
- ☐ **Before marking or drilling to install this cargo barrier, check vehicle for LPG conversion & non standard fuel tanks. Locate tanks and all lines attached and take EXTREME CARE not to damage whilst installing this cargo barrier.**
- ☐ **Before drilling to install this cargo barrier, check for concealed wiring looms. E.g. tow bar, reversing camera, reversing sensor wiring etc.. Relocate before drilling to avoid damage.**

**CARE SHOULD BE TAKEN NOT TO CROSS THREAD THE FASTNERS  
DURING INSTALLATION OF COMPONENTS TO THE VEHICLE.**



## REMOVAL OF REAR SEATS (3rd ROW SEATS– When applicable)

- Not required for **GX** Model. Please move to step 11.
- Follow steps 1– 10 to remove the Rear Seats.
- Pay attention during removal to aid in correct re-assembly.
- Retain all components for later fitment.



**IMPORTANT:** DO NOT REMOVE OR UNDO ANY SEATBELT BOLTS UNDER ANY CIRCUMSTANCES!!



1. Identify area that you are working in. REAR CARGO AREA.

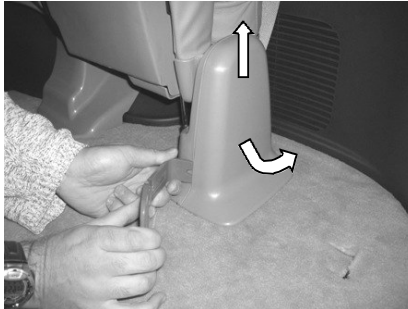

2. Remove Plastic trim coverings around base of 3rd row seats.



3. Expose rear floor bracket for 3rd row seats.



4. Remove Plastic trim coverings around base of 3rd row seats ( forward section).



5. Expose rear floor bracket for 3rd row seats.

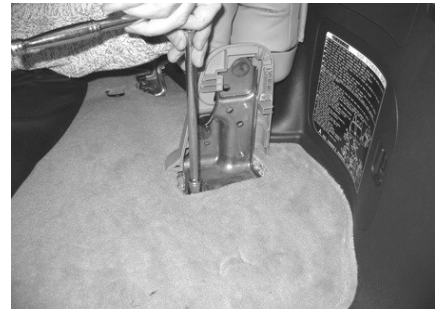

6. Using a 14mm socket driver, remove the retaining bolts. (Qty. 2)  
**NOTE:** When replacing ALL bolts must be torqued to 37Nm or 27ft. lbs

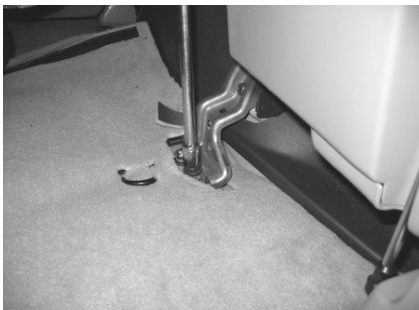

7. Using a 14mm socket driver, remove the retaining bolt. (Qty. 1)  
**NOTE:** When replacing ALL bolts must be torqued to 37Nm or 27ft. lbs



8. Using a 14mm socket driver, remove the retaining bolt. (Qty. 1)  
**NOTE:** When replacing ALL bolts must be torqued to 37Nm or 27ft. lbs



9. To release the seats use the handle at the rear of the vehicle. Carefully lift and store outside of vehicle.

**10. REPEAT STEPS 1 TO 9 FOR OPPOSITE SIDE.**

## **REMOVAL OF REAR FLOOR COVERING**

- Follow steps 11– 15 to remove the rear floor covering.
- Pay attention during removal to aid in correct re-assembly.
- Retain all components for later fitment.
- Some vehicles may use vinyl floor covering.

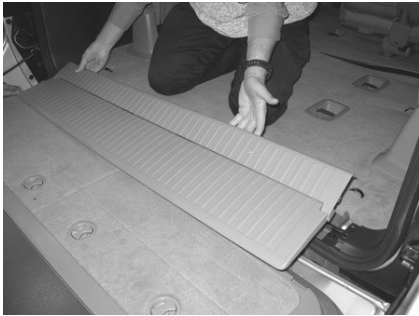

11. Remove rear Flap covering.



12. Using a trim removal tool, unclip the retaining clips holding the rear carpet in place. Take note of correct installation for re-assembly.



13. Remove the Plastic coverings for the 3rd row seat retainers x 4.  
**NOTE:** Some models will not have the plastic covering installed.



14. Remove the floor covering from the rear cargo area.

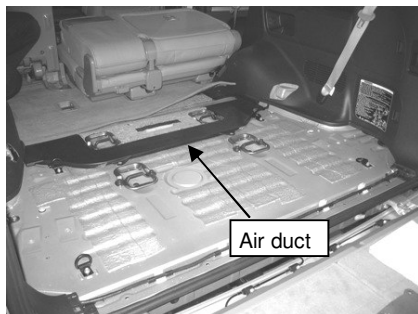

15. The rear floor area should now be visible.  
**NOTE:** Some models will not have the black plastic air ducting installed.

## **REAR FLOOR BRACKET LOCATION AND DRILLING PROCEDURE**

- Follow steps 16– 29 to mark out and drill holes for rear floor brackets.
- Vacuum away all swarf after any drilling occurs.
- Apply Rust Preventative Sealer (Item 7) to any hole drilled into metal floor.



16. Place floor bracket (Item 15) into position as shown.

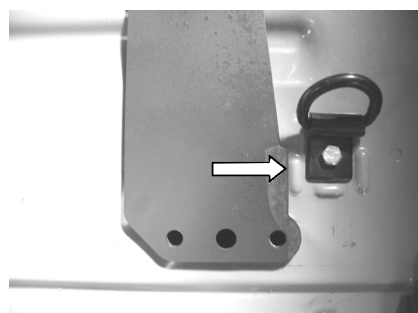

17. Align the side face to the rib where the D-Ring is attached. (Rear end shown)

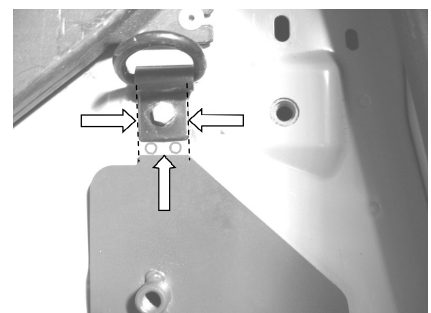

18. Square up edge's of D-Ring bracket with 25mm profile on floor bracket. Align top edge of bracket with pressed dimples as shown.



19. Using the floor bracket as a template, mark the hole locations accordingly. Rear locations shown.



20. Using the floor bracket as a template, mark the hole locations accordingly. Front locations shown.



21. Remove floor bracket and centre punch ALL marked locations.

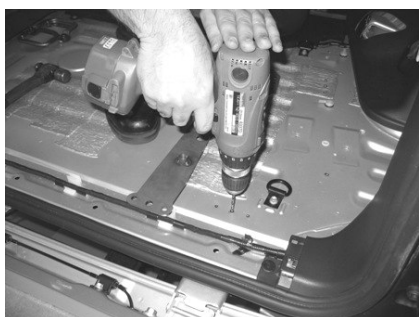

22. Pilot drill marked locations with a 5mm drill bit in rear area.  
**NOTE:** Use of a drill stop is recommended so no damage is done to external panel.



23. Pilot drill marked locations with a 5mm drill bit in front area.

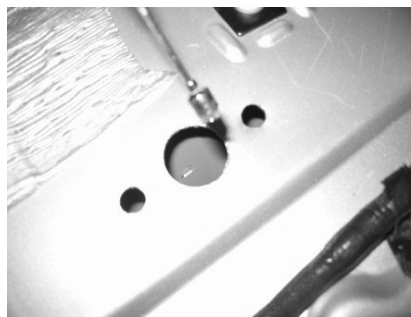

24. Drill hole's in all location's, out to -

- 9mm outer (x2)
- 22mm centre hole

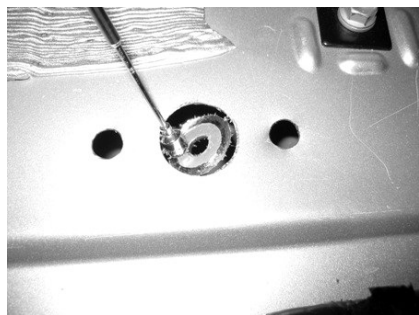

25. Using a magnetised wand, remove the centre 22mm piece of swarf as shown.

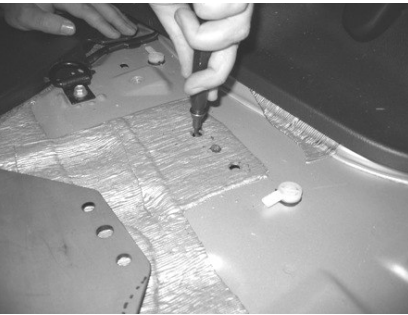

26. Using a De-Bur tool, de-bur all holes drilled.



27. Vacuum away all swarf.

28. Apply rust preventative sealer (Item 7) to ALL drilled holes.

**29. REPEAT STEPS 16 TO 28 FOR OPPOSITE SIDE.**

## **FLOOR BRACKET INSTALLATION ( REAR)**

- Follow steps 30– 39 to install rear floor brackets.

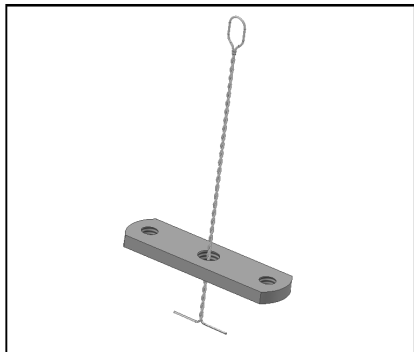

30. Insert the eye of the installation tool (Item 8) through the centre M10 hole in the mounting plate (Item 2) as shown.

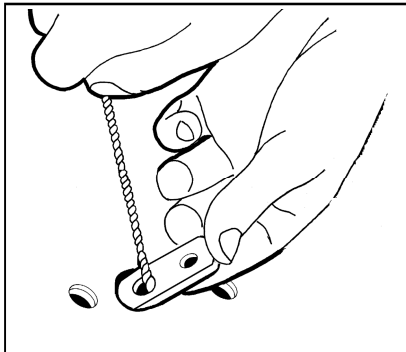

31. Insert mounting plate into forward centre 22mm hole and position mounting plate with holes aligned on underside of floor panel.



32. Slide centre hole of rubber cover plate seal (Item 5) over installation tool.

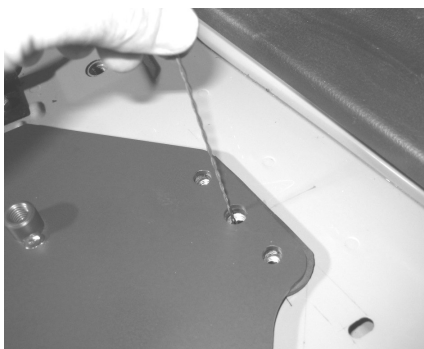

33. Slide floor bracket forward centre hole over installation tool as shown.

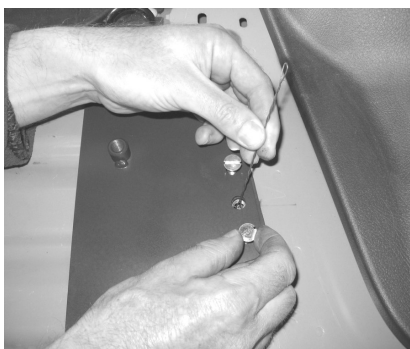

34. Holding the mounting plate in position, screw CSK Screws ( Item 4) through outer holes. Remove installation tool and insert Pan Head screw ( Item 6) into centre hole. Do not tighten as movement is needed to affix the mounts at the rear.

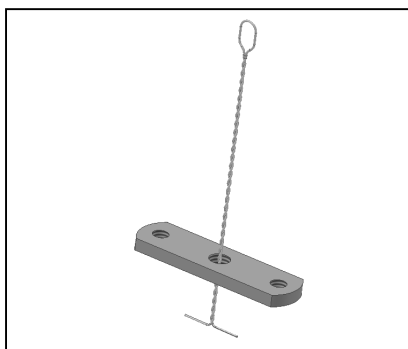

35. Insert the eye of the installation tool (Item 8) through the centre M10 hole in the mounting plate (Item 2) as shown.

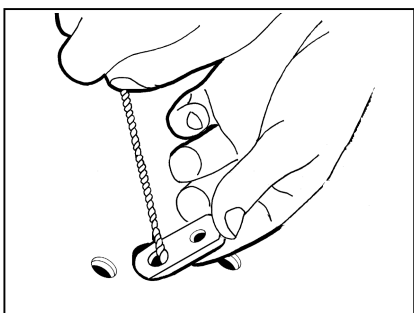

36. Insert the mounting plate into the 22mm hole in the floor at rear. **NOTE:** The floor bracket will be attached in the front location so some manoeuvring may be required to position the mounting plate.



37. Once the mounting plate is in position underneath the floor, slide the centre hole of the rubber cover plate seal (Item 5) over eye of installation tool. Slide floor bracket rearward centre hole over installation tool as shown.



38. Holding the mounting plate in position, screw CSK Screws ( Item 4) through outer holes. Remove installation tool and insert Pan Head screw ( Item 6) into centre hole. **Tighten all screws including forward plate securely.**

**39. REPEAT STEPS 30 to 38 FOR OPPOSITE SIDE**



## FRONT FLOOR BRACKET LOCATION AND DRILLING PROCEDURE

- Follow steps 40– 49 to mark out and drill holes for forward floor brackets.
- For models without ducted underfloor air conditioning go to step 44.
- Pay attention to notes on templates supplied.
- Care should be taken whilst trimming Air Duct. (Item 43 below).

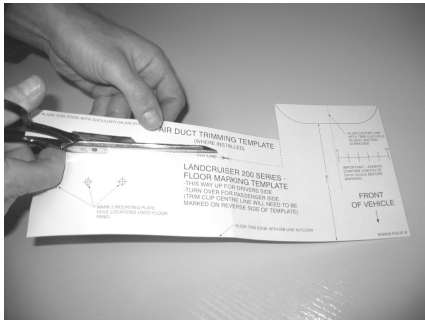

40. If vehicle has ducted air conditioning - Cut the Template ( Item 10) along cut line as shown. TAKE CARE to separate the two required templates.

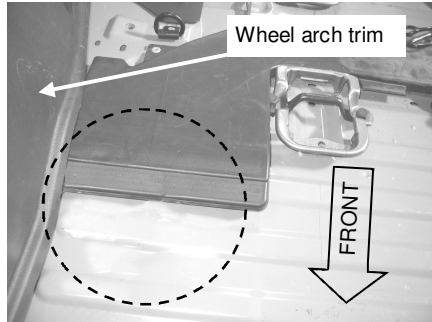

41. Identify area where the mount is to be located, (Drivers side shown) and pull floor covering forward out of the way.  
**Note:** Plastic duct shown may not be installed in all models.

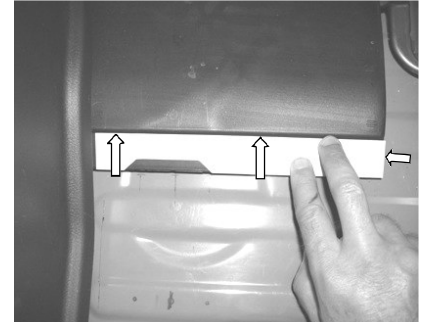

42. Place small section of the template as shown.  
**NOTE:** Carefully position with datum edges aligned with duct as shown by arrows above. (Refer template for detail) Mark cut out section onto duct)



43. Using a sharp Knife cut away the marked area.



**NOTE:** Care should be taken when cutting the drivers side as the air duct is close to the area being cut away. Only the thin web is allowed to be trimmed.

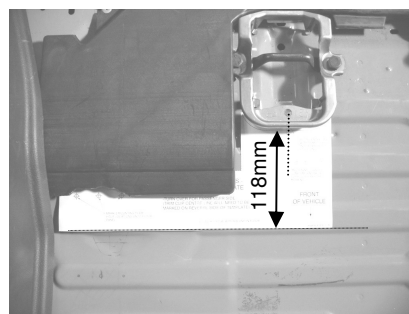

44A. For models with 3rd row of seats - Using the large part of the template, align the centre line on the template with the centre of the seat anchor surround as shown. Align the forward edge of the template parallel with the raised indent in the floor panel.

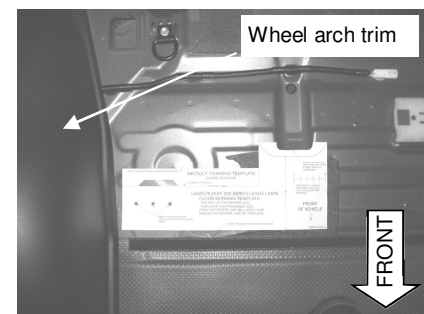

44B. For models without a 3rd row of seats installed & working on drivers side of vehicle, line up cut out in template with raised indent in floor panel. Align the forward edge of the template parallel with the raised indent in the floor panel.

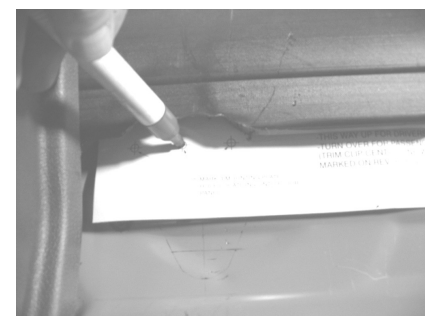

45. Once the template is in position mark the mounting plate hole locations onto the floor panel as shown.

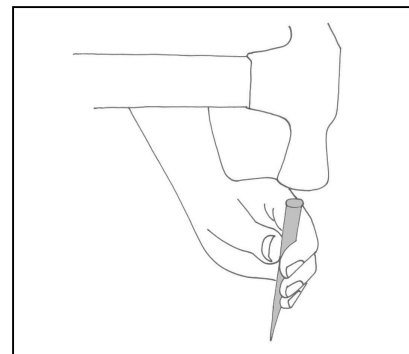

46. Centre Punch marked points.

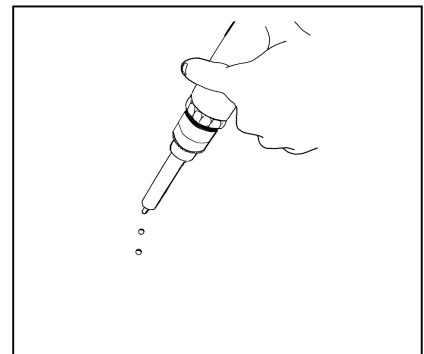

47. Drill out holes as follows -

- Pilot drill 5mm (All holes)
- Outer holes 9mm (x2)
- Centre hole 22mm





48. De-burr all drilled holes. Vacuum away all swarf.

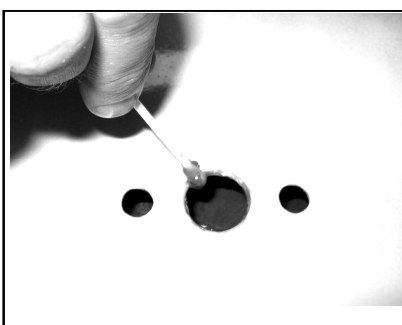

49. Apply Rust Preventative Sealer (Item 7) to all drilled holes.

**50. REPEAT STEPS 40 to 49 FOR OPPOSITE SIDE**  
*(With templates reversed)*

### **FRONT FLOOR BRACKET INSTALLATION PROCEDURE**

- Follow steps 51– 57 to install forward floor brackets.

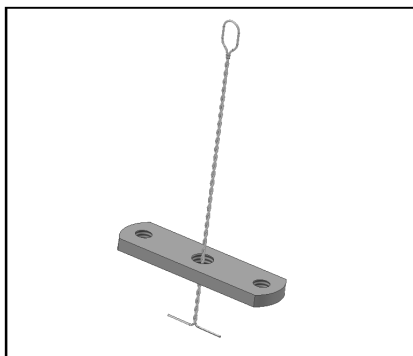

51. Insert the eye of the installation tool (Item 8) through the centre M10 hole in the mounting plate (Item 2) as shown.

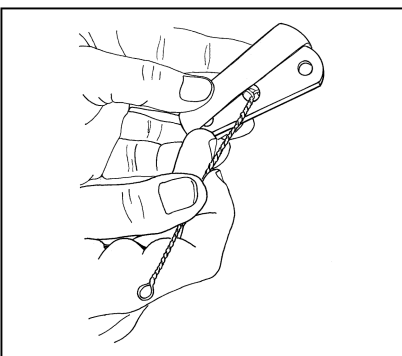

52. Insert mounting plate assembly into rubber mounting plate seal (Item 3) as shown.

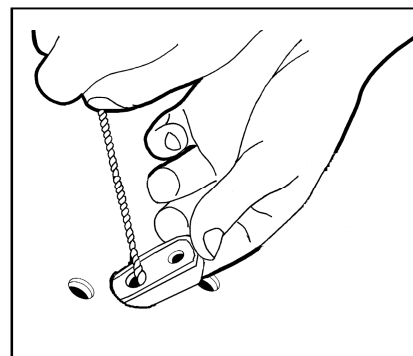

53. Insert mounting plate assembly into 22mm hole and position mounting plate with holes aligned on underside of floor panel.



54. Place centre hole of cover plate seal (Item 5) over eye of installation tool (Item 8).

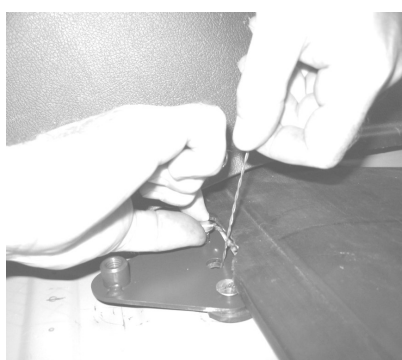

55. Place centre hole of small floor bracket (Item 16) over eye of installation tool. Holding the mounting plate in position, screw CSK Screws (Item 4) into outer holes. Remove installation tool and insert Pan Head screw (Item 6) into centre hole.



56. Tighten all screws securely.

**57. REPEAT STEPS 50 to 56 FOR OPPOSITE SIDE**



## **CUT FLOOR COVERING FOR ACCESS HOLES TO MOUNTS**

- Follow steps 58– 69 to re-install and cut access holes through soft floor covering.



58. Refit floor covering to rear cargo area and replace the plastic coverings of 3rd row seat retainers.



59. Locate rear most spacer tube on rear floor bracket ( Item's 14 and 15) underneath floor covering.  
**NOTE:** Forward spacer tube on rear bracket is not used in this installation.



60. Turn floor covering over and mark approximate location on the felt backing for the rear most spacer and forward spacer.



61. Trim felt backing away at marked locations with sharp knife.  
**NOTE:** Only remove enough felt backing to allow spacer to protrude to carpet, back surface.



62. Lay floor covering back into its natural position ensuring it is located accurately.  
Carefully locate centres of rear spacer tubes.



63. Using a 20mm vinyl cutter, centre drill bit on spacer tube, and cut hole through floor covering.  
**HINT:** In lieu of a vinyl cutter, a hole saw can be used very carefully by running in a reverse direction.



64. Relocate forward section of floor covering over spacer tubes on forward floor mounts (Item 16).



65. Locate spacer tube underneath floor covering.



66. Turn floor covering over and trim felt backing away at spacer tube location, with sharp knife.



67. Lay floor covering back into its natural position ensuring it is located accurately.  
Carefully locate centres of spacer tube.



68. Using a 20mm vinyl cutter, centre drill bit on spacer tube, and cut hole through floor covering.

**69. REPEAT STEPS 58 to 68 FOR OPPOSITE SIDE**

**70.** Re install floor covering in reverse order to disassembly. (Steps 11 to 14 on Page 4)

**71.** Re install 3rd row of seats in reverse order to disassembly (Steps 1 to 10, Page 3.



**ENSURE** all 8 x 14mm AF bolts (M10 x 1.25) are correctly torqued to 37Nm (27 ft. lbs.)

## **INSTALL CARGO BARRIER**

- Installation of Cargo Barrier in Rear Position
- Rating Label on Cargo Barrier panel should be facing toward the rear of the vehicle.



72. Position Cargo Barrier behind second row of seats with rating label facing the rear of vehicle.

**HINT:** This is easiest done by releasing small side of second row seat forward to allow space to manoeuvre Cargo Barrier into position.

73. Attach drivers side long side strap to Barrier panel top brackets using Milbolts (Item 12) with crinkle washer (Item 13) under head.

74. Using Milbolts (Item 12) with crinkle washers (Item 13) under head attach long side strap to rear floor brackets . Repeat for opposite side of the vehicle.

75. Attach the short bottom straps to the forward bottom mounts using Milbolts (Item 12) with crinkle washers (Item 13) under the head.

76. Tighten all Milbolts securely.



**IMPORTANT NOTE: Check that all bolts and screws are tight and re check periodically.**

### **ATTACH WARNING LABEL TO DRIVERS SIDE DOOR OPENING.**

- Follow steps 77 & 78 to attach warning label.

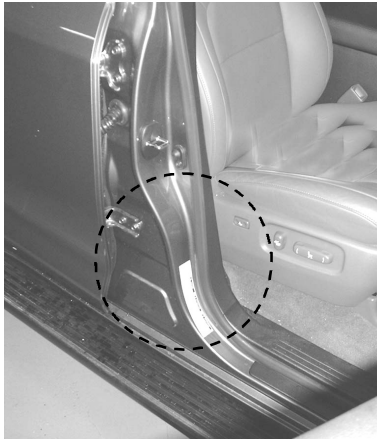

77. Clean area inside drivers door opening using alcohol cleaning pad (Item 9). Allow to dry completely.

78. Affix warning label (Item 11) to cleaned area as shown. Apply pressure to label to make good bond.

### **79. Complete a final inspection of the complete assembly in reference to these instructions.**



#### **ATTENTION**

- Modifications to the cargo barrier or its fixings, or use in any other vehicle for which it is not designed will void load rating and warranty.
- Strict compliance with fitting instructions is essential for this safety product to meet its rated capacity.
- Please refer to the installation and user instructions supplied for details regarding the fitting and usage of this product. Under no circumstances should a Seat, Seatbelt or Child Restraint Device Anchorage be used to mount the cargo barrier in the vehicle.
- Always position load against cargo barrier.
- Do not place smaller items, that may bypass the cargo barrier in the event of heavy braking or collision, near the edges of the barrier.
- Do not attach items to the front or rear of the cargo barrier.
- The cargo barrier may deform and significantly intrude into the occupants space in an accident.
- To ensure that your cargo barrier remains in good condition, periodically check the tension of all fasteners and clean with damp cloth. Clean with soap and water only. Do not use solvents or chemicals.
- If involved in an accident, or deterioration in condition is detected, the cargo barrier should be replaced and the anchorages inspected by an authorised Toyota Dealer.
- The cargo barrier **MUST NOT** be located in front of seats occupied by passengers.
- Never leave a child in the vehicle unattended, particularly in the rear cargo area. The cargo area should never be used as a play area for children.
- Remember that the Tailgate cannot be opened from inside the cargo area.