

PARTS, SERVICE & ACCESSORIES

RAV 4

December 2012 Production Onwards
ACRYLIC BONNET PROTECTOR
 Installation Instructions

Accessory Part No. PZQ15-42100

Installation Time: Approx. 15 mins

Place these instructions in vehicle's glove box after installation is complete
Care Instructions:


Do not slam bonnet.


 Clean Bonnet Protector
 with a mild detergent and
 water solution.

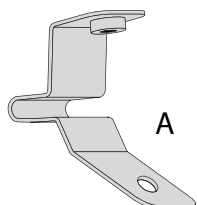
 Do not use automatic
 car wash.

 Do not use abrasive,
 spirit or solvent
 based cleaners.

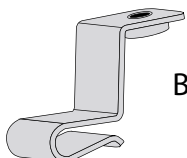
Item	Component Name	Qty	Part number
1	Bonnet Protector	1	PZQ15-42100
2	Fixed Metal Clips	2	PZQ15-42100FK
	Push-on Clips	4	
	Small Screws	6	
	Washers	6	
	Anti-Abrasive Tape	6	
	Self Tapping Screws	2	
	Screw Plugs	2	
	Alcohol Wipe	1	
	Installation Instruction	1	



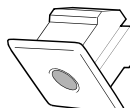
Item	Qty		Item	Qty	
A	2	Fixed Metal Clips	F	6	Anti-Abrasive Tape
B	4	Push-on Clips	G	6	Washer
C	2	Screw Plugs	H	1	Alcohol Wipe
D	6	Small Screws	I	1	Installation Instruction
E	2	Self Tapping Screws			



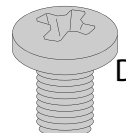
A



B



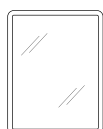
C



D



E



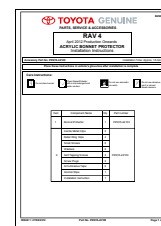
F



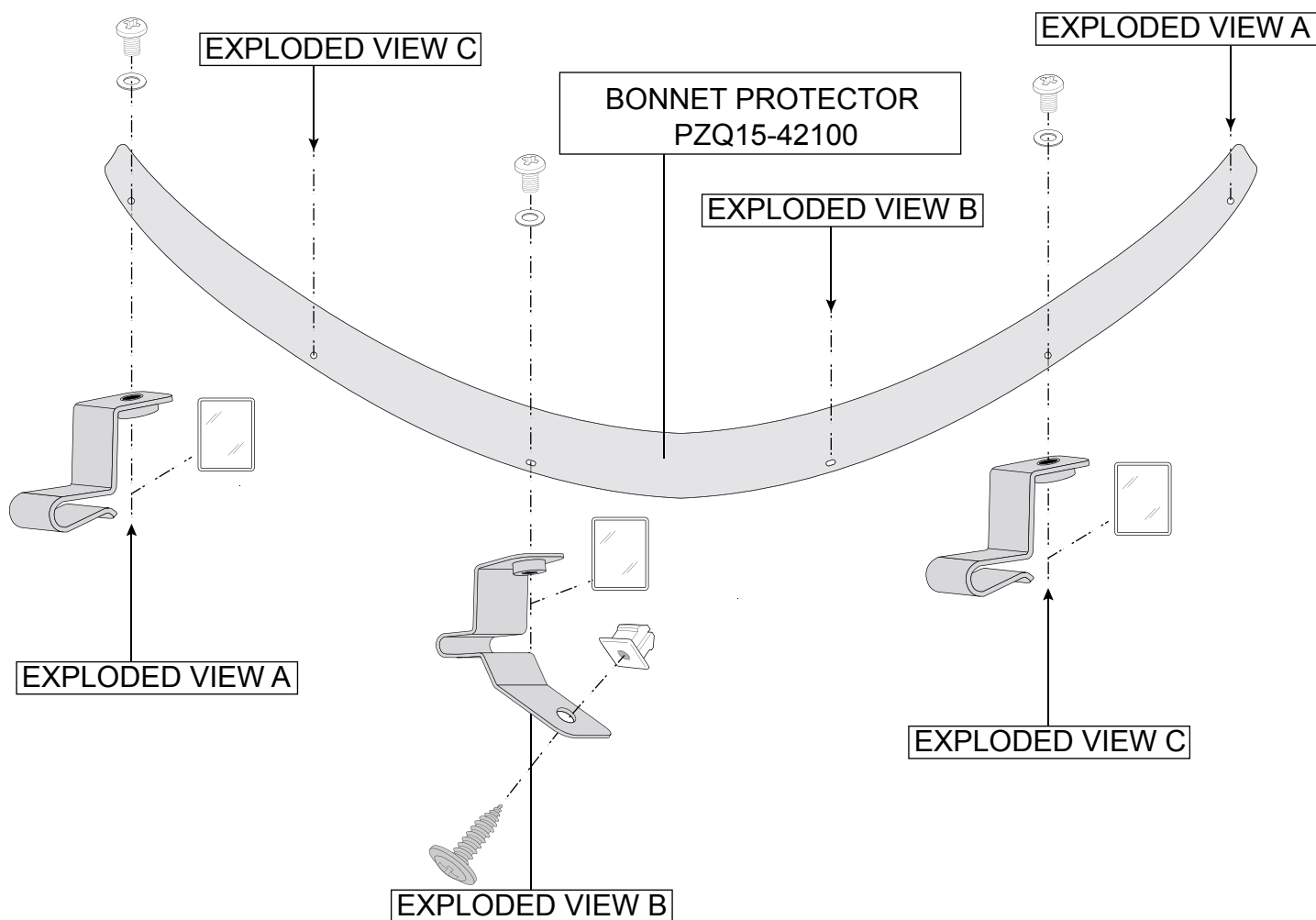
G

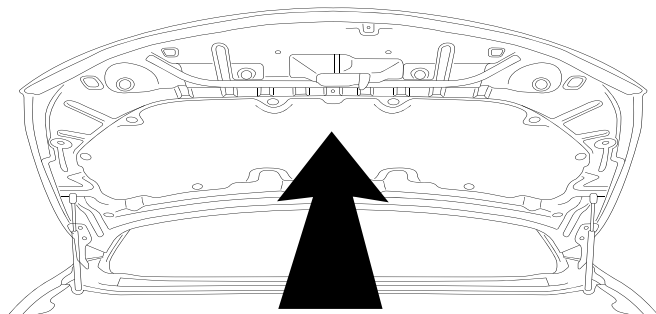


H



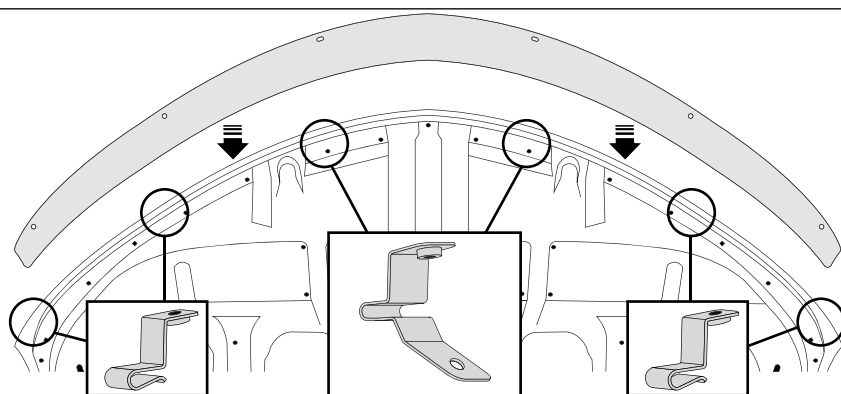
I

FITTING KIT
PZQ15-42100FK


Diagram #: 1

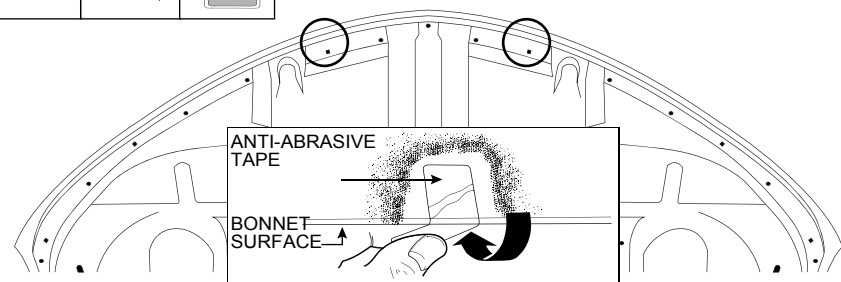
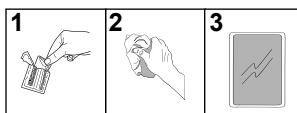
1. Open & thoroughly clean and dry the bonnet.

See Dia #1.


Diagram #: 2

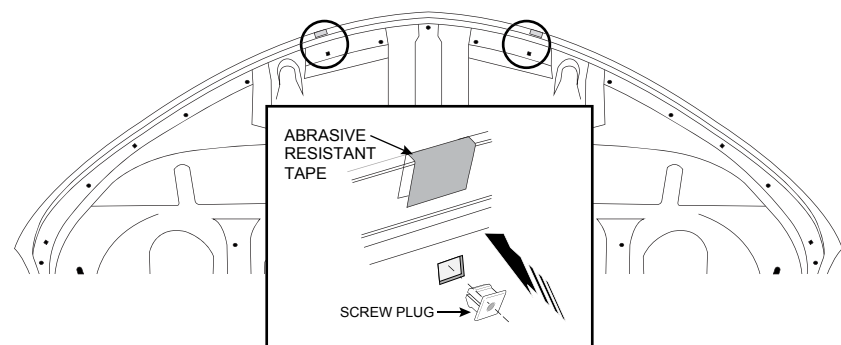
2. Trial fit the bonnet protector centrally onto bonnet. With a non-permanent marker, note the positions of the two middle slots in the bonnet protector that correspond to the holes in the underside of the bonnet. Also note and mark the push-on clip positions corresponding to the holes of the Bonnet Protector. Remove Bonnet Protector.

See Dia #2.

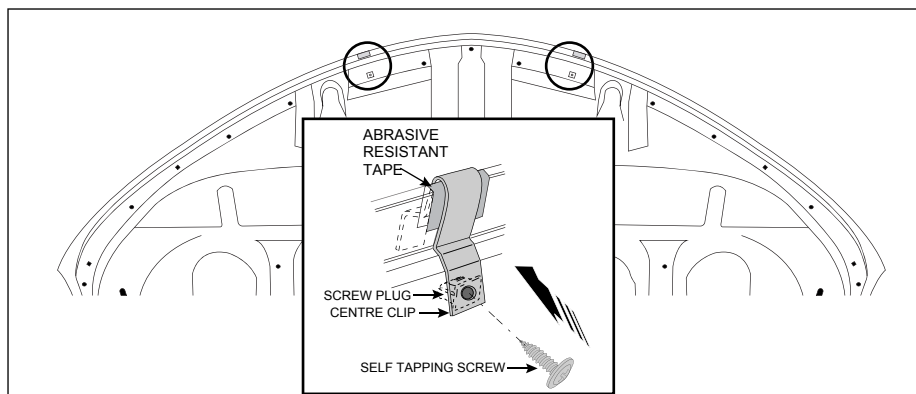

Diagram #: 3

3. Trial fit the fixed metal clips aligning the round holes in the clips with the holes in the bonnet. Note where the clips make contact with the bonnet, remove clips. Clean these areas with the alcohol wipe provided. Wipe off any residue with a dry clean cloth. Adhere the anti-abrasive tape over the bonnet lip. Apply tape so approximately half of the tape is on the topside and half is on the underside of the bonnet.

See Dia #3.


Diagram #: 4

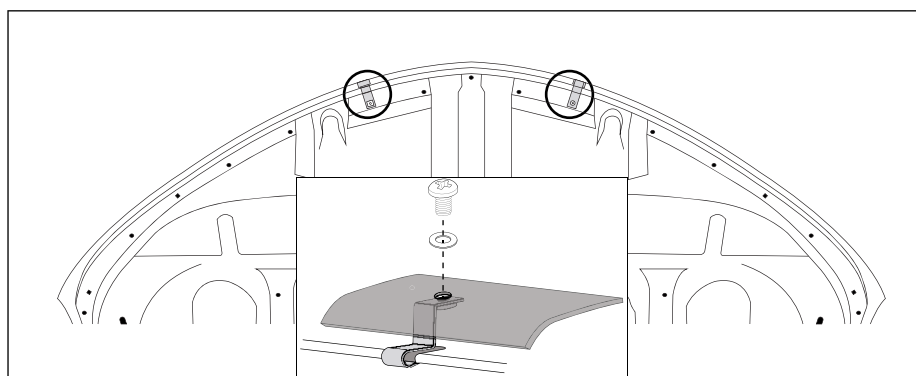
4. Position the screw plugs in the centre square holes in the bonnet.


Diagram #: 5

5. Position the centre metal clips onto bonnet and secure the clips with the self tapping screws into the previously installed screw plugs, as shown.

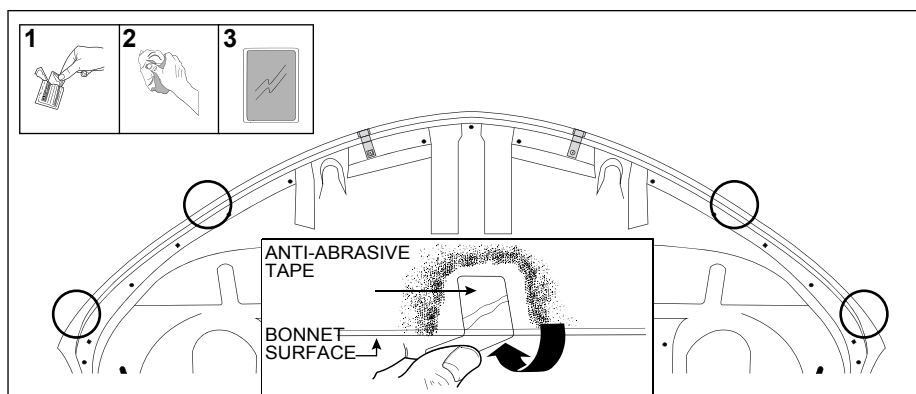
See Dia #5.

IMPORTANT: Ensure that the clips are positioned over abrasive resistant tape and do not come in contact with any of the bonnet's paint work. Failure to do this may result in permanent paint damage.


Diagram #: 6

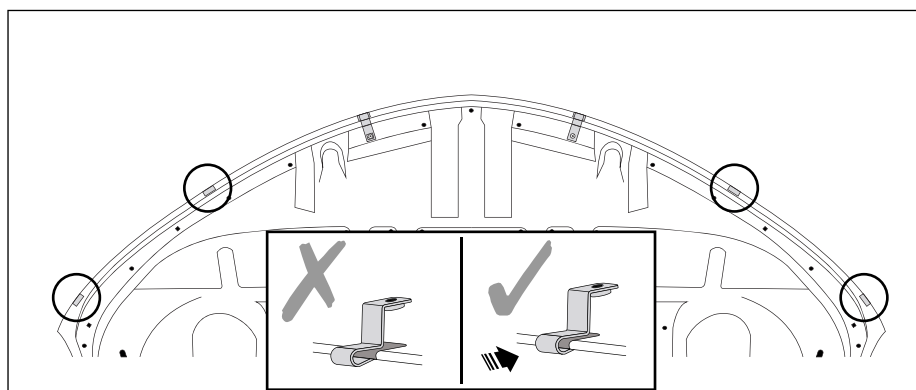
6. Fit the bonnet protector centrally to bonnet and loosely secure to the top of fixed metal clips with the small screws and washers provided.

See Dia #6.


Diagram #: 7

7. At the previously marked areas . clean bonnet with the alcohol wipe provided and wipe off any residue with a dry clean cloth. Adhere the anti-abrasive tape strips over the bonnet lip directly below the holes in the Bonnet Protector. Apply tape so approximately half of the tape is on the topside and half is on the underside of the bonnet.

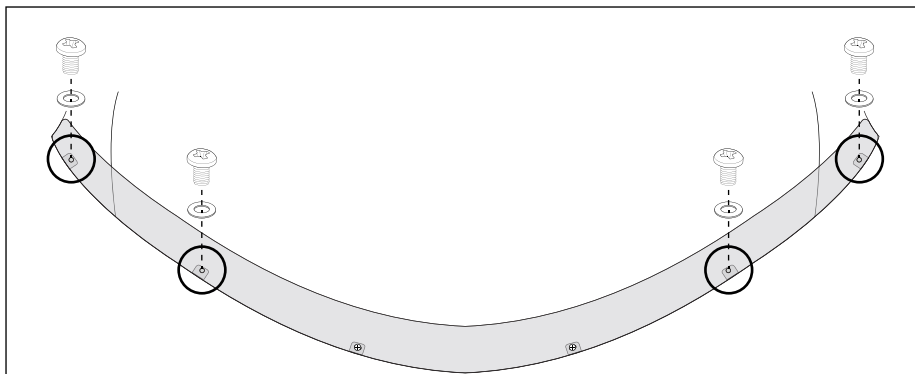
See Dia #7.


Diagram #: 8

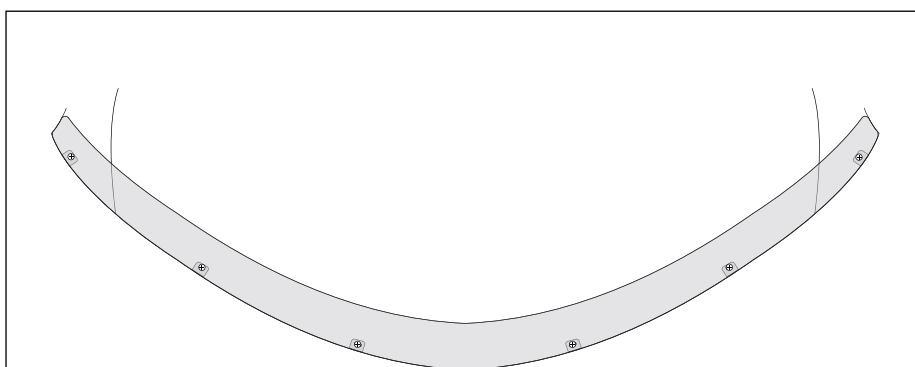
8. Slide the push-on metal clips onto the bonnet locating them over the anti-abrasive tape strips as shown.

See Dia #8.

IMPORTANT: Ensure that the clips are positioned over anti-abrasive tape and does not come into contact with any of the bonnet's paint work. Failure to do so may result in permanent paint damage.


Diagram #: 9

9. Loosely secure the Bonnet Protector to the four push-on metal clips with the screws and washers provided.
See Dia #9.


Diagram #: 10

10. Check the Bonnet Protector is sitting centrally on the bonnet. Tighten all the screws.
See Dia #10.

TO REMOVE: Reverse the above procedure.

IMPORTANT: Conduct final inspection, ensuring all fasteners are tightened, and clips are correctly installed and not touching painted surfaces. Close bonnet and check clearances at all edges for interference and adjust if necessary.