



Instructions

Rear Upper Control Arm Bushings - offset

Note. This instruction sheet should be used in conjunction with the workshop manual and proper safety procedures followed.

Application - Mini 2001-2015
- R50 R52 R53 R55-59

(Always refer complete catalogue listing)

Contents - 4x bushing 2423
- 4x offset steel tubes 20x12x40mm
- grease



WHITELINE recommends checking camber settings prior to dismantle.

- Raise vehicle evenly and safely support.
- Proceed to remove rear wheels.
- Un-bolt rear upper arms.
- Both inner and outer bushings will need to be removed.
Press out with a hydraulic press including the steel outer shell.

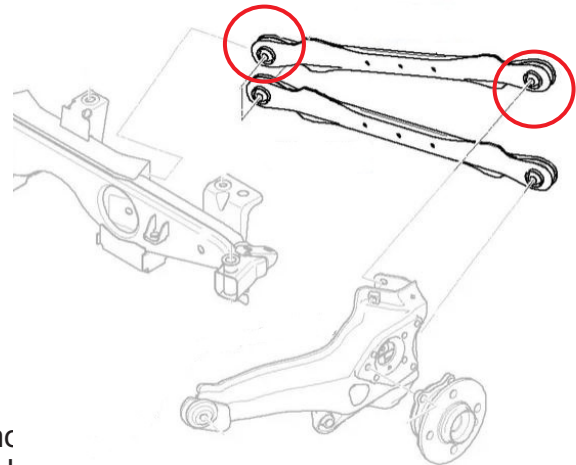

Note the image below using a support spacer to prevent the arm from squashing.

- Push in new bushing 2423 into clean arm. A small amount of grease may help.
- Grease bushing ID and face with supplied grease.
- Push in offset tubes
Rotate to desired position.
- Re-fit arms to car.
- Carry out wheel alignment immediately after install.
- Re-check all bolts after 500kms

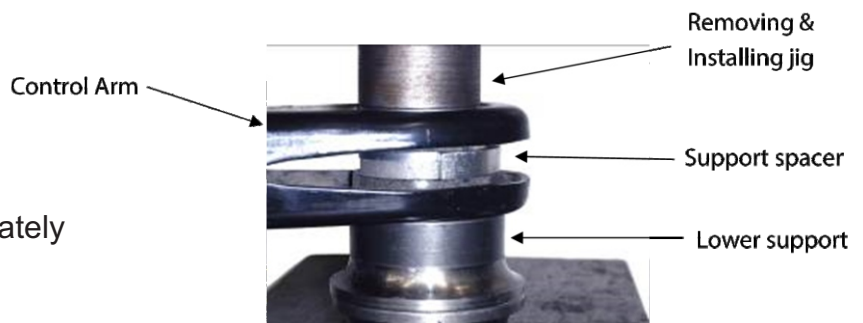

It is recommended that a licenced workshop or trades person carry out the above procedure and that workshop manual and relevant safety procedures are followed in addition to the above.