

Instructions

Front Control Arm Inner Bushing

N.B: This instruction sheet should be used in conjunction with the workshop manual and proper safety procedures followed.

Application: Toyota

Install Guide

1. Raise vehicle evenly and safely support.
2. Remove front wheels and proceed to remove front arms - you may have support motor and remove outer engine mounts.
3. The OE bushing can be pressed out with a Press. Once removed, check eyelet is clean and free of any burs.
4. Push the supplied bushings in place. Grease bushing ID and faces.

Note the steel components supplied;

- 2x Pins
- 4x Washers
- 2x Spacers
- 2x Lock brackets

5. Push Pin into place - note washer position in images.
6. Once arm is in position in car, place steel spacer under Pin and Lock Bracket over the top (under bolt).
7. Torque bolts to OE spec. A wheel-alignment is recommended.
8. Re-check after initial 100-200kms travelled.

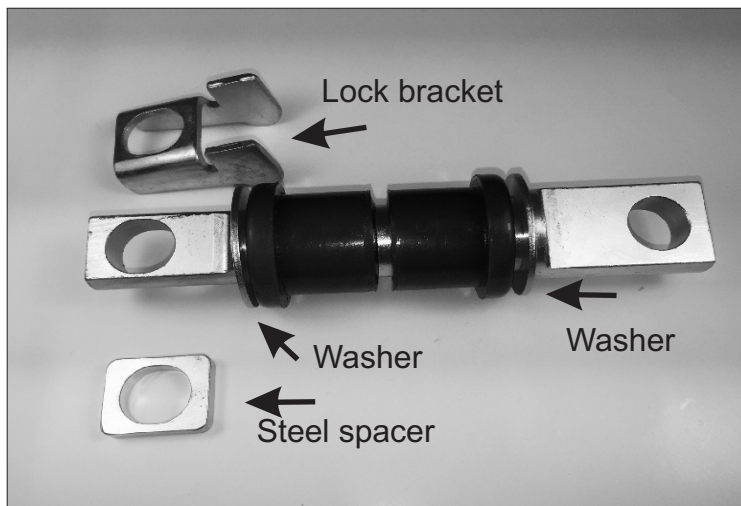

Note: Supplied steel spacer to be fitted between steel pin and vehicle sub-frame

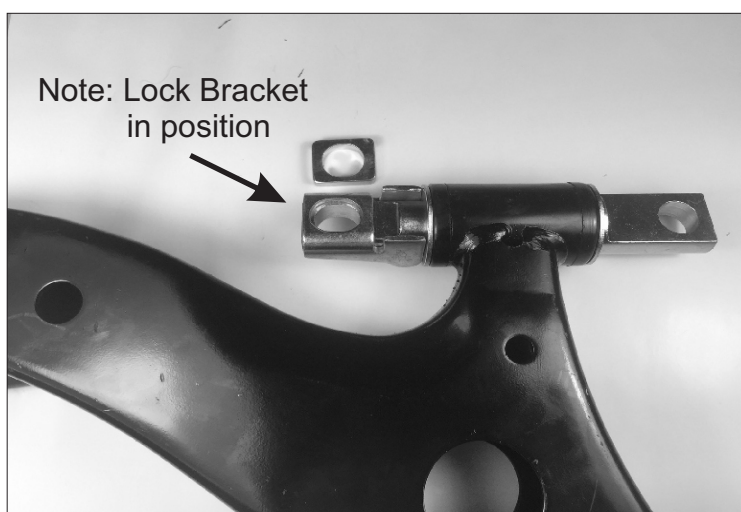

N.B: It is recommended that a licenced workshop or tradesperson carry out the above procedure and that workshop manual and relevant safety procedures are followed in addition to the above.