

# INSTALLATION INSTRUCTIONS



## **2591 TO SUIT NISSAN MAXIMA J31 12/03-ON**

### **PLEASE READ INSTRUCTIONS THROUGH BEFORE YOU BEGIN**

#### **WARNING:**

1. Do not, drill, cut, weld or otherwise modify the towbar.
2. If you are using electric welding on a motor vehicle, always check that the vehicle is not equipped with electronic engine or instrument management equipment. Failure to do so could destroy any onboard computers. If in doubt, check with the vehicle's manufacturer.

**Max. Towing Weight: 1200kg**

- 1 Ensure all hardware items have been included
- 2 Fold forward rear-quarter interior trim
- 3 Remove tail lights via removal of the following items
  - a) 3 nuts
  - b) 1 Plastic push-in clip
  - c) Remove tail light
- 4 Remove bumper bar via removal of the following items.
  - a) 1 self-tapping screw from each wheel arch
  - b) 4 Plastic trim buttons from lower bumper lip
  - c) 2 M6 bolts from inside rear quarter
  - d) 1 plastic trim button from underneath each tail light
  - e) Remove bumper bar
- 5 Remove foam support and impact beam
- 6 Remove mounting hats from impact beam and retain 2 nuts and beam
- 7 Lift towbar to back of vehicle and align holes of towbar with back of vehicle
- 8 Fit all bolts as per diagram, fitting nuts on wire through large access holes in towbar
- 9 Tighten all bolts to torque listing
- 10 **NOTE: CUT OUT** - may be required for the bumper bar ( 100mm wide x 60mm high ) and the centre section of impact-foam, due to model variances.
- 11 Refit impact beam using 2 M8 bolts and flat washers supplied and 2 nuts retained in step 6
- 12 Refit foam to impact beam
- 13 Refit bumper and taillight in reverse steps 4 through to 2

NOTE: Hayman Reese recommends that you check your towball to ensure it complies with Australian Design Rules.

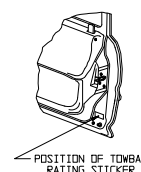

#### **RECOMMENDED ASSEMBLY TORQUE LISTING**

<b><u>Diameter</u></b>	<b><u>Grade 8.8 Bolt</u></b>
	<b>Nm</b>
M6	9.5
M8	21.7
M10	43.4
M12	77.3
M16	189.8

#### **FOR TOWING PURPOSES ONLY**

For towing capacity details please refer to vehicle owner's manual or to the manufacturer. Overloading can void your warranties.

# INSTALLATION INSTRUCTIONS



**2591 TO SUIT NISSAN MAXIMA J31 12/03-ON**

**PLEASE READ INSTRUCTIONS THROUGH BEFORE YOU BEGIN**

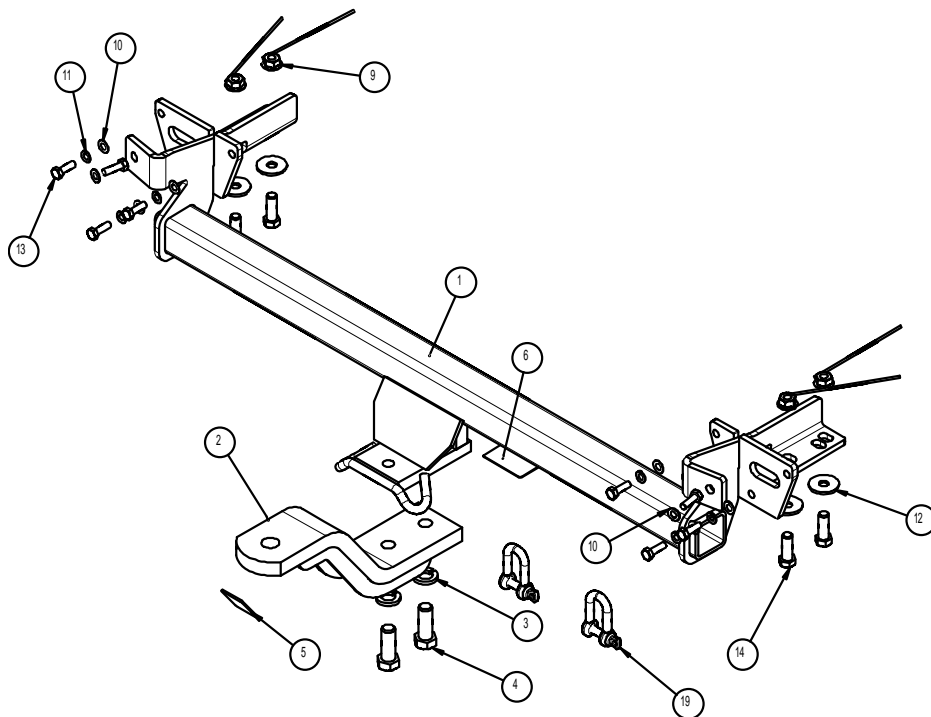

QTY.	DESCRIPTION	ITEM NO.
1	WELD ASSY NISSAN MAXIMA	1
1	LUG ASSEMBLY c/w REINFORCE	2
2	M16 X 5 X 3.5 SPRING WASHER	3
2	M16 x 45 2.0P BOLT	4
1	H.R STICKER	5
1	CP label sticker	6
1	BOLT PACK	7
2	PLASTIC SHEET BAG	8
4	M12 WHIZZ NUT AND WIRE	9
8	Wshr ft M8 x 17 x 1.20 z/p	10
6	WSHR SPRING FT SEC M8x3.0x2.0mm z/p	11
4	WASHER FLAT M12x 37 x 3	12
8	Bolt M8 x 25 Gr 8.8	13
4	M12 x 35 1.75P BOLT	14
1	BRAND BAG	15
1	Warranty Card	16
1	LRL LABEL STICKER	17
1	FITTING INSTRUCTION	18
2	D' SHACKLE	19

**PLEASE NOTE:** You must remove the lug unless you are actually towing if it obscures your number plate. Failure to do so may result in a fine.