

Install Guide

Rear Subframe Bushes

Jeep Cherokee WK, WK2 (2011-on)

Nolathane[®]

Note: These components must be fitted by a qualified person only, as per the manufacturers' service manual. Also, all relevant safety procedures are followed in addition to the following. Photos are an indication and may vary slightly in appearance from the actual product.

Kit Contents:

- 4 x "5392A" bush
- 4 x "5392B" bush
- 4 x 36x22.2x88.5 crush tube
- 4 x 110OD washers

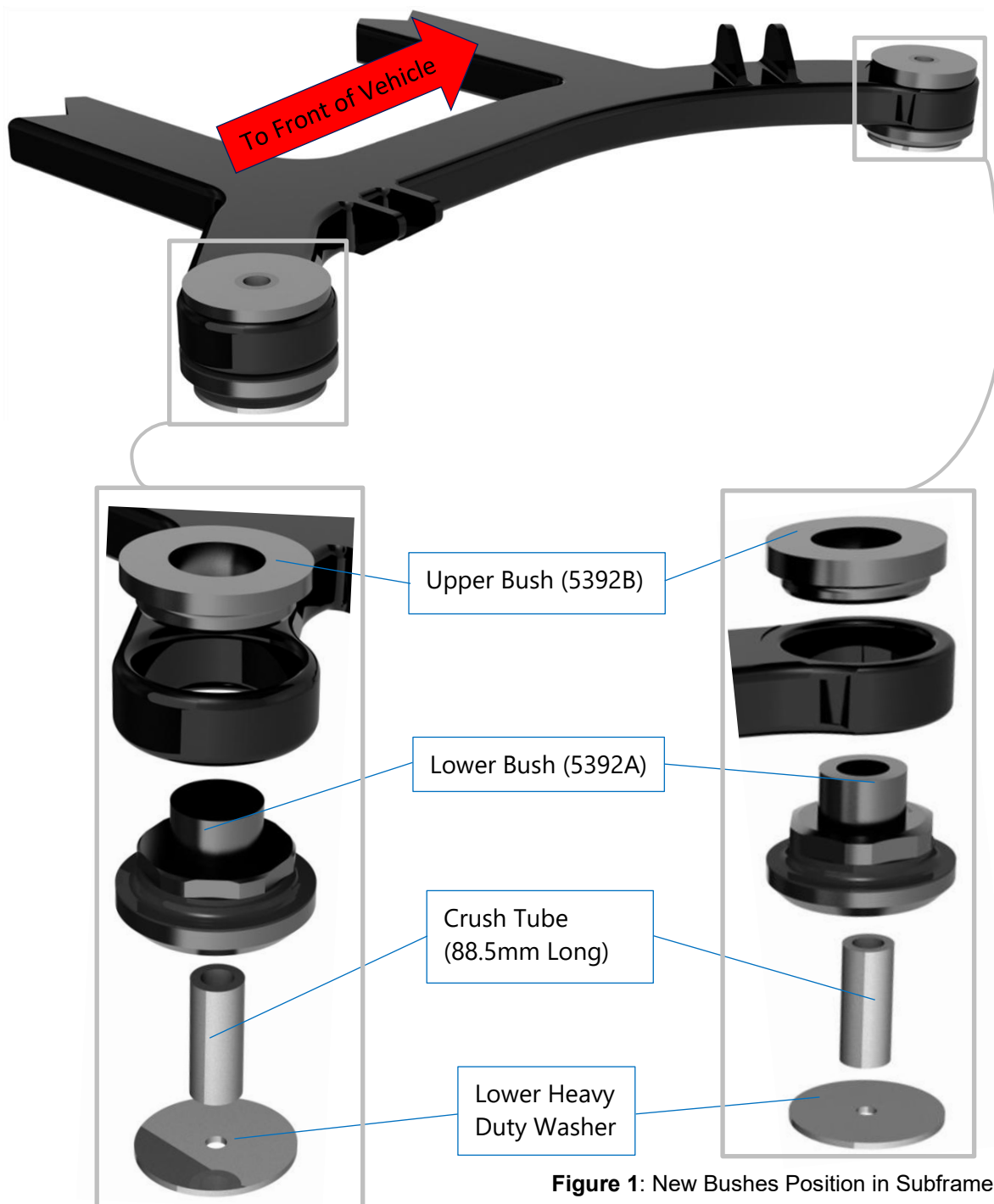

Figure 1: New Bushes Position in Subframe

Install Guide

Rear Subframe Bushes

Jeep Cherokee WK, WK2 (2011-on)

Z7106-N
Page 2 of 2

Nolathane[®]

Note: Polyurethane bushes must be fitted to both sides of the vehicle.

1. Jack vehicle up and put on stands/hoist, remove rear wheels, exhaust and disconnect the hand brake cable.
2. Support the subframe with a long adjustable stand or similar, then remove the rear sub frame bolts.
3. Lower the rear subframe until you have enough clearance (approx. 30mm) to place a pressing plate on top (around 95mm OD plate) for use to remove factory bushes. Note: careful to not stretch any cable.
4. Setup press tool assembly to extract the factory bushes (refer Figure 2 below for example).
5. Clean housing areas to remove any old original bushing materials.
6. Apply grease supplied onto the housing and install the new polyurethane bushings according to Figure 1.
7. Apply grease to the bore of the bushes, and outside of steel crush tube, then press the crush tube in
8. Refit the sub frame to the vehicle in reverse order, ensuring that you use manufactures torque settings and carry out a wheel alignment

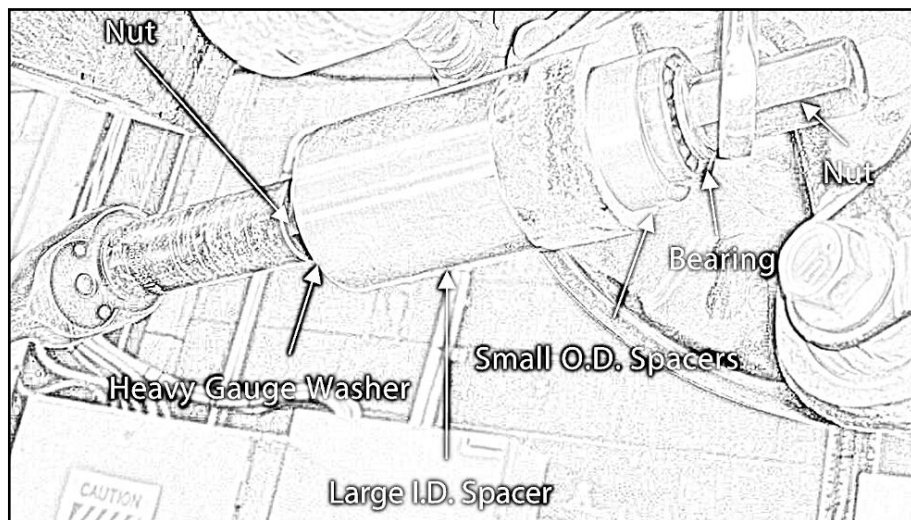

Figure 2: Press Tool Setup (Illustrative Purpose)