

Installation Guide

Lower Control Arm Rear Bush

Z 5147

Suits: Ford Focus

(Always refer to the current catalogue for complete application listings)

N.B: This installation guide should be used in conjunction with the workshop manual.

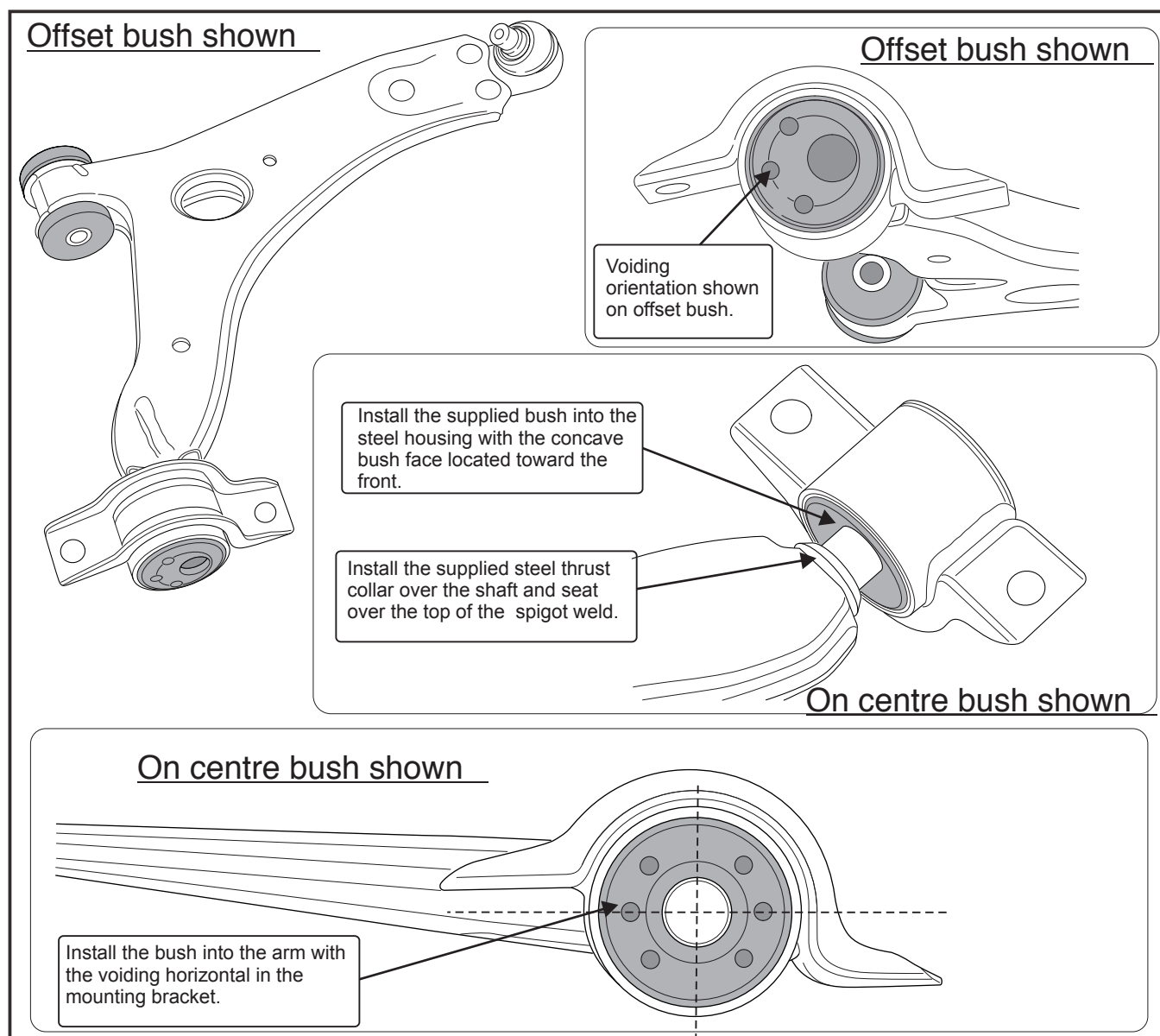

- ❑ Please ensure control arm spigot is smooth and free from burrs.
- ❑ Install the steel shelled bush into the housing ensuring the steel shell is pressed flush into the housing.

N.B: It is recommended that a licenced workshop or trades person carry out the above procedure and that workshop manual and relevant safety procedures are followed in addition to the above.