

# Instructions

## Aluminium Lift Blocks - for 4x4 Strut-Top and Leaf Spring Vehicles

N.B: This instruction sheet should be used in conjunction with the workshop manual and proper safety procedures followed.

Page 1 of 2

### **IMPORTANT NOTES:**

- Lift blocks are intended for original (OE) coil and leaf springs only.
- It is recommended Lift Blocks are installed by a qualified person only.
- A wheel alignment will be required directly after install.
- U bolts are to be re-checked for tightness after 100-500kms

### **INSTALL GUIDE - Front Blocks**

- Raise vehicle evenly and safely support. A 2-post hoist is best.

*Never rely on a Jack only*

- Proceed to remove wheels;
1. Loosen and disconnect upper ball joint.
  2. Loosen (only) upper inner bushings.
  2. Un-bolt swaybar links.
  3. Disconnect ABS wires.

**Note - you may have to loosen hub nut to help with strut removal/install.**

4. Remove Strut from vehicle. Place supplied Lift Block on top of strut top. Use original nuts here - depending on OE stud length you may not require supplied washers here.

5. Bolt strut back in - rotate strut 180 degrees.  
**Note - some cars do not have evenly spaced studs - the OE strut top may have to be rotated on OE spring.**

**Aluminium Lift Blocks** are machined from high quality 6061 material (with steel inserts). Designed to offer a conservative ride-height increase while maintaining OE quality ride comfort with original springs.

- Contents:** - Aluminium strut top spacer x2  
- with pressed studs and washers.
- Aluminium leaf spring spacer x2  
- with U bolts/nuts/washers

Place OE studs here (with OE nuts)

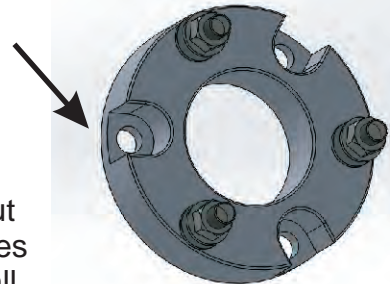

Rotate strut 180 degrees for re-install (some vehicles - rotate OE strut-top on spring so to line studs up in vehicle)



N.B: It is recommended that a licenced workshop or tradesperson carry out the above procedure and that workshop manual and relevant safety procedures are followed in addition to the above.

# Instructions

## Aluminium Lift Blocks - for 4x4 Strut-Top and Leaf Spring Vehicles

**N.B:** This instruction sheet should be used in conjunction with the workshop manual and proper safety procedures followed.

Page 2 of 2

### Continued - Rear Blocks

- Place a Jack or Jack Stand under Axle - on one side first.
- Disconnect lower bushing mount.

**Loosen all 4 U bolts, but only remove 1 side initially.**

- Proceed to un-bolt U bolts on one side. Lift vehicle up slowly. Lubrication may be required as these nuts will be tight.

Use a rag to clean surfaces between leaf and Axle.

**IMPORTANT - check the following at full droop;**

1. Brake lines.
2. Hand brake cable.
3. ABS wires.
4. Diff breather.

- Bolt together with supplied M14 U bolts nuts and washers.

- Tighten slowly and evenly - check thread length while tightening. Check U bolts are 'straight' against Axle.

- After install, road test then re-check U-bolt nuts.

**A wheel alignment is necessary immediately after install.**

- It is common for leaf spring blocks to continue to 'settle' over time. Re-check U bolts after 500-1000kms travelled.

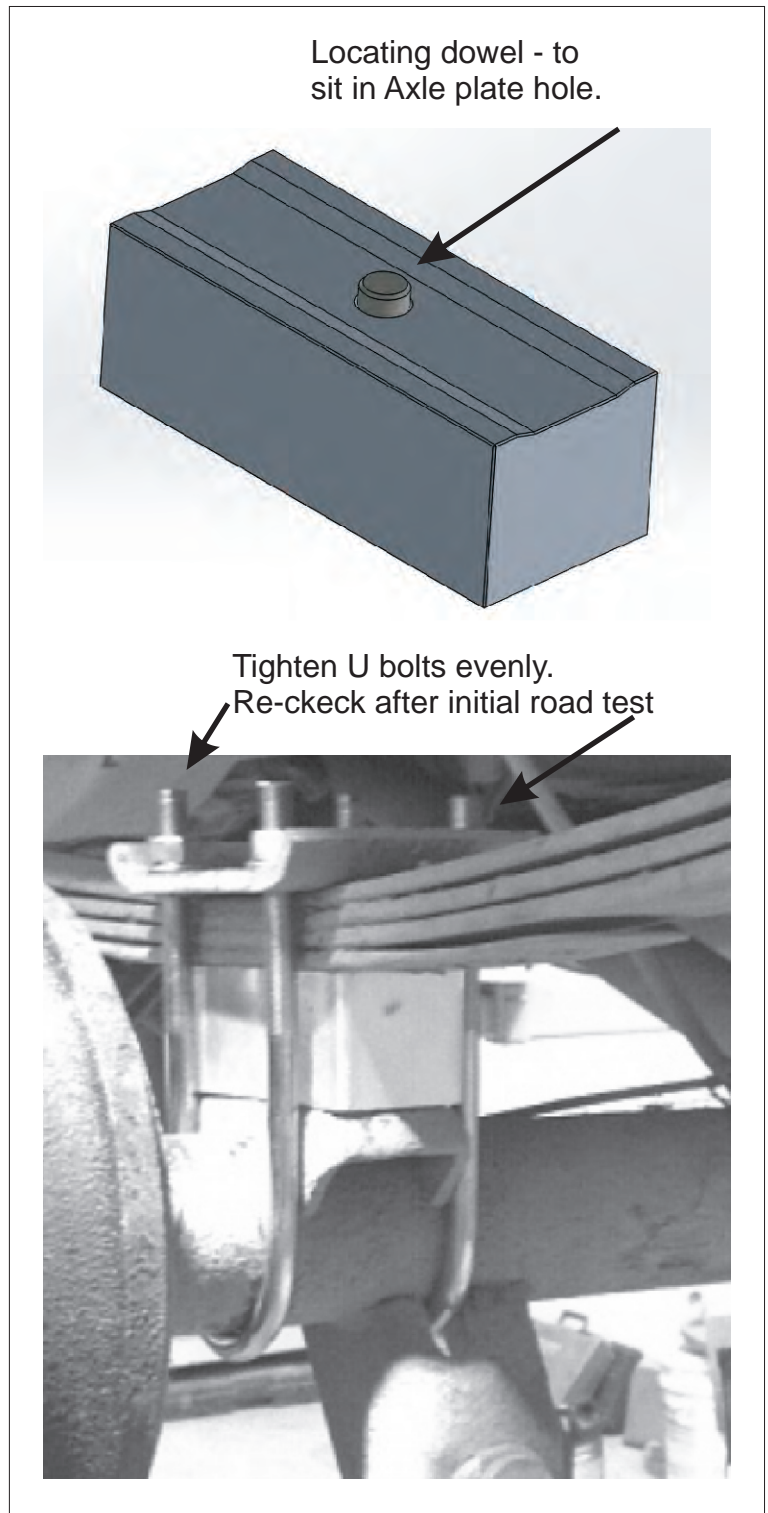

**N.B:** It is recommended that a licenced workshop or tradesperson carry out the above procedure and that workshop manual and relevant safety procedures are followed in addition to the above.

# Instructions

## Brake Line - Extension

**N.B:** This instruction sheet should be used in conjunction with the workshop manual and proper safety procedures followed.

Install Guide

**Application** - Toyota Hilux 4x4

*Always refer complete catalogue listing*

**IMPORTANT - BRAKE LINE LENGTH MUST BE ASSESSED WHEN VEHICLE IS LIFTED.**

**CHECK LENGTH WHEN VEHICLE IS JACKED UP AND WHEN AXLE IS FULLY DROPPED.**

**Contents** - Steel tube x2  
- M10 bolt x2  
- Spring washer x2

- Raise vehicle evenly and safely support.

*Never rely on a Jack only.*

- Locate brake line(s) near rear axle housing.

Depending on model - there will be 1 spacer required on Axle housing, or 2 spacers on chassis.

Discard original bolt(s).

- Tighten bolts to 21Nm

Tighten to 21Nm

Supplied Spacer



**N.B:** It is recommended that a licenced workshop or tradesperson carry out the above procedure and that workshop manual and relevant safety procedures are followed in addition to the above.