

# Fitting Instructions

## Front Control Arm Lower Bushings

Z5054A  
Rev A

### **Contents:**

- 2 x 67035 Bushes smaller diameter
- 2 x 67036 Bushes larger diameter
- 2 x Steel tubes 25.4x14.3x83
- 2 x Steel tubes 25.4x14.3x65
- 2 x Steel tubes 25.4x19.5x65
- 4 x 19.5 Inside diameter washers
- 8 x 14.2 Inside diameter washers
- 1 x Grease sachet

### **Application:**

**- Toyota Prado 120 Series & 05-On Toyota Hilux 4WD**

*Always refer to current catalogue for complete application listing.*

### **Fitting Instructions:**

These instructions are to be used in conjunction with the workshop manual, and it is recommended that all work be carried out by a qualified technician.

1. Raise and support the vehicle on chassis stands.
2. Remove the road wheels from vehicle.
3. Remove the two lower ball joint bolts.
4. Remove the shock absorber lower mounting bolt from the lower control arm.
5. Loosen the two inner lower control arm bolts from the vehicle.
6. While supporting the wheel hub assembly remove the two lower control arm bolts and arm from the vehicle.
7. Remove OE lower control arm bushes from the arm
8. Inspect the arm for damage and burrs, repair or replace as necessary.
8. Using a suitable press and press tools install the supplied bushes into the arm making sure that the larger flange width's face outward from the arm.

**Note:** Install the bushes so that the voiding is placed horizontally in the arm.

9. Apply grease supplied to bushing internal diameter and face - supplied washers are installed on the bushing face

**NOTE - select either 14.3 or 19.5mm ID steel tubes and washers for smaller bushing (depending on your vehicle bolt size)**

10. Re-install lower control arm to the vehicle and tension all bolts to manufacturers torque specifications.
11. Re-fit road wheels and settle vehicle on the ground.
12. Carry out wheel alignment immediately after install.

**Note:** It is recommended to re-tension all bolts in approx 100km's of distance travelled.

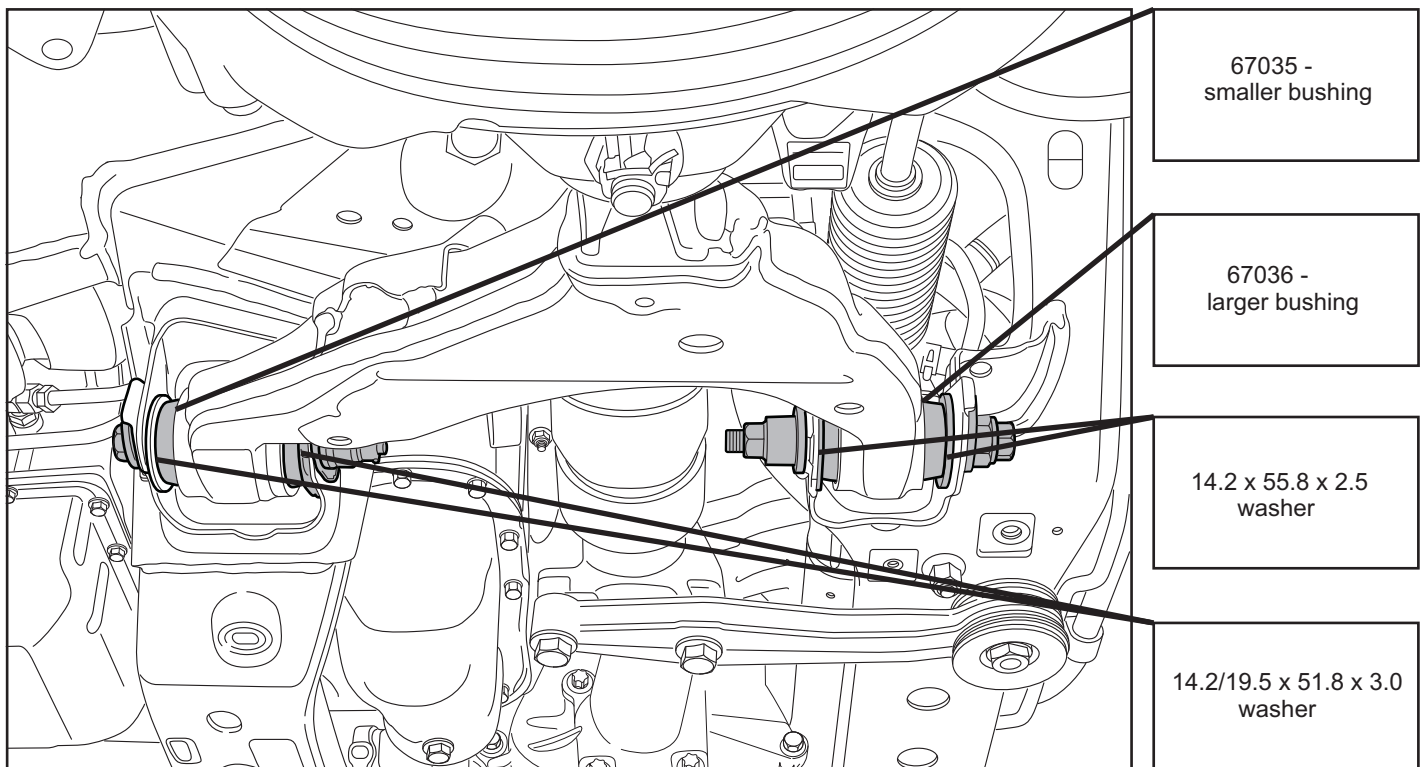

# Installation Guide

## Steering Rack Bush Kit

Suits: T oyota Prado 120 Series

Z 5079

(Always refer to the current catalogue for complete application listings)

N.B: This installation guide should be used in conjunction with the workshop manual.

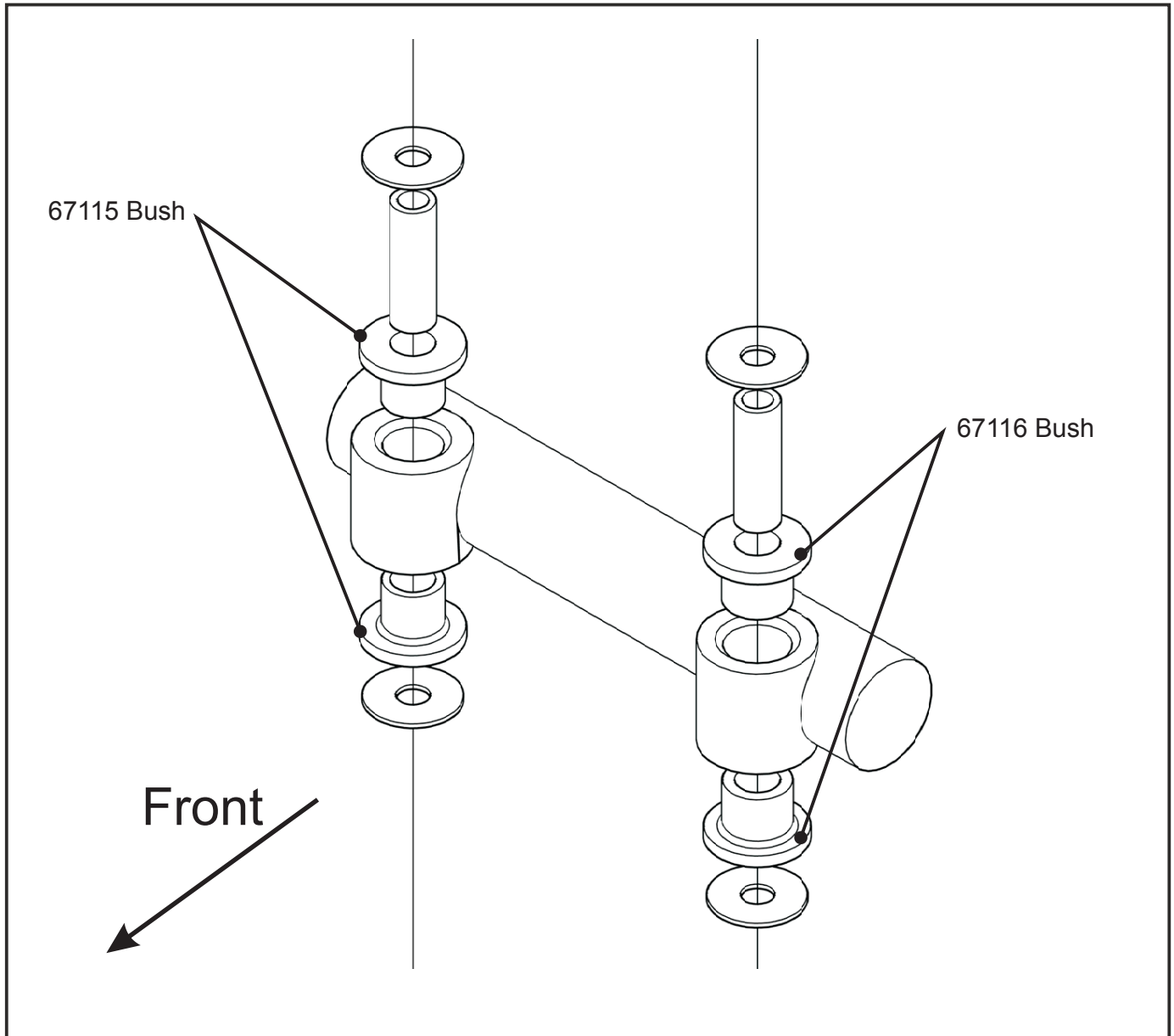

N.B: It is recommended that a licenced workshop or trades person carry out the above procedure and that workshop manual and relevant safety procedures are followed in addition to the above.

# INSTALLATION GUIDE

## FRONT UPPER CONTROL ARM BUSHINGS

Suits : TOYOTA PRADO, HILUX, FJ CRUISER. LEXUS GX470

(Always refer to the current catalogue for complete application listings).

N.B. This install guide should be used in conjunction with the workshop manual.

Note: For camber adjustment kit – wheel align vehicle and obtain specs prior to bushing removal.

### Fitting instructions

1. Raise vehicle and safely support.
2. Remove the front upper control arms.
3. Remove the OE bushings by drilling through the rubber then cutting through the outer shell.  
Clean eyelets of any dirt/grease and sharp edges.
4. Push new bushings into control arm eyelet from the outside until bonded washer is flush against eyelet.
5. Generously grease the ID and outer faces of bushings.
6. Push supplied steel tubes in position – if fitting camber adjustment kit, place offset closest to the ball joint effectively shortening the arm.
7. Re install OE retaining bolt but do not tighten until vehicle is at ride height. Tighten to OEM specifications.
8. Carry out wheel alignment. For camber adjustment kit, confirm camber/caster change and fine tune with OE adjusters on the lower arm.

Note: Tighten main retaining bolt at ride height.

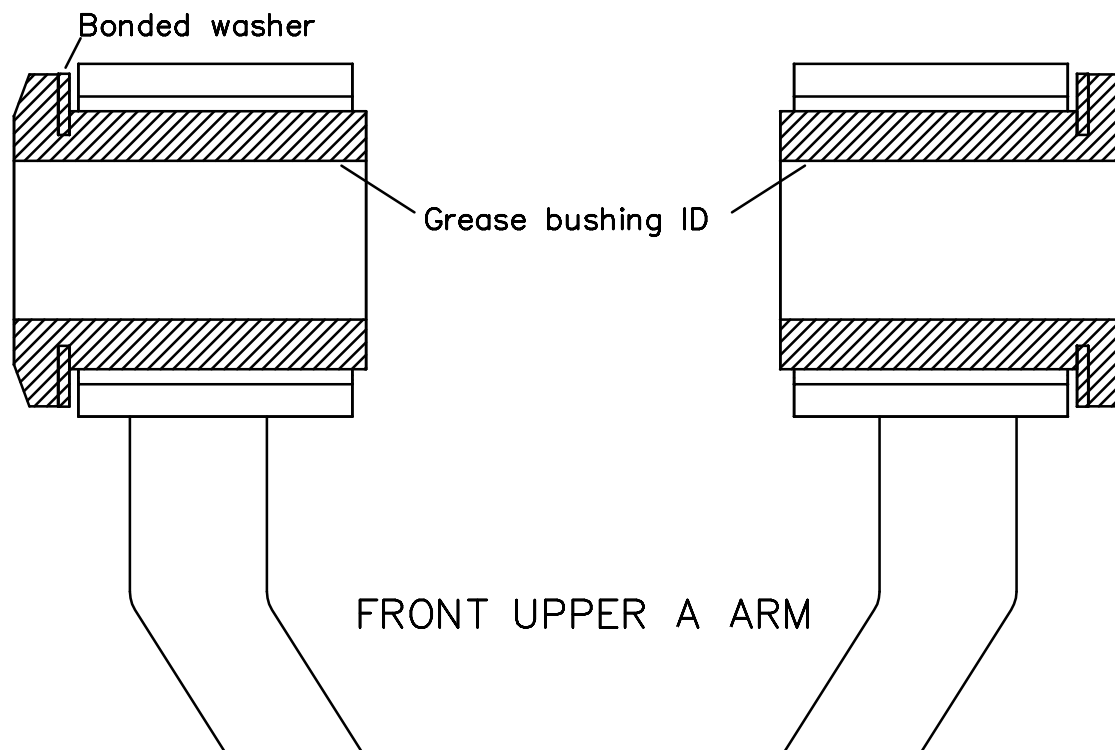

N.B. It is recommended that a licenced workshop or trades person carry out the above procedure and that workshop manual and relevant safety procedures are followed in addition to the above.