

# Installation Guide

## Rear Upper Control Arm Rear Bush

50-6263

Suits: VE Commodore

(Always refer to the current catalogue for complete application listings)

N.B: This installation guide should be used in conjunction with the workshop manual.  
All fastener torque settings should be adhered to.  
It is recommended that a wheel alignment is carried out after fitment.

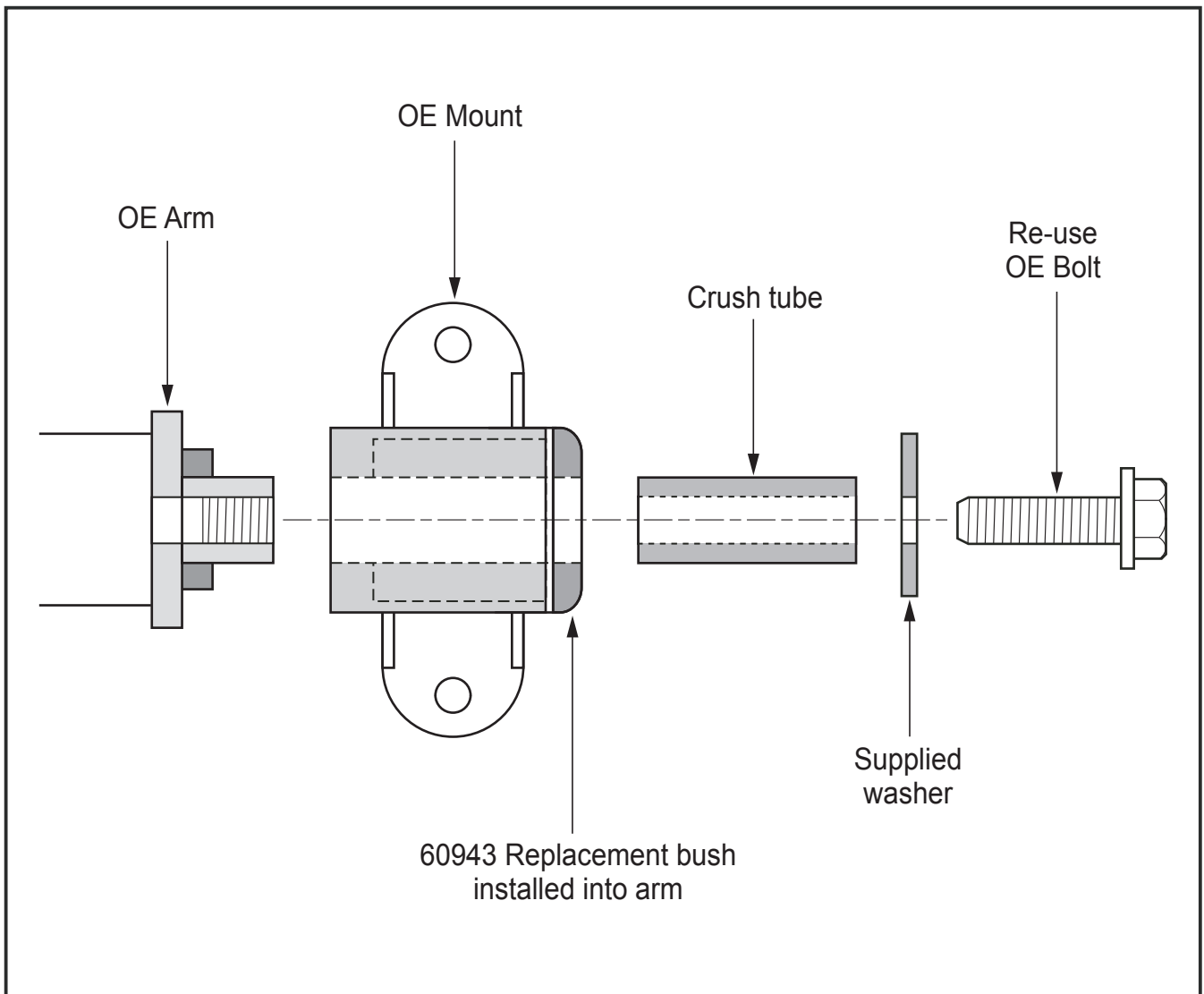

N.B: It is recommended that a licenced workshop or trades person carry out the above procedure and that workshop manual and relevant safety procedures are followed in addition to the above.