

# Installation Guide

## Front Upper Control Arm - Inner

Z5080

Suits: Pajero NH/N L 05/91 - 04/00  
Triton MK 2 & 4WD - 10/96 - 12/06  
Challenger PA 1998 - 03/07

(Always refer to the current catalogue for complete application listings)

N.B: These instructions should be used in conjunction with the workshop manual.

**NOTE: OE OUTER SHELL MUST BE REMOVED FROM EYE**

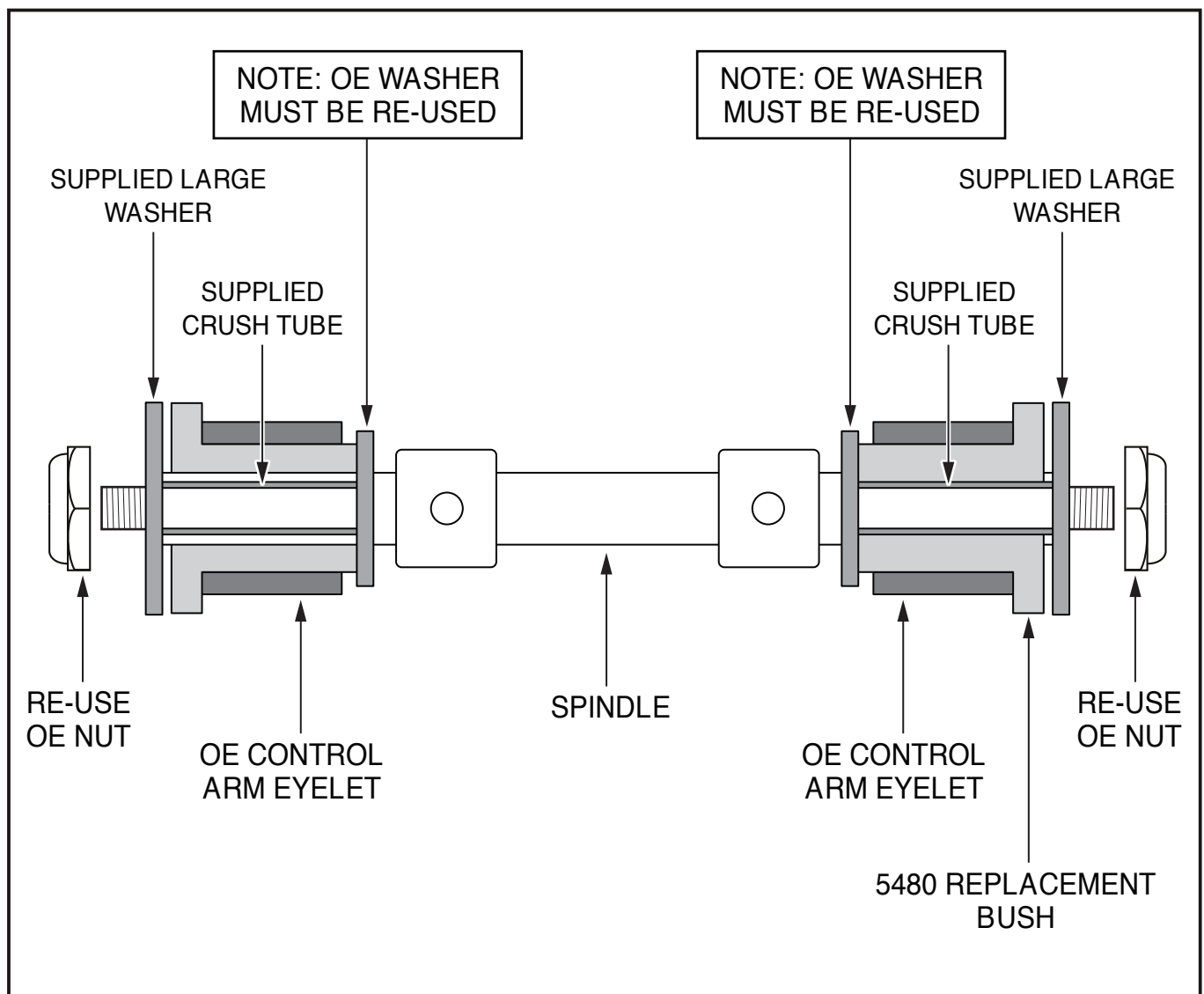

N.B: It is recommended that a licenced workshop or trades person carry out the above procedure and that workshop manual and relevant safety procedures are followed in addition to the above.