

# Instructions

## Pan-hard Rod Bushings

**N.B:** This instruction sheet should be used in conjunction with the workshop manual and proper safety procedures followed.

**Application** - Jeep Wrangler  
- 2007-2018

- Lift vehicle via Ramps or a 4-post hoist.

*(Refer current catalogue for complete listing)*

**This job is best done while vehicle is at ride height**

- Proceed to un-bolt Pan-hard Rod.
- A Press will be required to remove the original bushing  
Press out old bushing including steel outer shell.

**Contents** - Bushing 92054 x1  
- Bushing 92078 x1  
- Steel tube 22x14x40.5 x2  
- Grease

**Note** - these bushings are to suit 36/39mm size Panhard Rod internal hole diameters.  
**Refer catalogue for other sizes**

- Grease bushing internal diameter and side face with supplied grease only.

- Push in supplied tubes and re-fit Rod to vehicle.

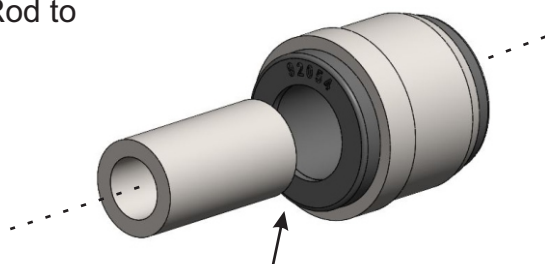

Grease bushing ID and side face



- During install of Pan-hard Rod, you may have to push the body sideways to then push bolts back in.

- Road test vehicle.
- Re-check all bolts after 100kms travelled,

**N.B:** It is recommended that a licenced workshop or tradesperson carry out the above procedure and that workshop manual and relevant safety procedures are followed in addition to the above.