

Installation Guide

FRONT UPPER CONTROL ARM BUSHINGS

Suits : TOYOTA LAND CRUISER 200 SERIES

(Always refer to the current catalogue for complete application listings).

N.B. This install guide should be used in conjunction with the workshop manual.

FITTING GUIDE – BUSHING CONFIGURATION

1. Raise vehicle and safely support.
2. Remove the front upper control arms.
3. Remove the OE bushings by drilling through the rubber then cutting through the outer shell.
4. Push bushings 67829 into control arm eyelet from inside of control arm.
5. Proceed to push bushing 67830 into eyelet from outside of arm.
6. Generously grease the ID and outer faces of bushings prior to install.
7. When re fitting the arm, place the supplied washers on inside of arm as per image.
8. Re install OE retaining bolt but do not tighten until vehicle is at ride height. Tighten to OEM specifications.

Note: Tighten main retaining bolt at ride height.

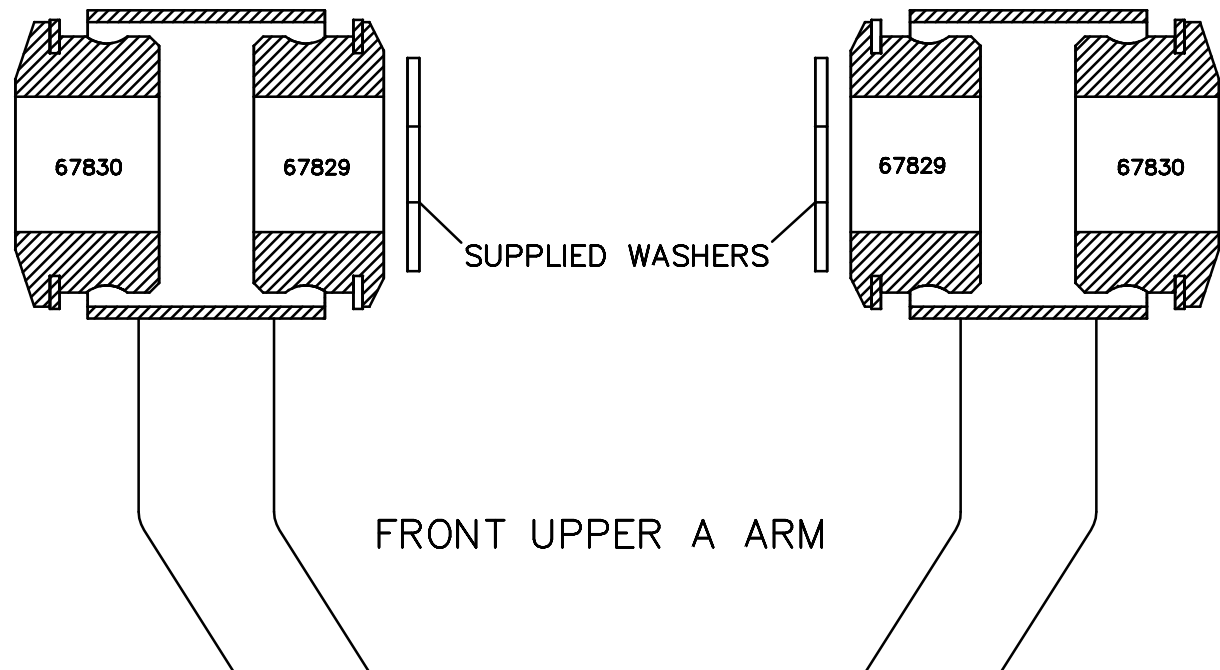

N.B. It is recommended that a licenced workshop or trades person carry out the above procedure and that workshop manual and relevant safety procedures are followed in addition to the above.

Installation Guide

Z5348

Front Strut Mount Bushing

Suits :Landcruiser IFS 11/07 – on.
:GRJ200 UZJ200 VDJ200 URJ202.

(Always refer to the current catalogue for complete application listings).
N.B.This install guide should be used in conjunction with the workshop manual.

Note: 1

Note:
Discard OE upper
rubber bush and
washer.

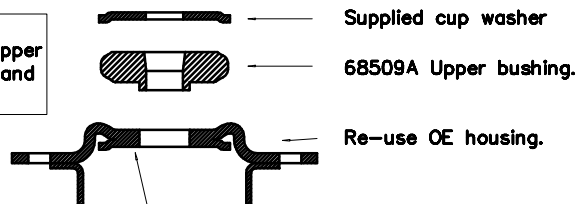

Please note: The lower OE rubber bush, if still bonded in position will need to be removed.
The mating surface will also need to be cleaned of any remaining rubber and glue deposits.

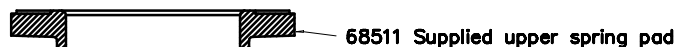

Note:
Discard OE lower
rubber bush and
washer.

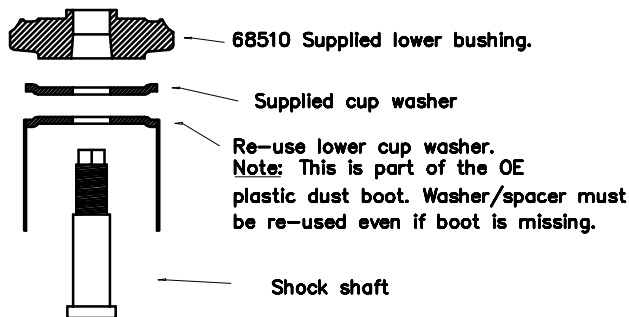

N.B. It is recommended that a licenced workshop or trades person carry out the above procedure and that workshop manual and relevant safety procedures are followed in addition to the above.

Installation Guide

Z5348

Front Strut Mount Bushing

Suits :Landcruiser IFS 11/07 – on.
:GRJ200 UZJ200 VDJ200 URJ202.

(Always refer to the current catalogue for complete application listings).
N.B.This install guide should be used in conjunction with the workshop manual.

Note: 1

Note:
Discard OE upper
rubber bush and
washer.

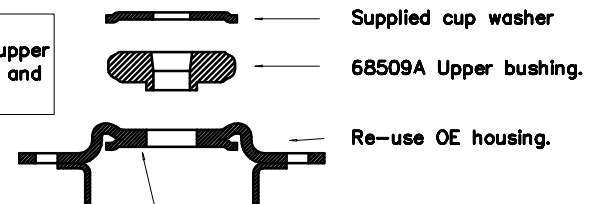

Please note: The lower OE rubber bush, if still bonded in position will need to be removed.
The mating surface will also need to be cleaned of any remaining rubber and glue deposits.

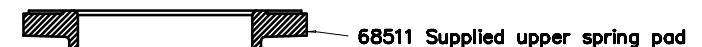

Note:
Discard OE lower
rubber bush and
washer.

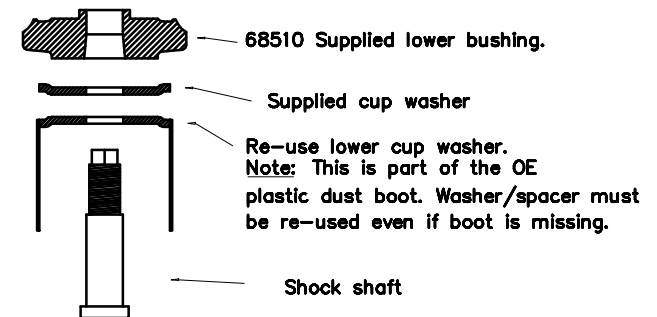

N.B. It is recommended that a licenced workshop or trades person carry out the above procedure and that workshop manual and relevant safety procedures are followed in addition to the above.

Instructions

Front Upper Control Arms

Application: Toyota Landcruiser 200 Series

N.B: This instruction sheet should be used in conjunction with the workshop manual and proper safety procedures followed.

It is recommended that a wheel alignment is performed prior to install - note current Camber/Caster settings.

1. Raise Truck evenly and safely support.
2. Remove front wheels. Proceed to unbolt ABS wire bracket on high side of arm.

Note - to remove RHS arm, you may have to loosen turbo plumbing near the upper arm bolt head.

3. Remove ball joint nut and clip - strike the hub to dis-lodge the taper.
4. loosen and remove upper arm main nut (at rear of arm).
5. Slide out main bolt towards radiator.
6. Proceed to install supplied arms - place supplied steel washers at hub on inside of bushing faces when installing main bolt.
7. Fit up ball joint and safety clip.
Also bolt up ABS bracket to existing stud.
8. Re-fit wheels and lower vehicle.

Important - A base wheel alignment must be carried out prior to test drive.

Note - you may have to 'roll the vehicle' to settle suspension and zero the Toe prior to final wheel alignment.

9. Re-check all nuts/bolts after 100kms.



Strike hub knuckle to dis-lodge ball joint.
Note - remove and re-fit safety clip.

Place supplied steel washers on inside of bushing face.
Loosen turbo plumbing on RHS.



N.B: It is recommended that a licenced workshop or tradesperson carry out the above procedure and that workshop manual and relevant safety procedures are followed in addition to the above.