

**NOTE:** Refer to Owner's Manual for maximum carrying capacity of the vehicle. Weight must NOT exceed lower value of vehicle roof or roofrack.

### STEP 1: Fitting End Support to Cross-bar

**NOTE:** Your purchased kit contains either the "Commercial Series" parts or the "Sports Series" parts. Please refer to diagrams on the right.

- Insert End Support into Cross-bar.
- Insert Nut into Bottom Slug and then slide both components into the cross-bar.
- Loosely fasten using Bolt, Spring Washer and Flat Washer. Assemble as shown in Fig.1
- Fit End Cap to each end of cross-bar.
- Do not fully tighten at this stage.

#### COMMERCIAL SERIES

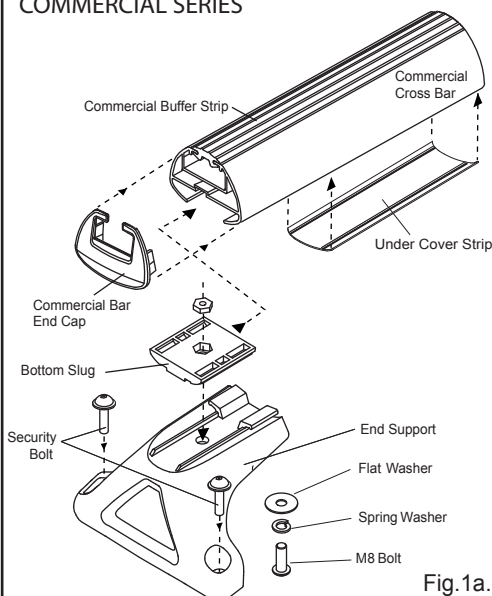

Fig.1a.

#### SPORTS SERIES

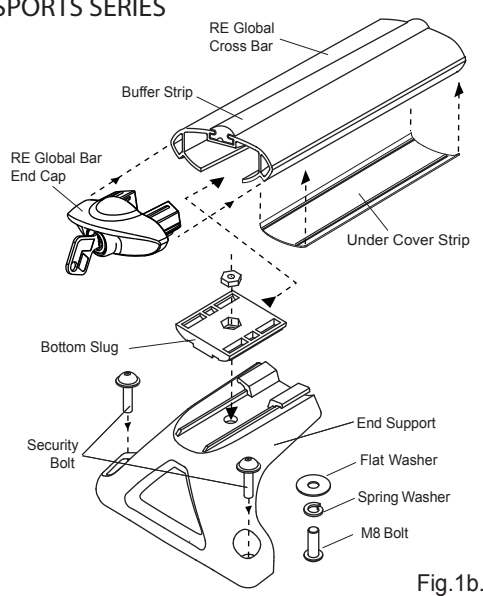

Fig.1b.

### STEP 2: Placement of Locking Straps

Locking Straps replace existing Mounting Brackets in the roof.

- Undo and remove the existing mounting brackets located in desired roofrack positions. see Fig 2a and Fig 2b.  
**NOTE:** Only remove the brackets where you wish to position your racks.
- Carefully Install the locking strap with the rubber washer and existing Toyota flanged bolt (Fig 2c). Tighten the bolts until a firm tightness is achieved.

Fig. 2a

Height adaptor kits are required in the positions shown to level the crossbar.

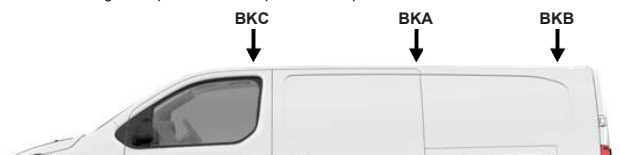

Existing mounting points are located in the roof channel.

Fig. 2b

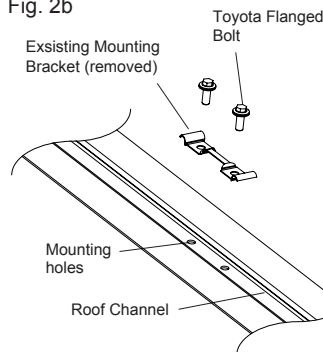
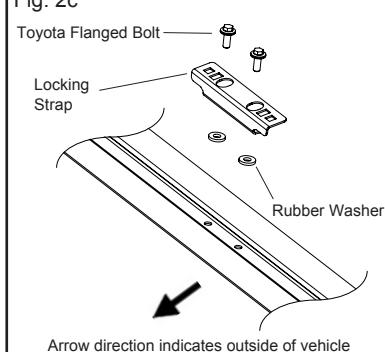

Fig. 2c



### STEP 3: Fitting Cross Bars to Vehicle.

- Place Cross Bar assembly onto appropriate Locking Straps. Loosely fit Security Bolts through End Support and engage Cage Nut. Tighten two or three turns with key supplied. Go to other side of vehicle and fit other End Support the same (Fig 3a).
- Measure equal distance (x) between end of Cross Bar and End Support on each side of vehicle to centre the cross bars (Fig 3b).
- Tighten all bolts including the End Support to Cross Bar fixing bolts assembled in Step 1.

#### Maximum carrying capacity of roofrack:

3 bars: 150 kg  
 2 bars: 100 kg  
 1 bar: 50 kg

Do not exceed vehicle manufacturers roof load rating.

Fig. 3a

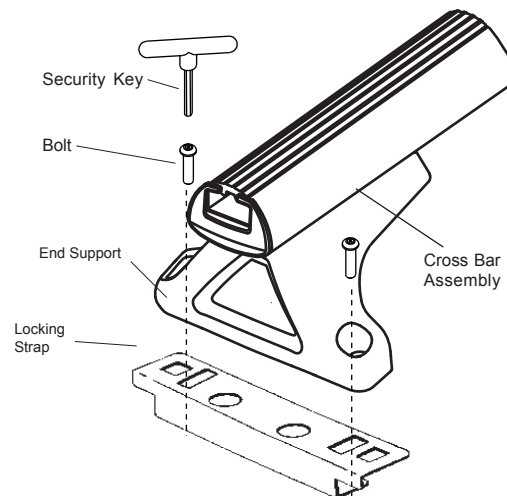

Fig. 3b

