

Product Code Number: RMEX16-2 & CRM20-2

Maximum Carrying Capacity:

Ref. Owners
Manual

REMOVABLE EXTENDED & HEAVY DUTY ROOF RACKS

STEP 1: Fitting End Support to Cross-bar

NOTE: Your purchased kit contains either the "Commercial Series" parts or the "Sports Series" parts. Please refer to diagrams on the right.

- Insert End Support into Cross-bar.
- Insert Nut into Bottom Slug and then slide both components into the cross-bar.
- Loosely fasten using Bolt, Spring Washer and Flat Washer. Assemble as shown in Fig.1
- Fit End Cap to each end of cross-bar.

COMMERCIAL SERIES

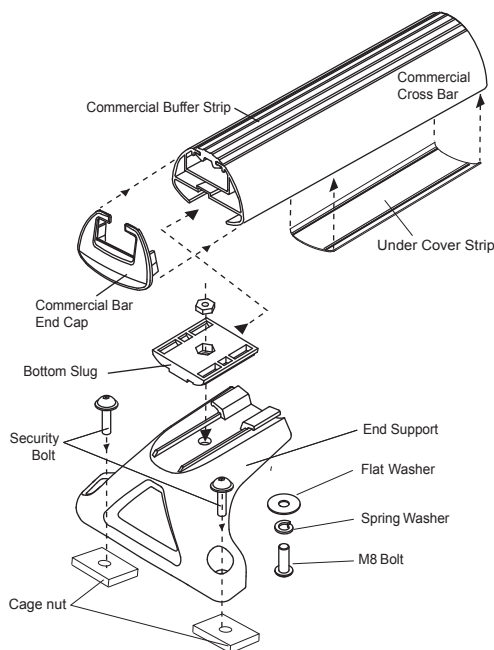

Fig.1a.

SPORTS SERIES

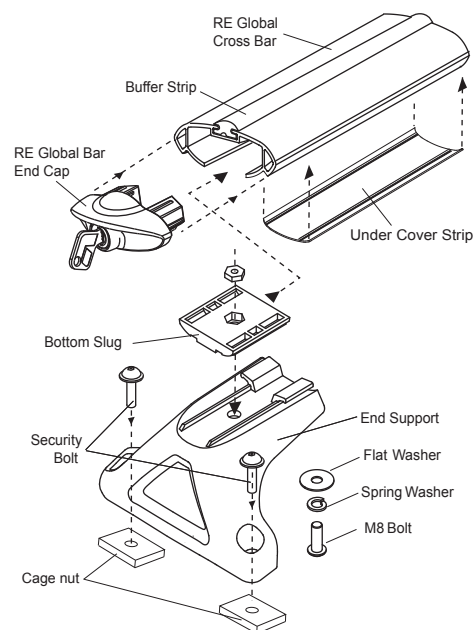

Fig.1b.

STEP 2: Fitting Wedge Block to End Support

- Fit Wedge Block to End Support.
(Orientation shown in Figures 2a & 2b.)

NOTE: The Wedge Block should clip onto End Support.

⚠ It is important that the Wedge Block be assembled in the correct orientation as shown.

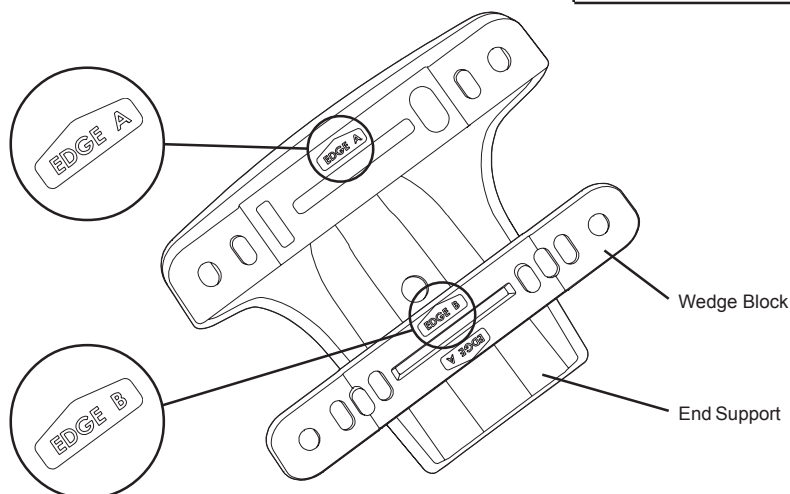
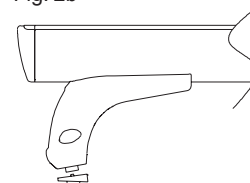

Fig. 2a

Fig. 2b



REMOVABLE EXTENDED & HEAVY DUTY ROOF RACKS

2 Cross Bar Roof Rack Fitment=80kg

STEP 2: Placement of Cross Bar Assemblies

A. Locate Roof rack assemblies along the vehicles tracks. Take caution that the End Supports are not placed above any of the access cutouts in the tracks. Refer to Fig.2a for recommended positioning.

B. Lower the Track Nuts into the track through the access cutouts located along the centre of the track. Align two Track Nuts per End Support.

Note: The Track Nuts are to be orientated with the shorter sides facing towards the front and rear of the vehicle.

C. Screw the M6x22mm Security bolts into each Track Nut (Fig.2.b). Tighten Security Bolt with Grey key provided. A firm hand tightness is adequate.

Repeat this procedure for the remaining End Supports

Fig 2a

Recommended Positioning of the Racks onto the vehicle.

Note: Dimensions are taken from the end of the track to the centre of the Cross Bar.

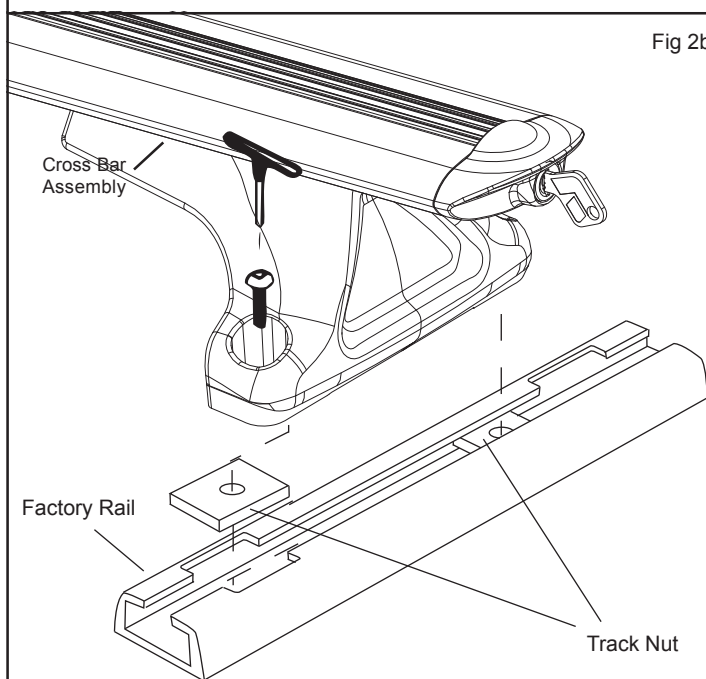
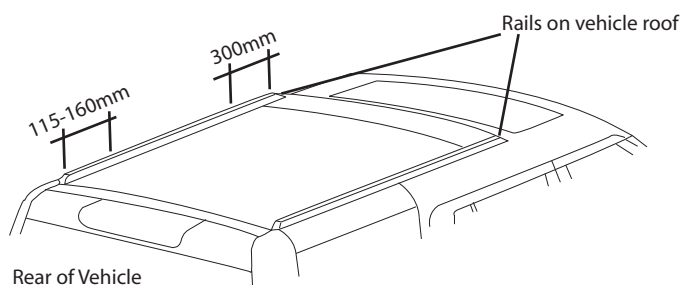

Fig 2b

STEP 3: Final check

A. Adequately tighten the M8 End Support Bolts. DO NOT over tighten. Overtightening could damage or significantly weaken the load carrying capacity of the roof rack.

B. Fit the Undercover Strip to the under side of the Cross Bar. Refer to Undercover Fitting Instructions which is packaged with the Cross Bars.

