

Kit Components

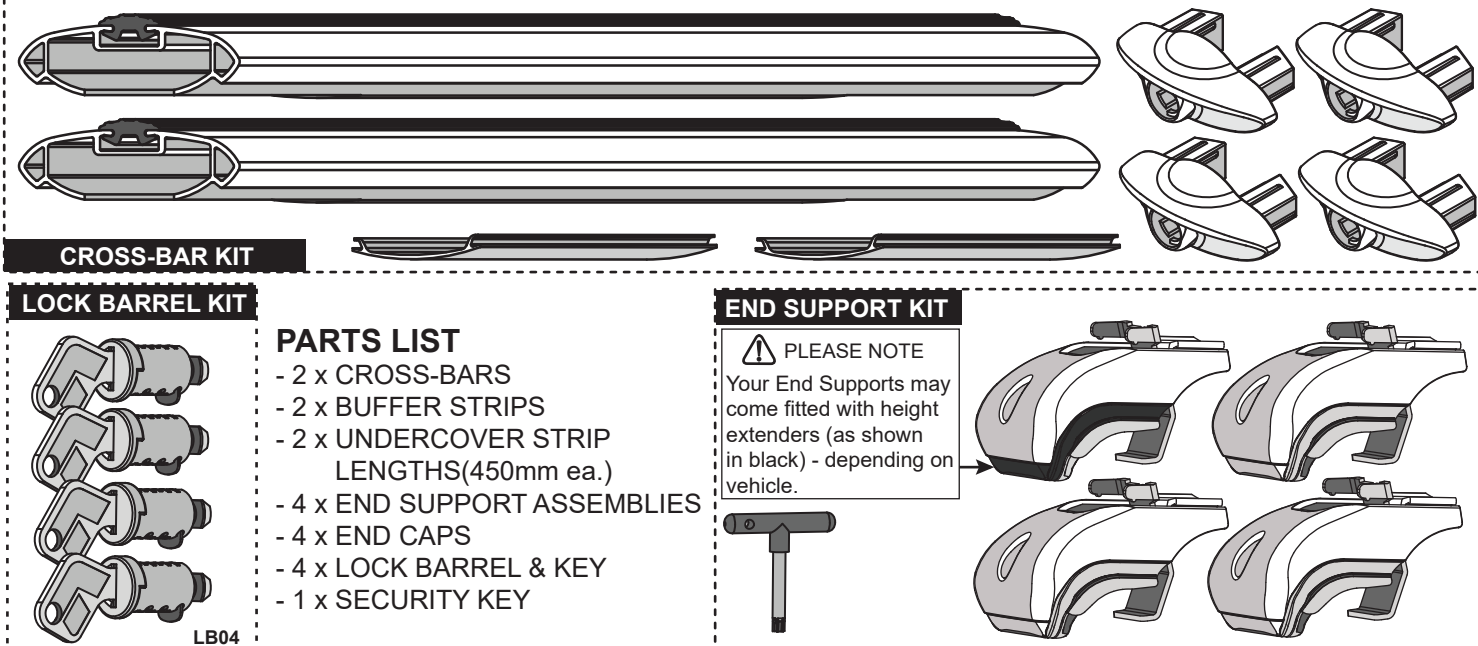

TOOLS REQUIRED: Cutting Blade, Lead Pencil, Steel Rule, Measuring Tape - Please read instructions thoroughly before commencing installation.

Fitment of Cross Bars to Vehicle

Step 1

Ensure that the roof rails are clean, free of dust and grease. Pre-assemble the End Supports into the cross-bars. Take care to avoid your hand coming into contact with any sharp edges.

Remove all end-caps from crossbars to allow access for assembly of parts.

Slide the end Support along to the desired position approximating its fixed position on the vehicle's rails. (Fig. 1). Strap is to be held extended to allow the end support to be located onto the rail bars (Fig. 2).

Fig. 1

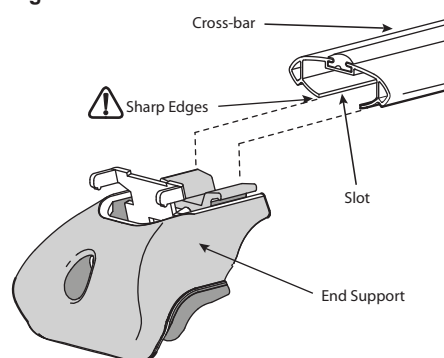
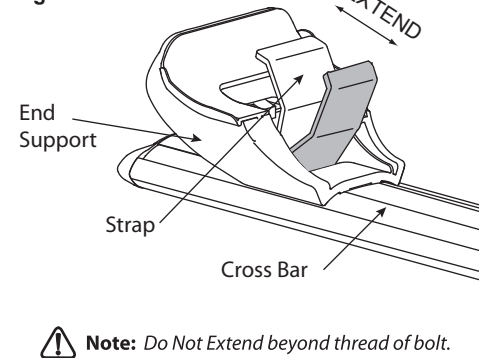

Fig. 2



Step 2

Use a measuring tape to locate the front cross bar 200mm forward of the B-Pillar and the rear crossbar 800mm rear of the B-Pillar (Fig. 3). This allows clearance for the sunroof. Double check sunroof clearance before clamping on rail.

If your vehicle does not have a sunroof, you may install the roof rack in a different position on the rail with a minimum distance of 700mm between each crossbar.

Place the Cross-bar onto the vehicle rail as shown in figure 4.

Ensure the end support is engaged under the rail and the over-hang of the cross-bars is even on both sides denoted by (X) in (Fig.5).

With the End Supports and Cross-bar located on the rails, mark out the End Support position on the Cross-bar. This marked position will indicate the required cut length of Undercover Strip (A). (Also refer to Fig. 7).

Remove cross-bars from the vehicle.

Fig. 3

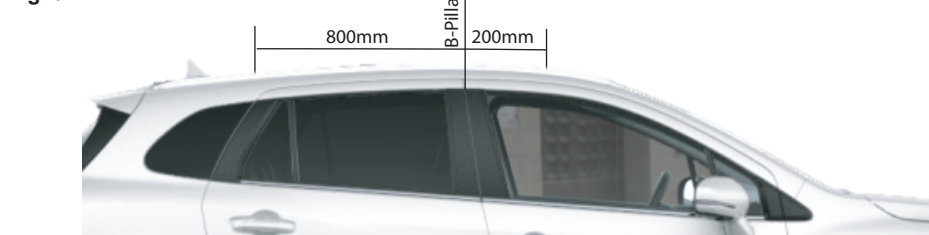

Fig. 4

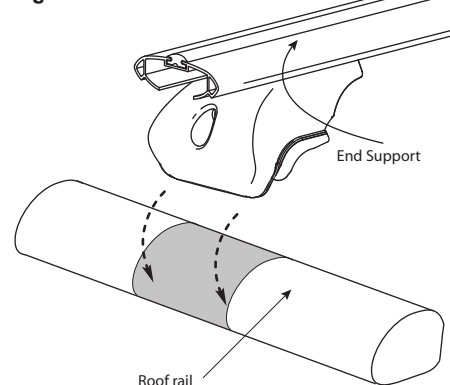
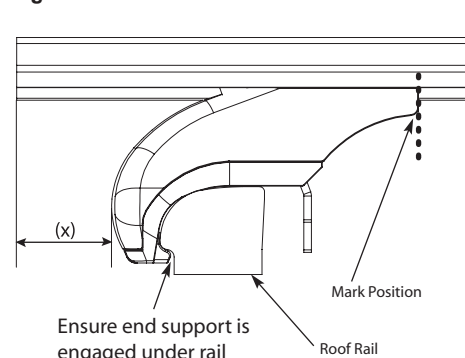

Fig. 5



Fitment of Cross Bars to Vehicle

Step 4

With the cross-bars removed, line up the undercover strip with the cut-out on the cross-bar. Ensuring the 'Strip edge' and the 'crossbar cut-out edge' are aligned, mark the strip with a line that corresponds to the line you marked on the crossbar, as instructed in Step 2 of page 1. Using a Rule and a Blade, score a straight line and snap off this piece from the length of Undercover Strip. This becomes Cut Length (A) as shown in (Fig. 6). Slide (A) as far in as possible. Do this for all four (A) strips. Insert all four End Supports and using the remaining Undercover Strip, insert into the remainder of the crossbar cut-out until fully covered. Cut to edge of crossbar all four (B) strips as shown in (Fig. 7).

Fig. 6

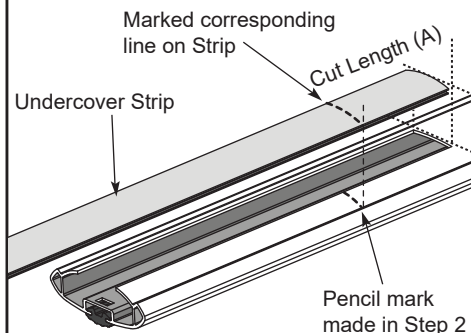
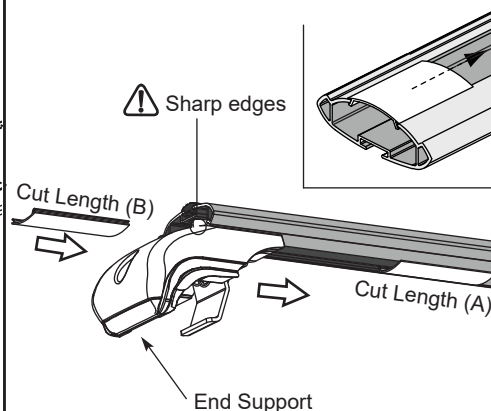

Fig. 7



Step 5

Fully insert the key into the Lock Barrel and remove the clear plastic tubing covering the Lock Barrel. (Fig. 8) Pull the Key back out of the Lock Barrel approximately 3mm. With the key in this position, depress the last large Metal Wafer before fully re-inserting the key. You may now release your finger from the metal wafer (Fig. 9). Ensure that all the Metal Wafers are now contained within the cylinder of the Lock Barrel.

Fig. 8

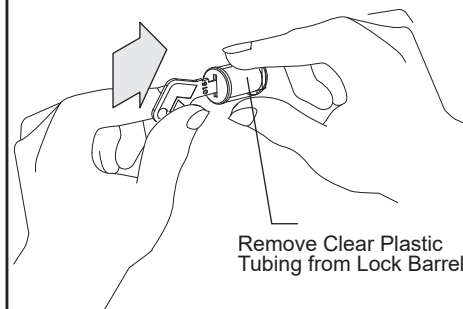
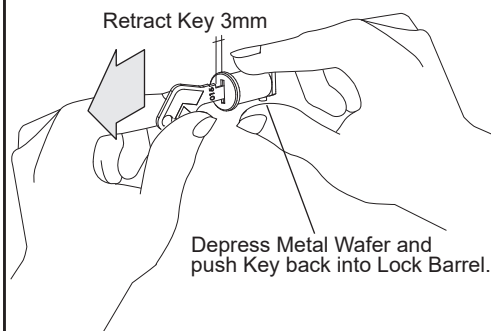

Fig. 9



Step 6

Using your thumb and forefinger, insert the Key and Lock Barrel assembly into the Lock Cavity until the Lock barrel is fully inserted (Fig. 10). Place your finger against the face of the Lock Barrel (to prevent it from being pulled out of the Lock Cavity), then remove the key with your other hand. If the key cannot be pulled out, then rotate the Lock slightly (with Key) and pull on the key GENTLY until the Key can be removed (Fig. 11).

Fig. 10

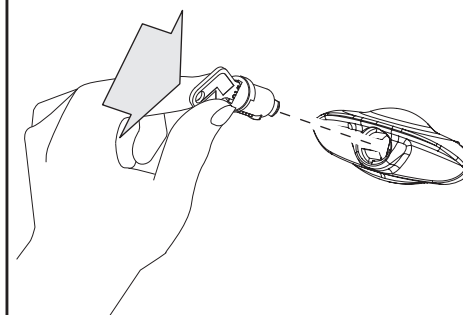
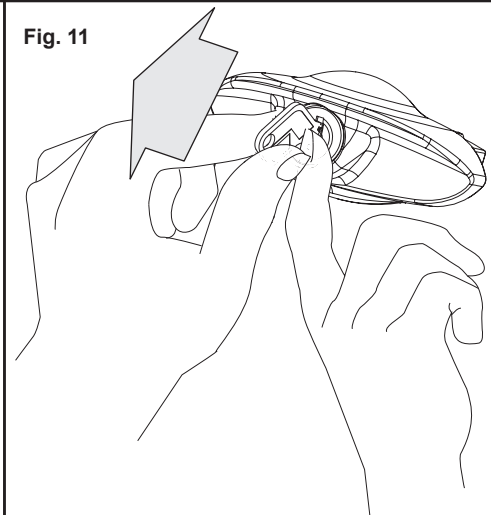

Fig. 11



Step 7

Record Key code numbers so replacement keys can be supplied in case they are misplaced.

Fig. 12

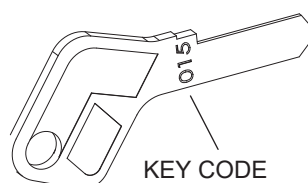

Fitment of Cross Bars to Vehicle

Step 9

Pull back the buffer strip to allow access to the end of the cross-bar. Insert Endcap into the Cross-bar by locating the two 'feet' of the Endcap into the void inside the cross-bar (Fig. 13). Push through until End-cap edge comes to rest against the edge of the cross-bar. This is important as the Locking Actuator inside the Endcap has to locate within the Locking slot on the end of the cross-bar (Fig. 14).

Fig. 13

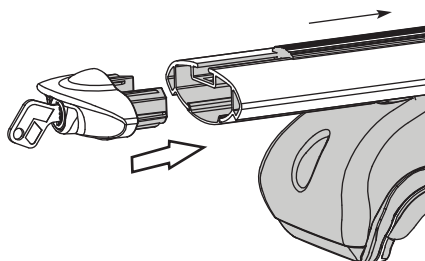
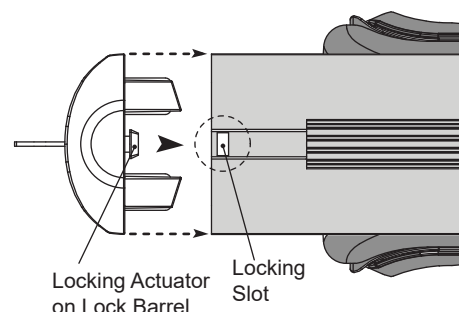

Fig. 14



Step 10

Place the assembled Roof-racks back onto the vehicle's rails in the same position as initially measured (Fig. 15).

Ensure that both bars are parallel and square to the front and rear axis of the vehicle and that the metal straps have located correctly against the rails ensuring the end support is engaged under the rail (Fig 16.)

Using the Security Key provided, proceed to tighten the bolts whilst alternating sides to ensure even tension is achieved across the bars (Fig. 16).

Fig. 15

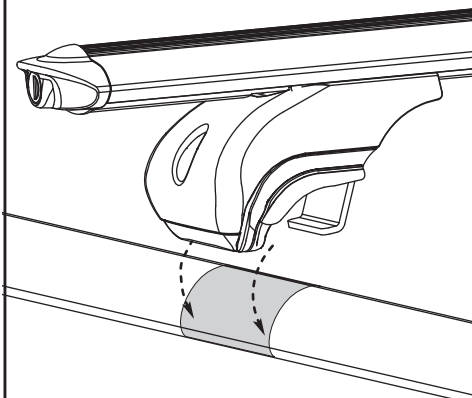
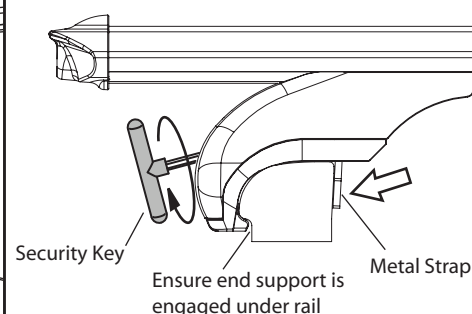

Fig. 16



Tip: To ensure robust attachment, turn screw through 4-5 full revolutions after achieving a snug condition between the End Support & Inner Strap against the Rail bar (ie. 4-5 turns after eliminating all free-play in system)

Final Check

After loading the roof-racks, check the tightness of all bolts and ensure that the metal straps are positively engaged and tight up against the vehicle's rails.

Ensure the Endcap is locked against the Cross-bar by turning the key 90° anti-clockwise to the locked position (Fig.17).

Store the keys in a safe location, for example, car key chain or Glove compartment of vehicle.

Fig. 17

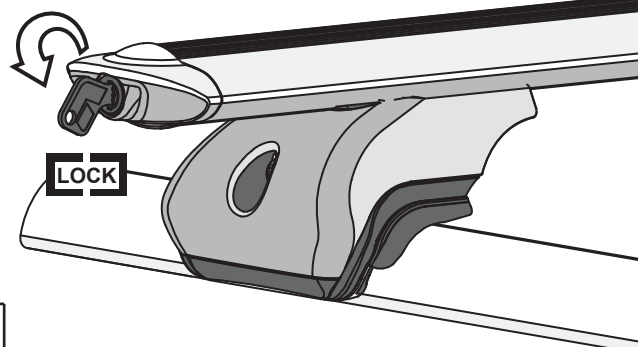

Unlocked



Locked

Care For Your Roof Rack

IMPORTANT - Please Read Thoroughly Before Use.

Please ensure that Roof Racks are fitted in accordance with the Fitting Instructions. It is important that you observe all recommendations outlined below.

Safe Usage

It is essential for the proper assembly, operation and use of the Roof Rack that the instructions and safety precautions supplied are strictly observed.

Loads should be evenly distributed across the cross bar length and width. Always ensure that the load has a low centre of gravity. Fasten the load securely against sliding and check regularly for correct positioning.

The Roof Rack and roof load must not project beyond the body of the carrying vehicle. The load must not extend beyond the sides of the Roof Bars. Long loads should be positioned centrally on the Roof Rack and securely fastened at the front and at the rear. Narrow and heavy loads should be carried as close to the end supports as possible. It is your responsibility to comply with statutory requirements regarding the projection of your load.

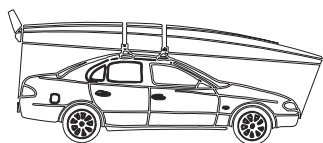

Ensure load is sufficiently secured with straps.

Do not use elasticised or "occy" straps.

Do not use damaged or frayed straps.

Use separate tie downs for each Roof Rack.

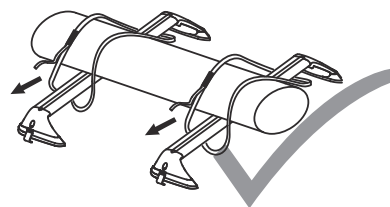
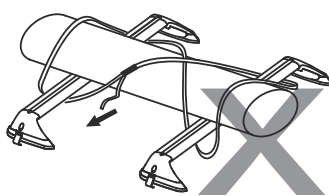

Check the security of your load and the tension of the bolts and fastenings of the Roof Rack before departing and at regular intervals during your journey.

A specialised Roof Rack accessory should be used to carry or secure your load when available (eg, Bike Carrier, Water Craft Carrier).

The maximum permissible load for your vehicle Roof Rack is the lower of the maximum load capacity specified in your vehicle operation manual, or specified as applying to the Roof Rack. Do not exceed the maximum specified load capacity.

Maximum permissible load = weight of the Roof Rack + weight of accessories + weight of load (cargo).

The mounted & loaded Roof Rack will affect your vehicle's handling characteristics, particularly relating to crosswind sensitivity, corners, bends and braking behaviour. Exercise care when driving and adjust for the change in vehicle handling and braking behaviour by always driving safely and at a speed appropriate to travel conditions and the load being carried.

Wind resistance is the number one cause of Roof Rack failures. Prior to securing a load, consider the surface area of the load to determine the suitability of carrying the load on the Roof Racks. Extra caution should be taken when travelling in high winds, at high speed, or when carrying loads with large surface areas (eg tables, bed bases and mattresses, sheets of wood).

Surfboards should be loaded on top of each other rather than side by side.

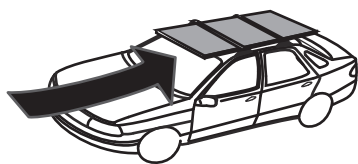

Maintenance

The Roof Rack should be removed regularly to clean adjoining vehicle surfaces, attaching locations and the Roof Rack itself. It is your responsibility to ensure that the Roof Rack is adequately maintained.

You should routinely and regularly check the proper functioning of your Roof Racks, and tighten all screws, bolts, connections and straps. Immediately replace any worn or damaged components.

Remove Roof Rack before entering an automatic carwash.

When not used to carry load, the roof-rack should be removed. This will also increase fuel efficiency when not in use.

We recommend that you store the Roof Rack Security Key and Fitting Instructions in the glove compartment of your vehicle.