

NOTE: Refer to Owner's Manual for maximum carrying capacity of the vehicle. Weight must NOT exceed lower value.

STEP 1: Fitting End Support to Cross-bar

NOTE: Your purchased kit contains either the "Commercial Series" parts or the "Sports Series" parts. Please refer to diagrams on the right.

- Insert End Support into Cross-bar.
- Insert Nut into Bottom Slug and then slide both components into the cross-bar.
- Loosely fasten using Bolt, Spring Washer and Flat Washer. Assemble as shown in Fig.1
- Fit End Cap to each end of cross-bar.
- Do not fully tighten at this stage.

COMMERCIAL SERIES

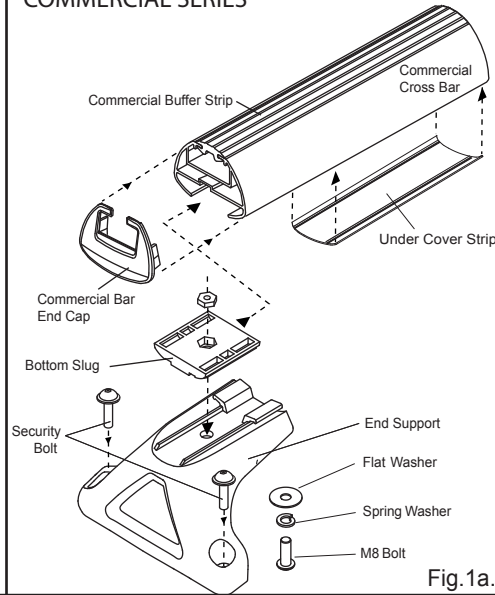

Fig.1a.

SPORTS SERIES

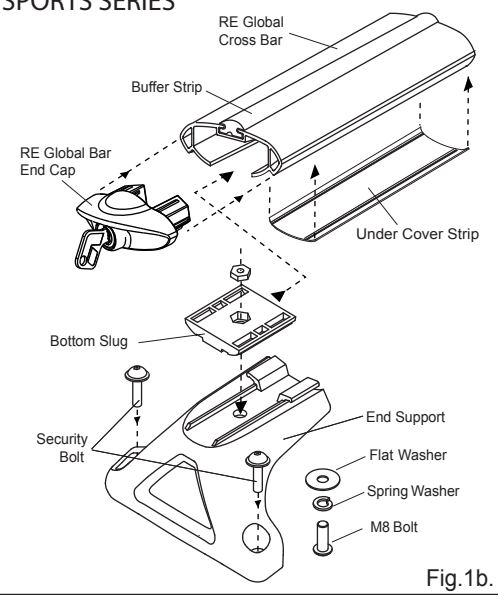

Fig.1b.

STEP 2: Placement of Locking Straps

- Carefully remove Rail Covers from roof (Fig 2a). Located in the recess are the Anchoring Points.

NOTE: Take care when removing Rail Covers to avoid damaging Rail Cover Clips. Covers can not be replaced while rack is fitted. Store covers in a safe place. ie Glove Compartment.

- Fit the short M6 x 16mm Bolts through the Mounting Straps and into the Anchor Points, tighten with security key through the top access holes on the Mounting Strap. (Fig 2b)

NOTE: Before installing the Mounting Straps, it is advisable to screw the Bolts in and out of the Anchor Points to clean the threads.

- A **Firm** hand tightness using key is adequate.

STEP 3: Fitting Cross Bars to Vehicle.

- Place Cross Bar Assembly onto appropriate Locking Straps. Loosely fit Special Bolts through End Support and engage Cage Nut. Tighten two or three turns with key supplied. Go to other side of vehicle and fit other End Support the same. (Fig3b).
- Measure equal distance (x) between end of Cross Bar and End Support on each side of vehicle. (Fig 3a)
- Tighten all bolts including the End Support to Cross Bar fixing bolts assembled in Step 1.

Fig. 2a

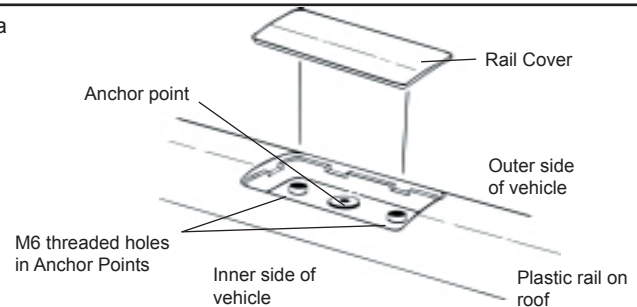

Fig. 2b

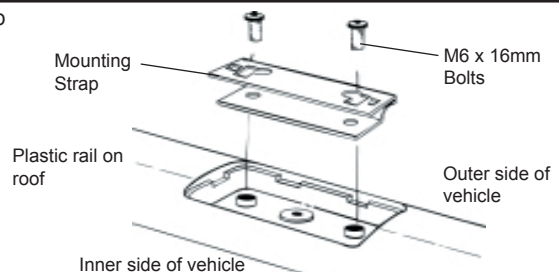

Fig. 3a

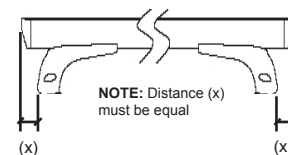

Fig. 3b

