

LoadMax® Universal Roof Rack Support System

by **ROLA**®



The installation kit contains sufficient components for fitment. Do not substitute any components.
A high degree of technical competence is necessary to correctly install this product.

Installation time - Experienced 60 mins.
Novice - 120 mins.

INTERNATIONAL PATENTS APPLIED AND PENDING.



WARNINGS

- THE TESTED CAPACITY OF THIS PART SUBSTANTIALLY EXCEEDS THE MAXIMUM LOAD CAPABILITY OF THE VEHICLES BODY TUB & THE SAFE OPERATING LIMITS OF THE VEHICLE. WE RECOMMEND THAT YOU NEVER EXCEED EITHER THE MAXIMUM BODY TUB LOAD OR THE SAFE OPERATING ROOF LOAD IDENTIFIED BY THE VEHICLE/CANOPY MANUFACTURER.
(FAILURE TO DO SO COULD RESULT IN VEHICLE DAMAGE, PERSONAL INJURY OR EVEN DEATH).
- FITTING INSTRUCTIONS MUST BE OBSERVED AT ALL TIMES.
- FAILURE TO OBSERVE THESE INSTRUCTIONS MAY VOID PRODUCT WARRANTY.
- RECOMMENDED FOR USE WITH ALL ROLA ROOF RACK SYSTEMS.
- SYSTEM NOT DESIGNED OR TESTED TO PERFORM AS A ROLL OVER PROTECTION SYSTEM (ROPS) OR CARGO TIE OFF POINT.
- LOAD MUST BE SECURELY FASTENED & CENTRALLY POSITIONED TO COMPLY WITH THE SYSTEM'S FUNCTIONALITY.
- PERIODICALLY CHECK ALL FASTENERS & TIGHTEN WHERE REQUIRED. IF DAMAGED, CORRODED OR INVOLVED IN AN ACCIDENT, AFFECTED COMPONENTS SHOULD BE REPLACED.
- DO NOT MODIFY THE LoadMax® ROOF RACK SUPPORT SYSTEM IN ANY WAY UNLESS SPECIFIED.
- MODIFICATIONS TO THE LoadMax® ROOF RACK SUPPORT SYSTEM MAY VOID THE LOAD RATING AND WARRANTY.
- WHERE HIGH TENSILE THREADED FASTENERS ARE USED, THE LoadMax® ROOF RACK SUPPORT SYSTEM MUST BE INSTALLED USING THE SIZE AND GRADE FASTENERS SPECIFIED BY ROLA.

TOOLS REQUIRED

- Socket Wrench
- Metric Hex Sockets
- Metric Spanners
- Torque Wrench
- Hex Drive Bits
- Straight Edge - Approx. 1200mm
- Power Drill
- Ø5mm Drill Bit
- Ø16mm Fine Tooth Hole Saw
- Metal Cutting Saw*
- Drill Stops
- Steel Rule/Tape Measure
- Marker Pen
- Masking Tape
- Raised Work Platform
- Soldering Iron or Similar (round)
- Silicon Sealant
- Vacuum Cleaner

*only if required in step 12.

FASTENER TORQUES

| Fastener size | Fastener class | Recommended torque |
|---------------|----------------|--------------------|
| M8 x 1.25 | 8.8 | 22 Nm |
| M10 x 1.5 | 8.8 | 44 Nm |

Read this full instruction prior to commencing assembly and fitment of the R-LMU-01.
Check contents of kit before commencing fitment and report any discrepancies or damage.

CONTENT - CHECK ALL PARTS ARE CORRECT BEFORE PROCEEDING

| Item | Component Name | Part No. | Qty | Parts list (4 units) |
|------|--|----------|-----|---|
| 1 | Clamp - Formed, Part A, Lower | 753546 | 4 |  1 |
| 2 | Clamp - Formed, Part B, Lower | 753548 | 4 | |
| 3 | Clamp ASM - Part A, Upper | 753553 | 4 | |
| 4 | Clamp ASM - Part B, Upper | 753555 | 4 | |
| 5 | Bracket ASM | 753556 | 4 | |
| 6 | Bracket - Formed | 753551 | 4 | |
| 7 | Double Threaded Spacer - M12 x M8 x 58 | 753557 | 8 | |
| 8 | Hex Nut - M12 x 1.25 ZP | 922256 | 8 | |
| 9 | Plastic Tube Enclosure | 904731 | 8 | |
| 10 | Roof Sealing Gasket | 904209 | 4 | |
| 11 | Button Hd. Socket Screw - M8 x 16mm ZP | 913140 | 8 | |
| 12 | Button Hd. Socket Screw - M8 x 60mm ZP | 913141 | 16 | |
| 13 | Washer - Flat, 8mm ZP | 932085 | 8 | |
| 14 | Washer - Spring, 8mm ZP | 932030 | 24 | |
| 15 | Flat Washer - 10mm ZP | 932005 | 8 | |
| 16 | Washer - Spring, 10mm ZP | 932010 | 8 | |
| 17 | Washer - Internal Tooth, 8mm ZP | 932195 | 8 | |
| 18 | Hex Nut - Domed Cap, M8 CP | 922261 | 8 | |
| 19 | Hex Nut - Domed Cap, M10 CP | 922260 | 8 | |
| 20 | Screw - Self Tapping | 912610 | 16 | |
| 21 | Angled Tub Rail Adaptor - Plastic | 904208 | 8 | |
| 22 | Support Tube | 505506 | 4 | |
| 23 | Support Clamp | 753570 | 4 | |
| 24 | Clamping Bracket ASM | 753572 | 4 | |
| 25 | Warning Label - Adhesive (not shown) | 907659 | 1 | |

Note: Items 22, 23 & 24 shown at a reduced scale

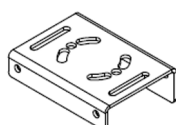
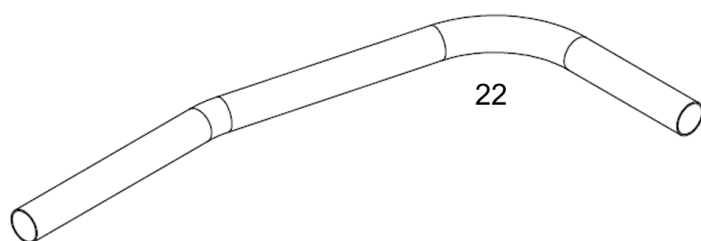

23

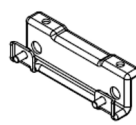

24



20



21

LoadMax® PRODUCT OVERVIEW

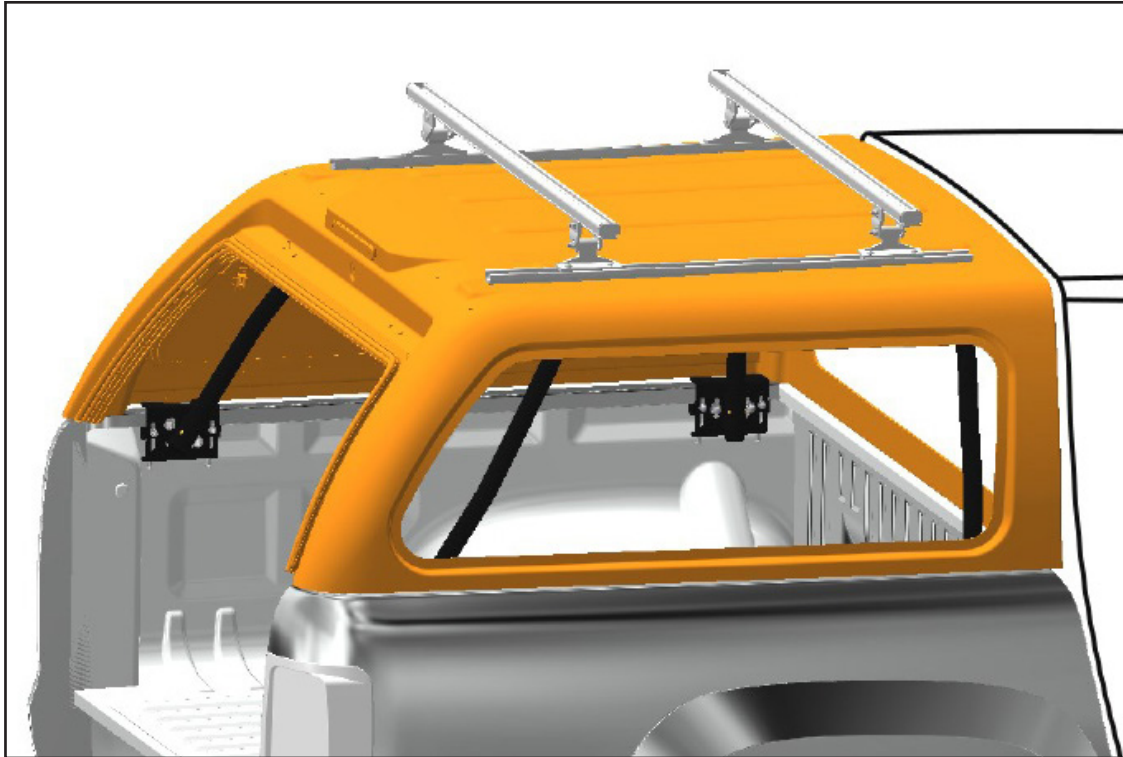

LoadMax® roof rack support system shown with Milford EcoRack® mounting channels and cross bars.

LoadMax® SUPPORT ASSEMBLY (1 unit)

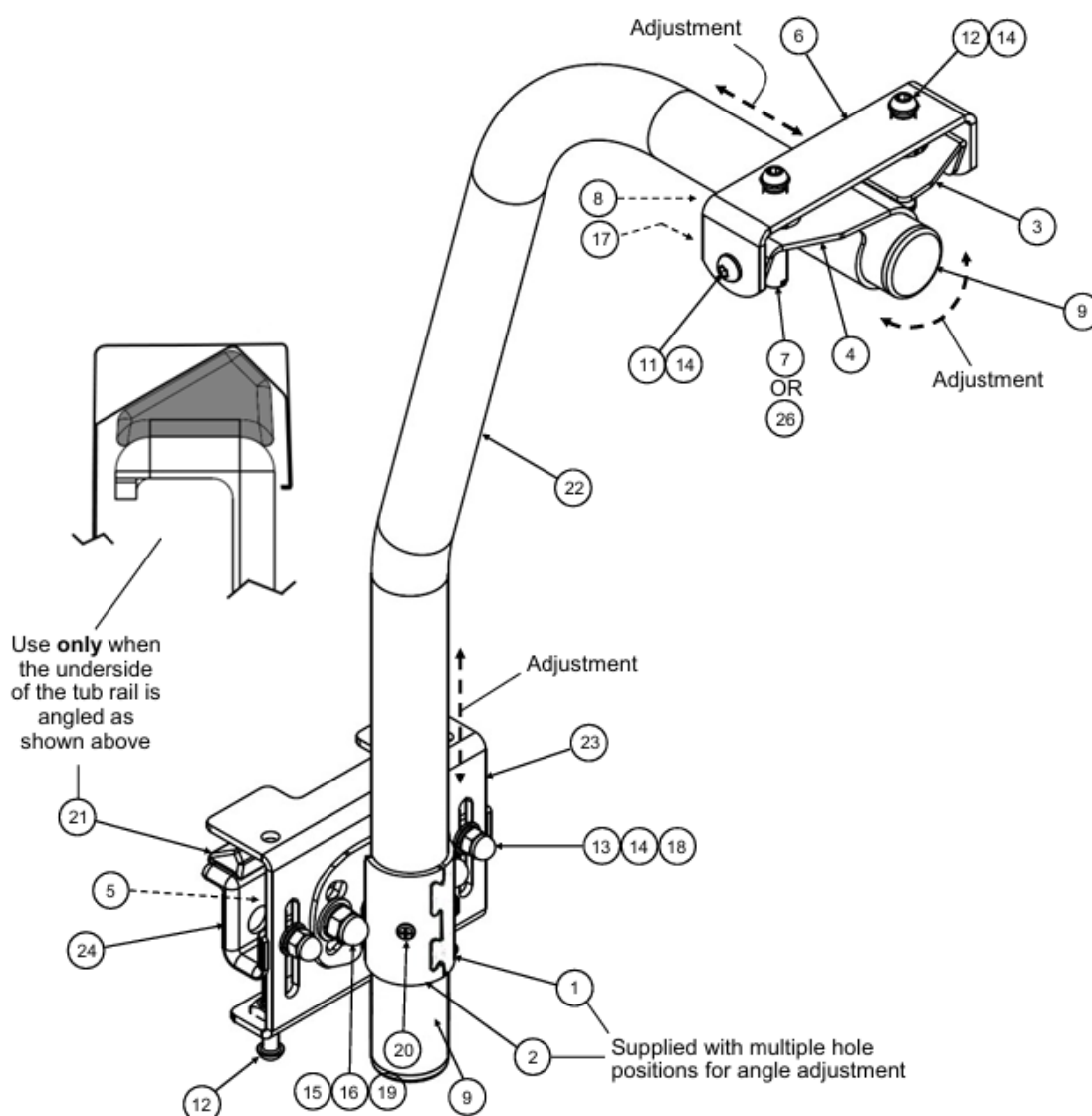

ADVICE TO FITTERS



Note: To fit the roof rack support system & cross bar system the following is essential:

- ☐ Always drill perpendicular to surface (Unless stated otherwise).
- ☐ A positive drill stop should always be used to prevent accidental damage to hidden panels etc.
- ☐ Ensure Safety Eye Protection and Gloves are worn as required when using cutting tools.
- ☐ Check screws in relevant components by hand before installation. Should there be resistance re-tap threads and re-check.

CARE SHOULD BE TAKEN NOT TO CROSS THREAD THE FASTENERS DURING INSTALLATION OF COMPONENTS TO THE VEHICLE. ALL FASTENERS SHOULD BE TIGHTENED TO THE RECOMMENDED TORQUES.

ASSEMBLY OF THE LoadMax® SUPPORTS

1

- Link the clamps (1 & 2) together as shown with the dove tails interlocked.
- Loosely secure the clamp ASM to the support clamp (23) as shown.

Note: The clamp assembly is shown in the straight up and down position. This is the usual position for the front canopy supports. The rear supports should be angled to suit the angle of the canopy at the rear. (LHS/RHS)
The angle will normally be established in the vehicle.

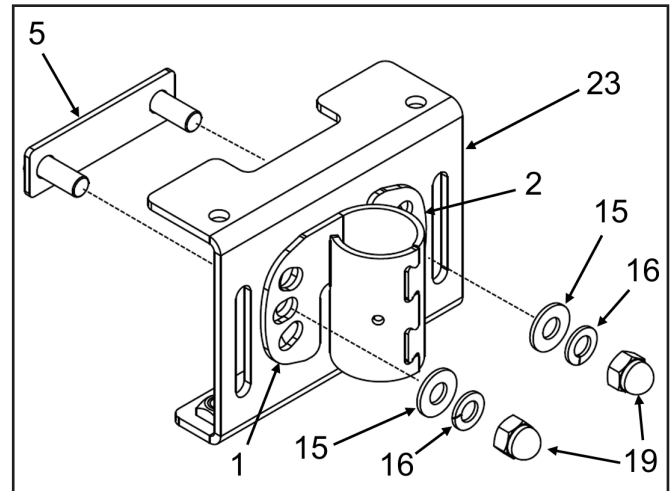

2

- Thread the M8 button head screws (12) into the captive nuts in the support clamp as shown.

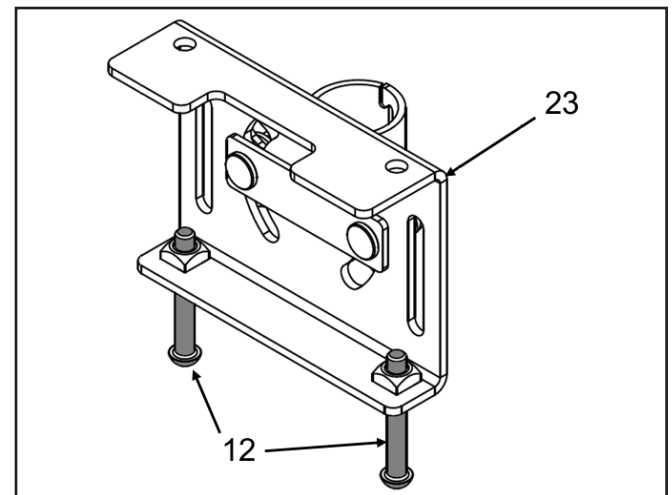

3

- Loosely secure the clamping bracket ASM (24) to the support clamp as shown.

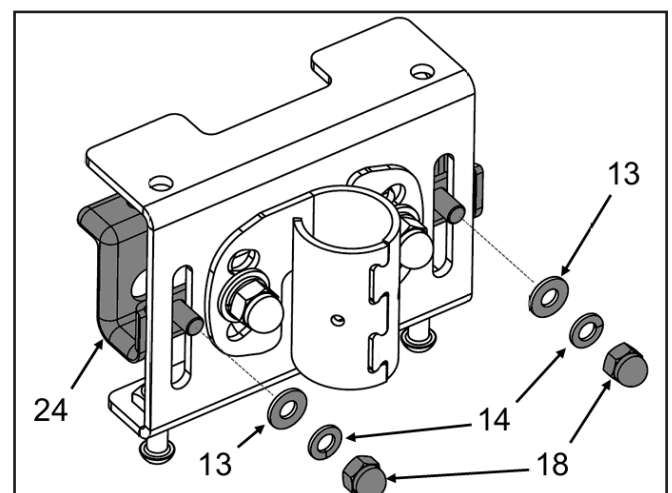

4

- a. Thread a thin hex nut (8) onto each of the double threaded spacers (7) with approximately 8mm protruding.
- b. Thread the spacers into the 'C' bracket as shown. Leave loose.

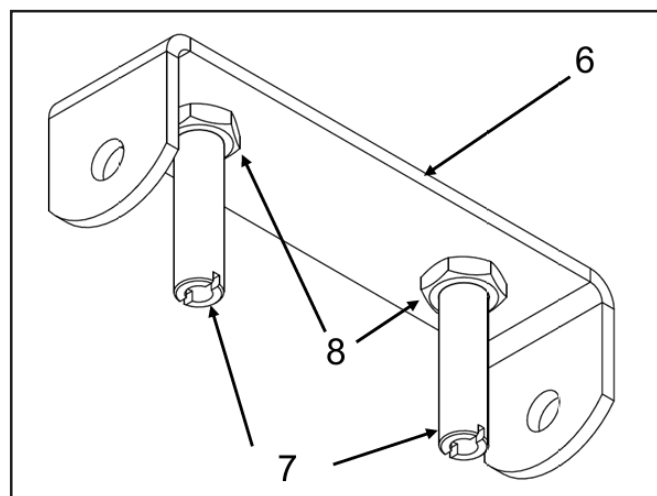

5

- a. Link the clamps (3 & 4) together as shown with the dove tails interlocked.
- b. Loosely secure the clamp ASM to the 'C' bracket ASM as shown. Ensure the tooth washers (17) are installed inbetween the brackets.

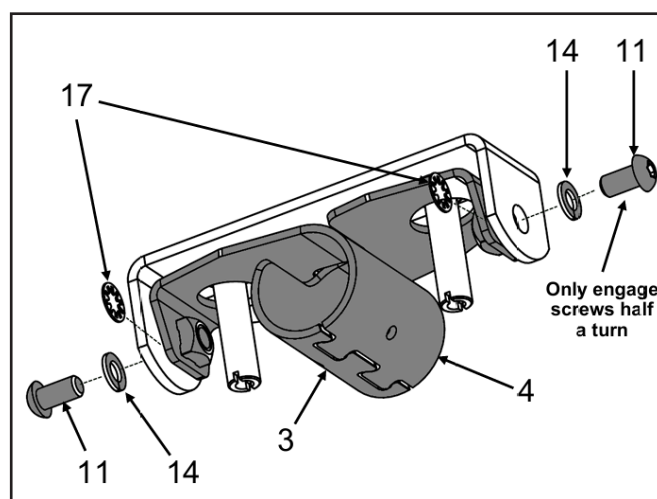

Note: The button screw heads should only be engaged half a turn at this step.

6

- a. Slide the upper clamp assembly from above over the top of the support tube (22) as shown.

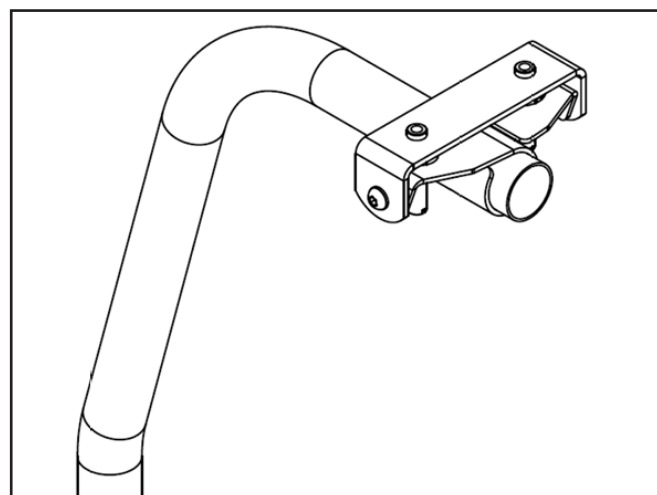

7

- a. Slide the lower bracket assembly over the bottom of the support tube (22) as shown.

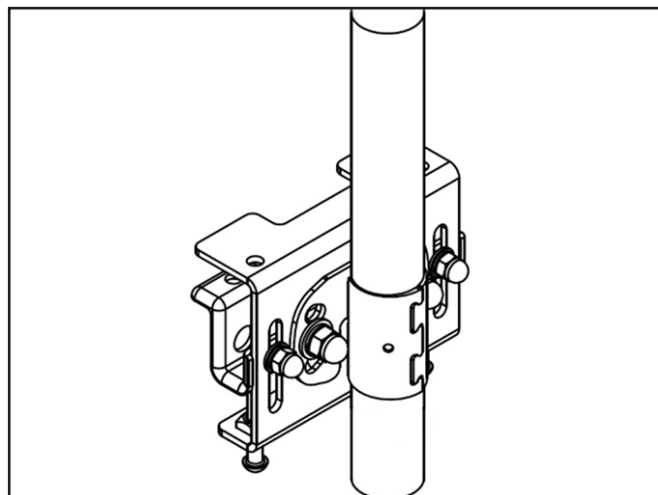

8

- a. Fit the plastic plugs (9) to the ends of the support tube as shown.
- b. Assemble the other 3 LoadMax® supports remembering that the rear supports will usually need to be set at an angle to suit the canopy.

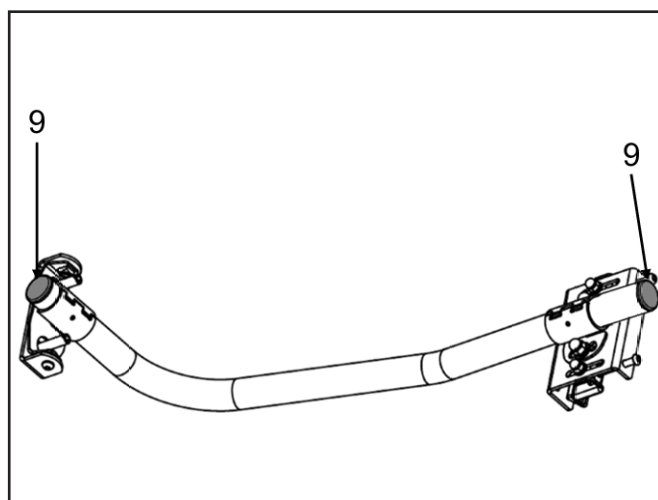

INSTALLATION OF THE LoadMax® SUPPORTS IN UTE TUB 9

- a. The ute tub canopy should be installed following the instructions provided with the canopy.
- b. If the ute tub lip is angled on the underside, fit the plastic tub rail adaptors (21) to the bottom clamping bracket ASM's as shown.

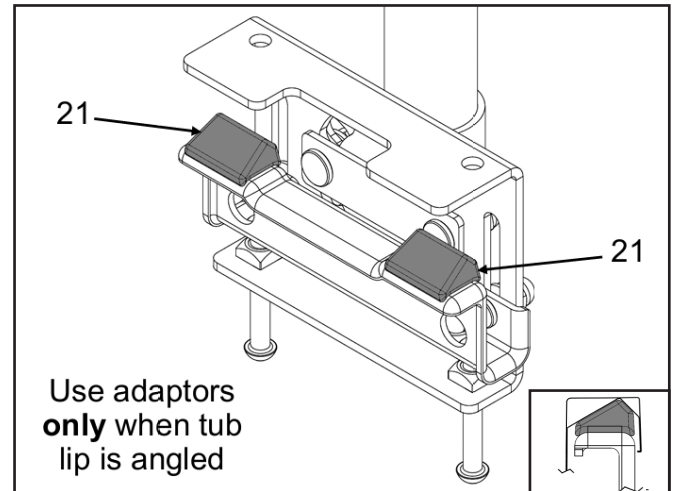

10

- a. Working on one side to start with, locate a LoadMax® support ASM over the tub lip and canopy flange at the front and rear of the canopy.

Note: The selected positions will need to work around the canopy clamps and side window hinges, locks, etc., on both sides of the canopy where applicable.

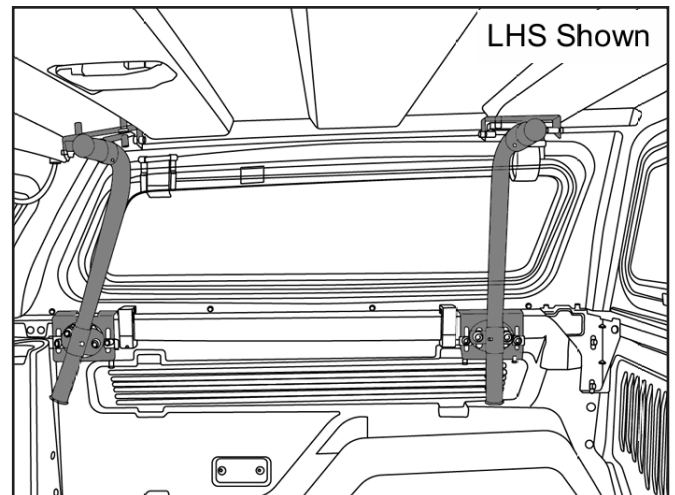

11

- a. Lightly clamp the supports to the tub lip by adjusting the clamping bracket upwards using the 2 adjusting screws.

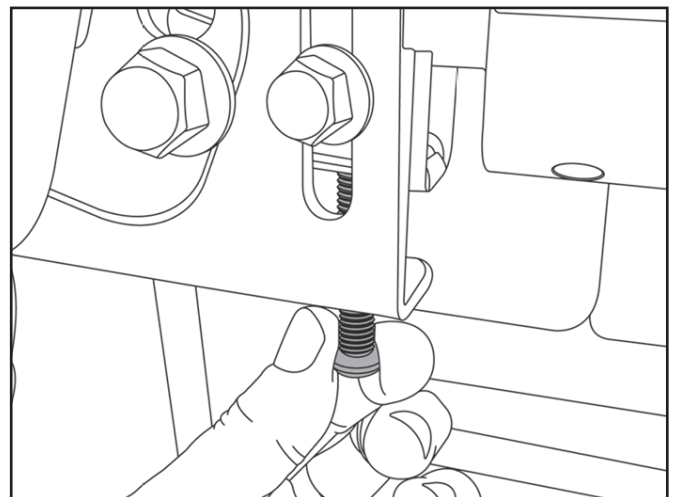

- a. Loosely adjust the support tubes in the tube clamps so the tops of the support tubes are sitting horizontal when viewed from the rear, and at 90° to the centre line of the vehicle.

Note: If LoadMax® is obstructed by tub body, trim bottom section of support tube (22) as shown. Remove and re-apply plastic plugs (9) to trimmed support tube.

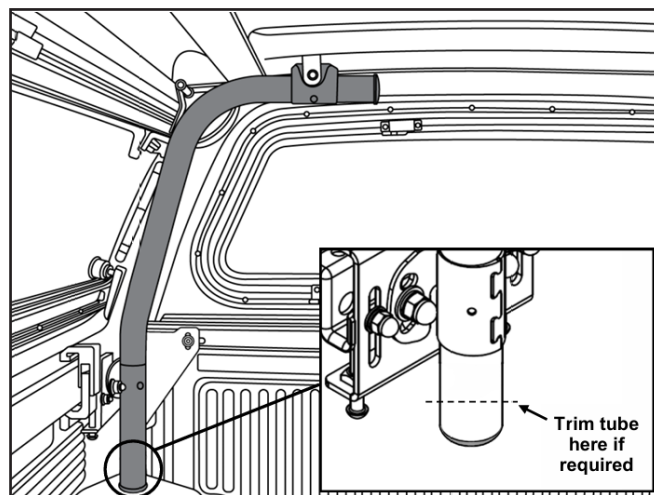

LOCATE THE MOUNTING HOLE POSITIONS IN THE CANOPY

13

- a. On the outside of the canopy affix masking tape in the approximate centre of the canopy roof.
- b. Carefully establish a centreline of the canopy and mark a line on the masking tape.
- c. On the inside of the canopy do the same.

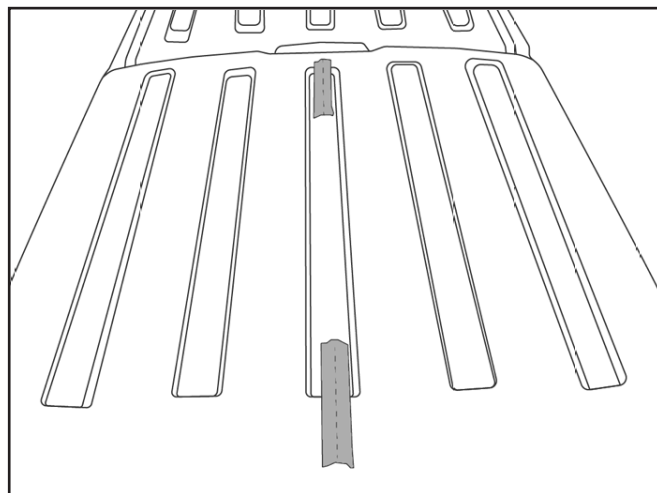

14

- a. On the outside of the canopy establish a suitable flat mounting area which is within the adjustable range of the upper front clamp ASM. Check that this location will also work for the other 3 mounting points
- b. Affix masking tape in these approximate locations.

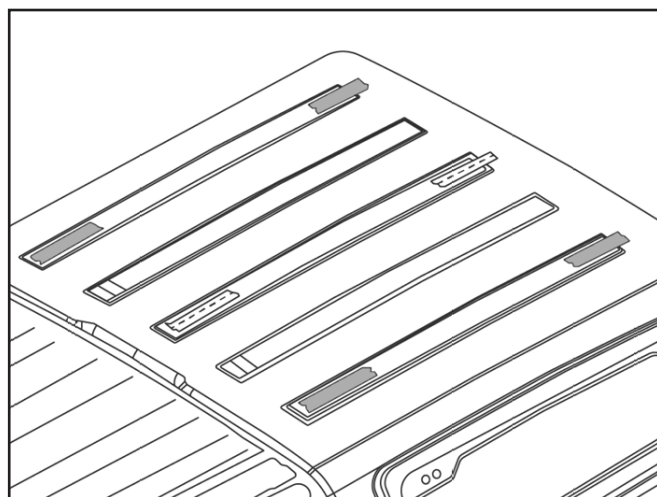

15

- a. Using the centreline to measure off, mark a line parallel to the centreline in the selected mounting area.
- b. Repeat on the other side.
- c. Establish the distance from the front of the canopy to the first mounting point of the front support ASM.
- d. Transfer this measurement to the top of the roof on both sides.

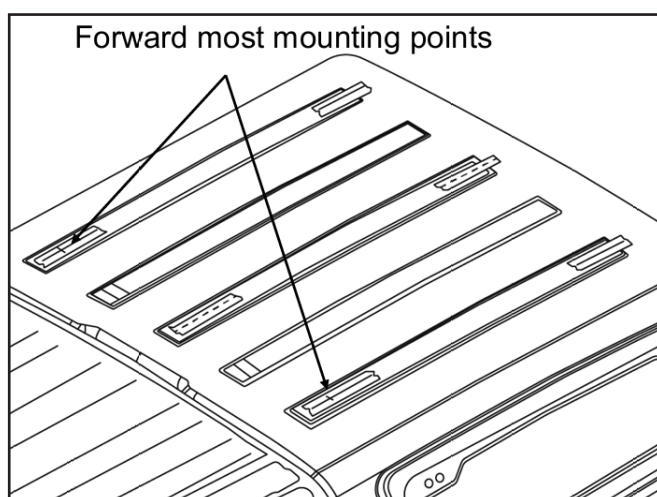

- a. On the inside of the canopy measure the distance from the first mounting point of the front support to the first mounting point of the rear support.
- b. Transfer this measurement to the outside of the canopy marking it on the parallel lines.
- c. From each of the marked locations on the outside of the canopy measure 90mm rearward and mark these positions on the parallel lines.
- d. Double check all of the above dimensions.

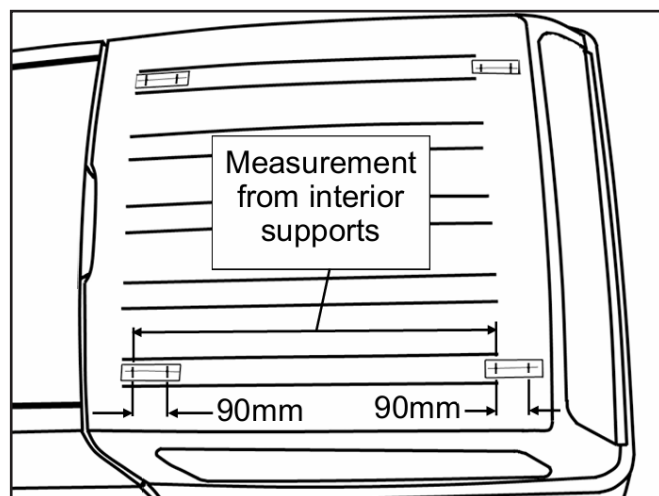

DRILLING THE CANOPY ROOF

17



Warning: Always refer to the canopy manufacturers recommendations for drilling the canopy.

- Ensure the upper clamp ASM's are moved away from the drilling area.
- Using a 5mm drill bit with a drill stop set at 25mm, drill a pilot hole at each of the marked positions on the canopy roof. Drill through all layers.

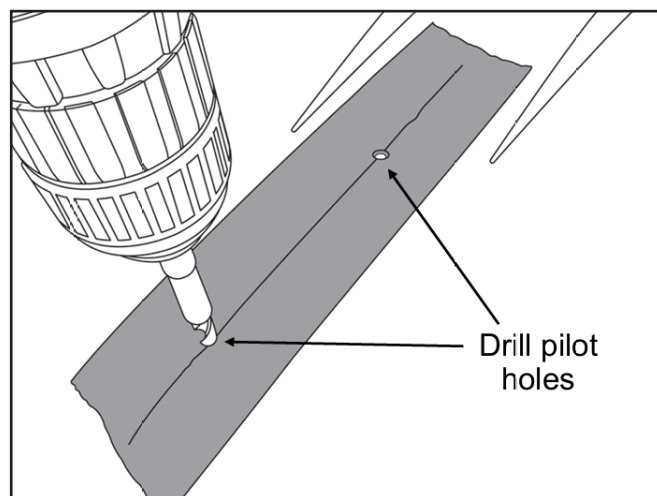
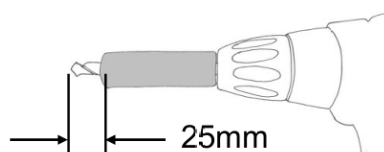

18



Warning: It is important that the 16mm hole sides are smoother and chatter free to avoid crack propagation.

- Using a fine tooth 16mm hole saw with a drill stop set at 25mm, enlarge each of the pilot holes. (Cutting from both sides is recommended to avoid saw breakout).
- Vacuum away any drilling swarf.

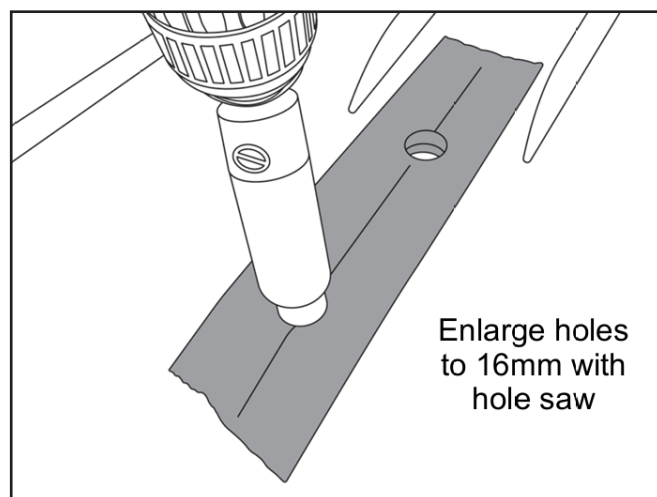
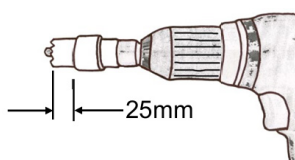

19

- Using a hot round soldering iron or other similar heating tool, carefully melt the sides of the cut 16mm holes to heat seal any micro cracks. (Care should be taken to not enlarge the holes or damage the paint).
- Remove the masking tape from the outside and inside of the canopy.

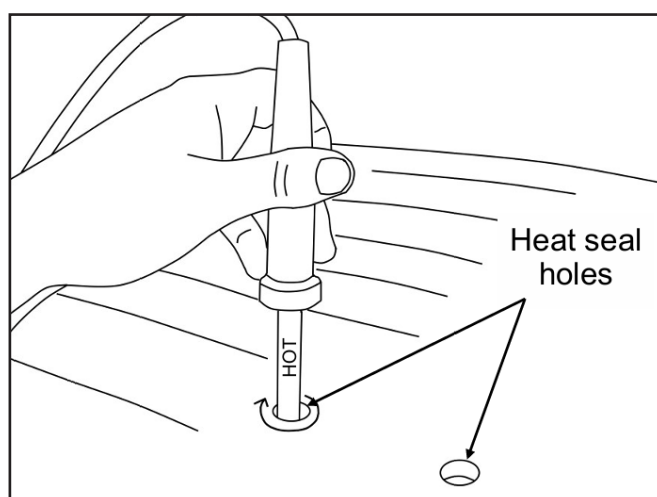

Note: Step 19.a is recommended for vacuum formed canopies.

COMPLETE INSTALLATION OF THE LoadMax® SUPPORTS

20

- a. Position the other 2 LoadMax® support ASM's in the ute tub opposite the first pair.
- b. Adjust and lightly clamp each of the 4 support ASM's until they align with the drilled holes in the canopy, with about 4mm clearance to the roof lining.

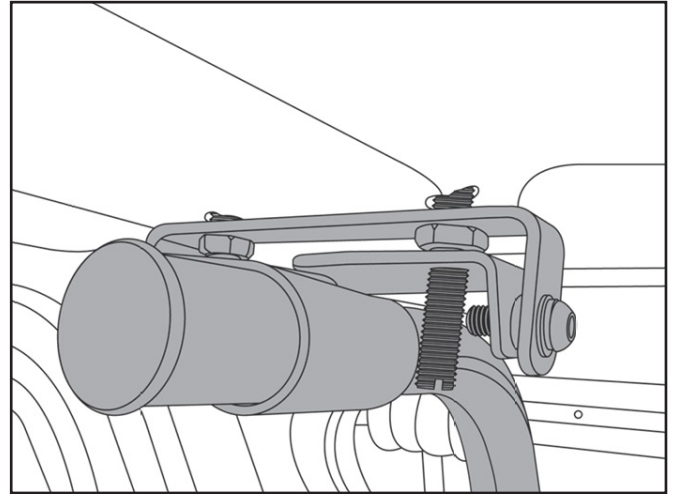

21

- a. Adjust the double threaded spacers until there is 4mm of each spacer protruding past the outside roof surface.

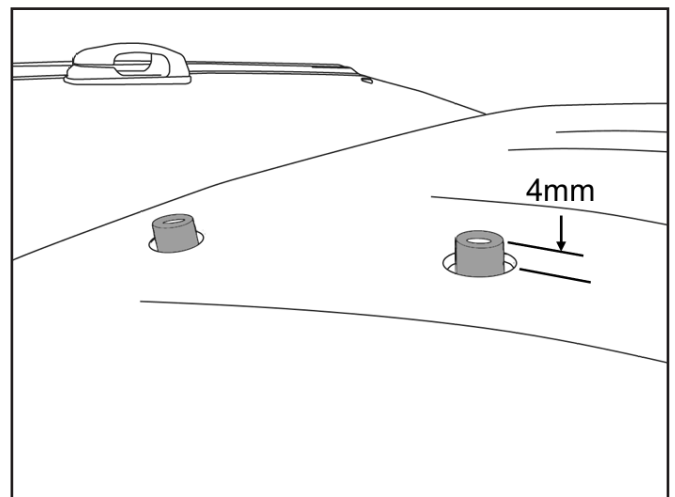

22

- a. Place the roof sealing gaskets (10) over the threaded spacers then attach the desired roof rack/roof bars to the threaded spacers using M8 x 1.25 screws (12) with spring washers (14) under the heads.

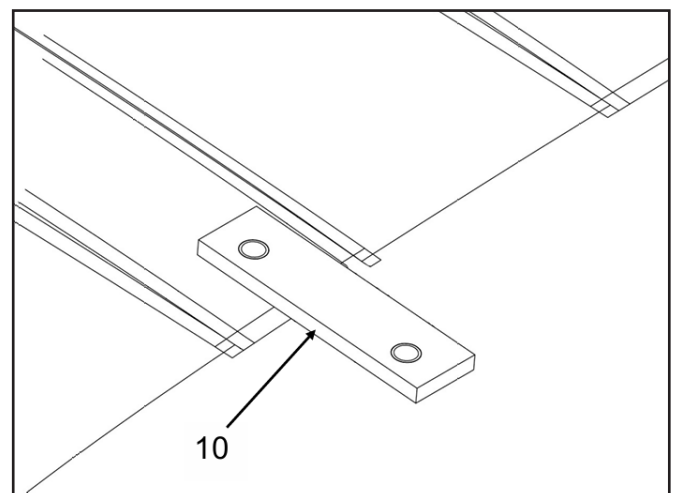

Note: Where necessary apply silicon sealant around the mounting holes for additional sealing.

- a. Tighten the bottom clamping screws until the lower bracket ASM's are right on the tub rim.
- b. Tighten and torque up all of the LoadMax® nuts and screws to tightly clamp the support tubes in place.
- c. Complete the assembly by drilling a pilot hole at each of the self tapping screw holes.
- d. Screw a self tapping screw into each of the screw holes
- e. Affix the warning label (25) to the rear RHS tube support in a prominent position facing rearward

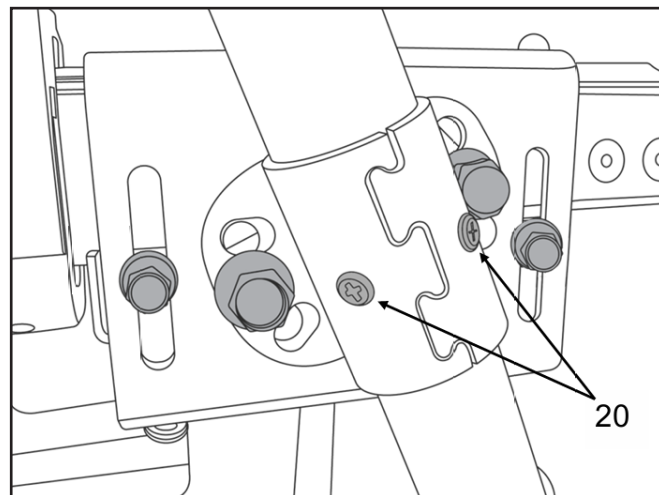

IMPORTANT - READ BEFORE USE

Please ensure the system is fitted in accordance with the fitting instructions.
It is important that you observe all outlined below.

**LOAD RECOMMENDATIONS**

- Routinely and regularly check the proper functioning of the system. Check all fixtures at regular intervals.
- Do not use an automatic car-wash with system installed.
- Maximum load capacity of the system is 100kg under static conditions.
- **Maximum load capacity of the system is 100kg under dynamic including off-road conditions.**
- **Do not exceed vehicle manufacturer's recommended load rating if it is lower than the maximum load capacity specified in this document** (i.e. 100kg).
- Ensure any load carried is evenly distributed.
- Actual load on vehicle Roof (refer to owner's manual) = Weight of Roof rack system / Ridge Mount + Weight of Tray + Weight of cargo.
- Actual load on rack system (Refer to product instructions) = Tray weight + cargo.

WARRANTY INFORMATION

Rola warrants that, subject to exclusions and limitations below, the Ridge Mount system will be free from defects in materials and workmanship for a period of 5 years commencing on the date of sale by the authorized Rola stockist to the original purchaser of the system.

If a defect appears in the Ridge Mount system before the end of the warranty period and Rola finds that the defect is in materials or workmanship, Rola will, in its sole discretion, either:

1. Repair the Ridge Mount or the defective component of the Ridge Mount system free of charge
2. Replace the Ridge Mount or the defective component of the Ridge Mount system; or
3. Refund the purchase price of the Ridge Mount system to the original purchaser.

Rola reserves the right to change the design, specifications or composition of the Ridge Mount system without notice and without liability.

Rola reserves the right to replace defective products or components with products or components of similar quality, grade and composition, where an identical product or component is not available. Goods presented for repair may be replaced by refurbished goods of the same type rather than being repaired. Refurbished parts may be used to repair the goods.

This 5 year warranty does not apply where:

1. The Ridge Mount system is not installed in compliance with the fitting instructions provided
2. The Ridge Mount system is not used as intended or designed
3. Any part of the Ridge Mount system is used with other products or components not intended to be used in conjunction with the Ridge Mount system
4. The Ridge Mount system has been on-sold or assigned by the original purchaser
5. The Ridge Mount system has been modified or repaired by someone other than Rola or an authorized Rola stockist
6. Rola cannot substantiate any fault after inspection of returned product
7. The Ridge Mount system has been subject to abnormal conditions, including fire, water, humidity, pressure, stress or similar
8. The defect in the Ridge Mount system has arisen due to abuse, misuse, neglect or accident
9. The defect in the Ridge Mount system has arisen due to the unlawful or improper operation of the vehicle to which it is fitted
10. The defect in the Ridge Mount system has arisen due to the purchaser's failure to properly assemble, install, fit, maintain or use the Ridge Mount system in accordance with the specifications and instructions provided by Rola.

For safety and use instructions, please refer to any General or Specific Fitting Instructions and Warning & Care Instructions enclosed within the Ridge Mount System or on our website at www.rola.com.au.

This warranty does not extend to fair wear and tear. Warranty claims can be made by contacting Rola directly using the details below. A warranty claim must be accompanied by proof of purchase (such as a receipt), details of the alleged defect and appropriate documentations (such as historical and maintenance records where appropriate). The customer must make the product available to Rola or its authorised repair agent for inspection and testing. If such inspection and testing finds no defect in the product, the customer must pay Rola usual costs of service work and testing. It is the purchaser's responsibility to arrange and pay to return the product or component to the place of purchase. The purchaser may seek reimbursement from Rola for the cost of such activities, providing Rola notifies the purchaser in writing that a warranty claim is justified. Any such claims made must be in writing via post or email.

The benefits of this warranty are in addition to any rights and remedies imposed by Australian State and Federal legislation that cannot be executed. Nothing in this warranty is to be interpreted as excluding, restricting or modifying any State or Federal legislation applicable to the supply of goods and services which cannot be so excluded, restricted or modified. Our goods come with guarantees that cannot be excluded under the Australian Consumer Law. You are entitled to a replacement or refund for a major failure and for compensation for any other reasonably foreseeable loss or damage. You are also entitled to have the goods repaired or replaced if the goods fail to be of acceptable quality and the failure does not amount to a major failure. Rola makes no express warranties or representations other than set out in this warranty.