

|                        |                       |                      |                     |                  |                   |                  |          |                  |                  |                 |                       |
|------------------------|-----------------------|----------------------|---------------------|------------------|-------------------|------------------|----------|------------------|------------------|-----------------|-----------------------|
|                        |                       |                      |                     |                  |                   |                  |          |                  |                  |                 |                       |
| END SUPPORT (RIGHT) x2 | END SUPPORT (LEFT) x2 | MOUNT PAD (RIGHT) x2 | MOUNT PAD (LEFT) x2 | SNAP-ON COVER x4 | SECURITY COVER x4 | STRAP BRACKET x4 | SCREW x4 | SECURITY BOLT x4 | SECURITY BOLT x4 | ASSEMBLY KEY x1 | CROSS-BAR ASSEMBLY x2 |

|   |                      |              |                         |               |
|---|----------------------|--------------|-------------------------|---------------|
| <b>SOME FITMENTS MAY ALSO FEATURE THE FOLLOWING COMPONENTS:</b> |                      |              |                         |               |
|   | ANCHOR POINT BOLT x4 | ALLEN KEY x1 | BOTTOM STRAP BRACKET x4 | BOLT COVER x4 |

**Please Note:** You will require the following tools

|                           |                       |               |              |
|---------------------------|-----------------------|---------------|--------------|
|                           |                       |               |              |
| Phillips Head Screwdriver | Flat Head Screwdriver | Rubber Mallet | Safety Knife |

#### \*NOTE:

RMX284-H refers to single bar - Rear Fitment ONLY. Maximum carrying capacity for single bar fitment is 20kg

#### ASSEMBLY OF CROSS-BARS

1. Ensure the roof is clean, free from dust and grease.

2. Insert the neck of the End-Support into the void of the Cross-bar profile. They are designed to be a tight fit: use a rubber mallet if necessary (Fig.1)

3. Pull back the rubber Buffer Strip about 20mm until the screw hole can be accessed.(Fig. 2) Using a Phillips Head Screwdriver, fasten the screw through the cross-bar and into the End Support.

Do this for all four sides and replace the buffer strip.

**NOTE:** The longer cross-bars are to be fitted to the front of the vehicle. Check labelling on the underside of the cross-bar.

#### FITTING CROSS BARS TO VEHICLE

4. Open the vehicle doors and carefully push fit the locking straps over the weather seal (Fig. 4b). Slide the rubber pad under the locking strap and place the crossbars on top with the sloping face of the end support towards the front of the vehicle. Loosely fit the special bolt through the end support and into the locking strap cage nut. Give two or three turns of the bolt in cage nut with the security key provided (Fig 5.). Go to the other side of the vehicle. Pull on the end support and fit using the same technique as above. This will allow correct alignment of the cage nut and the bolt thread.

5. Gradually tighten the bolts alternately (ensure locking straps are properly engaged) until even tensioning is achieved.

**PLEASE NOTE:** Leave a gap of approximately 3 to 5mm between the bottom of End Support and the top of the Strap bracket(Fig. 9). Over-tightening the bolts may result in damage to your vehicle and/or roof-rack.

6. Proceed to follow steps 4 and 6 when mounting the Rear Crossbar Assy.

7. You are now ready to mount your "Accessories" set onto the cross-bars using the Global Mount Channel. Once installed, insert the 'Global Channel' Covers into the End Supports.

**Note:** You have a choice of 2 - (a) quick access snap-on cover or (b) long term mounting - security cover to cap off and lock the mount channel. (Fig. 6)

Fig. 1

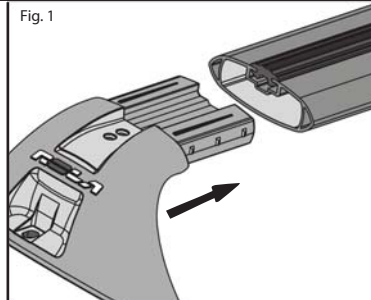

Fig. 2

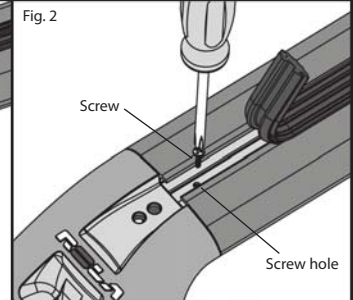

Fig. 3a - IF APPLICABLE

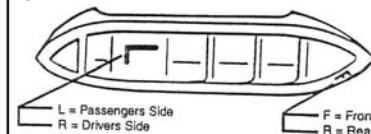

Fig. 3b - IF APPLICABLE

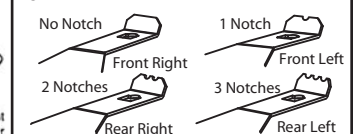

Fig 4a.



Fig 4b.

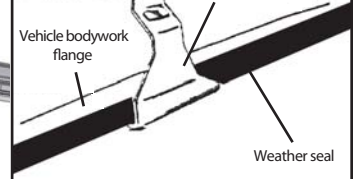

Fig. 5

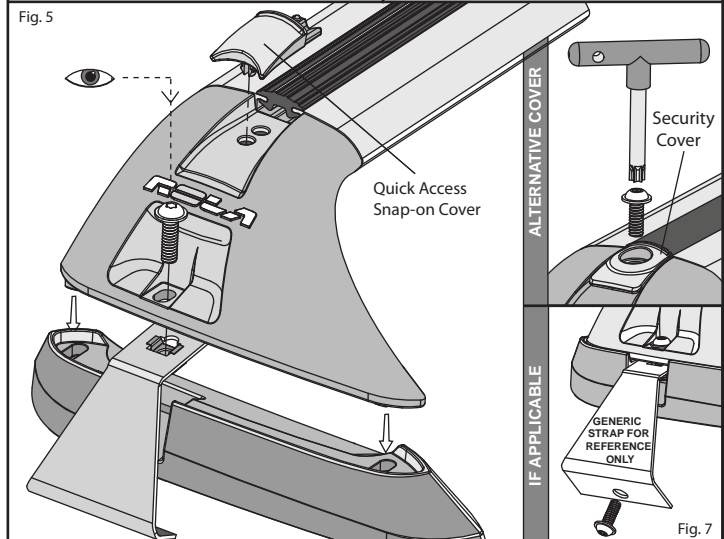

Fig. 8

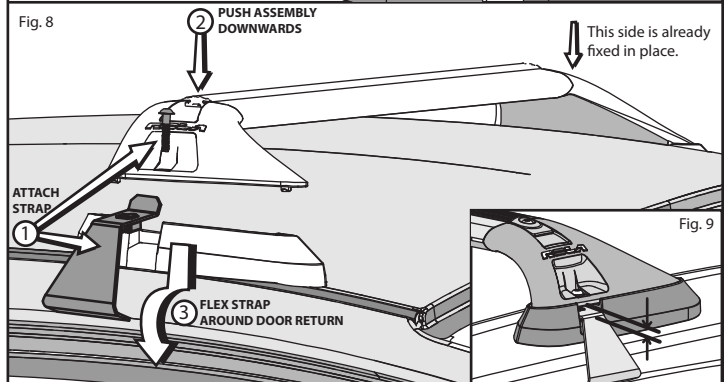

Fig. 9

**General Usage Information**

It is essential for the proper assembly, operation and use of the Roof Rack that the instructions and safety precautions supplied are strictly observed. Read any fitting, care and usage instruction carefully.

The maximum permissible load for your Roof Bar is the lower of the maximum load capacity specified in your vehicle operation manual, or specified as applying to the Roof-Rack. Do not exceed the maximum specified load capacity.

Maximum permissible load = weight of the Roof Rack + weight of accessories + weight of load (cargo).

When fitting the Roof-Rack and transporting a load, ensure the vehicle's functions are not impaired (eg, sunroof, aerials, windscreen wipers, mirrors). Rear doors on Hatch- and Wagon-type vehicles should be inspected for adequate clearance for full opening operation of the boot/tailgate.

Stop and check all screw connections, bolts and retaining straps after a short distance of travel. Repeat these checks at regular intervals.

**Warnings**

Remember that the fitting of a Roof Rack and the transport of a load increases the overall height of the carrying vehicle.

Where the Roof-Rack is to be used in off-road conditions, a safety weight reduction of 1.5 should be observed from the total carrying capacity. (eg. 60kg becomes 40kg)

Cequent will not be liable to the purchaser or any other person for any consequential, incidental, direct or indirect loss, damage or costs incurred or suffered by the purchaser or any other person including but not limited to damage to persons or property, loss of turnover, loss of profits, loss of business or goodwill, arising from or in relation to the assembly and use of the Roof rack, or the non-observance of the fitting and care instructions.

**APPENDICES & ADDITIONAL 'FITMENT SPECIFIC' FITTING STEPS - IF REQUIRED**

This area has been intentionally left blank.