



INSTRUCTION GUIDE FOR:
ROLLING DUFFLE BAG
59101-AUS

Date of Purchase: / /

ROLLING DUFFLE BAG FITTING INSTRUCTIONS

1. Pack your Rolling Duffle Bag while paying attention to NOT overload either the bag or your vehicle's roof load carrying capacity.
2. Position the bag in the most appropriate location on your roof top tray or roof top basket.
3. Feed the centre strap through the loops sewn on to top of the bag. If using the cover, feed the centre strap through the loops sewn onto the cover. **See Figure 1.**
4. Attach the end straps to the roof racks (through the basket or the tray) or to the basket or tray rails. **See Figure 2.** One strap to be attached to the front of the tray or basket and the other to the rear.
5. Attach the end straps to their respective buckles on the centre strap as shown in **Figure 3.** Remove all slack in straps by alternately tightening the front and back end straps until the Rolling Duffle Bag is adequately secure. **Make sure the front & rear straps trap the Duffle Bag snug between them.**
6. Any excess webbing should be properly restrained to prevent unwanted flapping while the vehicle is in motion.

NOTICE:

This product is only waterproof against the elements when used with the provided cover. Valuables and water-sensitive items should be sealed in water proof plastic bags before placement in this cargo bag. ROLA is not responsible for any damages due to water.

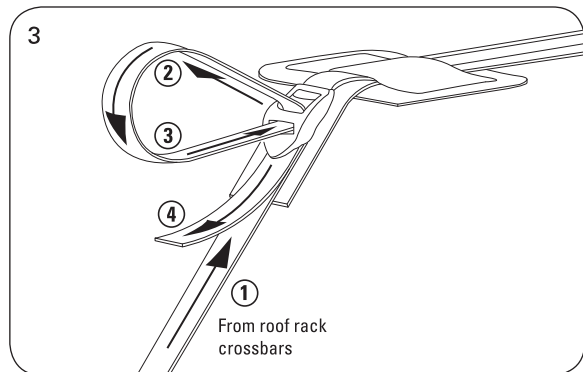
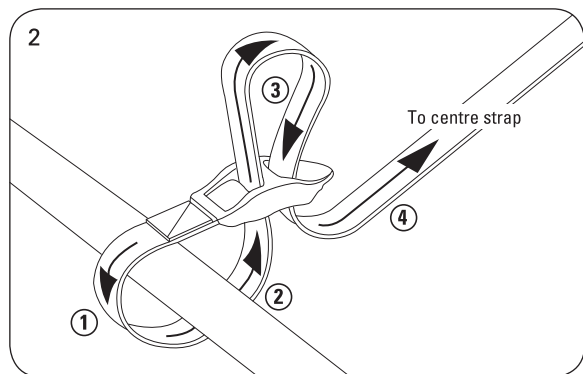
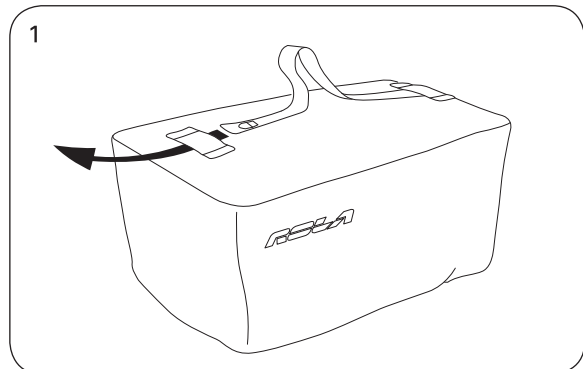

ROLA®, a Cequent Brand
AUS: 49 Pacific Drive, Keysborough, VIC 3173
PH: 1800 812 017
www.rola.com.au
NZ: 2 Boldwood Place, Wiri, Auckland 2104
PH: 0800 698 227