



# Instructions

## Rear Diff - Front Bushings

This instruction sheet should be used in conjunction with the workshop manual and proper safety procedures followed.

**Application** - Nissan Skyline R32 - R34  
 - Nissan 180SX  
 - Nissan 200SX  
 - Nissan 300ZX

*Always refer complete catalogue listing*

**WHITELINE** differential bushings improve drive-line integrity under excess loads. This helps transmit power to the wheel more smoothly and efficiently.

**Note: removing the original diff bushings is best done with the diff removed from vehicle.**

**Contents** - 2x bushing B3047  
 - 2x bushing B3048  
 - 2x steel tube 19x13x43mm  
 - 2x steel washer 55x12.5x2.5mm  
 - grease

- Raise vehicle evenly and safely support.

*Never rely on a Jack only*

- Proceed to remove diff from the rear cradle.

**Note: the exhaust may have to removed first.**

- The original bushings have a steel outer shell. These are bet removed with air-chisel. OR drill hole in the rubber to these drill out the steel outer shell.

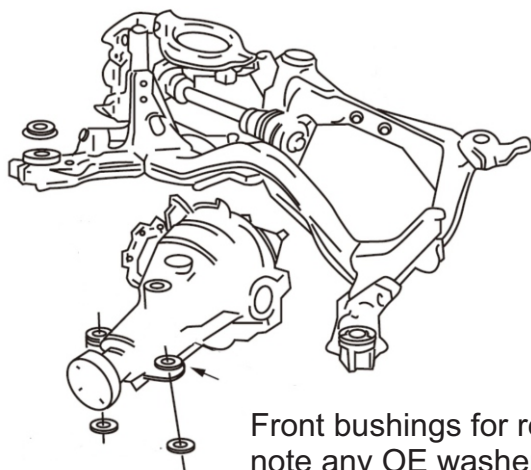

Front bushings for rear diff  
 note any OE washers in their  
 respective position.

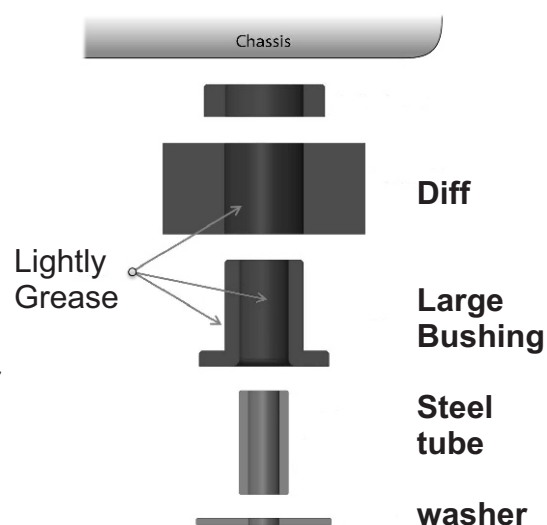

- Once bushings are removed, clean the diff housing of any dirt or oil.
- Refer above diagram for new bushing install. use a small amount of grease to help with install and operation.
- Re-fit diff to vehicle using original bolts.
- Test drive and recheck all bolts

It is recommended that a licenced workshop or tradesperson carry out the above procedure and that workshop manual and relevant safety procedures are followed in addition to the above.