

Fitting Instructions #5475IS

VW Golf MK5

Front Lower Control Arm Front Bushing (Adjustable)

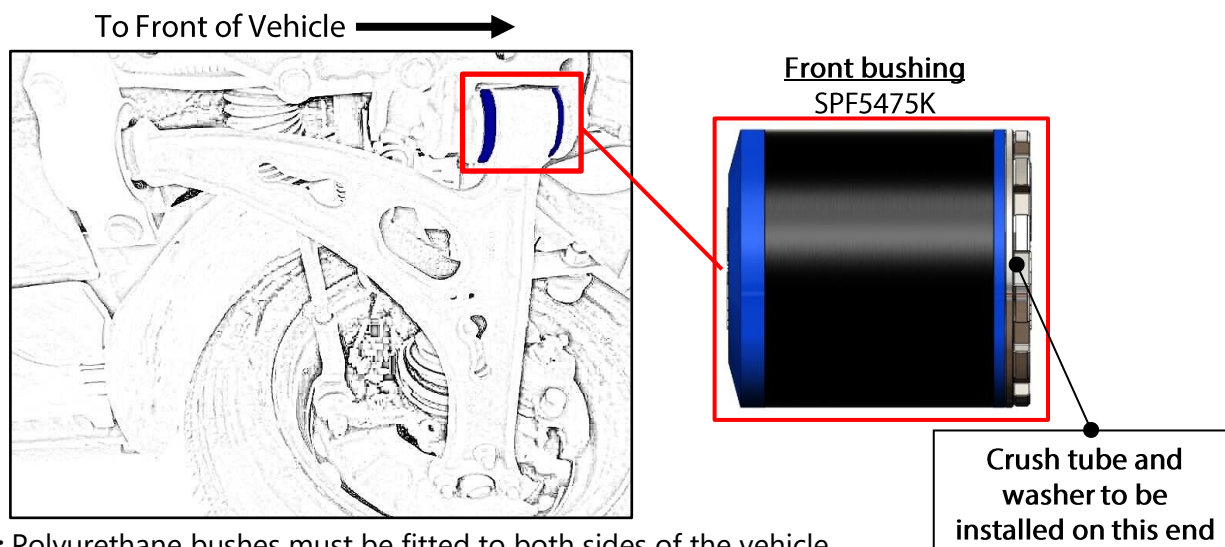

Note: Polyurethane bushes must be fitted to both sides of the vehicle.

- Wheel-align the vehicle before the job is started and note settings;
- Jack the vehicle up and support on jack stands/hoist;
- Using factory manual, remove the front lower control arms;
- Remove original bushings from the housing with the use of a hydraulic press and suitable pressing tools;
- Grease up the body of the polyurethane bush and the inside of the housing, then, press the bushes into the housing;
- Liberally apply the grease supplied to the polyurethane bore of the bush, the outside of the steel crush tubes and then, push the crush tube and washer in as per orientation below.

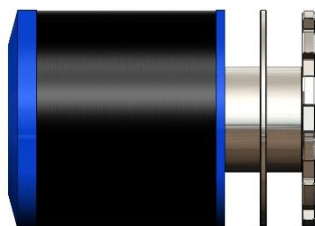

- With reference to Table 1 and the settings required, adjust the new crush tube with the spanner provided, so that the hole in the bushing is positioned to give the desired camber settings.
- Refit the front lower control arm to the vehicle and tighten all bolts to manufacture's torque settings and carry out a wheel alignment.

Left Hand Side Shown – Looking from the rear

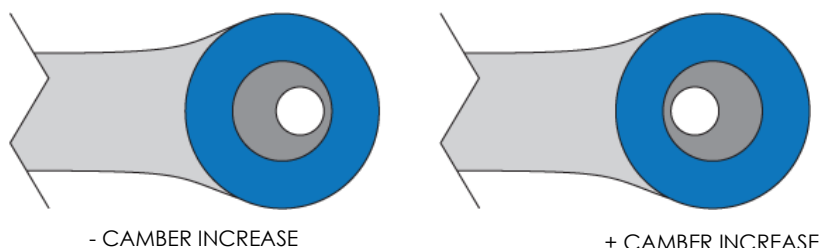

Table 1: Illustration of Camber settings