

Fitting Instructions #3036IS

Toyota Altezza / Lexus IS200

Rear Lower Control Arm Inner Bushing

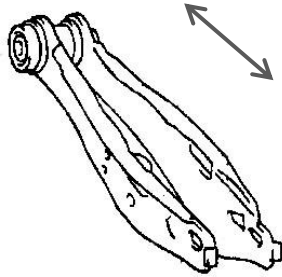

Moving the lower control arm towards the centre of the car will give you more positive camber approx. 0.5 degree;
Moving the lower control arm towards the outside of the car will give you more negative camber approx. 0.5 degree.

Note: Polyurethane bushings must be fitted to both sides of the vehicle.

- Wheel-align the vehicle before the job is started and note settings;
- Support the vehicle on jack stands or a hoist and remove the lower control arms;
- Using the appropriate pressing tools remove the original metal shelled bush and press in the new bush marked '3036' (make sure the centre of the control arm is supported so as it doesn't collapse);
- Apply the white grease supplied to the bore of the bushes and the outside of the steel crush tubes. With reference to the diagrams fit the crush tubes to gain desired results;
- Refit the control arms to the car, making sure you tighten the bolts with the arm held at 90 degrees to the mount as this will give you the maximum camber offset.
- Re-assemble the rest of the car. Check that there is sufficient end float in the drive shafts and then carry out a wheel alignment;
- Note manufactures torque setting must be used on all bolts and nuts.

Left Hand side Shown

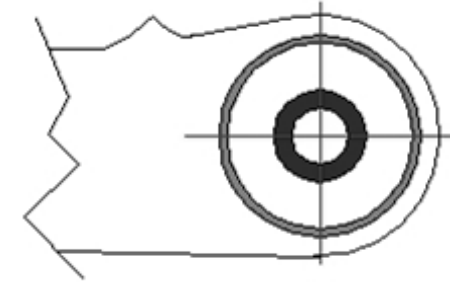

Standard Replacement

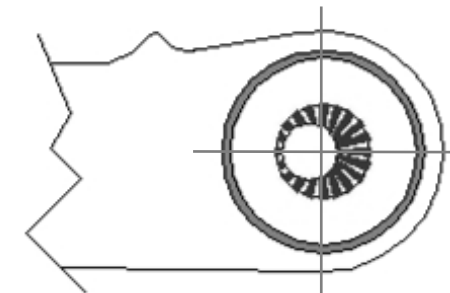

Positive Camber

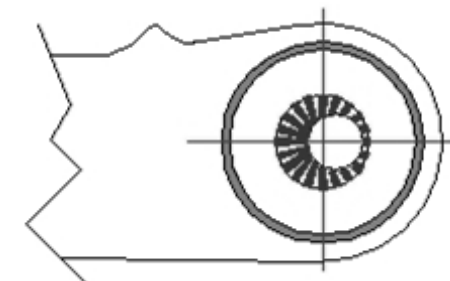

Negative Camber