

Fitting Instructions #ALOY0001IS

Volkswagen / Audi / Seat / Skoda

Front Lower Control Arm Complete Replacement

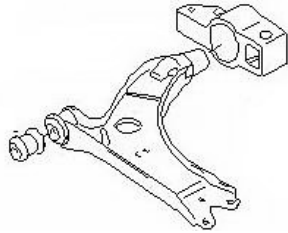

Note: ALOY0001 arms must be fitted to both sides of the vehicle.

- Wheel align the vehicle before the job is started and note caster settings;
- Place vehicle on hoist and remove OE control arms and set aside;
- Note the kit comes as a complete arm replacement assembly with the front bushing installed and only requires the rear bush to be assembled onto the arm;
- Lubricate the centre of the new rear bushes note it will have 3754L or 3754R cast into the bush itself and is part of the aluminium housing assembly;
- Push 3754L over the end of the arm as per picture below ensuring that it bottoms out on the spigot and rotates freely. This will become the left hand control arm – repeat for the right hand side;
- Fit the control arms to the car note 3754L is for the left hand side of the car 3754R is for the right hand side of the car;
- Wheel align vehicle and check castor settings;
- Torque all mounting bolts to manufactures specifications with the vehicle at ride height.



Note: bushing comes complete with housing left hand shown



Lubricate bushing assembly

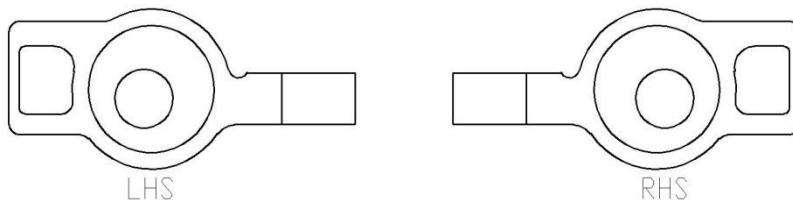

Schematic drawing of brackets viewed from the back of car looking towards the front.
Note offset position of the brackets.



View of underside of car right hand side shown with arm assembly installed