

Fitting Instructions #5722IS

Honda Accord Euro 2003-2008 - CL, CM

Rear Hub Bushes

- Jack vehicle up and put on stands/hoist, remove rear wheels and the control arms/trailing arms you are replacing;
- To remove the bushes without removing the hub you will need the following items; 1 x metal spacer 36mm O.D x 2.5 wall thickness & 1 x metal spacer 38mm O.D x 2.5 wall thickness, length of 12mm booker rod and 2 matching nuts, heavy gauge washers one to sit on each of the spacers, old pinion style bearing, matching spanners, ratchets;
- Set the tools up according to Figure 2 and draw the bush out. Note excessive force is not necessary; make sure the spacers are lined up correctly. Also cover the bearing with a rag incase of failure, appropriate safety equipment must be used.
- Repeat process to install the new bush making sure the bush goes in straight. **Note:** install the bush centre to the housing;

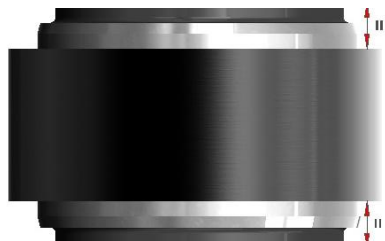

- Apply the grease supplied to the bore of the bush and the outside of the crush tube and use a pair of multi grips to install the crush tubes;
- Refit trailing arms using manufactures torque settings and carry out a wheel alignment.

Note: This procedure is only one option, alternatively you can remove the hub assembly and use a press to remove the bushes, note due to the awkward position of the hub bushes you may have to burn/cut out the bush depending on the press you have.

KIT CONTENT			
KIT No.	PART No.	DESCRIPTION	QTY.
SPF5722K	SPF5722	BUSHES BONDED	2
	F8186	CRUSH TUBE (24 X 12.3 X 40)	2

Superpro
Suspension Parts

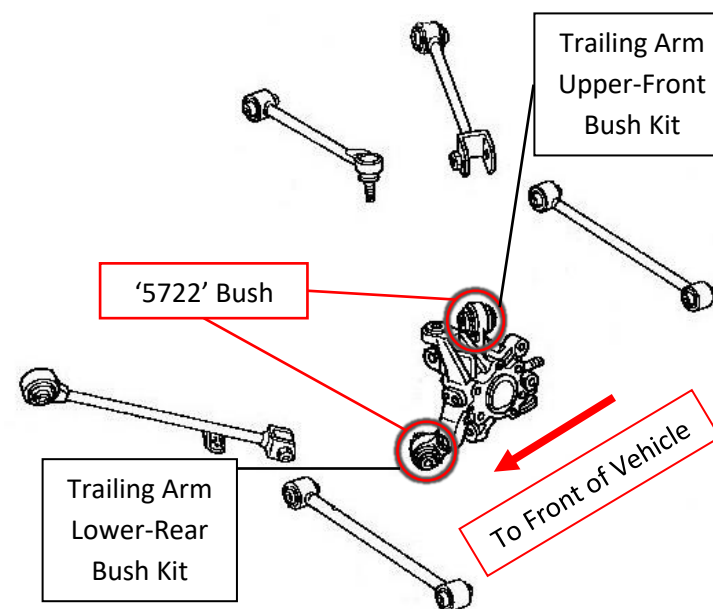

Figure 1: Rear Suspension Arrangement

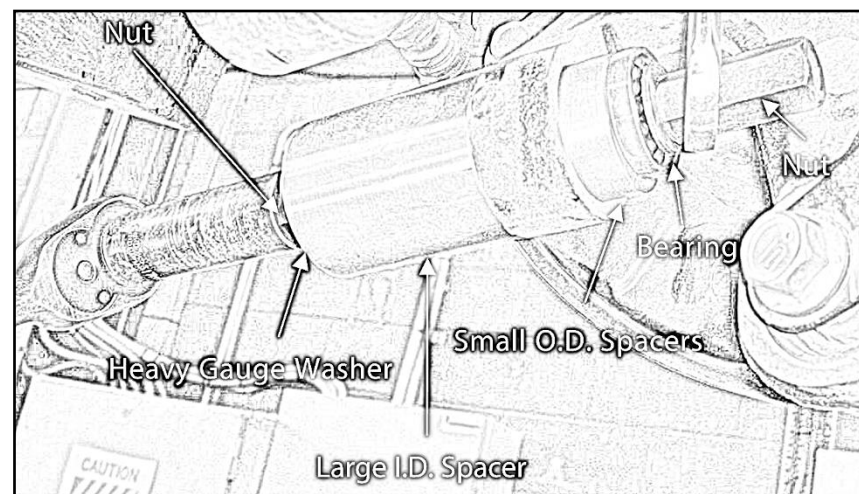

Figure 2: Press Tool Setup (Illustrative Purpose)