

Fitting Instructions #1899IS

Honda Civic, Concerto, CR-V, Integra / Rover 200, 400

Rear Upper Lateral Link Inner Bushing



- Wheel-align the vehicle before the job is started and note settings;
- Jack the vehicle up and support on jack stands/hoist and remove the lower control arms;
- Remove the original bush, including the shell part, from the outer bush housing of the upper lateral link with the use of a hydraulic press and suitable pressing tools;
- Different methods can be used to remove the OE pin from the OE bush. A suggestion would be to warm the OE bush pin up to break the bond to the rubber, then polish it to remove any left material and re-use this OE pin with the SPF1899K kit;
- Apply the supplied grease to the outside surfaces of the bush and inside the housing;
- Push the new '1899' bush according to the Figure 02. Note the position of the bush, the bigger flange should be facing the back of the car, see Figure 02;
- Apply the white grease supplied to the bore of the bush and outside of the OE pin, and push the pin into the bush bore, Figure 02;
- Apply the same procedure to the other control arm;
- Refit the upper lateral link to the vehicle and tighten all bolts to manufacture's torque settings;
- Carry out a wheel alignment.

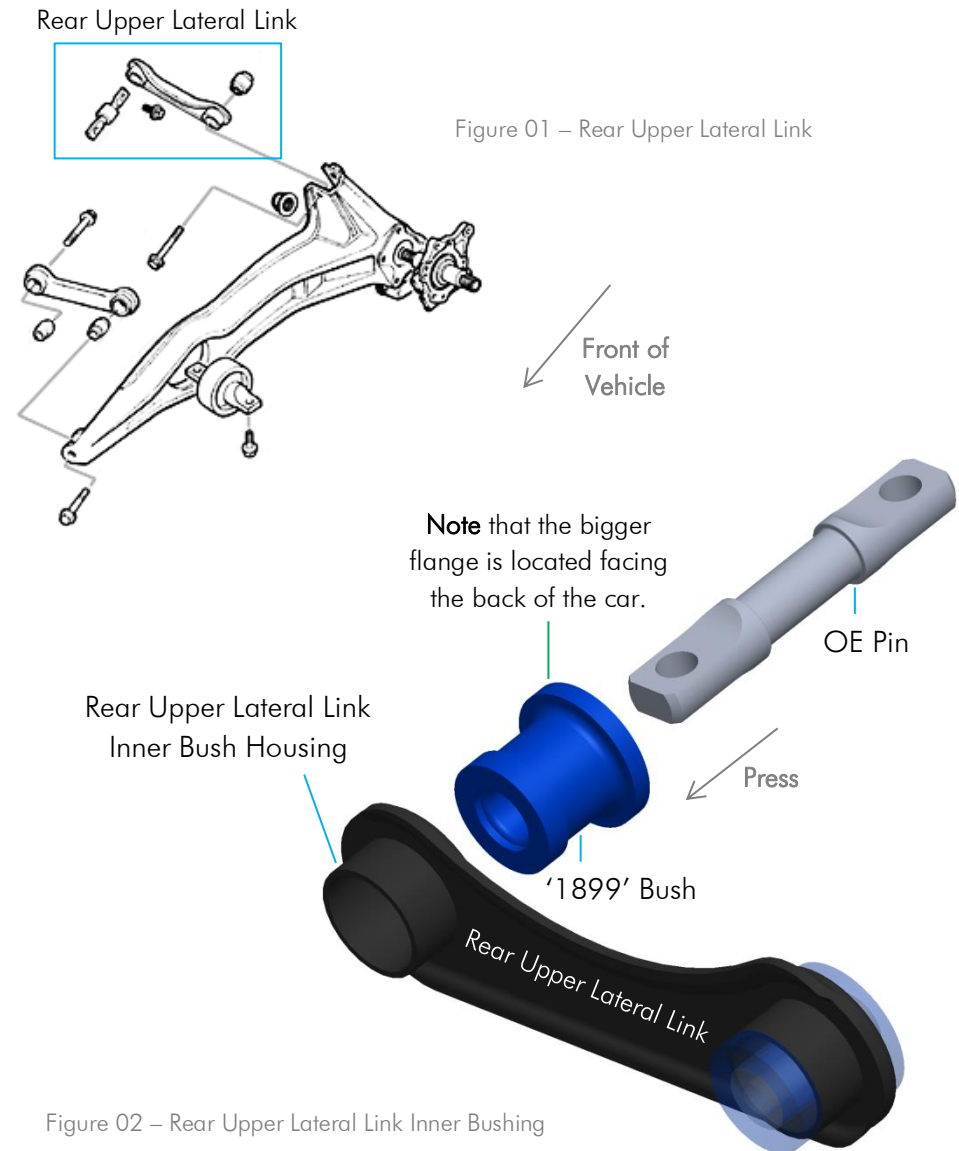

Note: Polyurethane bushings must be fitted to both sides of the vehicle. This kit should be installed by a Qualified Motor Mechanic.