

Fitting Instructions #2870IS

Holden Commodore VE

Rear Upper Control Arm Inner Rear Bush

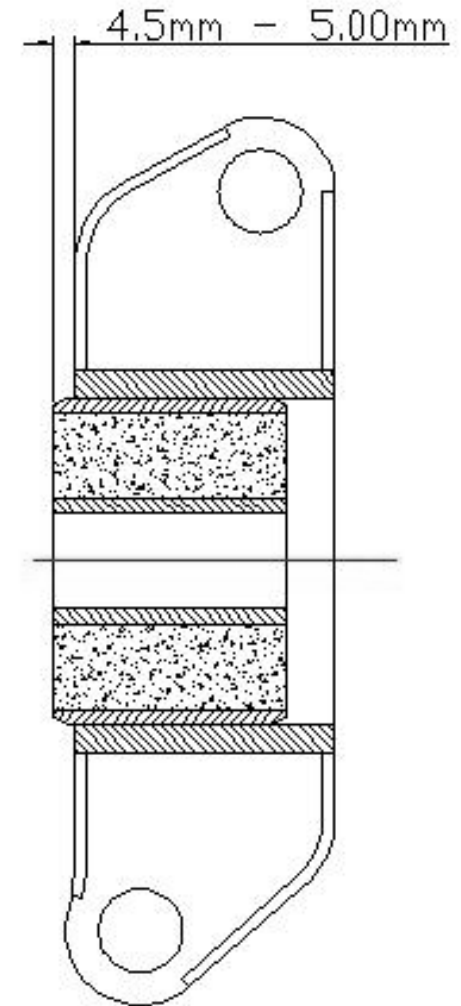

- Support the vehicle on a hoist and remove the rear sub frame;
- Remove the 2 mounting bolts and centre bolt from the control arm;
- Mark the side which the bush protrudes from the bracket with white out or similar;
- Note the original bracket is oval shaped, varying from 69.3mm – 70.3mm, find a pressing tool that will fit into the bracket and press out the original bush;
- Press in the new bush marked '2870' making sure to leave 4.5mm – 5.00mm of the shell protruding from the side that you have marked;
- Using the white grease supplied, lubricate the bore of the bush and the outside of the crush tube, push in the crush tube;
- Refit to the arm and repeat for the other side;
- Refit the sub frame and carry out a wheel alignment;

Note: manufactures torque settings must be used on all bolts.