

Fitting Instructions #3153IS

Nissan Skyline R33 / R34

Control Arm Upper-Inner Kit

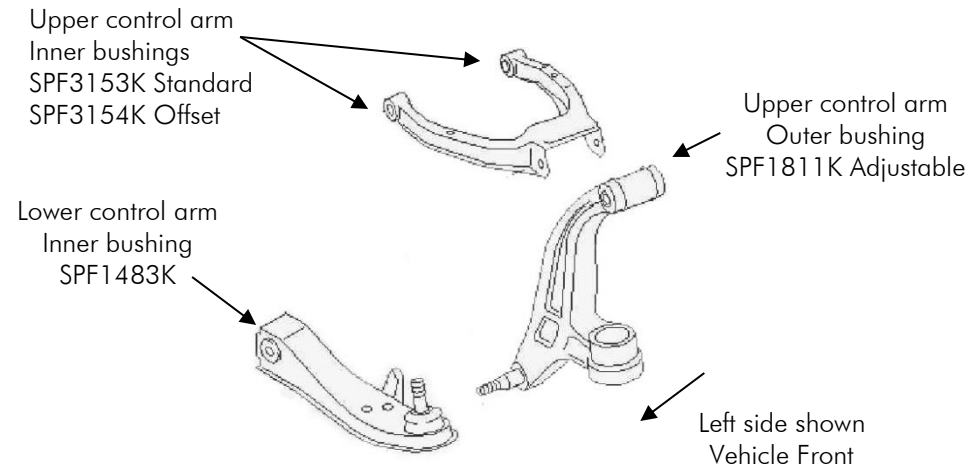

- Fit the new bushes into the hub. Then, with reference to the diagrams, line up the crush tubes and push them in with the vice or multigrrips. Note fine tuning of the camber can be done once the arms are assembled;

View from Right Hand Side
Looking from the Rear

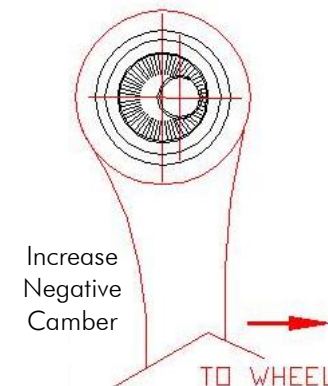
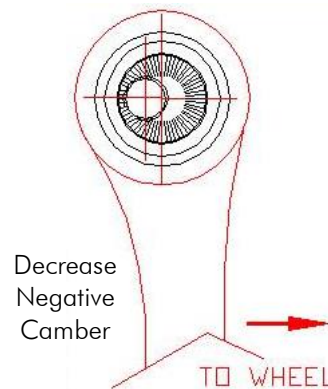

- Wheel align the vehicle, then Jack vehicle up and support on jack stands/hoist – remove the front wheels;
- Remove the front stub axle which contains the front upper outer control arm bushes. Make sure all ABS and brake lines are not damaged in removal process;
- The original bushes are pressed in to the stub axle - one from each end. Hold the arm in a vice and use an air chisel to remove the O.E. bushes. Put the air chisel under the flange and drive the bush out, alternate from one side to the other and make sure you don't damage the arm. Alternatively the bushes can be burnt out;
- Clean any burrs that may interfere with the new bushes then use the grease supplied to lubricate the bore of the new bushes and the outside surface of the offset crush tubes;

- Refit the stub axles to the car. Use the bolts and nuts supplied to fasten to the control arm. There are 2 long bolts, 2 short bolts, 4 washers and 2 nuts. Fit a short bolt and washer to one end of the arm (doesn't matter front or rear whichever is more accessible from under the car for when it comes time to adjust). Fit one nut to one of the long bolts and then put the washer on and fit it to the other end of the control arm. Tighten down and repeat for the other side;
- Refit the wheels and carry out a wheel alignment. Loosen off the short bolts and the locking nuts then with the use of a spanner turn the long bolt to fine tune the camber. Hold in the desired position then tighten the lock nut and short bolt.