

Fitting Instructions #5166IS

Dodge Hellcat

Sub frame Mount Bush kit

Front position

- With the vehicle on a hoist, remove the sub frame from the rear of the vehicle
- Using an air chisel or similar remove the metal tag from the OE bushing (present only in the front position) and fold the flange up on the bush so a pressing sleeve can fit up to the sub frame
- Using suitable pressing tools and a hydraulic press remove the OE bushes.
- Clean housing areas to remove any old original bushing materials ensuring the bores are smooth and free of burrs;
- Grease the bore of the housing and using the image as a guide insert "5166A" bushing into housing. Note the flange has a section removed to gain clearance on the sub frame care should be taken to align correctly.
- Fit "5166B" to the upper section of the sub frame this should also spigot over the lower "5166A" bushing
- Grease the bore of the bush and using multigraps or similar press crush tubes into the bush. **Note the longer of the 2 tubes fit this position**
- Fit new washer to the lower bushing when ready for installation

Figure 01 – Front of sub frame bushing installation

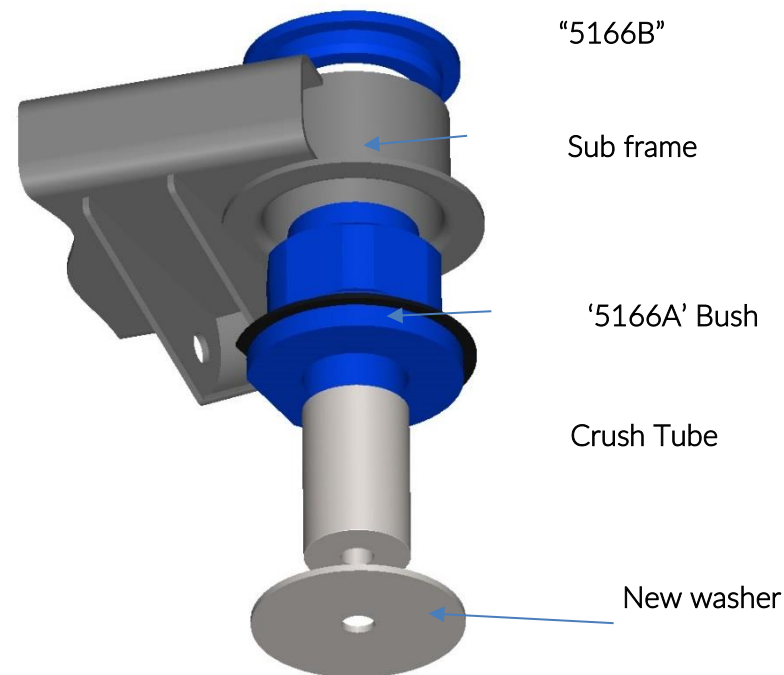

Exploded view of bushing installation
Note view is from underneath the vehicle

Fitting Instructions #5166IS

Rear Position

- Using an air chisel or similar fold the flange up on the bush so a pressing sleeve can fit up to the sub frame
- Using suitable pressing tools and a hydraulic press remove the OE bushes.
- Clean housing areas to remove any old original bushing materials ensuring the bores are smooth and free of burrs;
- Grease the bore of the housing and using the image as a guide insert "5167A" bushing into housing. Note the flange should face down in the vehicle
- Fit "5167B" to the upper section of the sub frame this should also spigot over the lower "5167A" bushing
- Grease the bore of the bush and using multigrips or similar press crush tubes into the bush. **Note the shorter of the tubes go in this position**
- Re use the OE washer and fit to the lower bushing when ready for installation.

Figure 02 – Rear of sub frame bushing installation

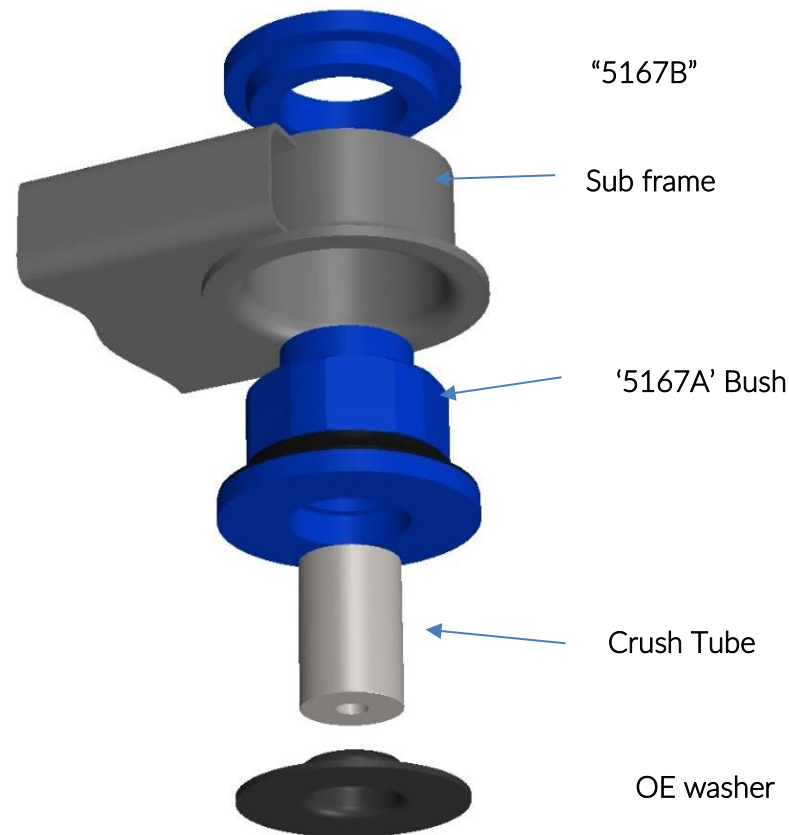

Figure 02 –Assembly

Exploded view of bushing installation
Note view is from underneath the vehicle