

# Fitting Instructions #4748IS

## Nissan X-Trail

### Sub-frame Mount to Chassis Rear Bushing

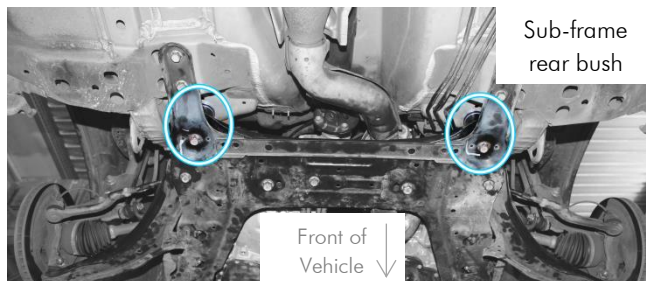

- Set the car up on a hoist, disconnect the lower control arms from the wheels and remove the sub-frame from the vehicle;
- Push the rear original bushes out of the sub-frame and clean the bush housing;
- Apply the supplied grease to the outside surface of the new SuperPro bushes;
- Install the new SuperPro '4748U' bush into the upper side and the '4748L' into the lower side of the housing, see Figure 01 ;
- Apply the supplied grease on outside surface of the tube, and push it into the bushes' bore until the step on the end with smaller outer diameter (O.D.) of tube is flush to the top part of the upper bush, see Figure 01 ;
- Install the new washer on the smaller O.D. of the tube, which will be located on the upper side of the sub-frame housing, see Figure 01 ;
- Install the other sub-frame rear bush using the same procedure;
- Reinstall the sub-frame in the vehicle and tighten all the bolts to the manufacturer's torque specifications.

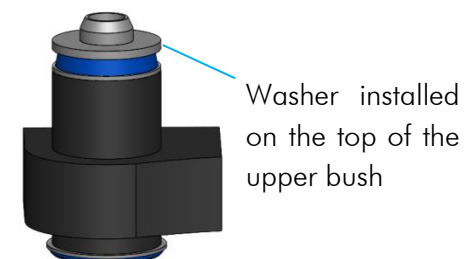
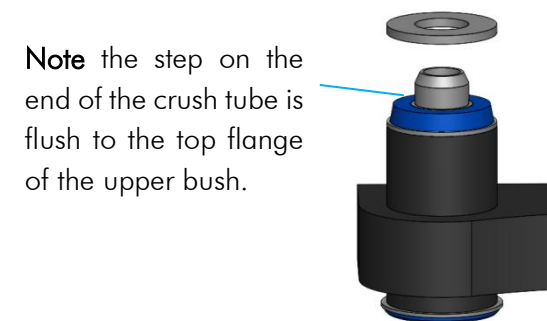
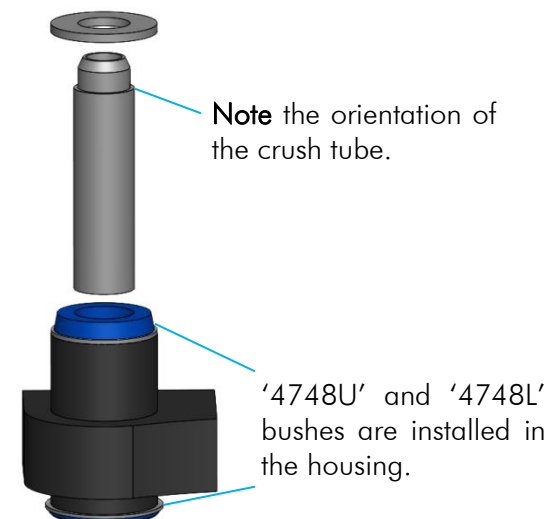
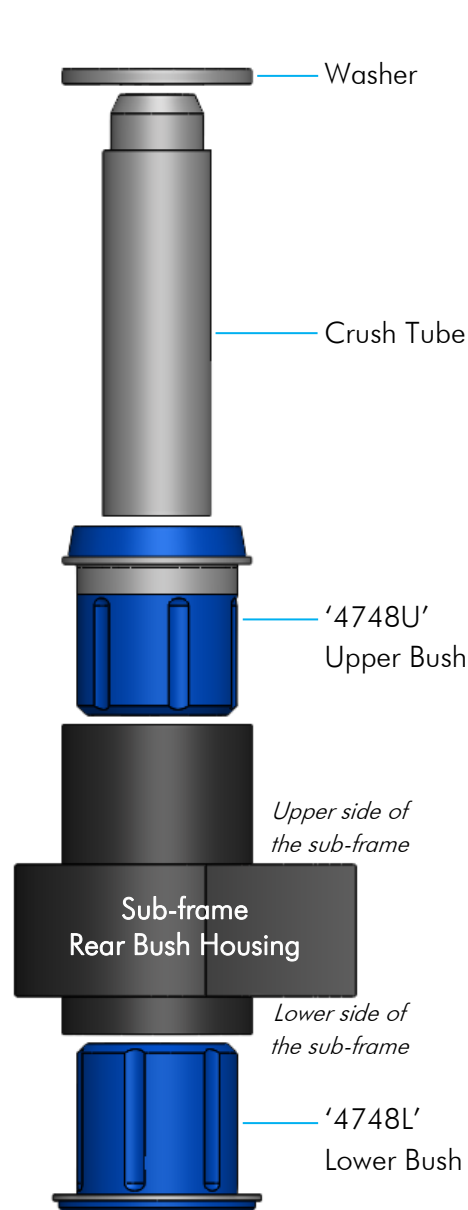

Figure 01 – SPF4748K kit installation procedure