

Fitting Instructions #1524IS

Honda Civic, Concerto and Integra

Front Upper Control Arm Inner Bushing



Depending on the kit you have purchased, the camber can be adjusted. Check the before wheel alignment to see what setting you require.

Note: Polyurethane bushings must be fitted to both sides of the vehicle.

- Wheel-align the vehicle before the job is started and note settings;
- With the vehicle on jack stands, remove the upper control arms;

Note Remove the original bushes including the steel shell;

- Using the appropriate pressing tools support the control arm and press in the new bushes according to your desired setting;
- Apply the grease supplied to the bore of the bush and the steel crush tubes. If you have SPF1941K with offset tubes push in the crush tubes as per drawing to give maximum camber change;
- Refit the control arms to the car, making sure you tighten the bolts with the arm held at 90 degrees to the mounts to give you the maximum camber offset;
- Re-assembly the rest of the car. Carry out a wheel alignment.

Note: manufactures torque setting must be used on all bolts and nuts.

Left Hand Side Rear View

SPF1524K – standard replacement kit

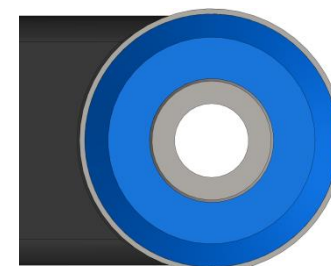

SPF1524K

SPF1941K – camber +/- both sides, approx. 0.5 degree change

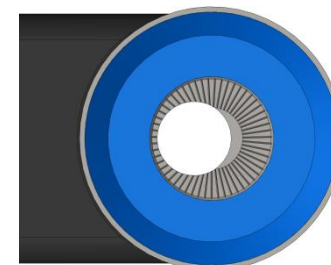

SPF1941K