

# Fitting Instructions #4457IS

Nissan D22 Navara 1997-on

## *Greasable Front Fixed Pin/Greasable Rear Shackle with Bushes*



**Important Note:** These components must be fitted by qualified persons only, to factory specifications, as per factory service manual.

Before commencing any work, ensure that the kit contains the required componentry (See Table 1).

### Installation Instructions:

- Use a jack to raise the rear of the vehicle and support chassis on vehicle stands or use a hoist to raise vehicle (recommended);
- Remove rear leaf springs as per factory service manual – taking into account the following
  - Disconnect any cables/hoses/sensors that could get overstretched if the axle housing and leaf spring is lowered – check leaf spring and both front and rear of axle housing for;
    - Brake hoses
    - ABS sensor cables
    - Handbrake cables
    - Diff breathers
    - Diff locker cables/hoses/sensors
    - etc
- Remove current bushes from leaf spring
  - If OE bushes are installed:
    - The leaf spring front eye bushes may need to be pressed out by metal shell;
  - If Aftermarket bushes are installed:
    - Press out steel tube (if applicable) from leaf spring front eye and remove bushes;
- Remove current bushes from vehicle rear chassis eyes;
- Remove any debris from chassis eyes and leaf spring eyes and clean with a rag;

### Install the new SuperPro bushings and shackles with the following procedure:

- See Table 1 for correct bush placement;

#### **Front fixed pin:**

- Screw the grease nipples into ends of the fixed pins and firmly tighten (see figure 1). **DO NOT** over tighten grease nipple as this will damage the thread;
- Place the locating spacer (chamfer faces vehicle) and pin plate on the pin as per figure 1;
- Screw and lightly tighten the deep nut on the pin (figure 1);
- Lightly grease outer bore of bushes (figure 2) and fit into the front leaf spring eyes;
  - For correct bush placement see Table 1;
- Liberally grease the inside and the ends of the bushes (figure 2) and the shank of the fixed pins;
- Push the steel tubes into the installed front leaf spring eye bushes;

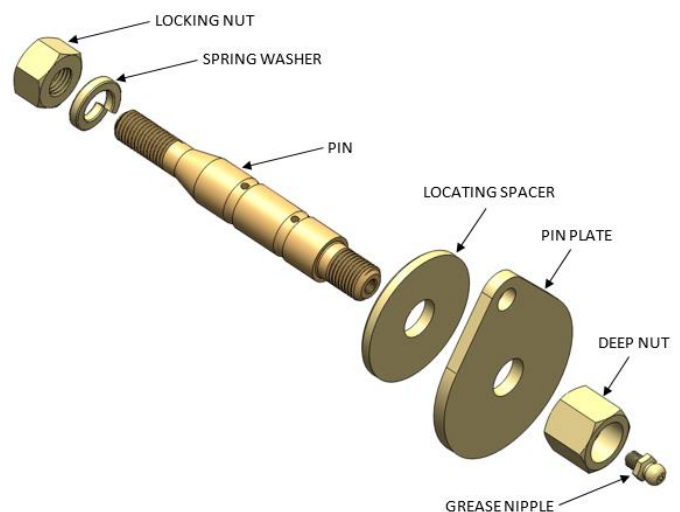

Figure 1: Diagram of fixed pin