

Fitting Instructions #4212IS

Mazda 6 GJ

Control Arm Upper – Inner & Outer Kit (Rear)

Note: Polyurethane bushings must be fitted to both sides of the vehicle.

- Wheel-align the vehicle before the job is started and note settings;
- Jack the vehicle up and support on jack stands/hoist;
- Using factory manual, remove the rear upper control arm of the rear suspension;
- Remove original bushes including the steel shell from the housing with the use of a hydraulic press and suitable pressing tools (refer to figure 2). Note: use press tool No. 3 & No. 5 to remove;
- Apply the grease supplied to the bore of the arm and the outside of the new polyurethane bushes and press the bush into the arm. Note: bush marked '4212' to be fitted to inner position and bush marked '4213' to be fitted to outer position (refer to figure 1);
- After that, apply grease to the bore of the bush and the outside of the crush tube and then, install the crush tube;
- Refit the rear upper control arm to the vehicle and tighten all bolts to manufacture's torque settings.
- Carry out wheel alignment.

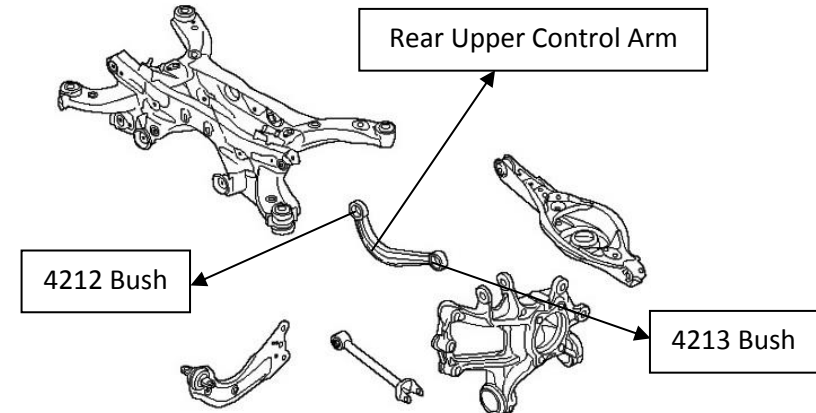

Figure 1: Rear Suspension Diagram



Figure 2: O.E Bush Removal

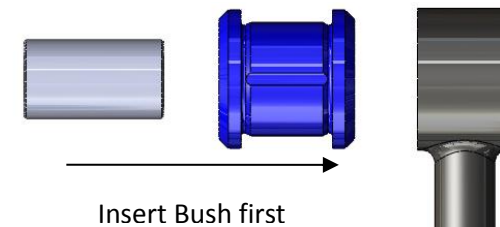

Figure 3: Polyurethane Bush Installation