

Fitting Instructions #4528IS

Volkswagen Transporter T5

Rear Control Arm Lower Outer Adjustable Bushing

- Wheel-align the vehicle before the job is started and note settings;
- Jack the vehicle up and support on jack stands/hoist and remove the lower control arms;
- Remove original shell part from the outer housing of the arm with the use of a hydraulic press and suitable pressing tools;
- Apply the white grease to the outside surfaces of the bush and inside the housing;
- Push the new '4528' bushes into the outer housing according to the Figure 02;
- Apply the white grease supplied to the bore of the bush and outside of the crush tube, and push it in;
- With reference to the Figure 01, adjust the new crush tube with the spanner provided to give the desired camber result;
- Apply the same procedure to the other arm;
- Refit the control arms to the vehicle and tighten all bolts to manufacture's torque settings and carry out a wheel alignment.

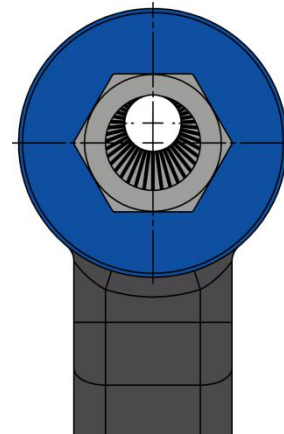

Figure 01 – RHS Control Arm Outer Side Front View

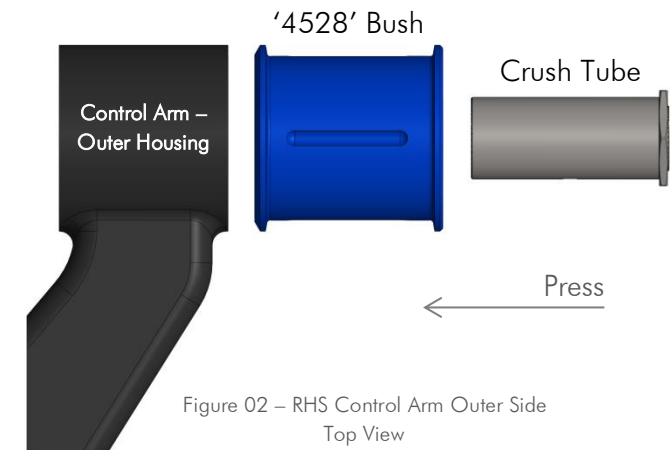

Figure 02 – RHS Control Arm Outer Side Top View

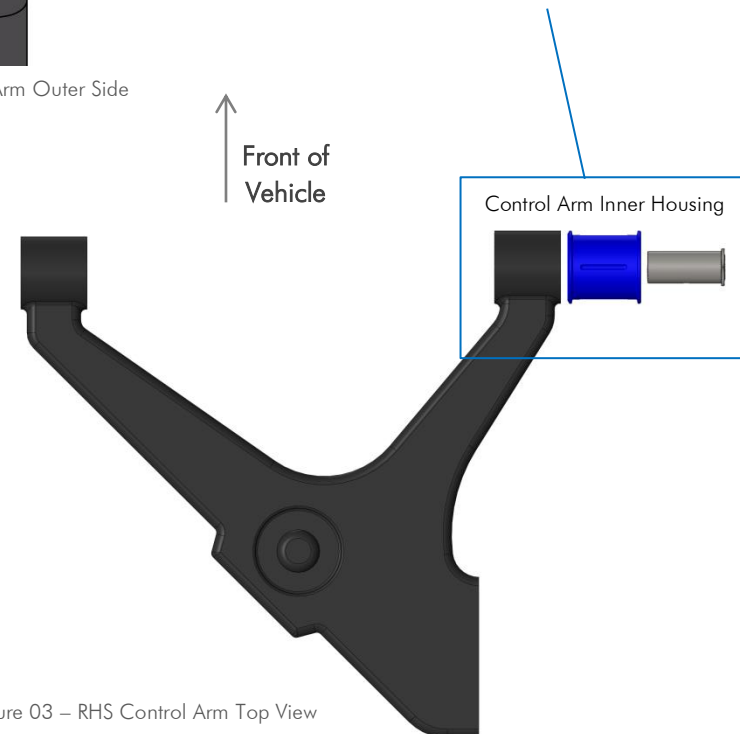

Figure 03 – RHS Control Arm Top View

Note: Polyurethane bushings must be fitted to both sides of the vehicle.

This kit should be installed by a Qualified Motor Mechanic.