

Fitting Instructions #3106IS

Subaru Impreza WRX GH

Rear Lower Control Arm Inner Bushing



- Moving the control arm towards the centre of the car will give you more positive camber (approx. 1 degree)
- Moving the control arm towards the outside of the car will give you more negative camber (approx. 1 degree)

Note: Polyurethane bushings must be fitted to both sides of the vehicle.

- Wheel-align the vehicle before the job is started and note settings;
- Support the vehicle on jack stands or a hoist and remove the lower control arms;
- Using the appropriate pressing tools remove the original metal shelled bush and push in the new bush marked '3106';
- Apply the white grease supplied to the bore of the bushes and the outside of the steel crush tubes. With reference to the diagrams fit the crush tubes to gain desired results. Note if you are after negative camber decrease we recommend you fit SPF3101K first due to drive shaft movement;
- Refit the control arms to the car, making sure you tighten the bolts with the arm held at 90 degrees to the mount as this will give you the maximum camber offset (1 degree);
- Re-assemble the rest of the car and then carry out a wheel alignment;

Note: manufactures torque setting must be used on all bolts and nuts.

Left Hand Side Shown

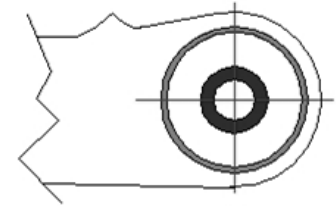

Standard Replacement

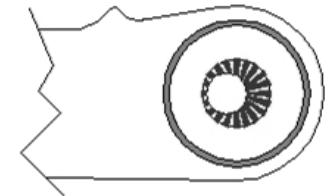

Camber Decrease

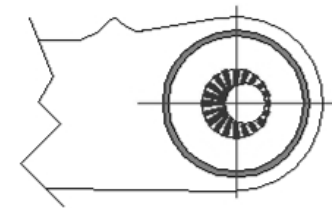

Camber Increase