

# Fitting Instructions #3232PIS

## Ford Territory / Falcon BF & FG

### Rear Differential Centre Support Bushing

**Note:** This instruction sheet is a suggested method of removing the diff bushes. There are various techniques and tools available to do the job. Manufacturer's torque settings should be used to tension all bolts.

- Remove the rear seat base, disconnect the wheel speed sensors and push out from rubber bung;
- Set the car up on a hoist and remove the rear wheels, remove the rear brake calliper mounting bolts and secure calliper out of the way;
- Remove rubber exhaust hangers;
- Mark the tail-shaft position and counterweights, and disconnect the shaft;
- Disconnect the handbrake cables from the 'T' junction;
- Remove the 2 stabilizer rod bolts from the chassis rails, also remove the side bolt from the right side of the rear diff bush housing near the wheel well;
- Support lower control arm and remove the lower shock absorber bolt, also remove the 2 front blade control arm nuts, lower down until blade control arm is clear from the studs. Be careful of spring tension;
- Lower the car and support the cradle with 3 or more jack stands or similar, then remove the 6 sub-frame nuts/bolts;
- Slowly raise the vehicle making sure no wires brake lines, shock absorbers, etc., are damaged;

- Separate and lower rear end from vehicle, Figure 1 ;
- Remove diff vibration absorber;
- Use screwdriver or chisel to crush the outer shell and remove bush. Force may be needed to be applied to the other side of the bush to remove it;
- Fit new bush. Ensure that bush is kept square to the mounting surface. All thread and washers and spacers may aid the process;
- See following page for bush replacement instructions;
- Reassemble the vehicle in reverse order.



Figure 1 - Back end removed from vehicle

# Fitting Instructions #3232PIS

## Differential Centre Support bushes

**Note:** some models have a counterbalance attached to the same bolt as the bush, see Figure 4. If there is one, remove the bolt and the counterbalance first.

- Use a hacksaw or similar to cut through the shell, and then chisel the shell out or use a pair of vice grips to remove or use a screwdriver, to fold the shell and remove;
- Clean any burrs that may have happened;
- Using the stepped down parallel spigot on the outer shell as a guide, use an all-thread and appropriate washers/bearings, Figure 2, etc. to draw the bush in until the bush is flush with the back of the sub-frame. Make sure the bush is set square in relation to the housing;
- Refit the outrigger arms to the diff then fit the new washers over the existing bolts, Please note that the concave side of the washer should be facing outwards, Figures 4 and 5;
- Reverse disassembly procedure to reinstall.

**Note:** Make sure there is clearance between the outriggers and the cradle; Make sure there is clearance between the fuel tank and the LH outrigger bolt.



Figure 2 – Insertion of new bush

**Note:** The "5091" polyurethane bush should face towards the rear of the car when installed.

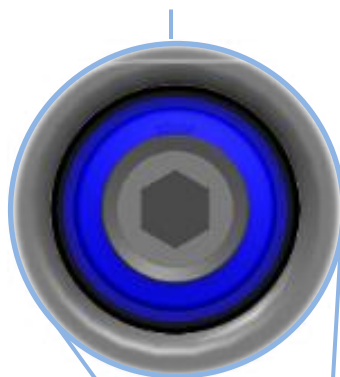
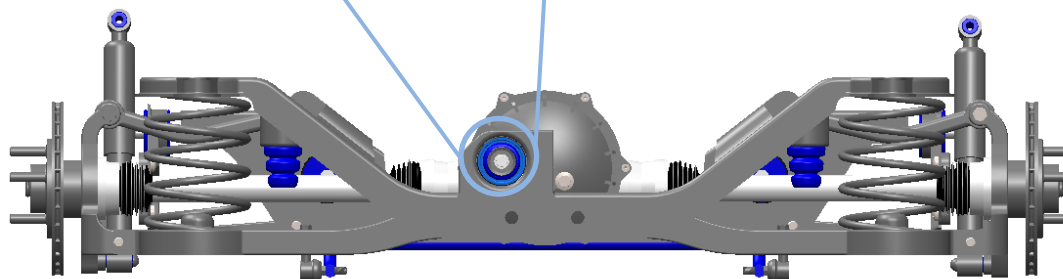

Figure 3 – '3232PE55' Bush



Counterbalance

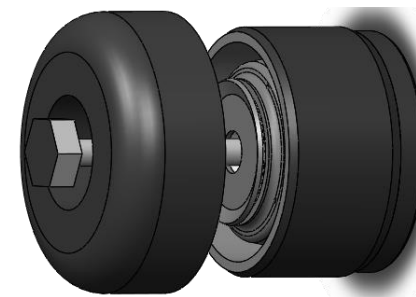

Figure 4 – '3232PE55' Bush - Models with counterbalance

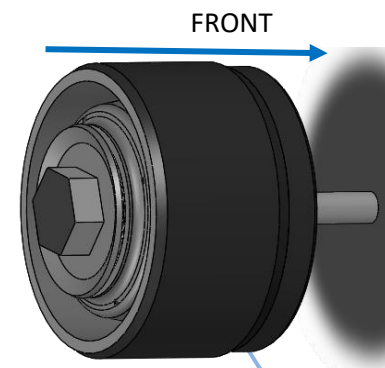

Figure 5, '3232PE55' Bush - Models without Counterbalance

Note that the smaller diameter faces towards the front of the car.