

# Fitting Instructions #4403IS

## Citroen Dispatch G9C

### Swaybar to chassis mount bush (Front)

---

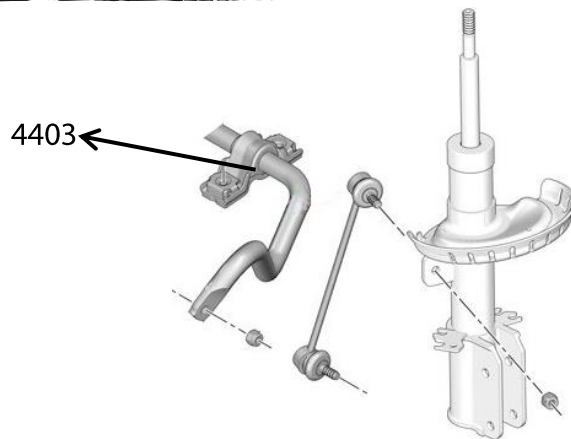

**Note:** Polyurethane bushings must be fitted to both sides of the vehicle.

- Jack the vehicle using jacking points on body, not cross member as this has to be moved later;
- Remove front wheels and both sway bar link rods. Also, remove the inner guard liners for easier access;
- From under the vehicle, undo and break taper of both tie rod ends. Then, undo the 4 retaining bolts (2 each side) on the swaybar bracket to cross member follow up with removing the 2 retaining bolts on the rack to cross member;
- Remove the retaining bolt on the engine exhaust pipe to the rubber insulator at the rear of the cross member. Using a jack stand or similar, support on the flat surface at the rear of the cross member (in the middle beside the engine pipe);
- Remove 6 bolts (3 each side) at the rear of the cross member and remove 2 retaining bolts on brace bar from cross member up to body, only the lower bolt needs to be removed.
- Loosen but do not remove the 2 bolts (1 each side) on the front of the cross member to help keep cross member located. Then, gently lower about 1 inch on the rear of the cross member.
- This will then allow room for the swaybar to move sideways. By using a die grinder, remove enough metal to weaken the flared joint of the lower plate to the top 'U' bracket. Then, use a flat chisel to knock the bracket apart and remove the factory swaybar bush;
- Generally clean up the burrs on the bracket to allow the parts to mate up easily.
- Apply the white grease supplied to the bore and body of the bush, then install the new bush to where the rubber bush sit originally;
- Refit the swaybar bracket, all other loose parts and cross member back to the vehicle in reverse order. Tighten all bolts to manufactures torque settings;