

Fitting Instructions #1741IS

Mazda RX7

Front Control Arm Lower Rear Bushing



Note: Polyurethane bushings must be fitted to both sides of the vehicle.

- Wheel-align the vehicle before the job is started and note settings;
- Jack the vehicle up and support on jack stands/hoist;
- Remove the lower control arms;
- Remove original bush from the arm;
- Generously apply the supplied grease to the outside of the control arm peg and into the bush bore, then push the control arm into the bush, as shown in the Figure 01. With reference to the diagrams and the settings required, Page 02, fit each bush into their respective position;
- Apply the supplied grease to the outside of the new SuperPro '1741', '1743' or '1743A' bush (depending on the kit you've purchased);
- Refit the control arms to the vehicle, the OE bracket and tighten all bolts to manufacture's torque settings and carry out wheel alignment.

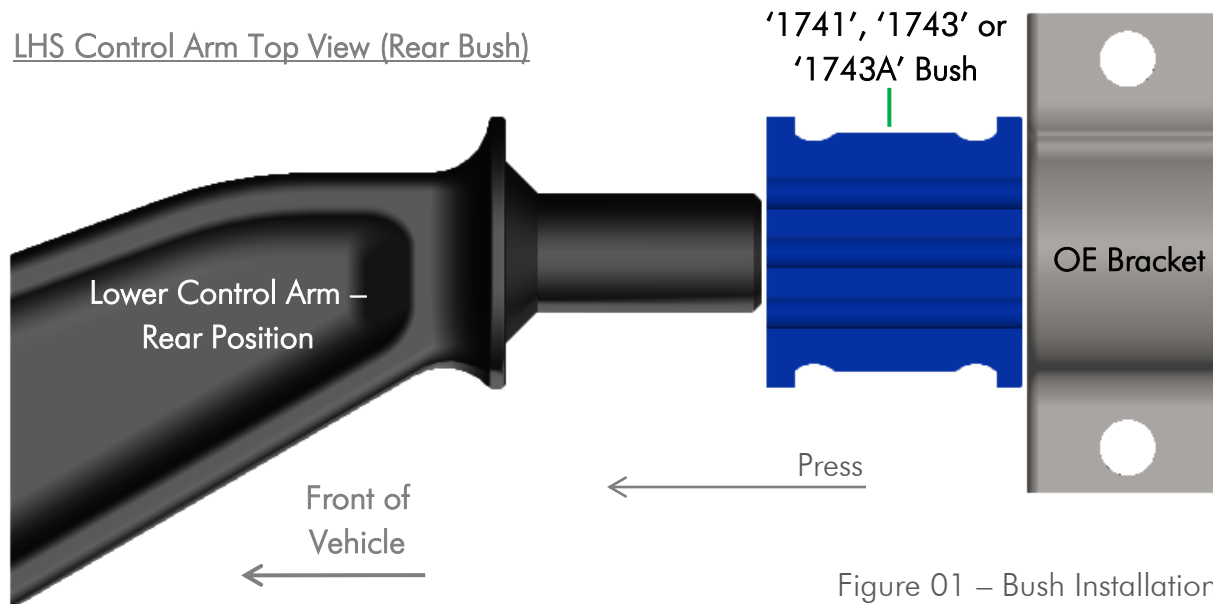
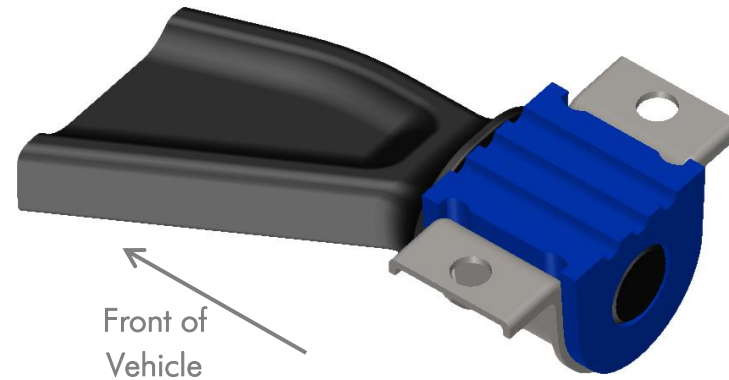
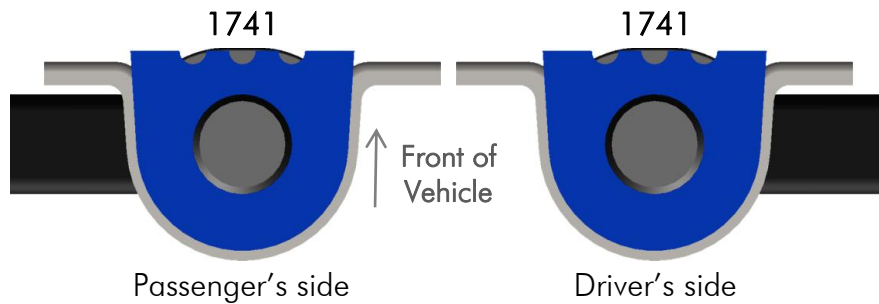

Figure 01 – Bush Installation.

Fitting Instructions #1741IS

As viewed from the rear of the control arm

Kit #1741K – Standard Replacement
No caster change.



Kit #1743K – Double Offset
Passenger's side caster increase and Driver's side caster decrease.

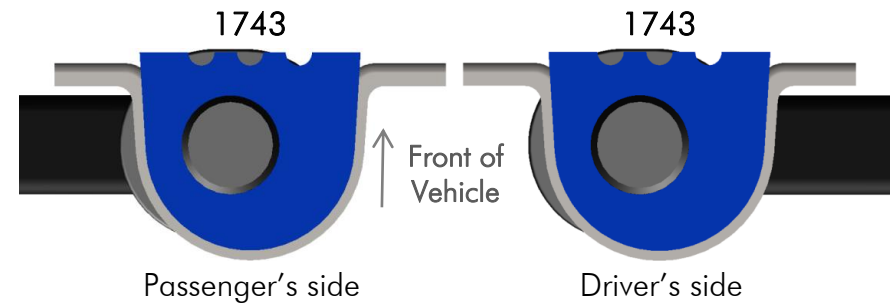

Kit #1742K – Single Offset
Passenger's side caster increase.

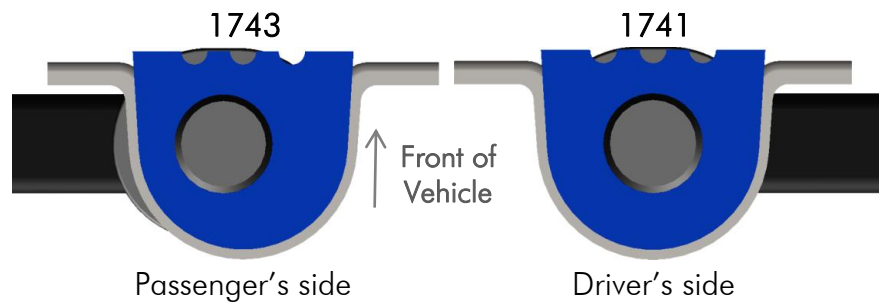

Kit #1743AK – Double Offset
Passenger and Driver's side caster increase.

