

Fitting Instructions



SKU

PRODUCT

T4P637

**TAG Heavy Duty Towbar to suit
Iveco Daily Vi (03/2014 - 04/2016),
Daily (05/2015 - on)**



Scan for latest
version of these
instructions

SPECIFICATIONS

- Towbar Class: Heavy Duty
- Towing Capacity: 3200kg

IN THIS GUIDE

- Fitment Instructions
- Torque Settings
- Warranty Info

Towbar Fitting Instructions



Step-By-Step Instructions

Warning:

Safety First: Always use correct safety equipment.

This towbar is NOT to be drilled, cut, welded or modified in any way.

Check the surrounding area before drilling into chassis or body panels for fuel lines, wiring harnesses and other components that may be a hazard.

General:

Before fitting this towbar read fitting instructions and check installation hardware is correct.

Check that the towbar is suitable for the vehicle and be wary of any changes to the vehicle design that may conflict with the fitting of this towbar.

After drilling, blow any filings clear, remove any swarf and treat exposed metal with a rust inhibitor.

If this vehicle requires a bumper cut out, please check to make sure that you measure twice and check twice before cutting any panels as some bumper profiles can change.

If you are not sure then ask your towbar supplier.

Tighten all bolts as specified on the last page.

Towbar Fitting Instructions

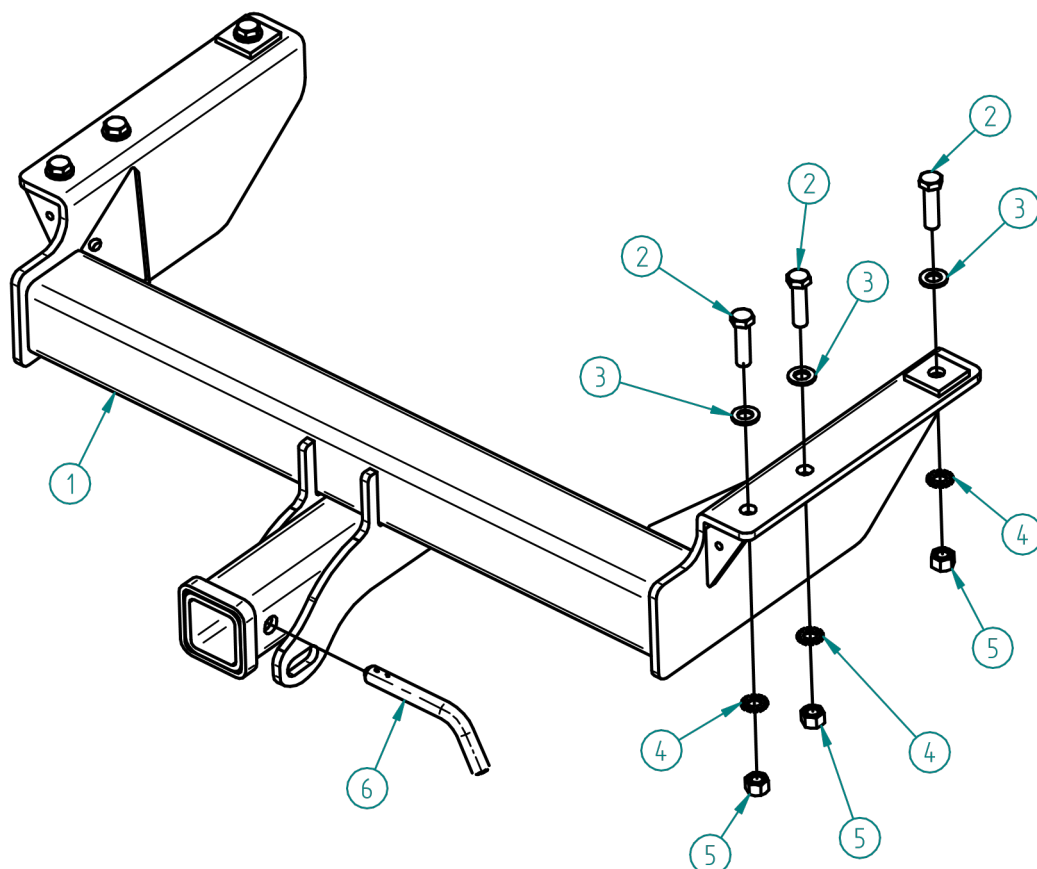

Tools Required: Spanners, Sockets, Screwdriver, Torque wrench

ITEM NO.	DESCRIPTION	QTY.	ITEM NO.	DESCRIPTION	QTY.
1	Towbar Assembly	1	5	M12x 1.75 Nut	6
2	M12x 1.75x 40 Bolt	6	6	Class 4 Pin & Clip	1
3	M12 Shakeproof Washer	6	7	L4045 Ball Mount	1
4	M12 Flat Washer	6	8	Compliance Label	2

Towbar Fitting Instructions



Step 1. Fit Towbar

- Remove and discard step fasteners A as circled in pic 1.
- Loosen step fasteners B as circled in Pic.2
- Lift towbar up to chassis rails and insert 3x M12x 40 bolts into each chassis rail. Fasten with nuts & washers to torque specification as per page 2.
- Tighten step mount bolts.
- Apply plastic hitch cover to receiver. Insert ball mount into receiver and secure with pull pin & clip.

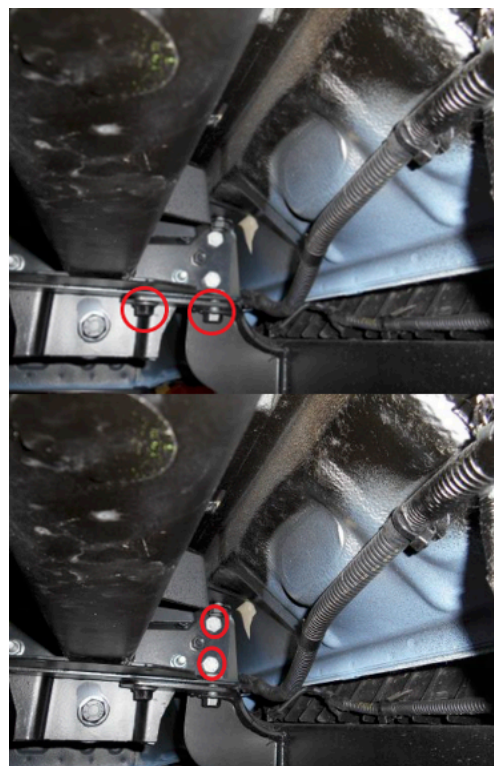

Step 2. Apply Door Sticker

- Apply one of the compliance labels to the pillar of the driver's door. Leave the remaining label & the fitting instructions in the vehicle handbook.



Torque table for bolt tightening

Diameter	Pitch	Grade	Torque	Unit
M8	1.25	8.8	29	Nm
M10	1.25	8.8	57	Nm
M10	1.50	8.8	44	Nm
M12	1.25	8.8	101	Nm
M12	1.50	8.8	97	Nm
M12	1.75	8.8	77	Nm
M14	2.00	8.8	122	Nm
M16	2.00	8.8	190	Nm
Imperial Bolt Torque Settings				
$\frac{3}{8}$ "	UNC	8	44.75	Nm
$\frac{1}{2}$ "	UNC	8	108.5	Nm

TAG Warranty Statement

SWD warrants your TAG Towbar for its full product life under the following conditions:

- You can show proof of purchase.
- The towbar has been correctly installed by a suitably qualified installer.
- The towbar has not been modified or abused in any way and has only been used for the purpose intended.
- The towbar was not fitted second hand to your vehicle.

The extent of this warranty includes materials and workmanship used in the manufacture of the towbar and is to the equivalent value of current, full replacement cost.

Nothing stated or implied in this warranty limits in any way, the statutory rights that you may have.

To make a claim visit the original installer in the first instance or, if you are unable to or are not satisfied with their help, then contact us direct by phone on 1300 669122 or visit www.swd.com.au