

Fitting Instructions



SKU

PRODUCT

TXR819

TAG 4x4 Recovery Towbar to suit Toyota Hilux Styleside (10/2015 - on)



Scan for latest version of these instructions

SPECIFICATIONS

- Towbar Class: Extreme Recovery
- Towing Capacity: 4500kg

IN THIS GUIDE

- Fitment Instructions
- Torque Settings
- Warranty Info

Towbar Fitting Instructions

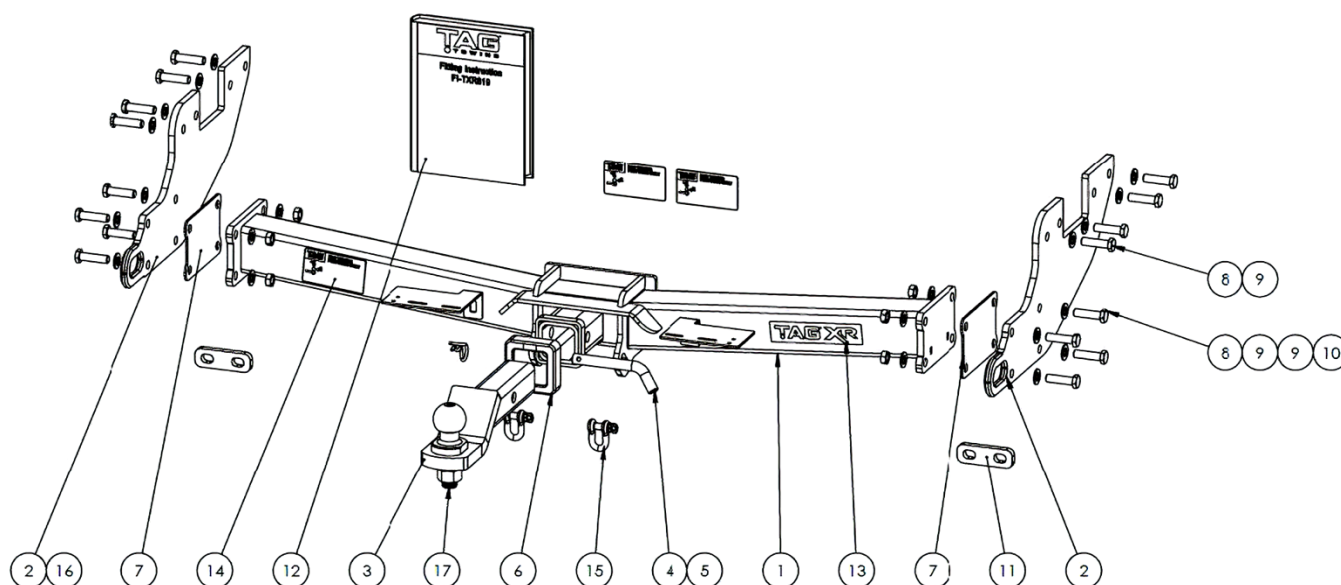

Tools Required: 18mm Spanners and or Sockets, 33mm Socket, Torque wrench, Impact Wrench

Item No.	Description	QTY.	Item No.	Description	QTY.
1	Centre Assembly	1	10	M12x1.25 Nut	8
2	End Plate Assembly	2	11	Bumper Spacer - 10mm	2
3	L4045 Powder Coated TBM	1	12	TXR819 Fitting Instructions	1
4	Class 4 Pin	1	13	TAG XR Sticker	1
5	E-Clip for Class 4 Pin & Clip	1	14	TAG Compliance Sticker	3
6	TAG Hitch Receiver Cover	1	15	D-Shackle	2
7	Endplate Spacer - 3mm	2	16	Tag WLL Sticker	1
8	M12x1.25x45 Hex Bolt	16	17	50mm TAG Tow Ball	1
9	M12 Flat Washer	24			

Step-By-Step Instructions

Warning:

- This product is for towing purposes only and must only be loaded as shown in your vehicle Owner's Manual.
- This towbar is NOT to be drilled, cut, welded, or modified in any way.
- Check behind chassis rail and body panels before drilling to ensure no hazards are present
- All load ratings shown are under the assumption your trailer has a functional braking system installed
- When installed in positions other than the one depicted in these instructions the Tow Ball Mount may interfere or obstruct certain features of your vehicle (tailgate opening, Chassis clearance, etc.)

General:

- Before fitting this towbar read fitting instructions and check installation hardware is correct.
- Check that the towbar is suitable for the vehicle and be wary of any changes to the vehicle design that may conflict with the fitting of this towbar. (Tray, Canopy, Suspension etc.)
- After drilling, blow any filings clear, remove any swarf and treat exposed metal with a rust inhibitor.
- The high tensile fasteners supplied with this product are an integral feature to achieving the specified rating, if replacement is required ensure that fasteners of the same grade (8.8) & quality are used. Contact an authorised TAG distributor or the TAG fitment centre - (07) 3208 3022 - if further information is required.

Towbar Maintenance and Care:

It is recommended, when not in use, the Tow Ball Mount assembly and class 4 Pin and Clip is stored inside the car away from moisture to prevent standing water from forming rust. Inspect to ensure, on regular basis, fasteners are torqued to the specifications below and in good condition.

Ensure that the fitting instructions are read and understood prior to fitment

Place these instructions in the vehicle's glovebox after installation is completed

Towbar Fitting Instructions



Step 1. Remove & Modify Bumper, Fit towbar, Reinstall Bumper

- a. Lay out the fitting kit next to the towbar with the fasteners in their respective positions on the towbar and ensure all hardware to be included is in the kit and correct.
- b. Ensure any wiring connected to the rear bumper is disconnected.
- c. Carefully with 2 people. Remove the 2X bolts securing the bumper to the chassis rail on each side and remove the bumper from the vehicle.
- d. Remove the brackets from the bumper, Fit the supplied 10mm bumper spacers between the brackets and the bumper to increase overall width by 20mm.
- e. Loosely secure both end plates to the chassis using the rearmost holes of the towbar and fasteners supplied.

NOTE: Tighten the bolts enough to hold the end plates against the chassis rails. DO NOT tighten to torque spec.

- f. Offer centre assembly to the endplates and secure using the 8X M12 Bolt sets provided if a gap of 3mm or more is present between the endplates and centre assembly the spacer plates provided will need to be added.
- g. Carefully with 2 people reattach the bumper to forward most holes of the towbar.
- h. After making sure the towbar and bumper are level and sitting in the right position tighten and torque all fasteners to torque spec (see table) starting with the towbar bolts.

Step 2. Apply Door Label & Fit Ball Mount

- a. Apply one of the compliance labels to the pillar of the driver's door. Leave the remaining label & the fitting instructions in the vehicle handbook.



Torque table for bolt tightening

Diameter	Pitch	Grade	Torque	Unit
M8	1.25	8.8	29	Nm
M10	1.25	8.8	57	Nm
M10	1.50	8.8	44	Nm
M12	1.25	8.8	101	Nm
M12	1.50	8.8	97	Nm
M12	1.75	8.8	77	Nm
M14	2.00	8.8	122	Nm
M16	2.00	8.8	190	Nm
Imperial Bolt Torque Settings				
3/8"	UNC	8	44.75	Nm
1/2"	UNC	8	108.5	Nm

TAG Warranty Statement

SWD warrants your TAG Towbar for its full product life under the following conditions:

- You can show proof of purchase.
- The towbar has been correctly installed by a suitably qualified installer.
- The towbar has not been modified or abused in any way and has only been used for the purpose intended.
- The towbar was not fitted second hand to your vehicle.

The extent of this warranty includes materials and workmanship used in the manufacture of the towbar and is to the equivalent value of current, full replacement cost.

Nothing stated or implied in this warranty limits in any way, the statutory rights that you may have.

To make a claim visit the original installer in the first instance or, if you are unable to or are not satisfied with their help, then contact us direct by phone on 1300 669122 or visit www.swd.com.au