

Install Guide

Front Control Arm - Rear Bushings Caster Increase

Application - Nissan Elgrand E52
- 2010-on

(Always refer current catalogue listing)

Contents - 2x vertical bushings
(caster offset / double bonded)

WHITELINE performance caster bushings significantly improve vehicle turn in at speed. This is achieved using a low compliance offset bushing. The offset firm bushing increases the static caster value - whilst maintaining dynamic wheel alignment settings on the limit.

- Raise vehicle evenly and safely support.

Never rely on a jack only.

- Proceed to remove front wheels. Next, un-bolt and remove the lower control arms from vehicle.

Tip - use lubricant on bolts prior to removing.

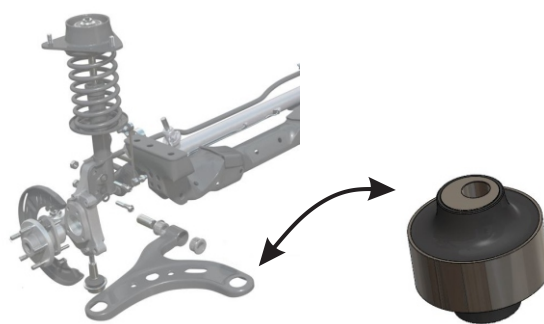

It is recommended that a licenced workshop or tradesperson carry out the above procedure and that workshop manual and relevant safety procedures are followed in addition to the above.

Install Guide

Front Control Arm - Rear Bushing Caster Increase

- Press out old bushing with hydraulic press (including steel outer shell)



- Press in new bushing into clean control arm.

NOTE offset centre tube. Place the bolt hole towards the centre of vehicle.
Refer below images:

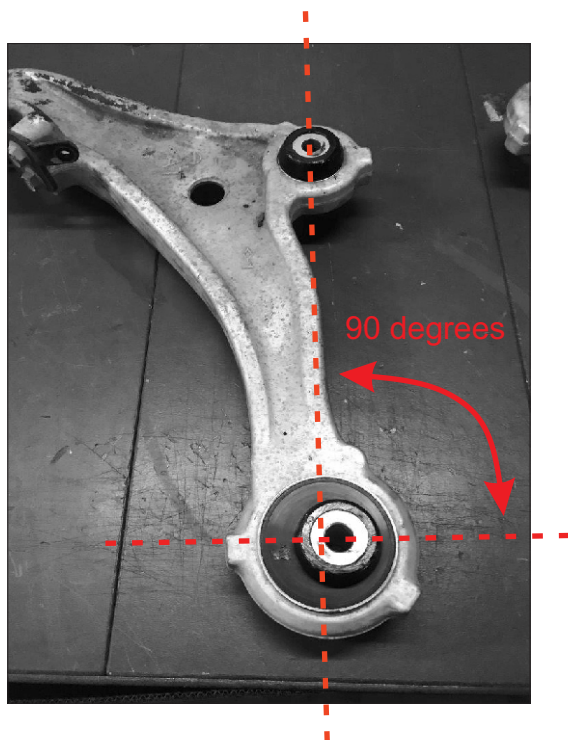

- Re-fit arms to vehicle using original bolts.
- **IMPORTANT** - a wheel alignment will be required soon after install.
- Re-check all bolts after 500kms.

It is recommended that a licenced workshop or tradesperson carry out the above procedure and that workshop manual and relevant safety procedures are followed in addition to the above.