



Instructions

Front Control Arm Bushings

This instruction sheet should be used in conjunction with the workshop manual and proper safety procedures followed.

Application - Honda Civic FK

(Refer current catalogue for complete listing)

- Raise vehicle evenly and safely support.

Never rely on a Jack only

- Proceed to remove front wheels. Un-bolt front control arms.

- The original bushing will need to be pressed out or drilled out. If drilling - drill closest to the welds on control arm.

- Refer image below for bushing installation.

- Grease bushing internal diameter and face.

- Push in supplied steel tube and washer as per below - note steel tube is stepped.

- Re-fit arm to vehicle.

- A wheel alignment after install is recommended.

- Contents** - Bushing 69494 x2
 - Bushing 69495 x2
 - Steel tube 24x14x60 x2
 - Steel washer 38x22x3 x2
 - Grease

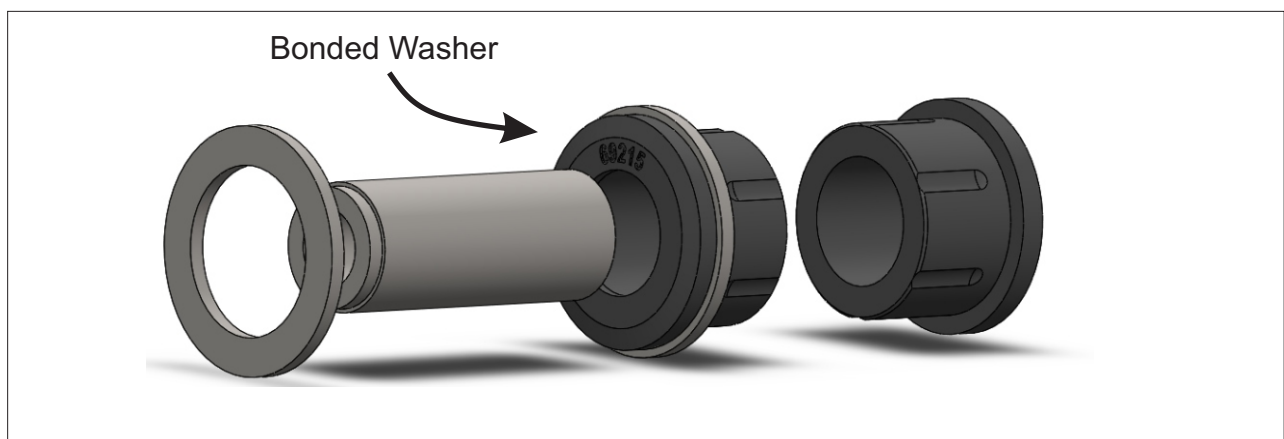

N.B: It is recommended that a licenced workshop or tradesperson carry out the above procedure and that workshop manual and relevant safety procedures are followed in addition to the above.