

Fitting Instructions #Z6279

Toyota Land Cruiser Prado 150 Series

Front Lower Control Arm Bushes All



- Wheel align the vehicle before the job has started and check the camber/caster readings
- Jack vehicle up on hoist/stands
- Remove front lower control arms
- Use a 20mm drill bit, drill through the washers to remove them from the crush tube
- If using an oxy-acetylene torch you must be in a well ventilated area and use the appropriate safety equipment
- Use the oxy-acetylene torch to heat the inner crush tubes until the bonding on the rubber has let go – push the crush tube out. Apply heat to the outside diameter of control arm until the rubber bonding lets go of the shell then push the remaining rubber out
- Using a hacksaw or similar cut through the remaining shell then use a chisel to remove the shell from the control arm. Clean out the holes in the control arm and paint the eyes if they need to be
- Using a hydraulic press appropriate pressing tools and the images on the next page press the new bushings into place.
- Grease the bore of the installed bushes and use an arbour press or similar to fit the crush tube.
- **Note:** The longer crush tube fits the rear position & the shorter crush tube fits the front position.
- There are 8 off washers included in the kit and these need to be fitted in the correct orientation. See figure on the following page (exploded image of arm) for correct positioning.
- **Note:** These washers need to be pressed onto the end of the crush tubes using an arbour press or similar.

Note: use a plate disc and press on the end of the urethane part of the bush as per photos and sketches over page.

- Refit the control arms and carry out a front wheel alignment
- Recheck all bolts after 1000km or 1 month
- Manufactures torque setting must be used on all bolts.

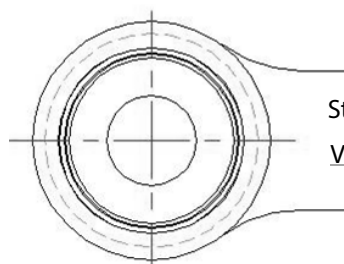

Standard Replacement
View from Rear of RHS



Fitting Instructions #Z6279

