

Toyota Land Cruiser 200 Series
 2011 Production Onwards
SECOND ROW CANVAS SEAT COVERS
 Installation Instructions

Part Numbers: PZQ22-60210

Installation Time: Approx 30 mins.

Place these instructions in vehicle's glovebox after installation is complete.

Important



- Please read these instructions carefully before installation, paying special attention to all Note & Caution notes. Failure to do so may result in damaged parts or injury to the installer or customer.
- Regularly inspect seat cover for wear, damage and seat cover misalignment.
- Adjust alignment if seat cover twists or moves from its original, centrally aligned position.

WARNING!



- This seat cover suits Toyota Land Cruiser **ONLY**.
- **DO NOT** fit to models fitted with leather seats
- Install seat covers exactly as described in installation instructions. If during normal usage, the seat cover is damaged, **DO NOT** repair. It must be replaced.

Part List

1. Backrest Cover RH
2. Seat Base Cover RH
3. Backrest Cover RL
4. Seat Base Cover RL
5. Side Headrest Covers x 2
6. Centre Headrest Cover

Layout

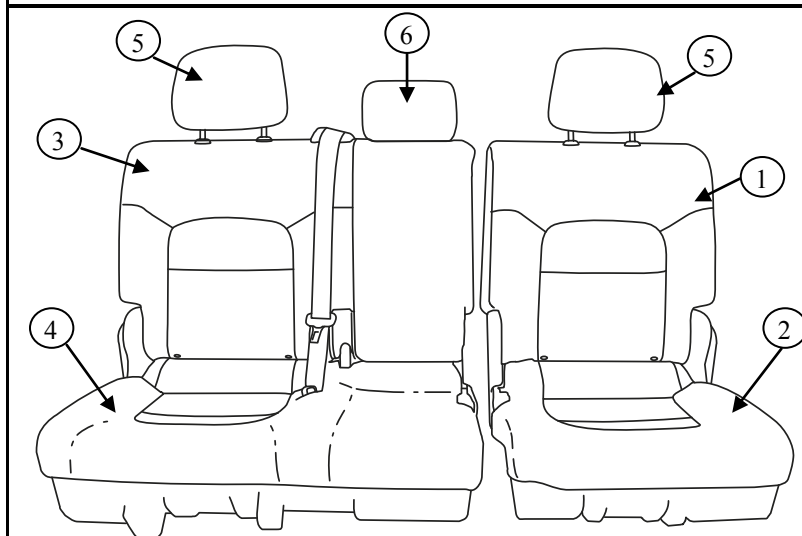

Care Instructions

- **HAND WASH IN COLD WATER ONLY**
- Clean only with cold water and a soft brush. Do not scrub hard.
- Do not use soaps, detergents, bleaches.
- Line dry in shade only, do not tumble dry
- Do not Dry Clean or Machine Wash
- Prompt removal of organic matter will maintain fabric appearance and longevity.

Part List		
No.	Item	Qty
1	Headrest Hole	6
2	Hook Tape	25
3	Loop Tape	22
4	Strap	2
5	Elastic	5
6	Seat Belt Hole	3

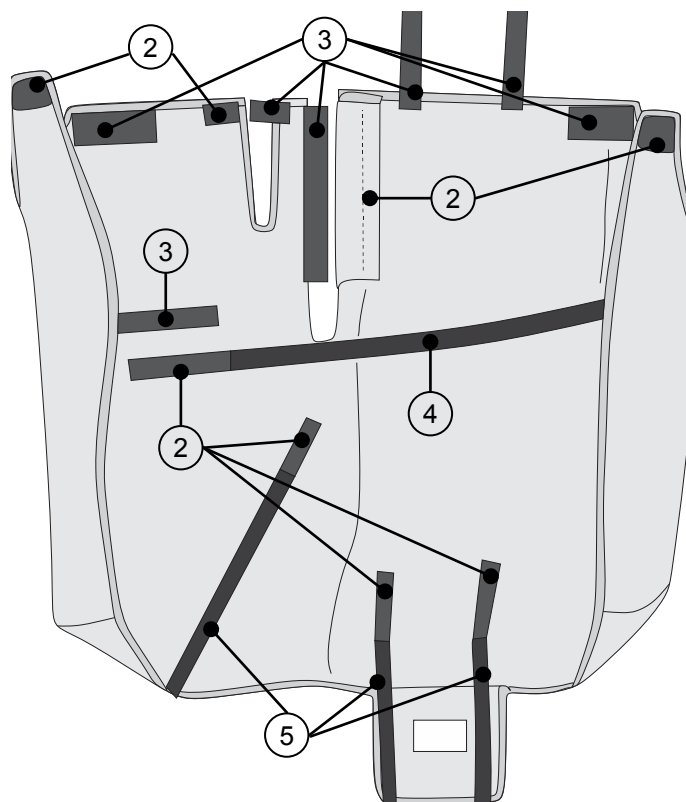
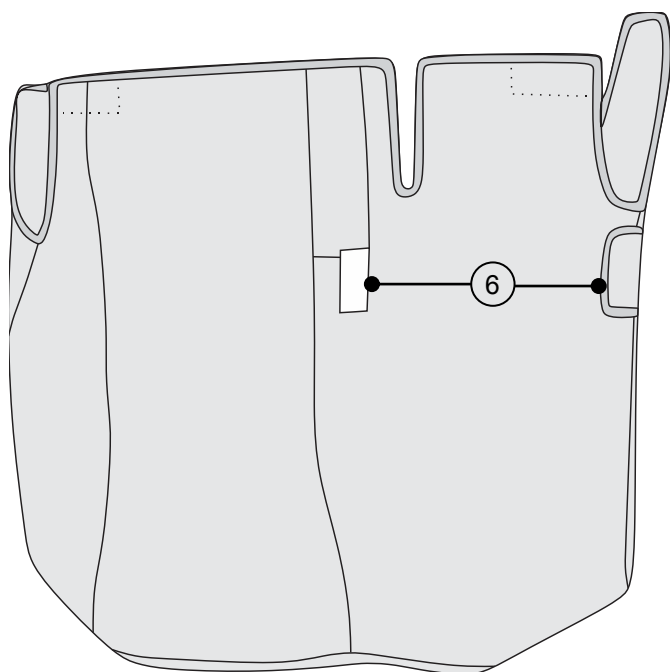
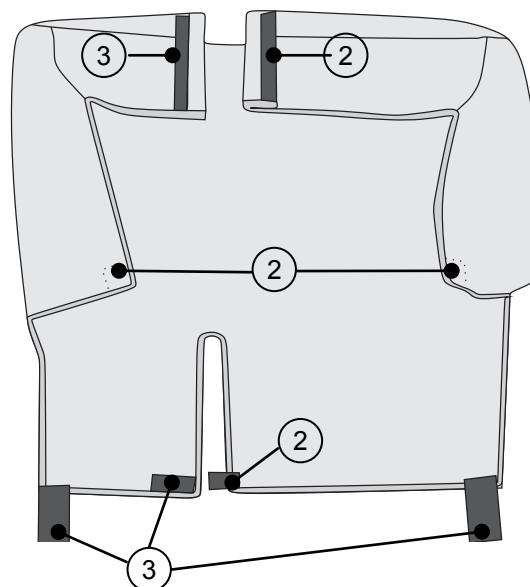
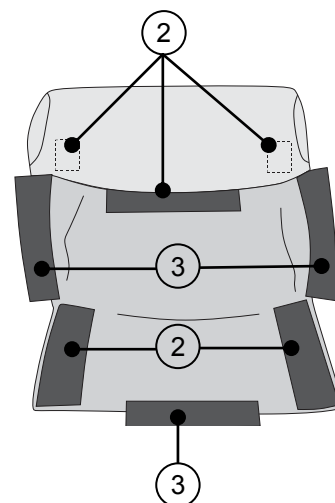
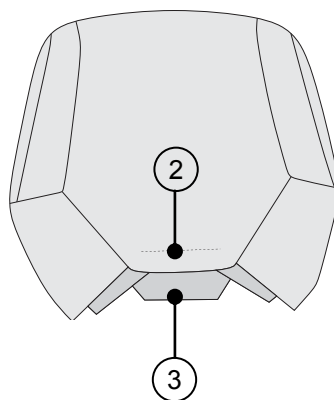

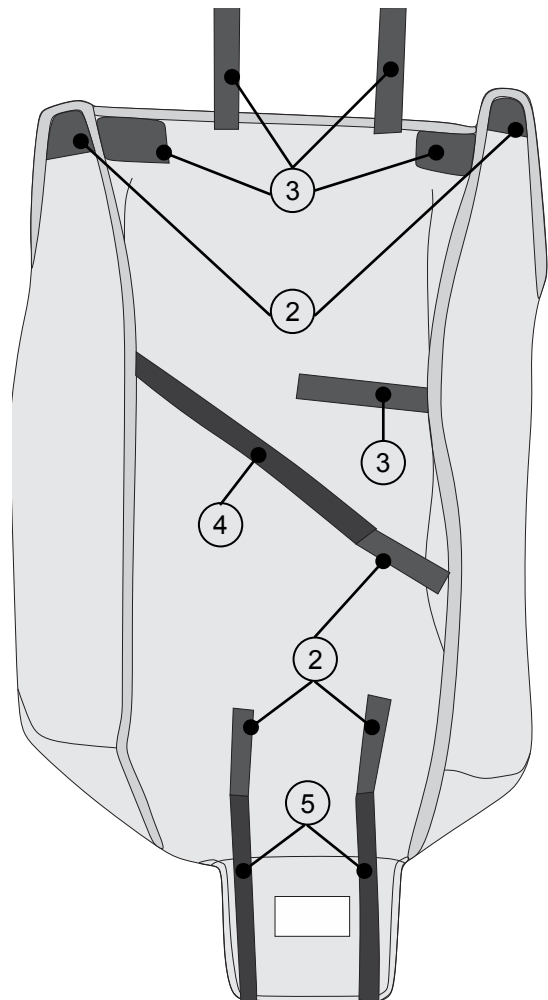
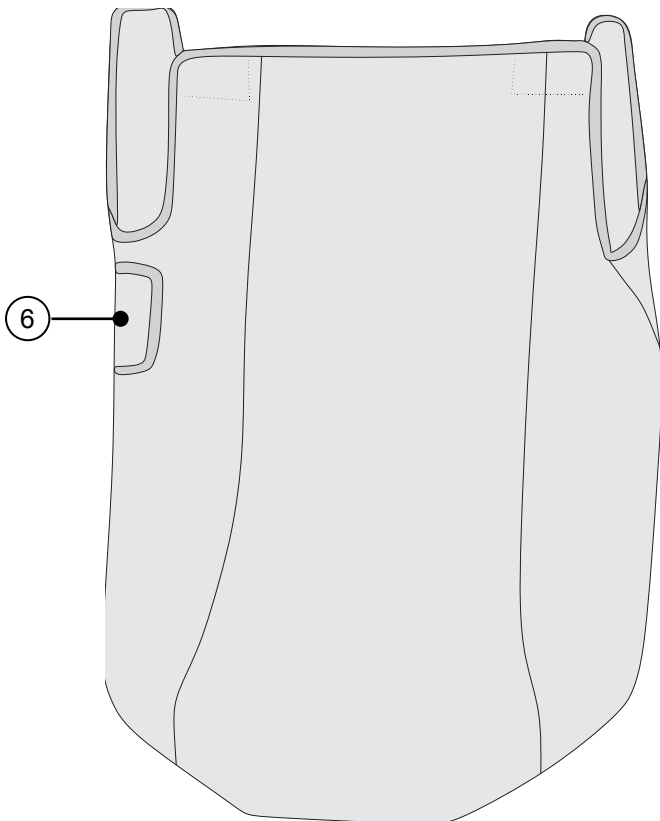
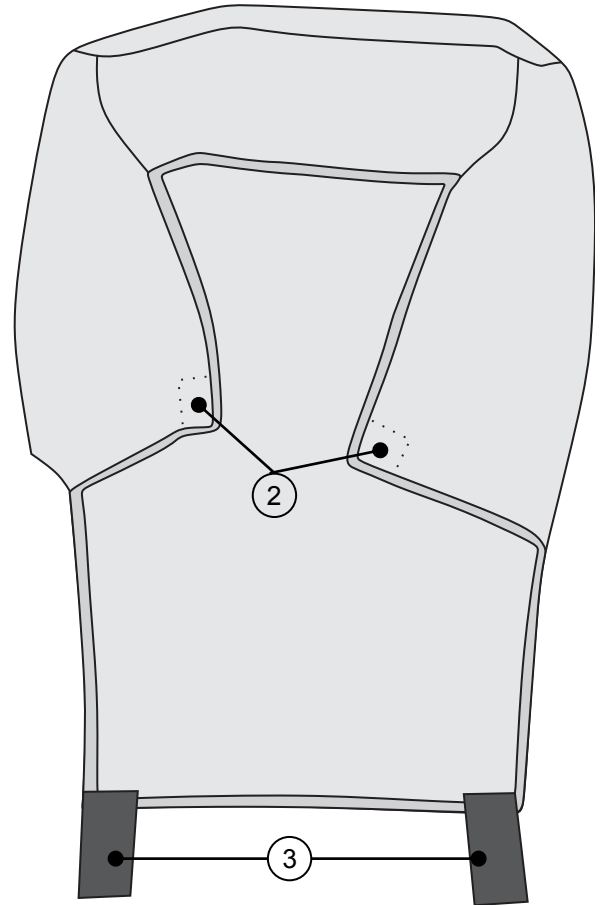
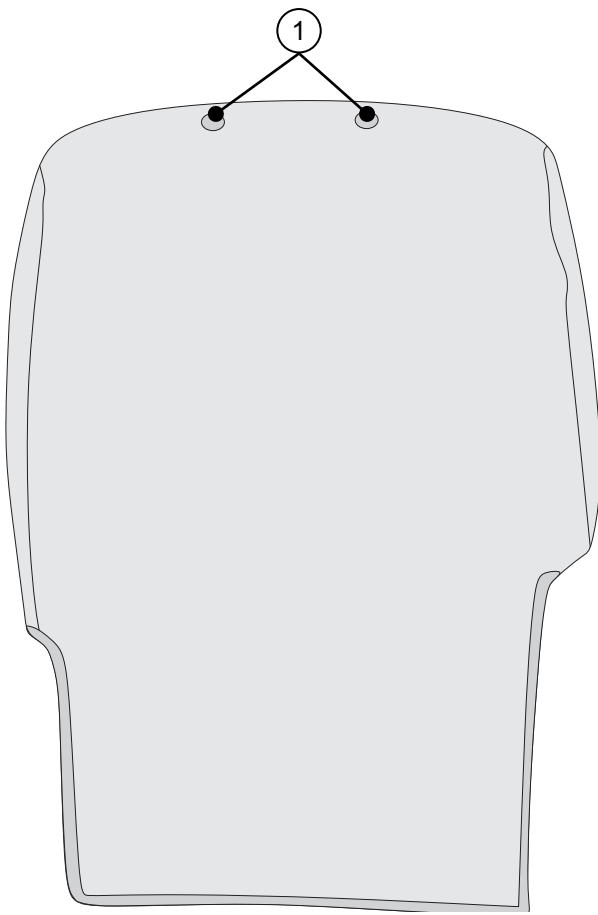

Step 1. Remove all 3 headrests from the middle row.

60% (Driver Side) Base Fitment:

Step 2. Align seat base cover to the seat base. Detach hook and loop tape at the middle of the seat cover [1].

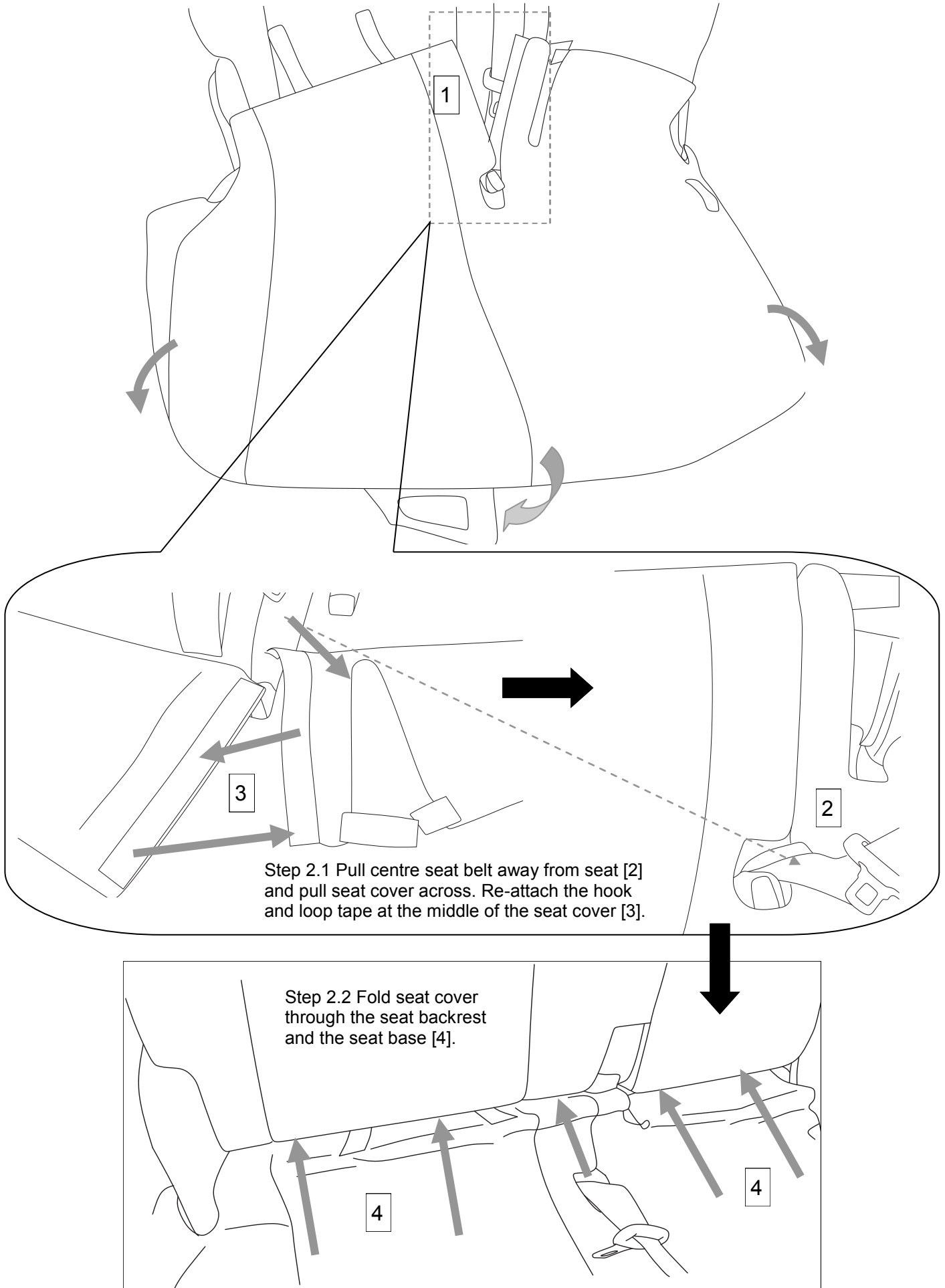

Step 2.3 Guide seat cover evenly between the seat backrest and seat base [5].

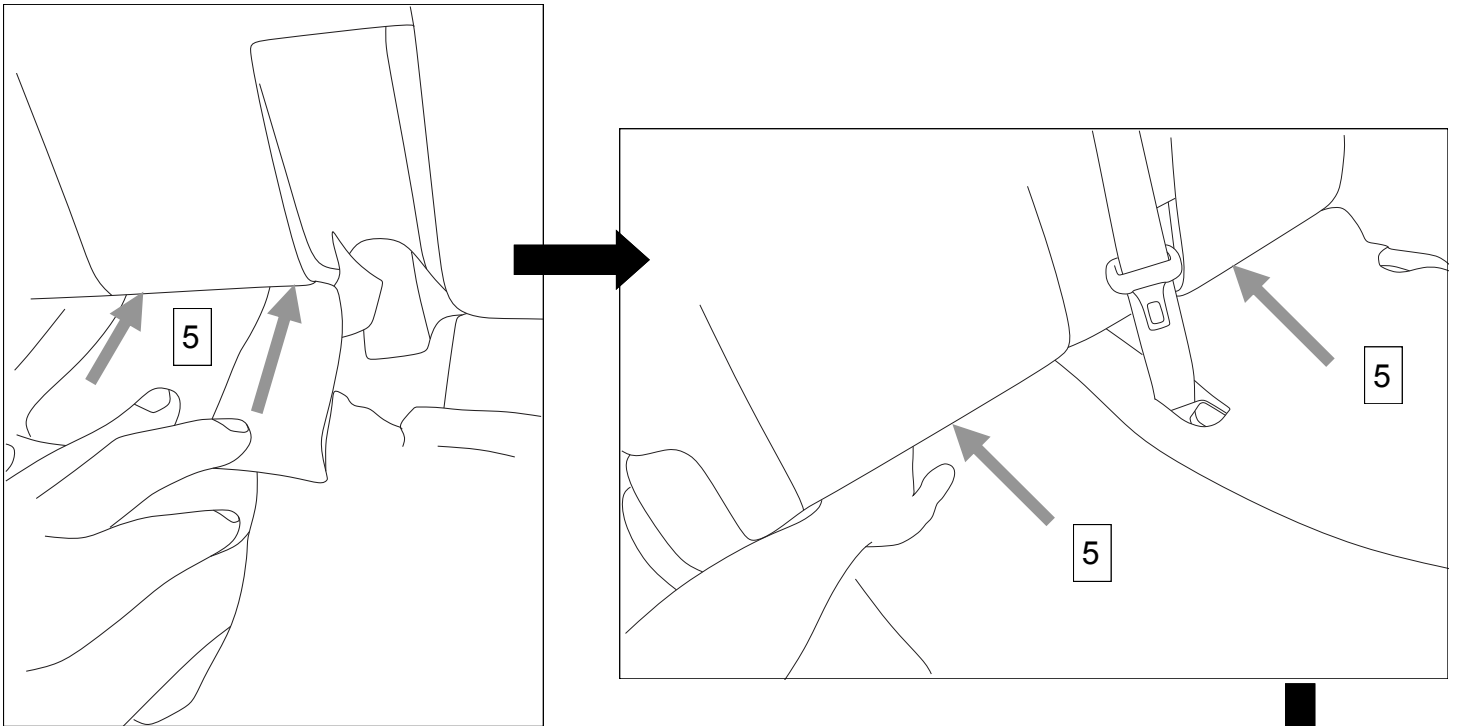

Step 3. Guide the corner of the seat cover evenly around both of the corners of the seat [1] & [2].

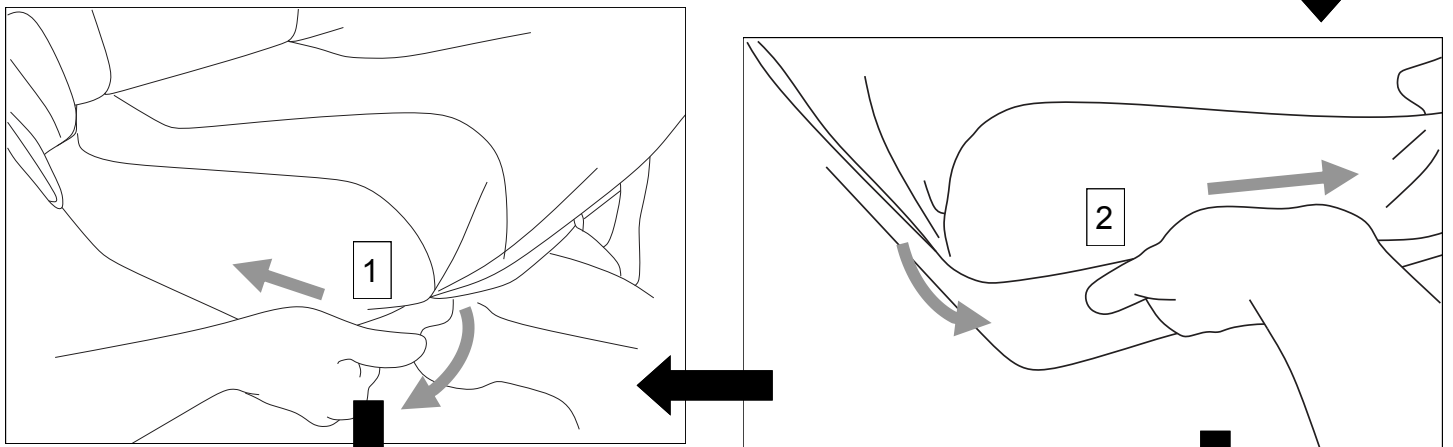

Step 3.1 Guide the outside flap behind the seat lever [3].

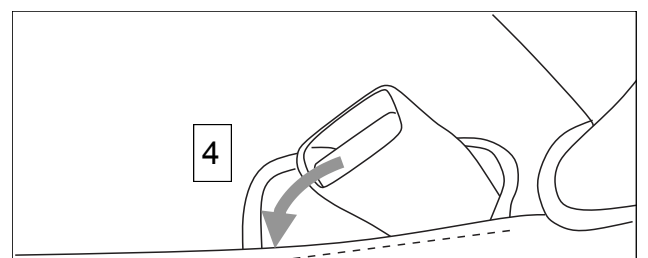
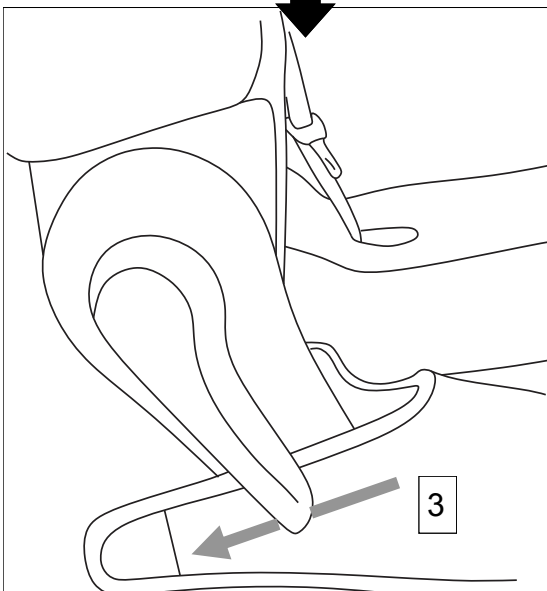

Step 3.2 Align the inside of the cover so that the seatbelt mechanism can move up and down [4].

Step 4. Proceed to the back of the seat.

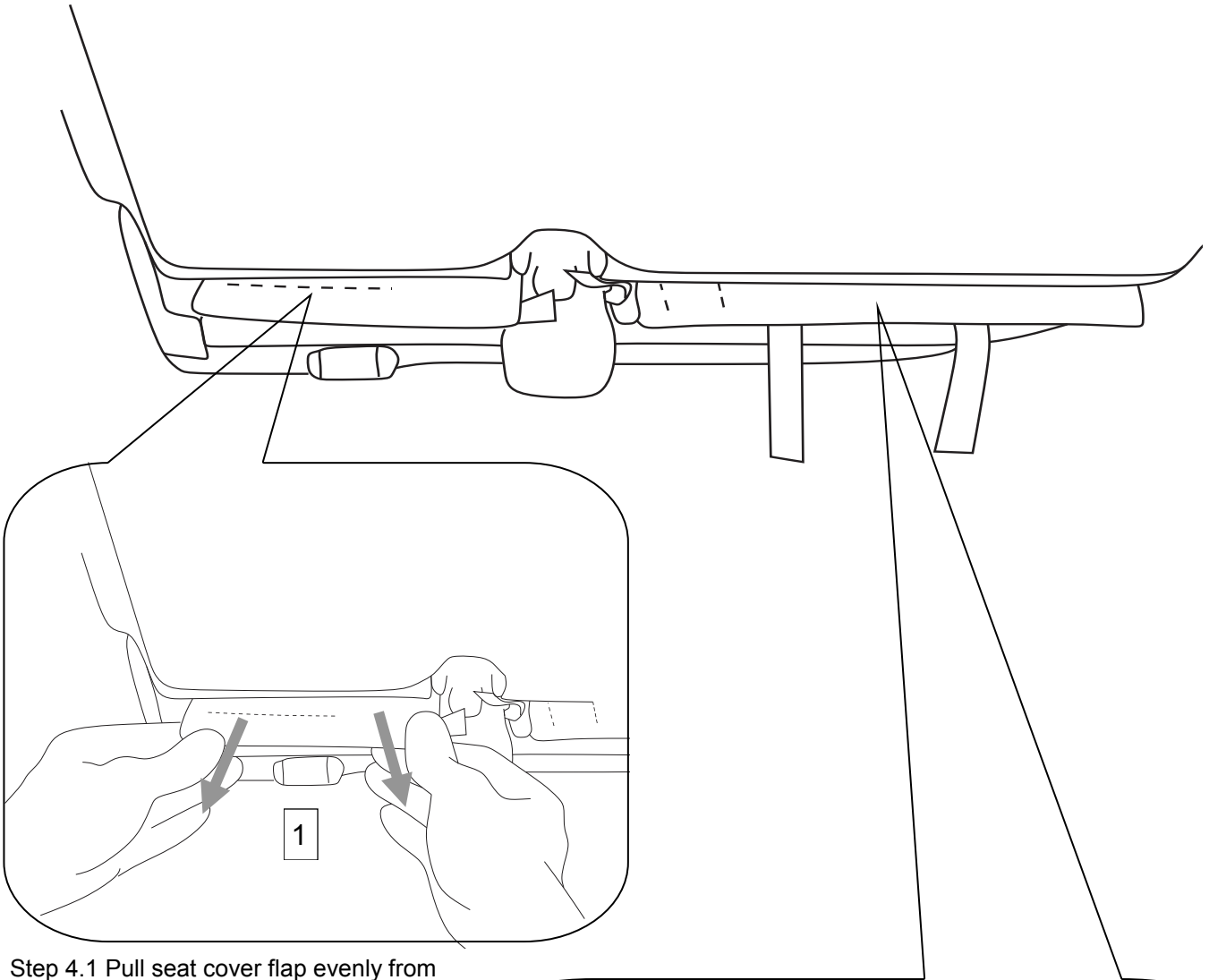

Step 4.1 Pull seat cover flap evenly from your left hand side through backrest and base using both hands [1]. Do not pull on the straps.

Step 4.2 Pull seat cover flap evenly from your right hand side through backrest and base using both hands [2]. Do not pull on the straps.

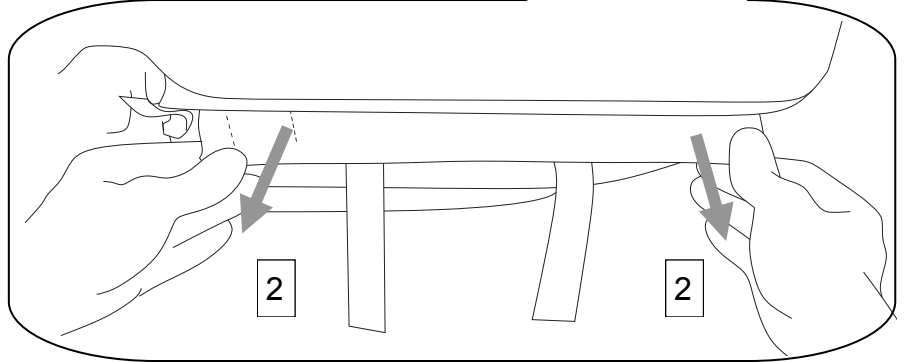

CAUTION:
Do not pull on the straps [3].
This may cause the thread
to break.

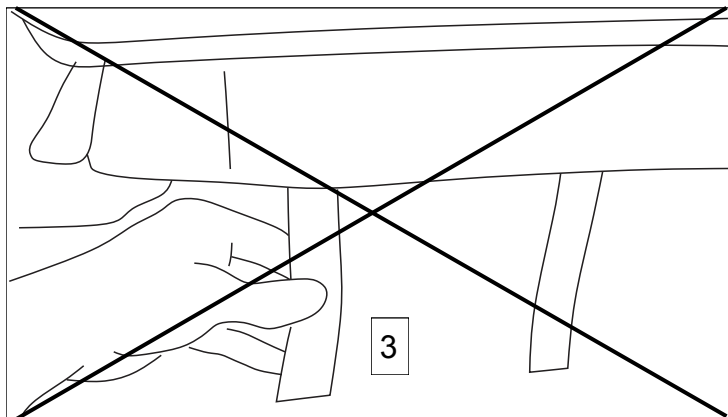

Step 5. Attach the hook and loop tape in the middle of both the flaps that were pulled through [1].

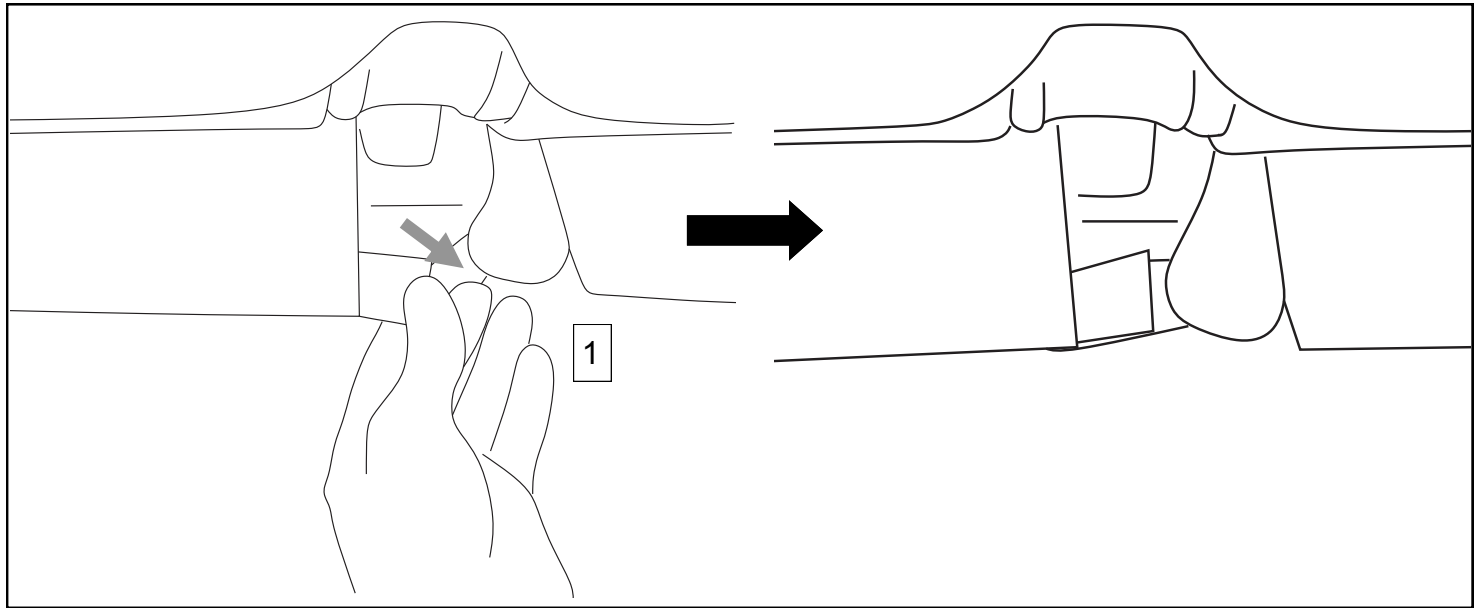

Step 5.1 Attach the hook and loop tape from the right hand side flap that was pulled through and the side flap of the backrest cover [2].

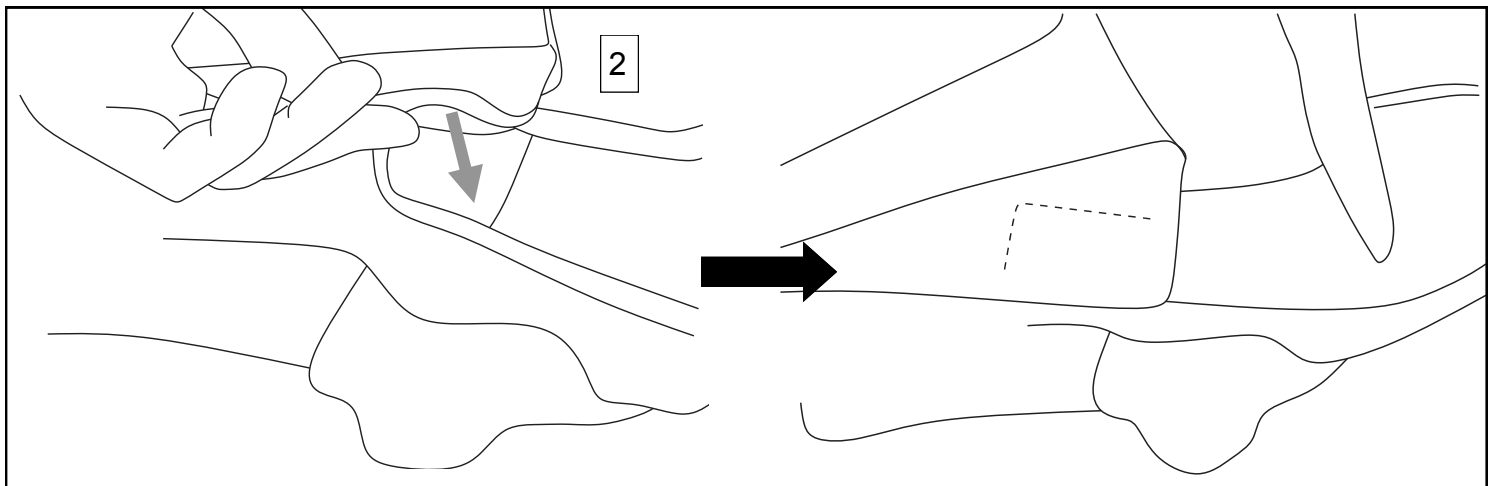

Step 5.2 Attach the hook and loop tape from the left hand side flap that was pulled through and the side flap of the backrest cover [3].

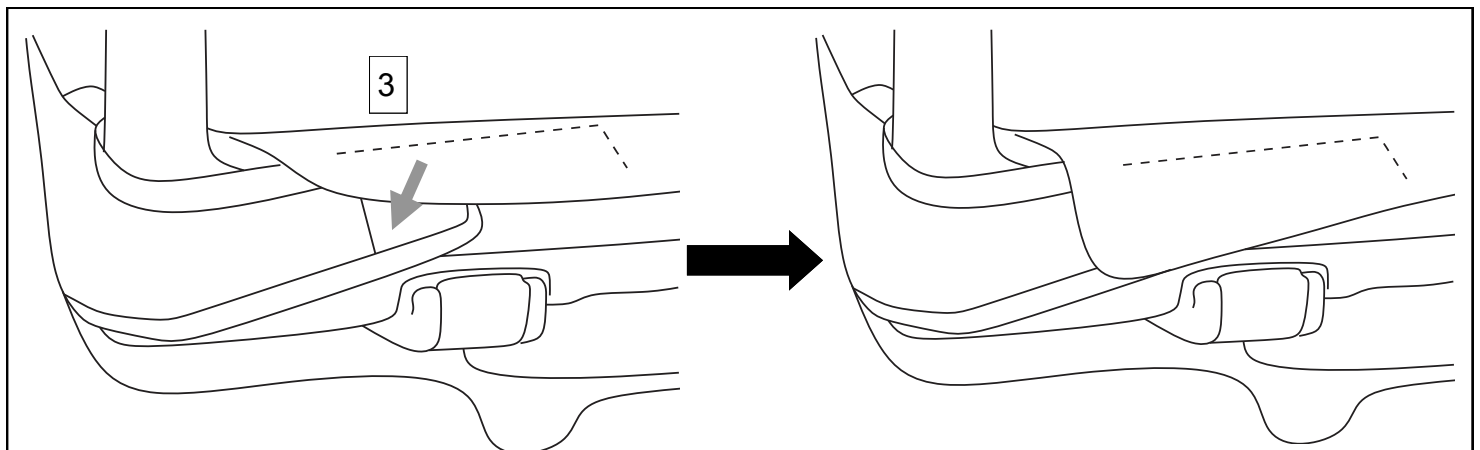

Step 6. Make sure the seat cover has been evenly aligned. Check that the seat latch on the front of the seat base is accessible and can be lifted up and down completely through the latch hole in the front flap of the seat cover without being interfered by the seat cover [1].

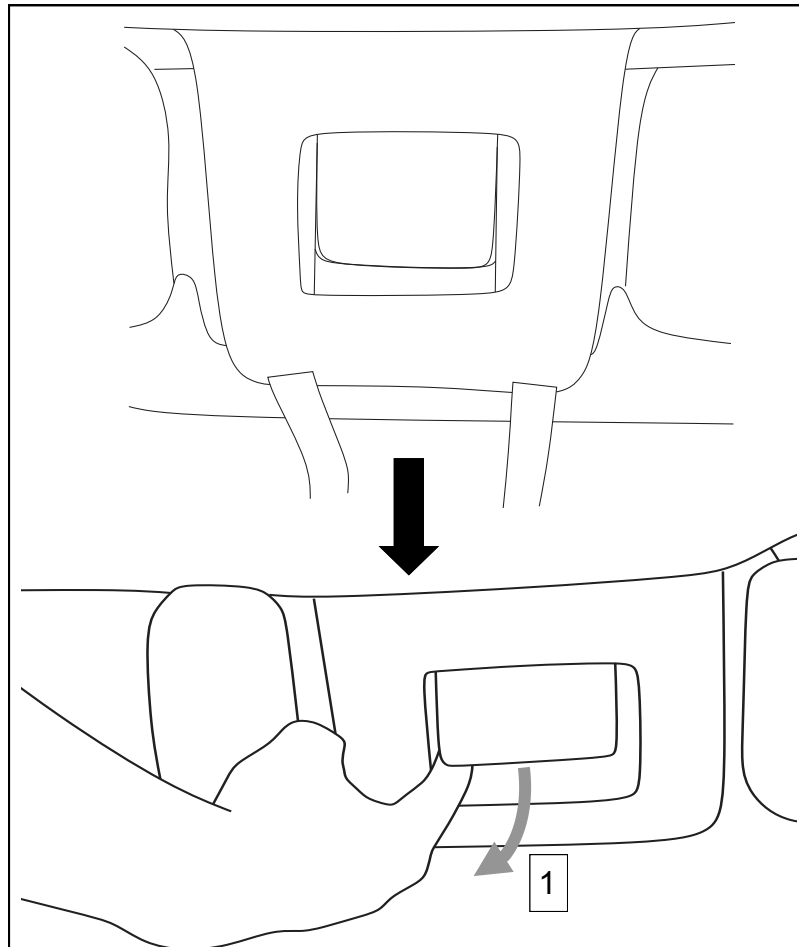

Step 7. Tilt the seat base upright and locate the 4 un-attached straps outlined in the dotted boxes below.

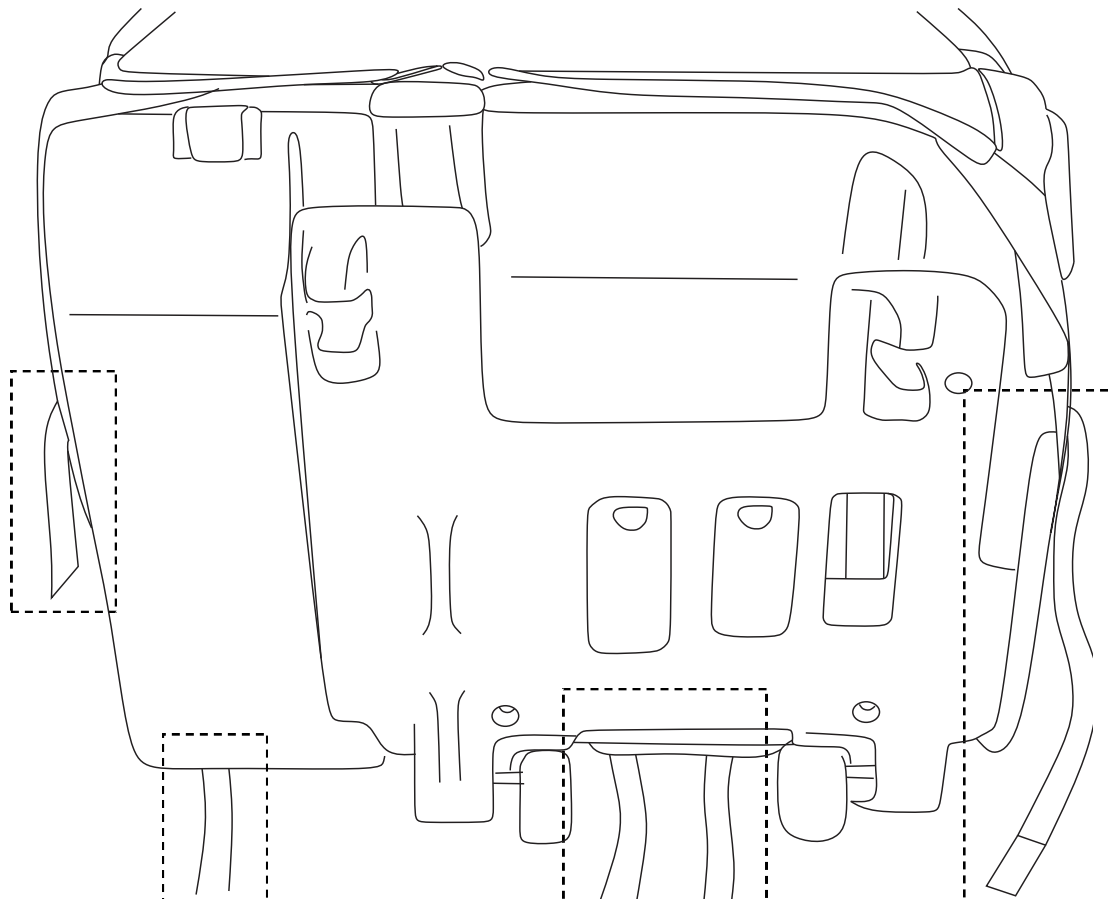

Step 7.1 Attach vertical strap on your left hand side from the front of the seat base to the back by securing it in between the left hand side flaps [1] that were attached in step 5.2

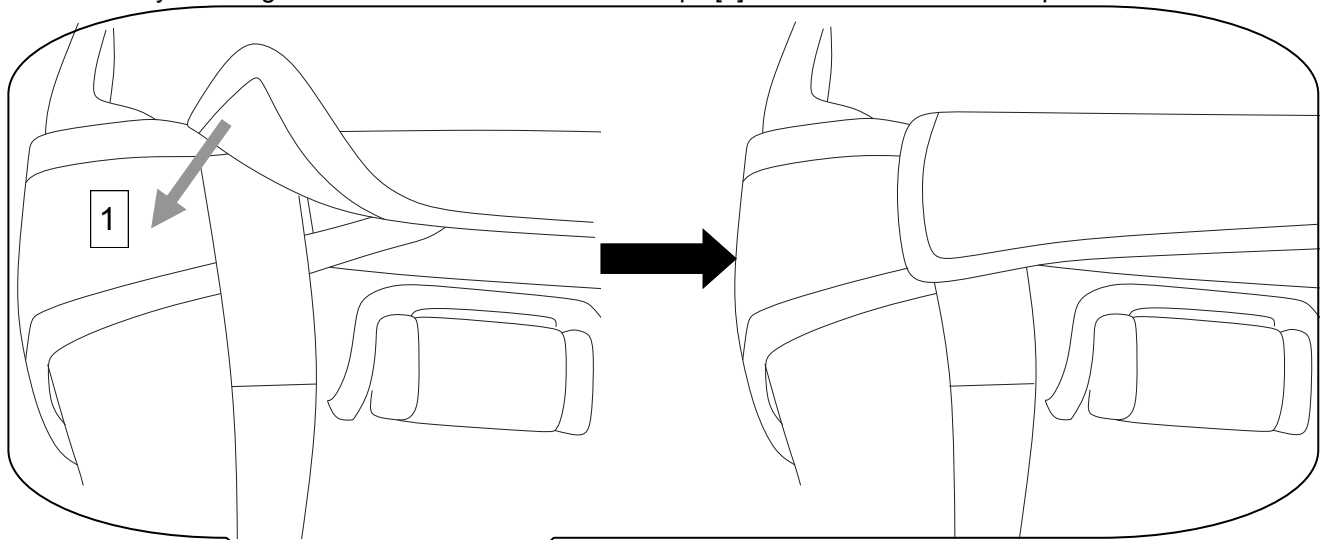

Step 7.2 Attach horizontal straps from right to left [2].

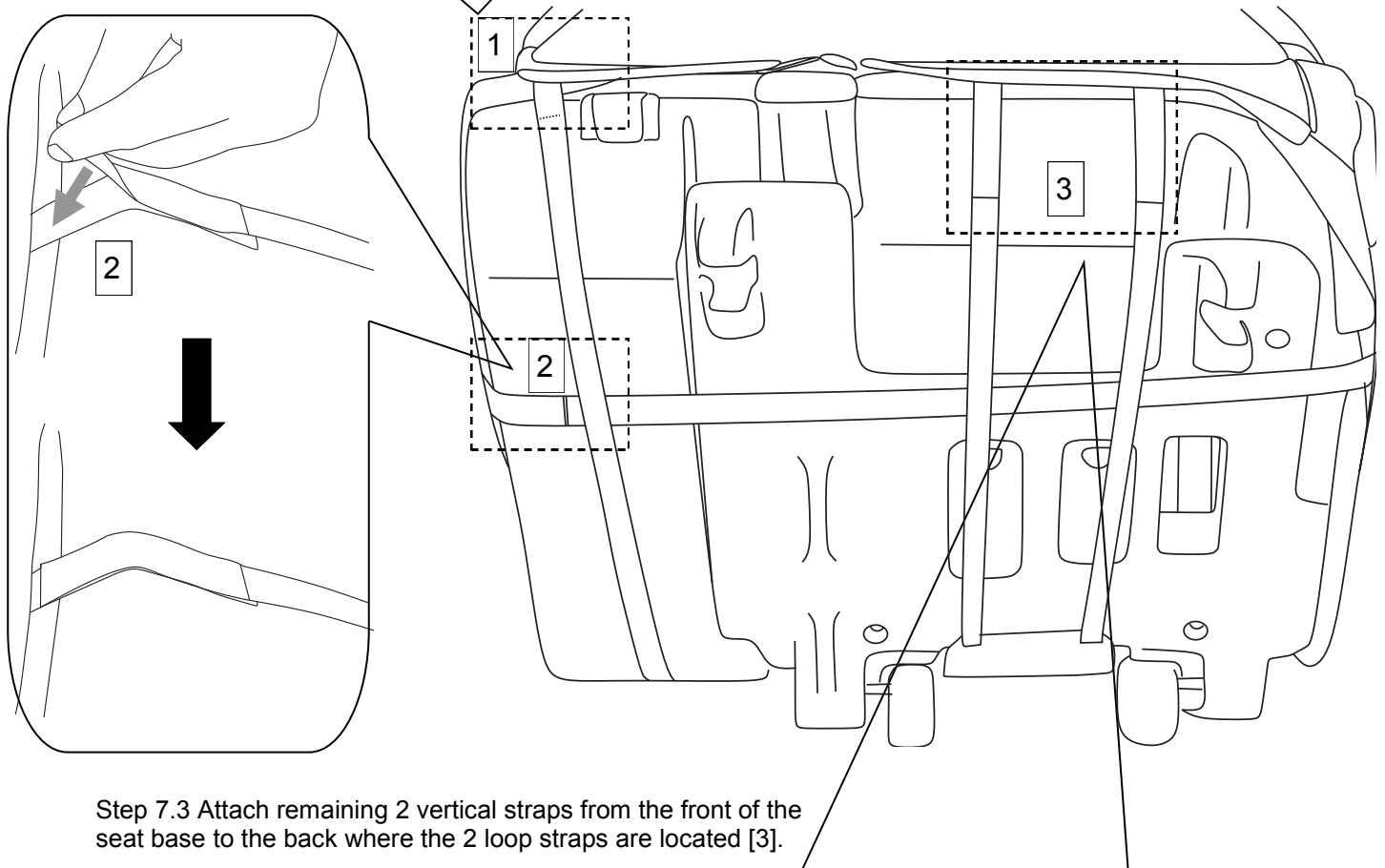

Step 7.3 Attach remaining 2 vertical straps from the front of the seat base to the back where the 2 loop straps are located [3].

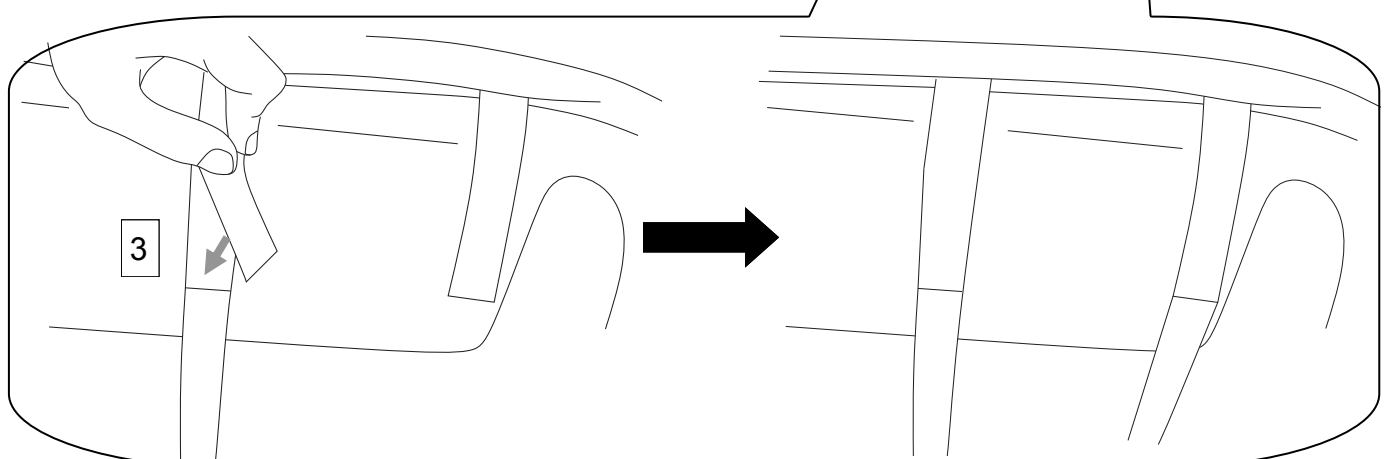

60% (Driver Side) Backrest Fitment:

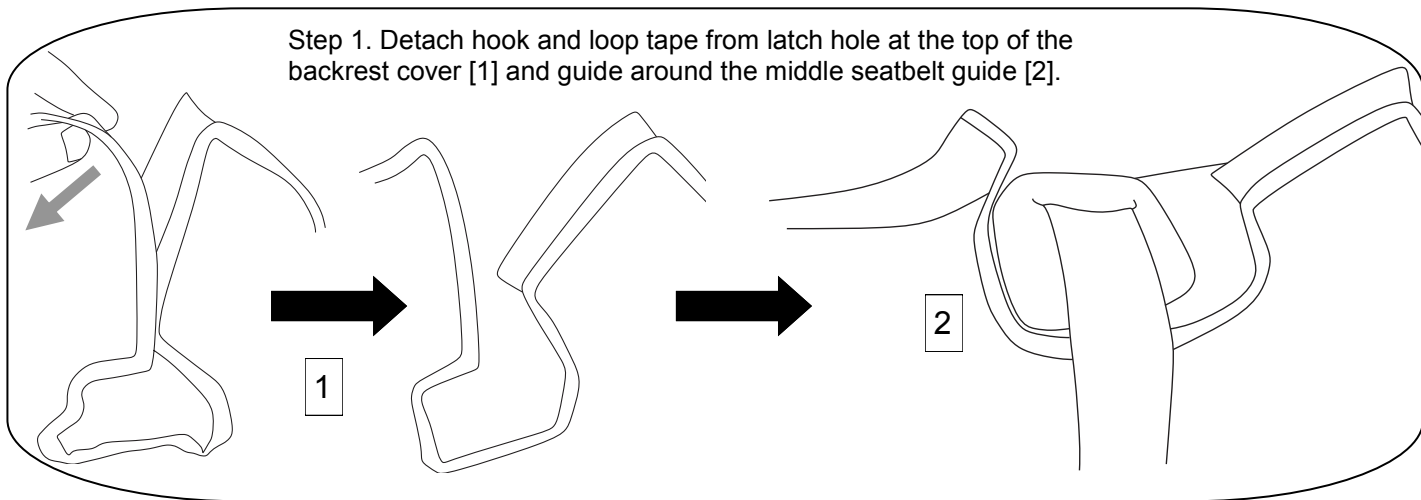

Step 1.1 Align backrest cover to the seat backrest working evenly from left to right [3].

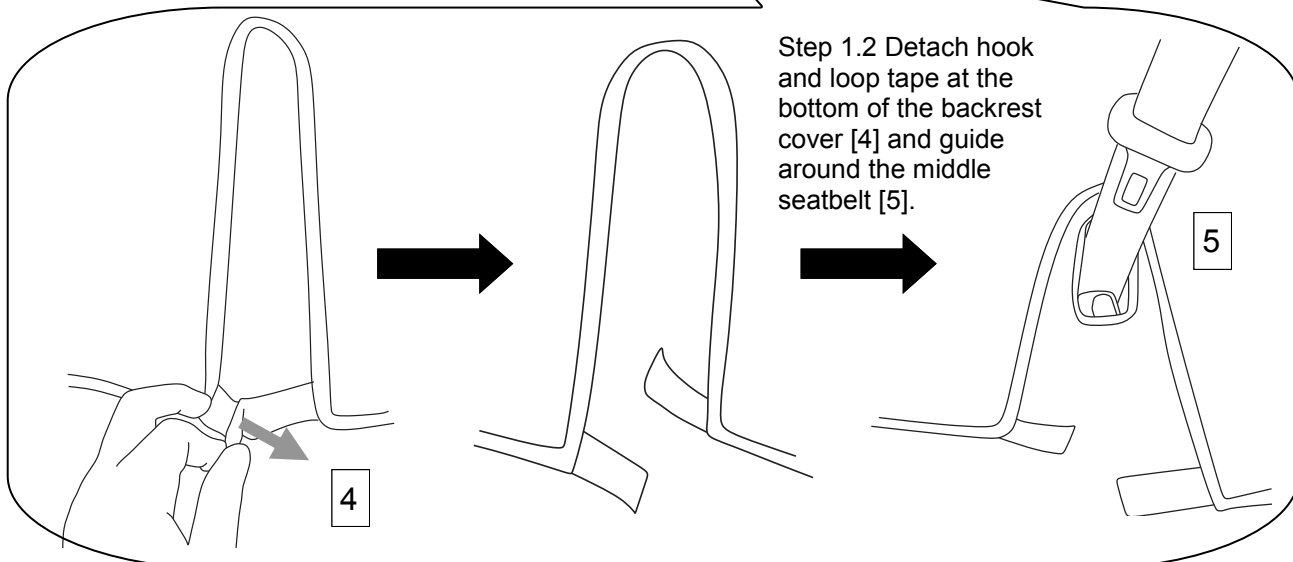
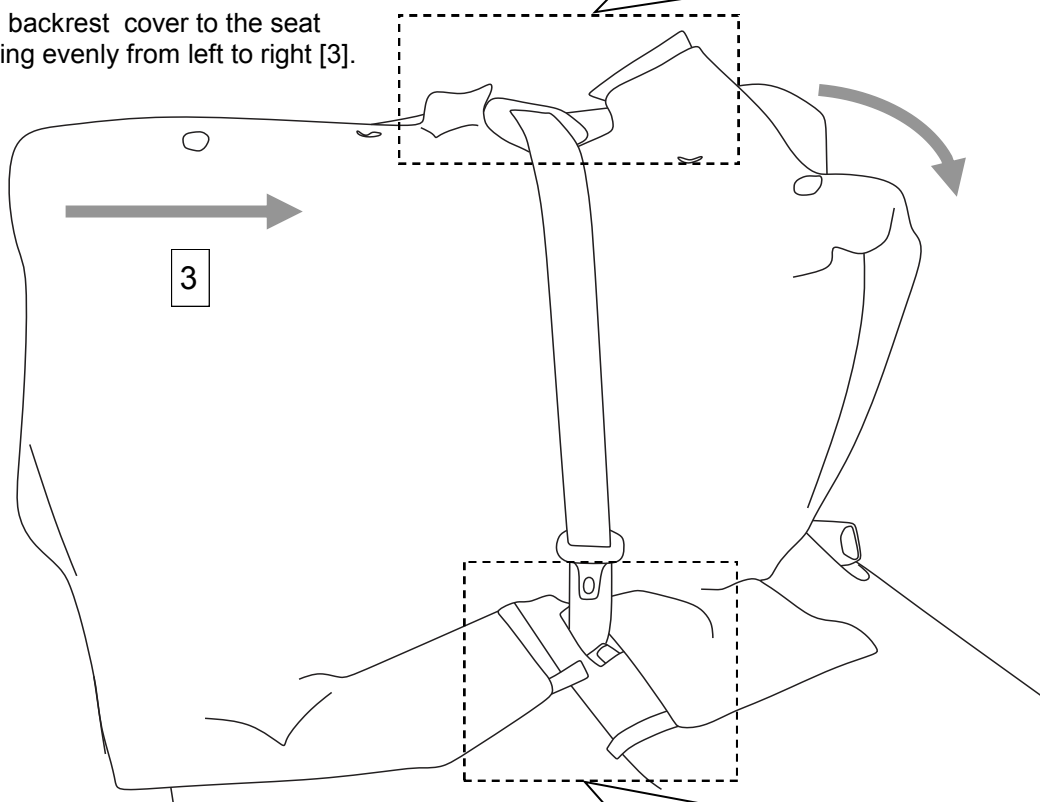

Step 2. Align the top corners of the backrest cover to the seat backrest [1].

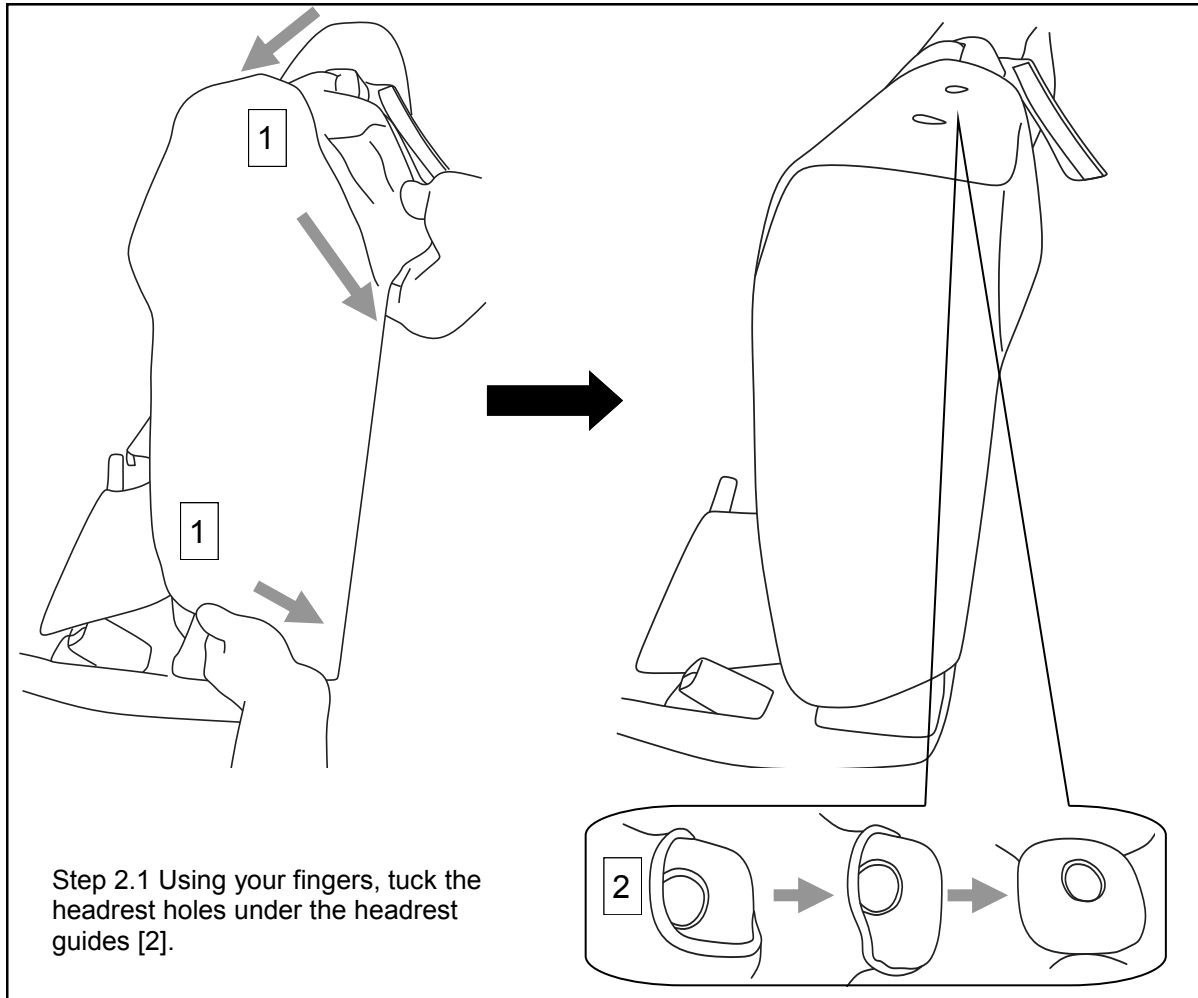

Step 2.2 Align the outside bottom corner of the backrest covers to the seat backrest [3]. Make sure the bottom corner of the backrest cover wraps around the bottom corner of the seat [4].

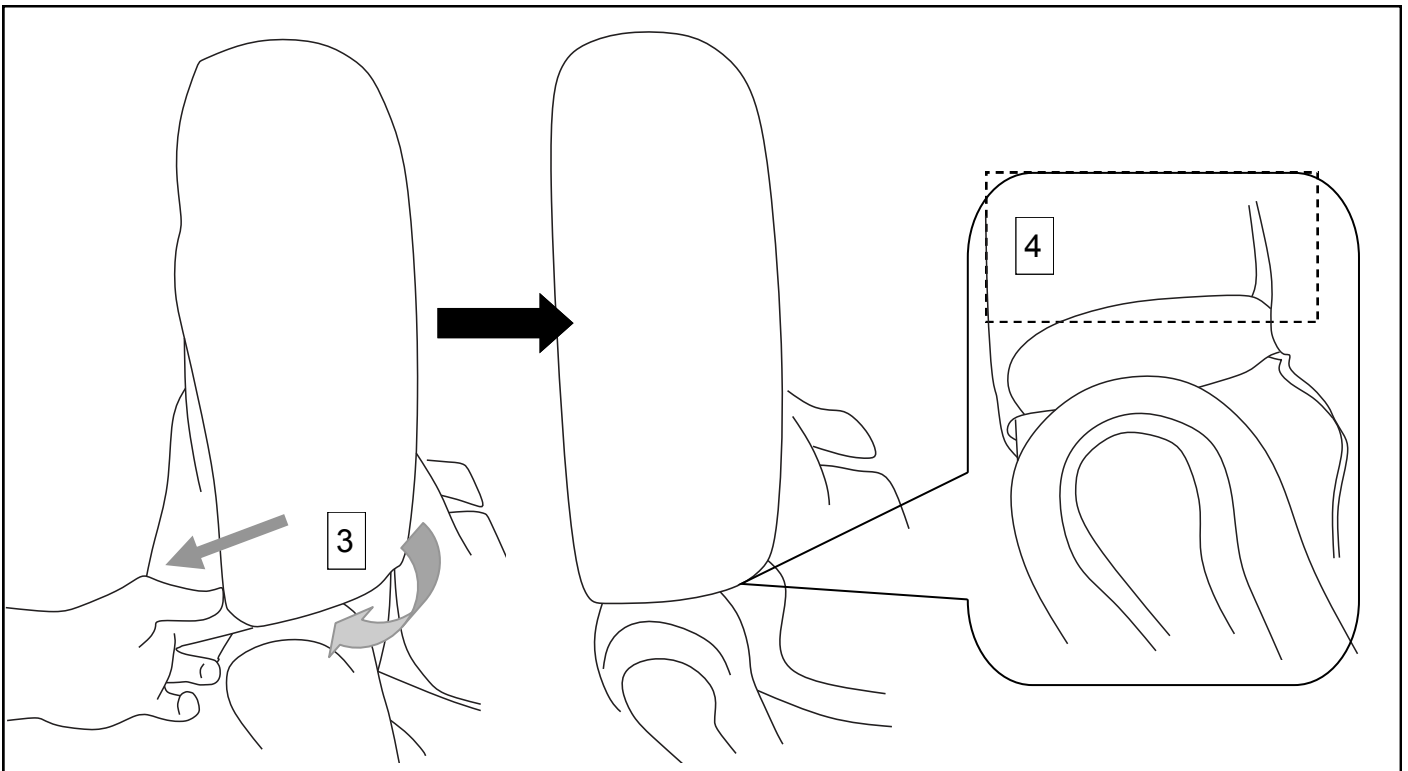

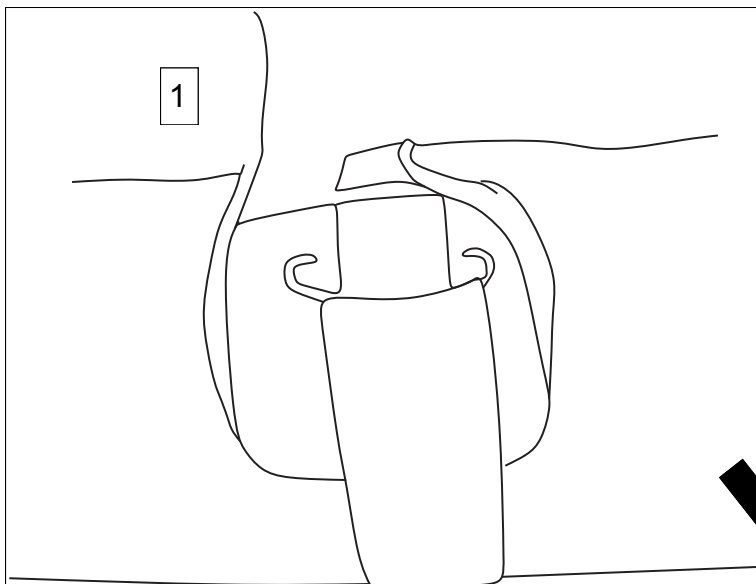

Step 3. Align the latch hole at the top of the backrest cover to the seat belt guide on the seat [1].

Step 3.1 Using your fingers, slowly tuck the edges of the backrest cover under the seat belt guide on the seat [2]. Work your way around all edges of the cover [3] & [4].

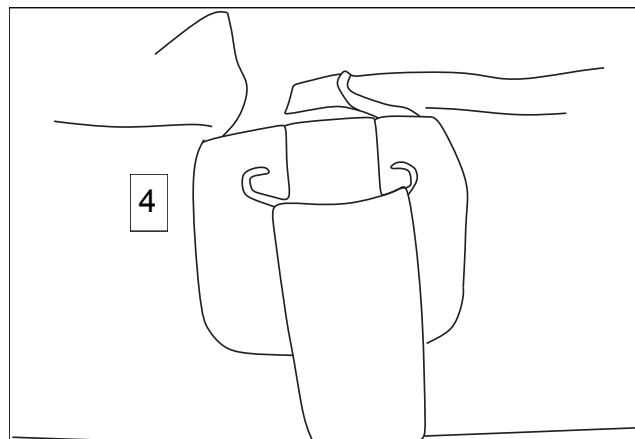
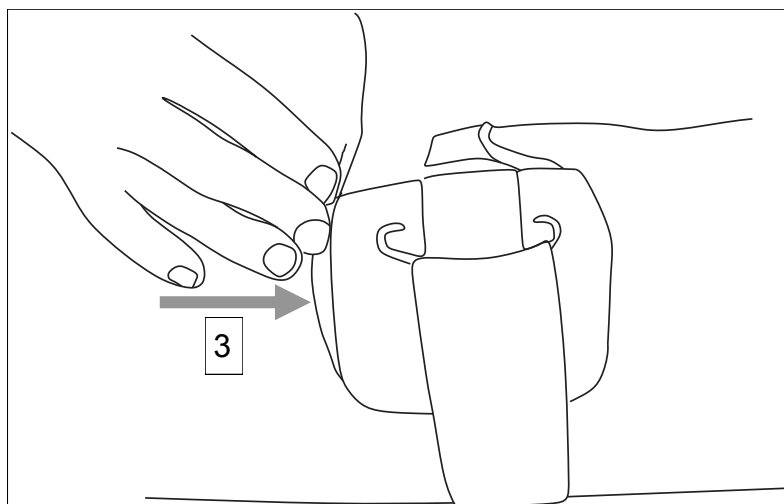
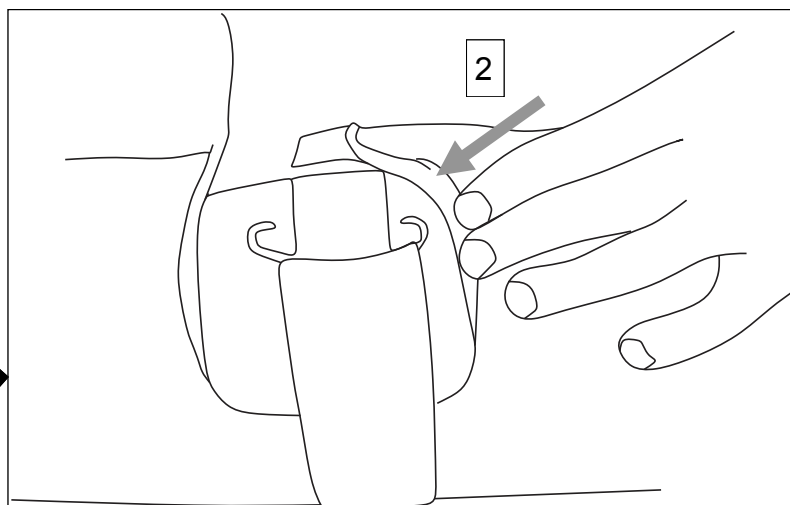

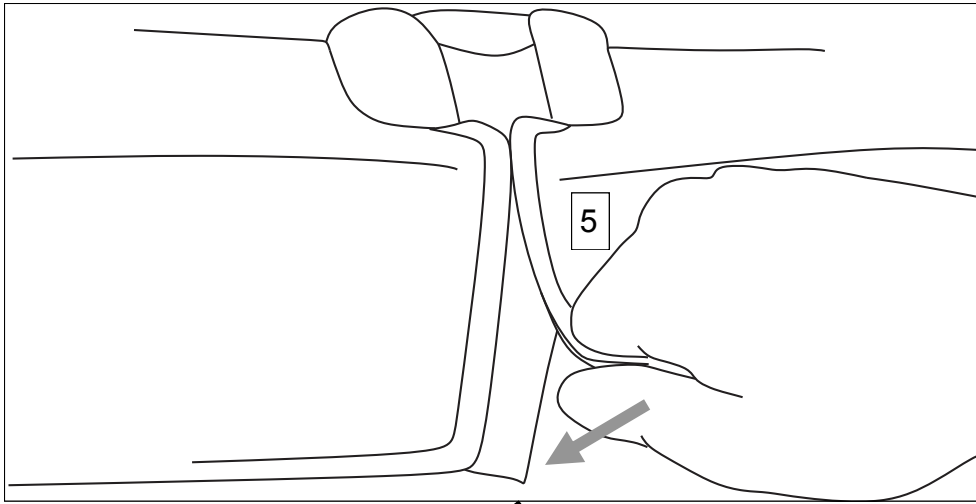

Step 3.2 From the back of the seat, attach the hook and loop tape together [5]. Ensure that they are closed up all the way so that the hook and loop tape are not visible [6].

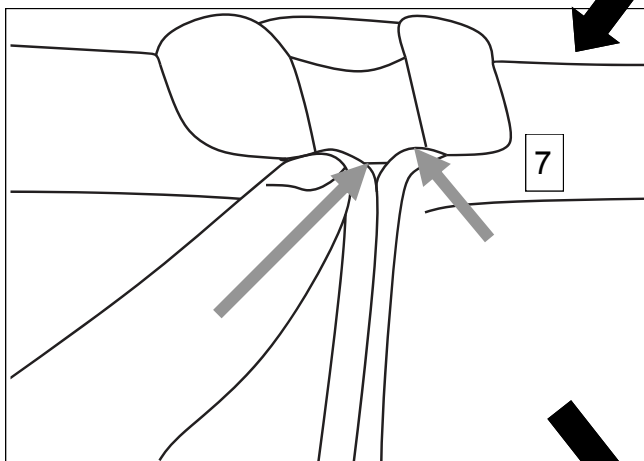
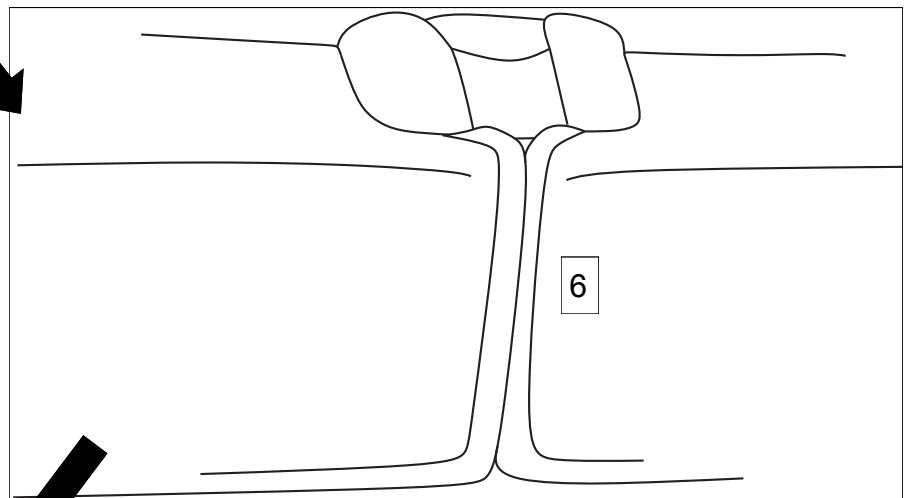

Step 3.2 Using your fingers, slowly tuck the remaining edges from the back of the backrest under the seat belt guide on the seat [7] & [8].

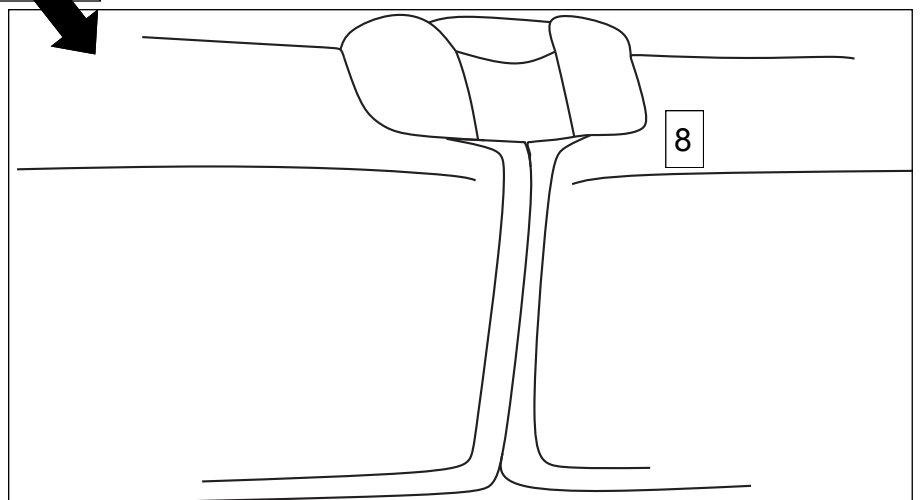

Step 4. Guide the backrest cover flaps evenly between the seats backrest and base [1].

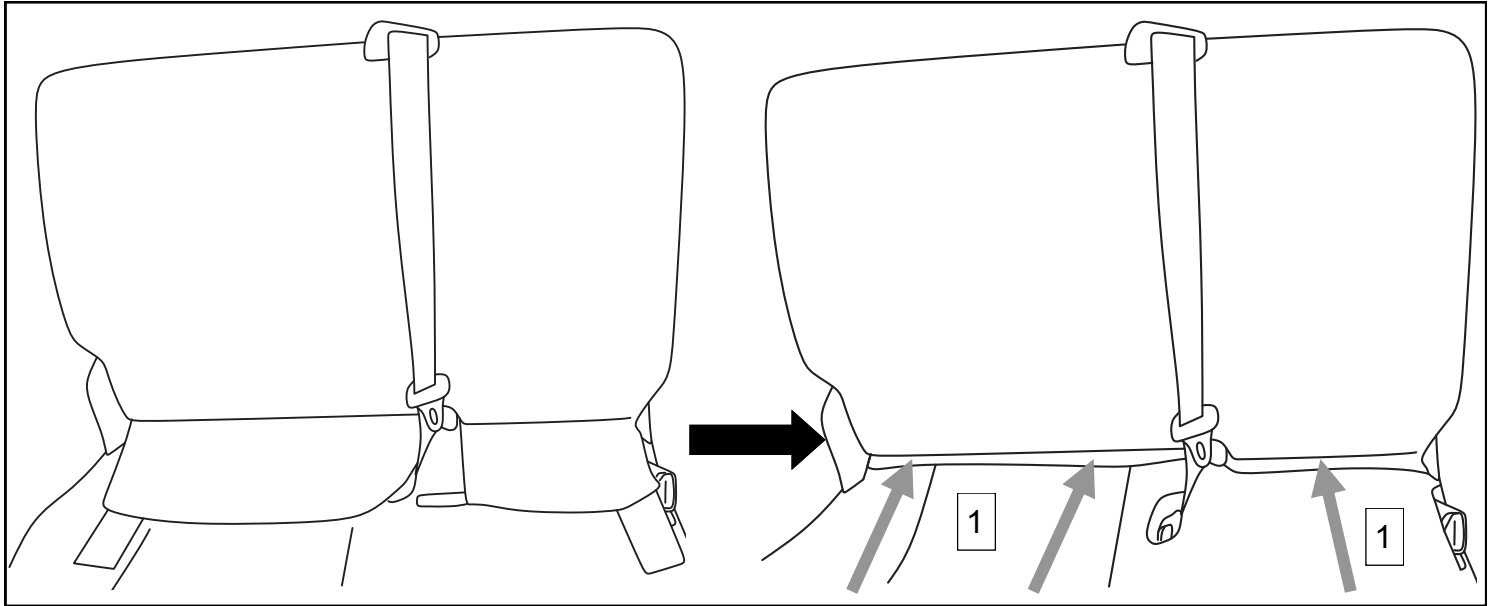

Step 4.1 Proceed to the back of the seat and pull backrest cover flaps evenly from your left hand side [2] and right hand side [3] through the seats backrest and base using both hands. Do not pull on the straps.

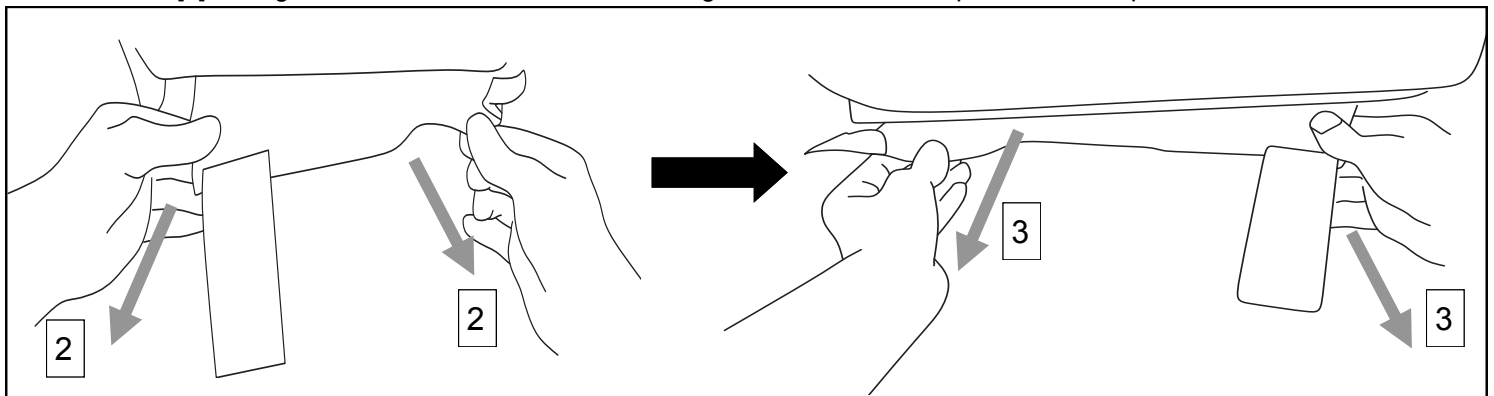

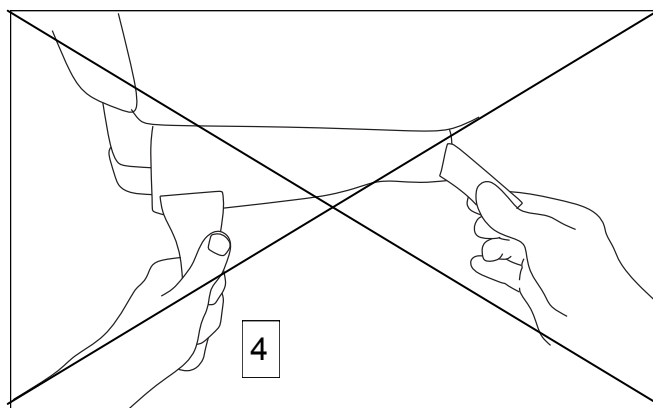

CAUTION:
Do not pull on the straps [4].
This may cause the thread
to break.

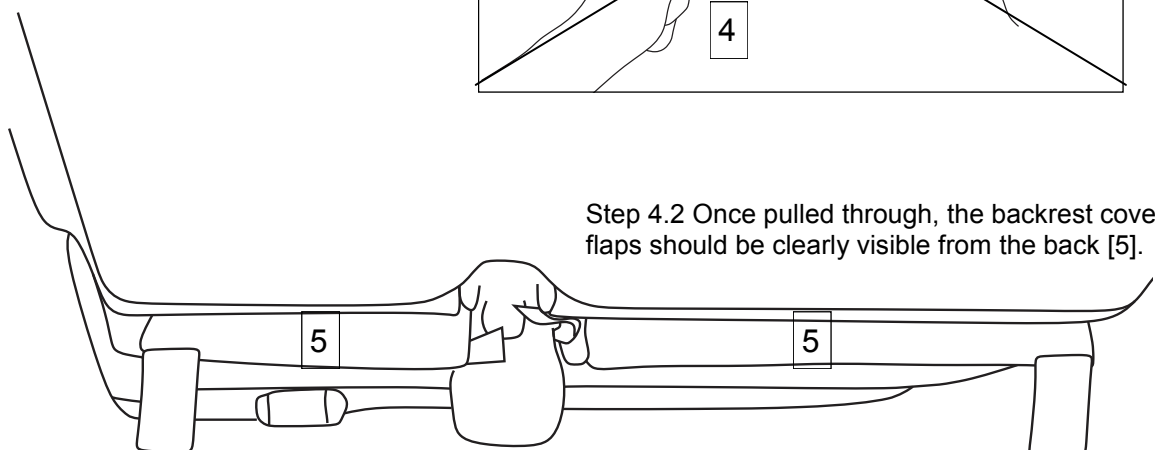

Step 4.2 Once pulled through, the backrest cover flaps should be clearly visible from the back [5].

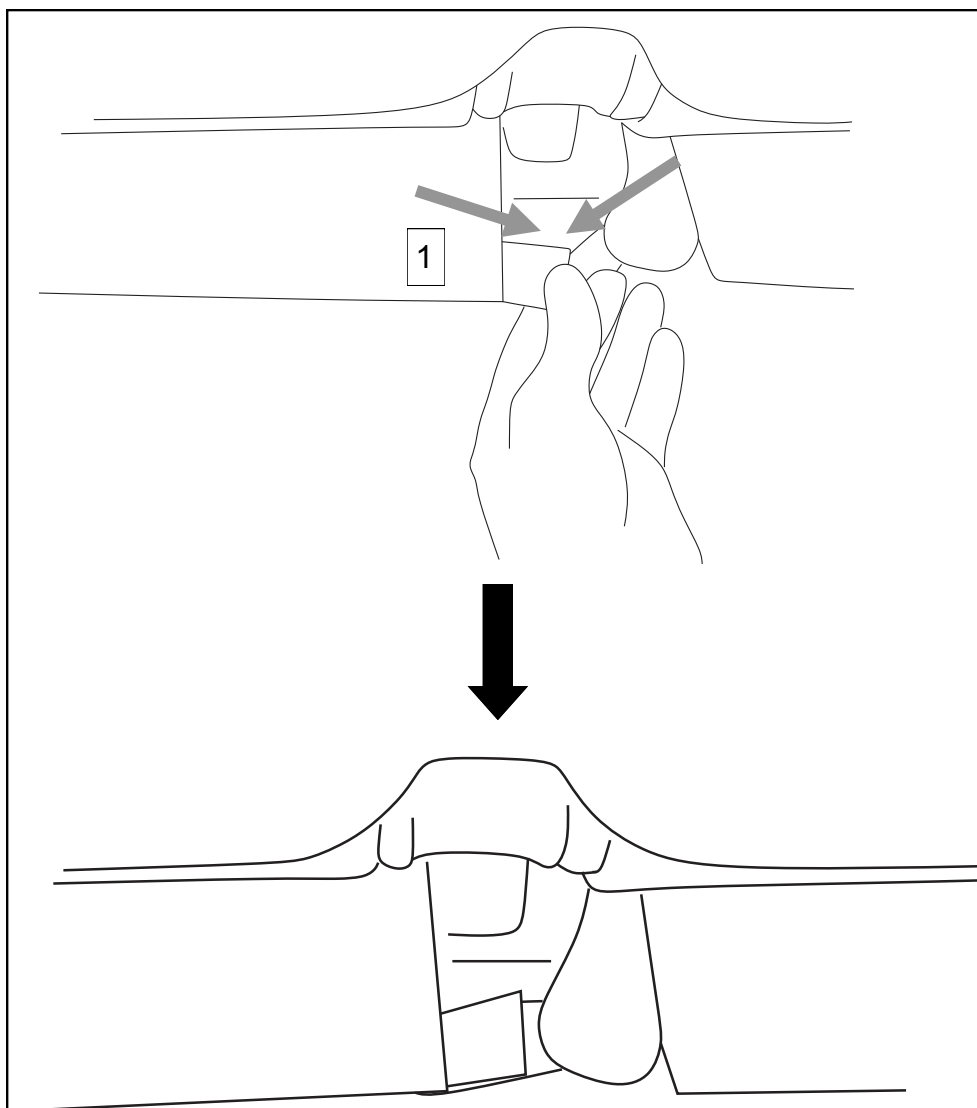

Step 5. Attach the hook and loop tape in the middle of both the flaps that were pulled through [1].



Step 5.1 Attach the hook and loop tape from the left hand side flap that was pulled through and the tab inside the corner of the backrest cover [2].

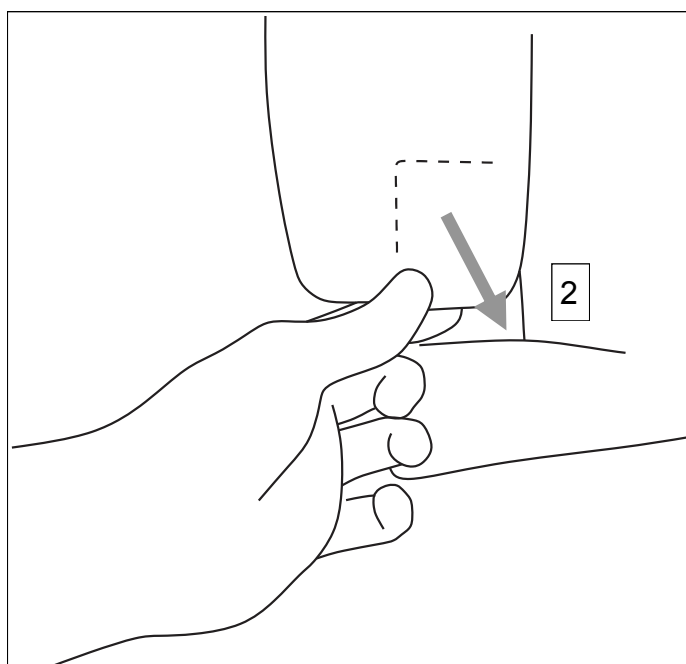

Step 5.2 Attach the hook and loop tape from the right hand side flap that was pulled through and the tab inside the corner of the backrest cover [3].

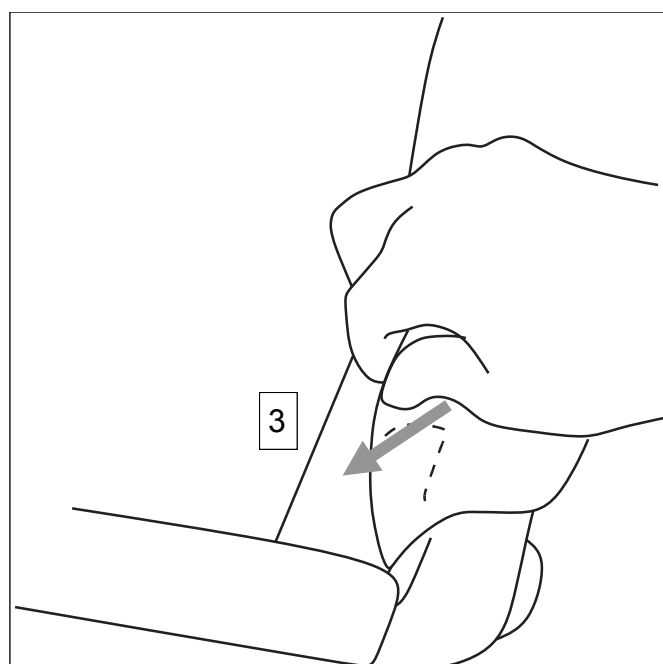

40% (Passenger Side) Base Fitment:

Step 2. Align seat base cover to the seat base [1].

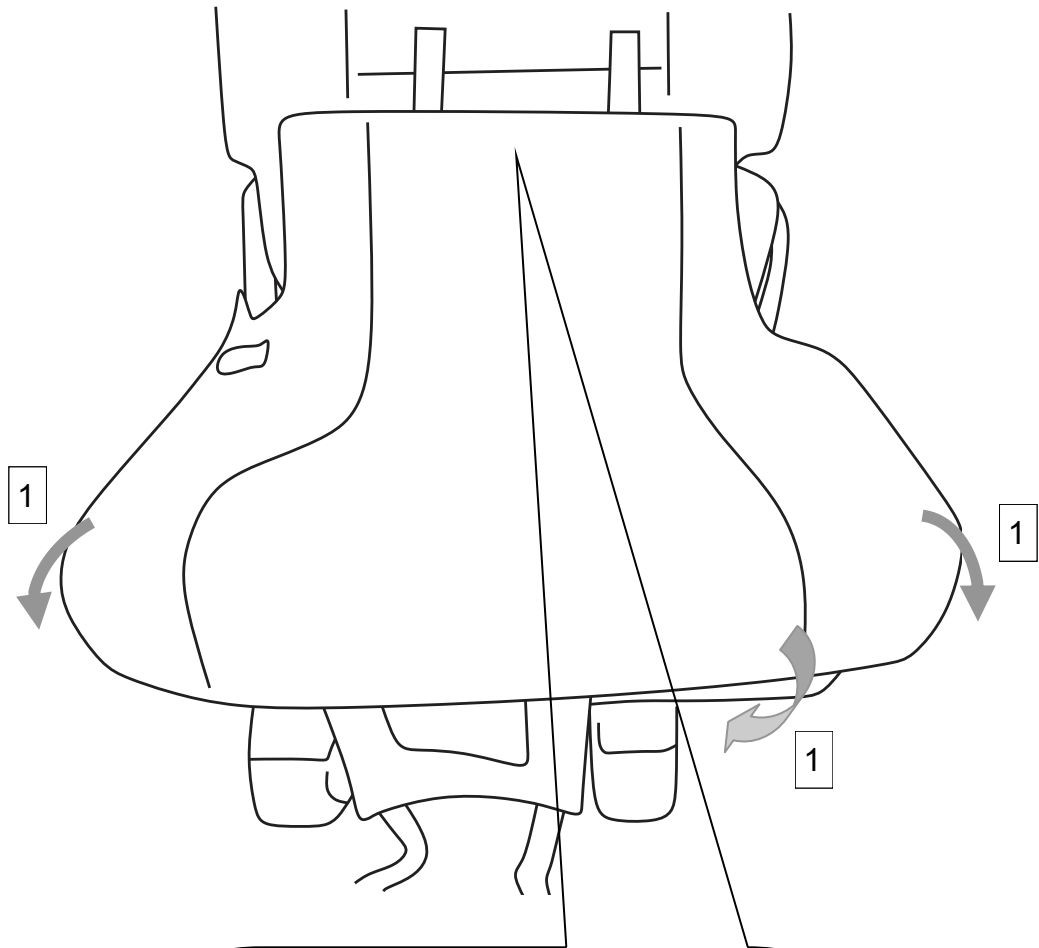

Step 2.1 Fold seat cover and guide evenly through the seat backrest and the seat base [2].

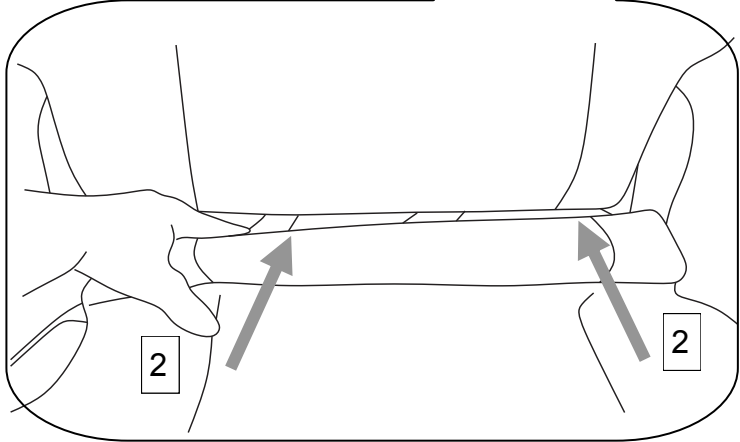

Step 2.2. Guide the corner of the seat cover evenly around both of the corners of the seat [3].

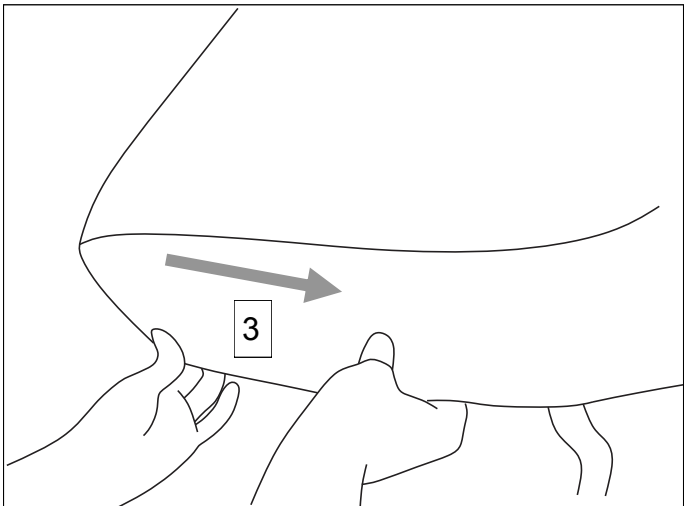

Step 2.3 Guide the outside flap behind the seat lever [4].

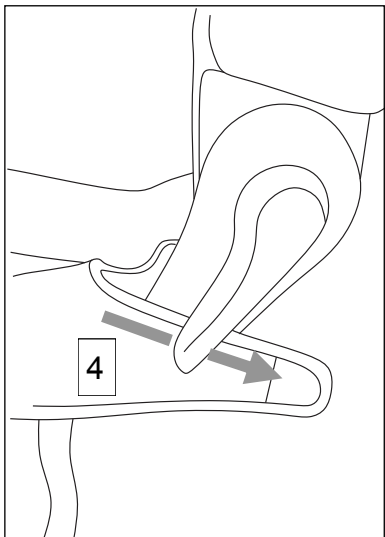

Step 2.4 Align the inside of the cover so that the seatbelt mechanism can move up and down [5].

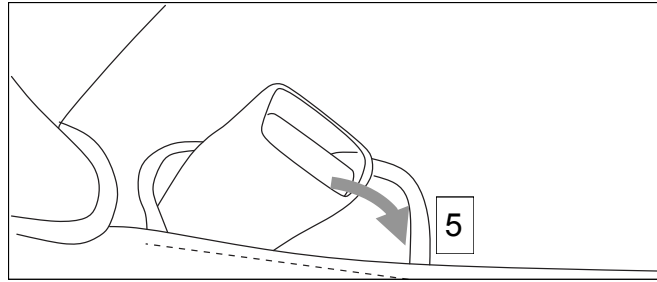

CAUTION:

Do not pull on the straps [2].
This may cause the thread to break.

Step 3. Proceed to the back of the seat. Pull seat cover evenly through backrest and base using both hands [1]. Do not pull on the straps.

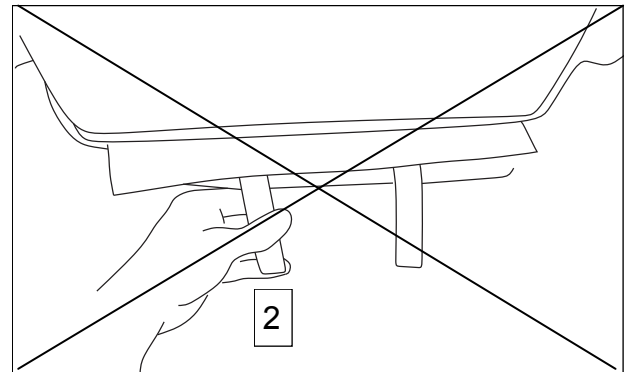
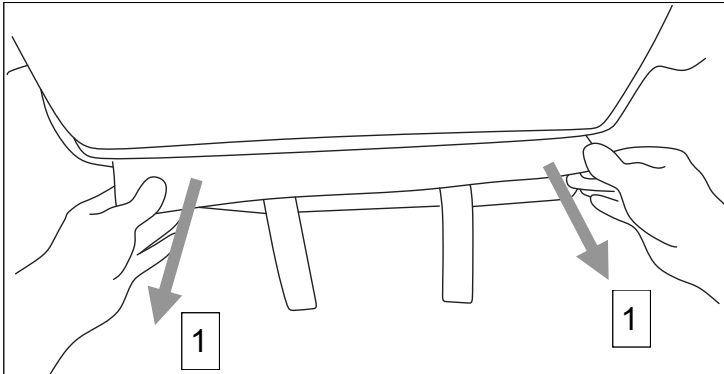

Step 4. Attach the hook and loop tape from the left hand side of the flap that was pulled through and the side flap of the seat cover [1].

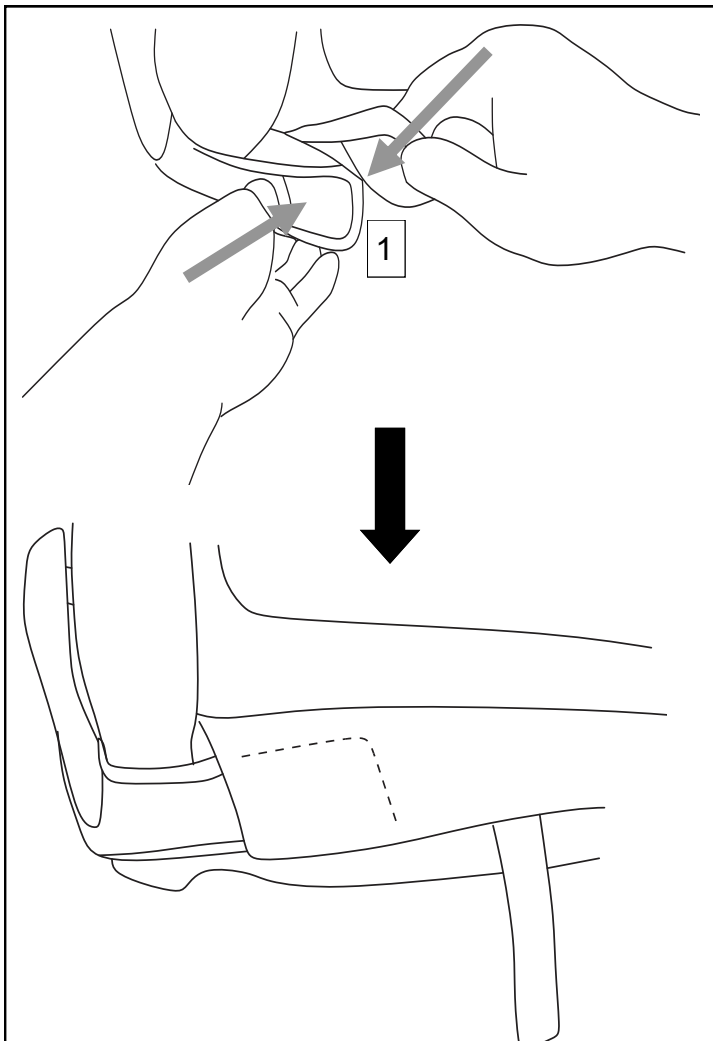

Step 4.1 Attach the hook and loop tape from the right hand side of the flap that was pulled through and the side flap of the seat cover [2].

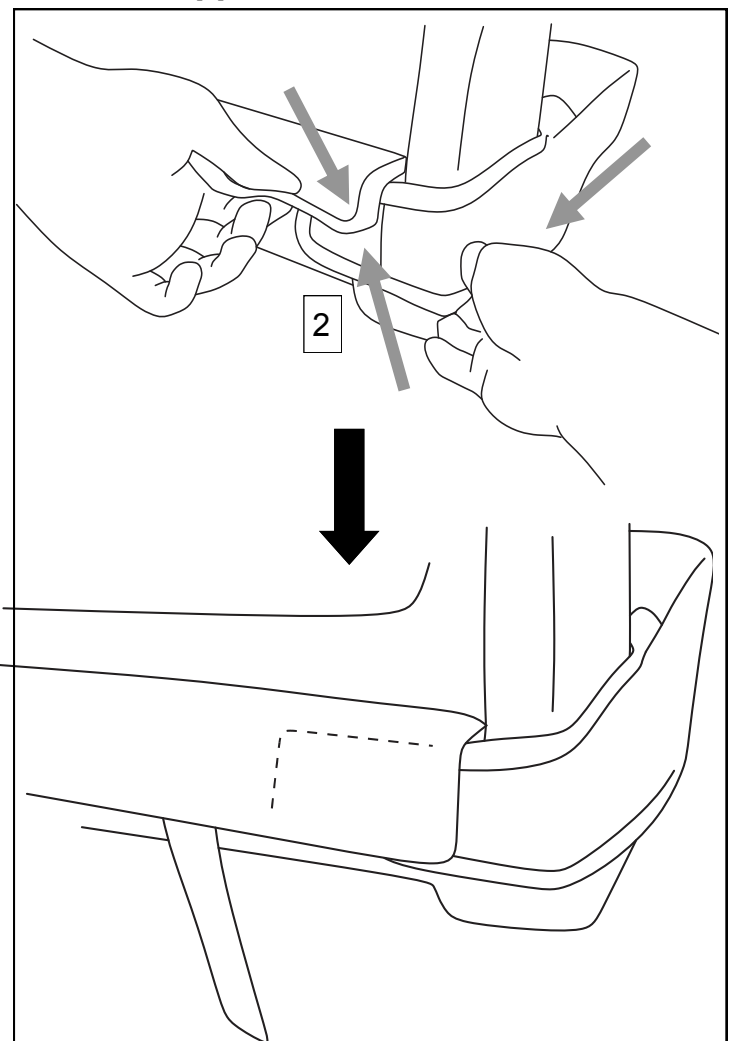

Step 5. Make sure the seat cover has been evenly aligned. Check that the seat latch on the front of the seat base is accessible and can be lifted up and down completely through the latch hole in the front flap of the seat cover without being interfered by the seat cover [1].

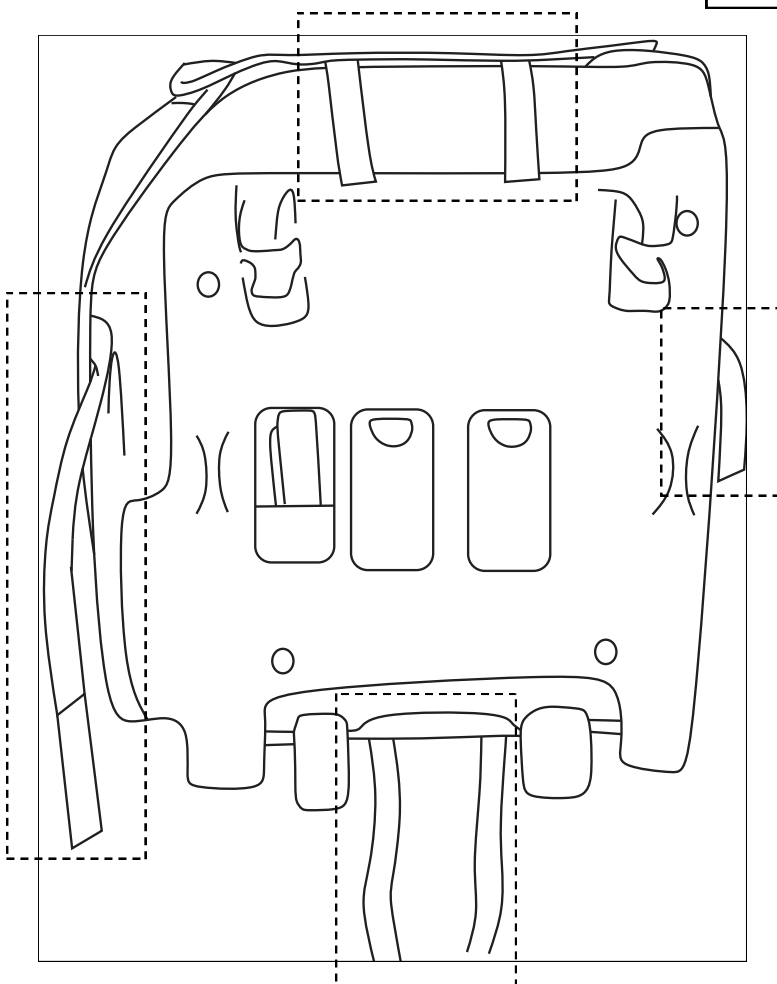
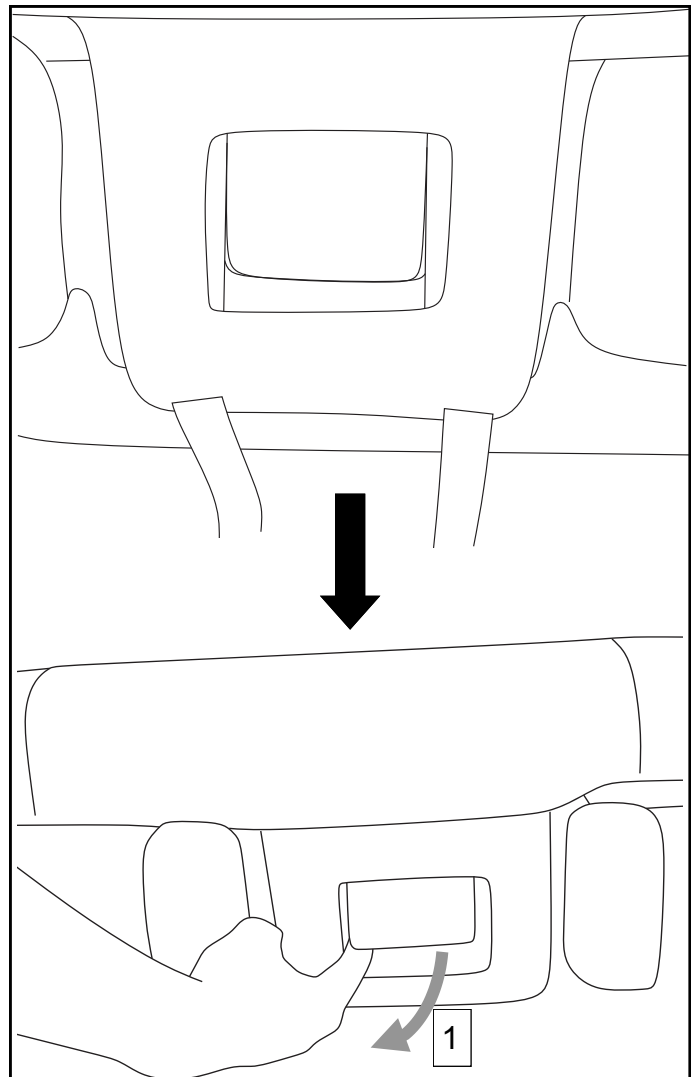

Step 6. Tilt the seat base upright and locate the 3 un-attached straps outlined in the dotted boxes on the left.

Step 6.1 Attach horizontal straps from left to right [1].

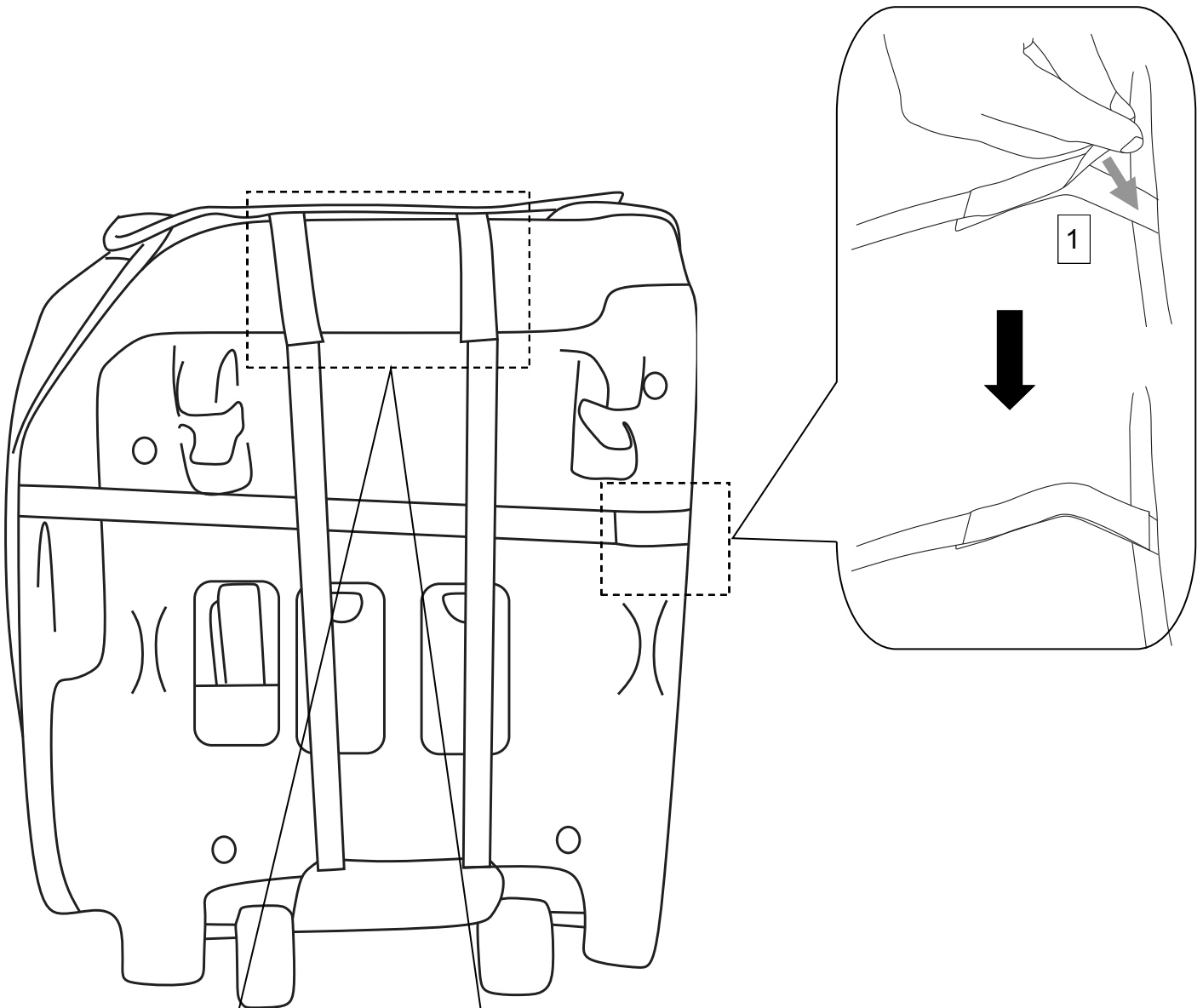

Step 6.2 Attach remaining 2 vertical straps from the front of the seat base to the back where the 2 loop straps are located [2].

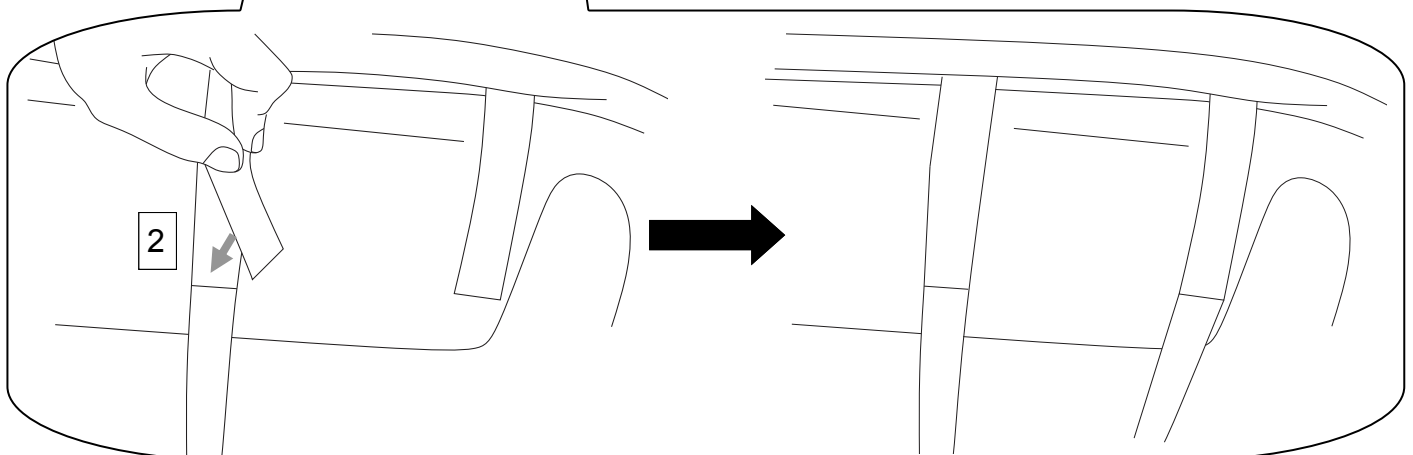

40% (Passenger Side) Backrest Fitment:

Step 1. Align backrest cover to the seat backrest working evenly from left to right [1].

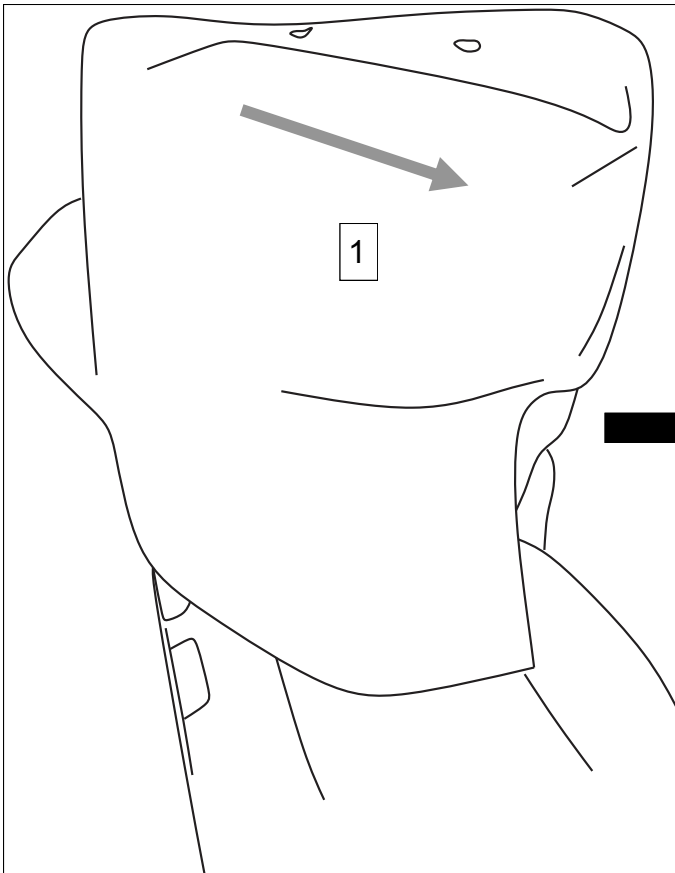

Step 1.2 Proceed to the back of the seat and align the top corners of the backrest cover to the seat backrest [2].

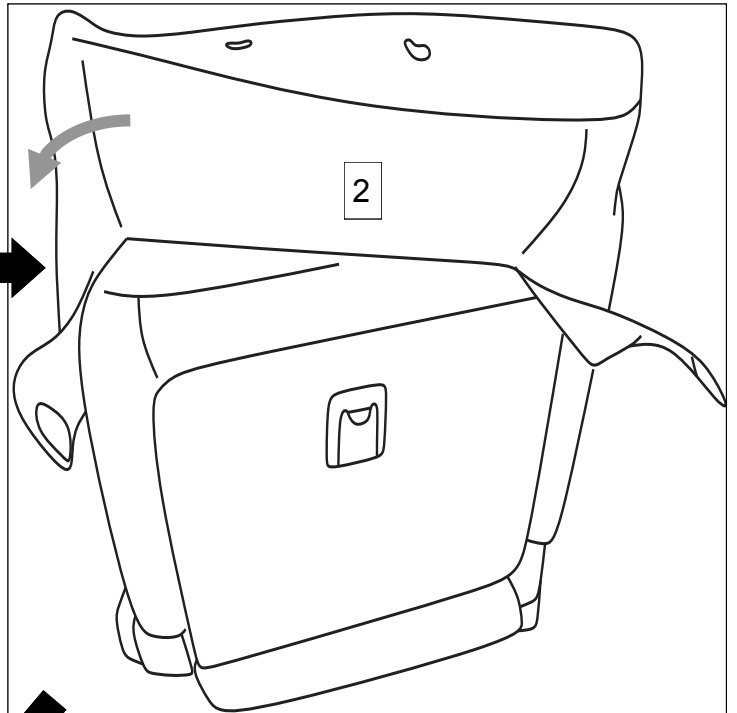

Step 1.3 Pull backrest cover down the backrest evenly [3].

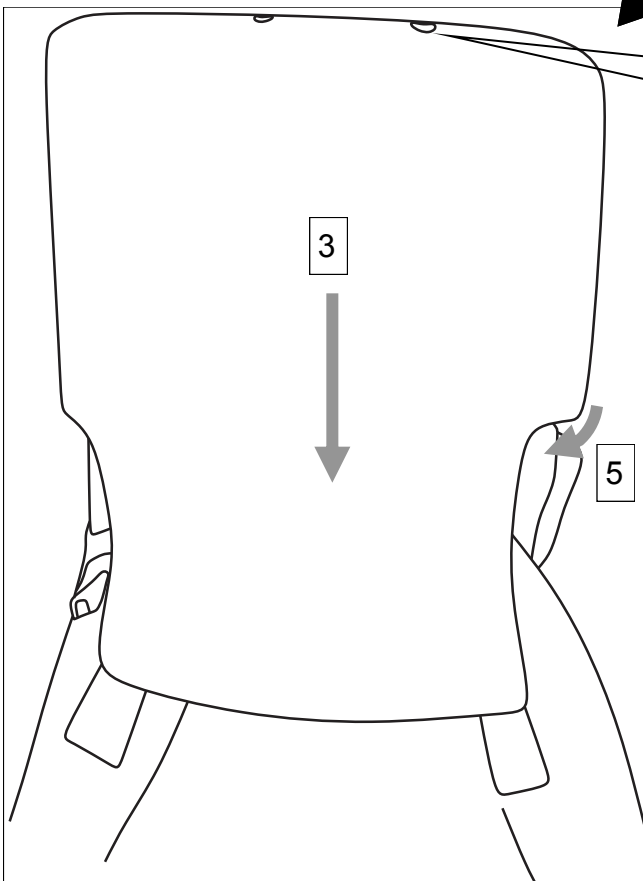

Step 1.4 Using your fingers, tuck the headrest holes under the headrest guides [4].

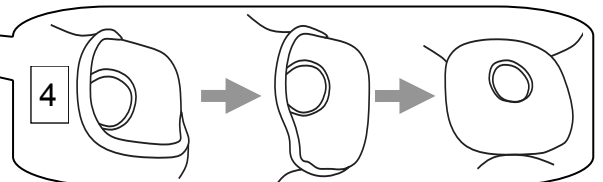

Step 1.5 Align the outside bottom corner of the backrest covers to the seat backrest [5]. Make sure the bottom corner of the backrest cover wraps around the bottom corner of the seat [6].

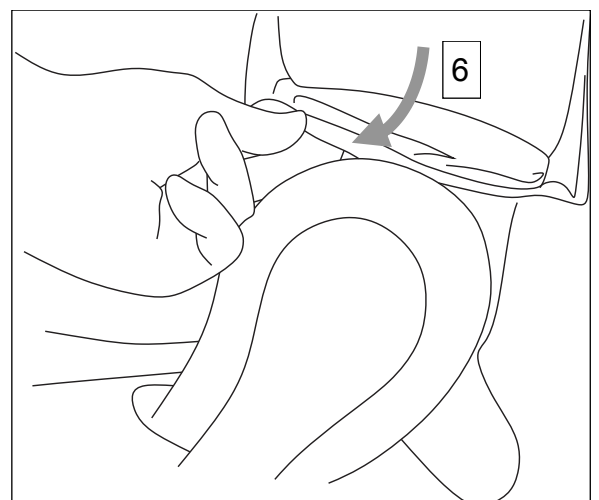

Step 2. Guide seat cover evenly between the seat backrest and seat base [1].

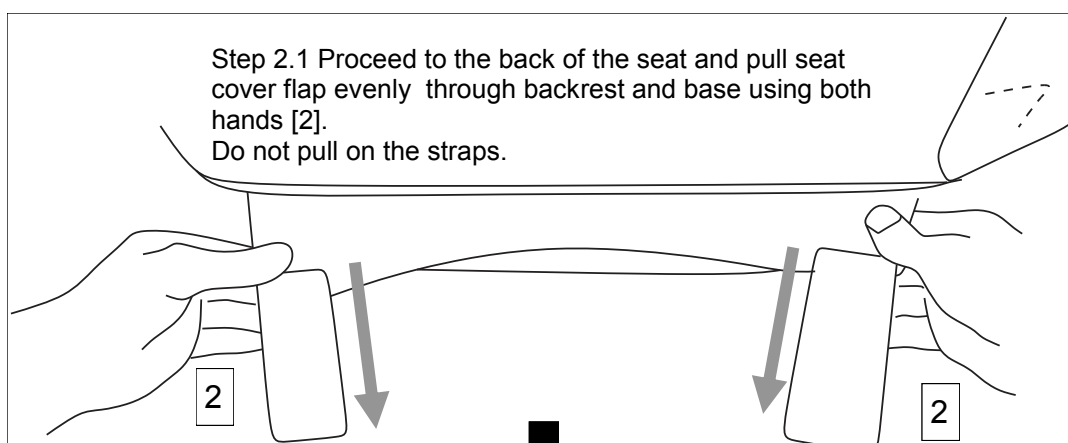
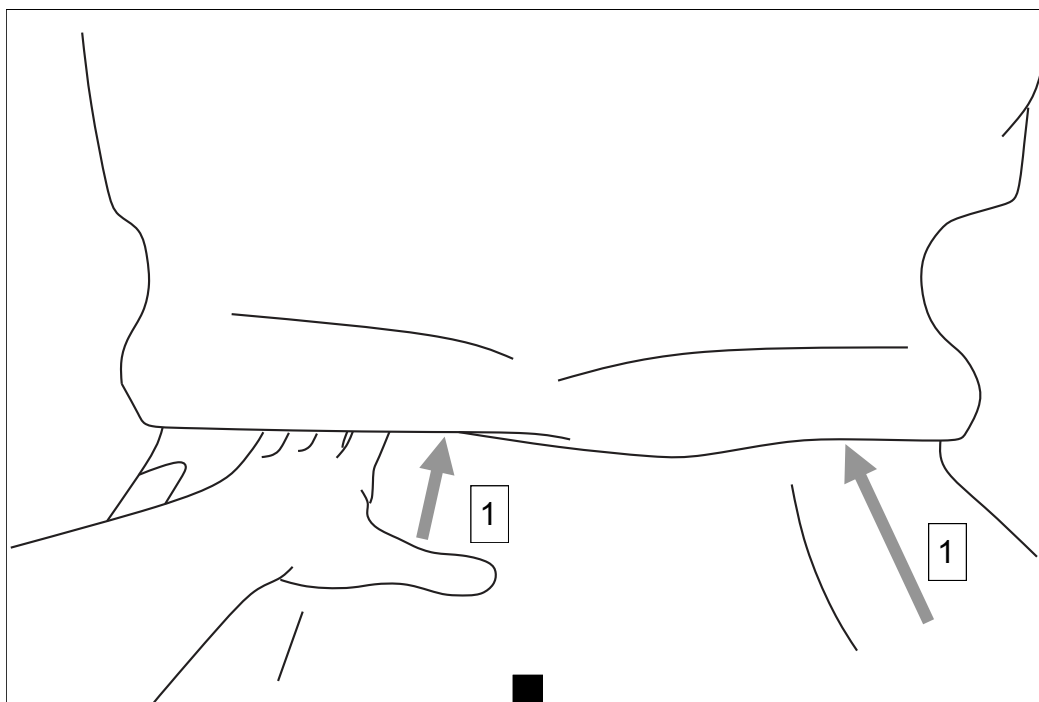

CAUTION:

Do not pull on the straps [3].
This may cause the thread
to break.

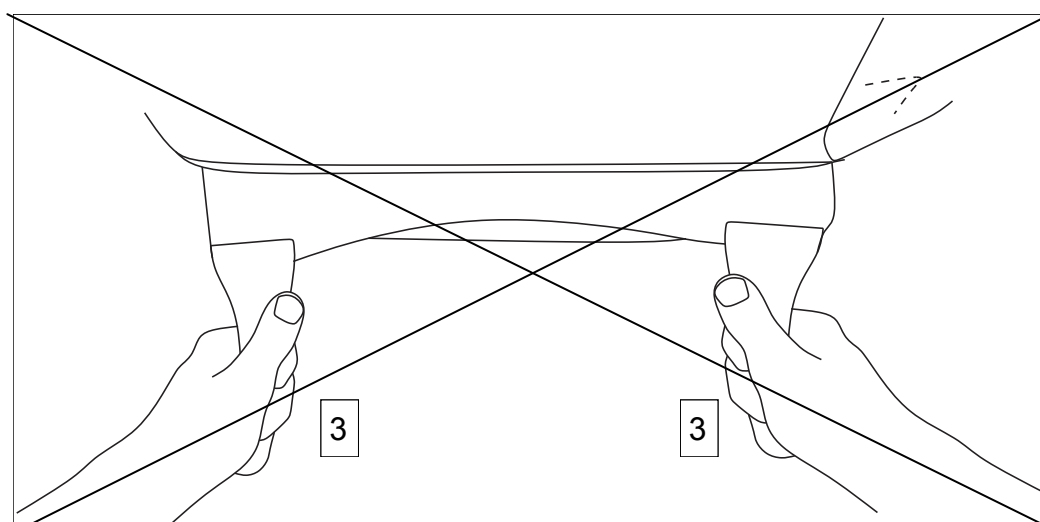

Step 3. Attach the hook and loop tape from the left hand side flap that was pulled through and the side flap of the backrest cover [1].

Step 3.1 Attach the hook and loop tape from the right hand side flap that was pulled through and the side flap of the backrest cover [2].

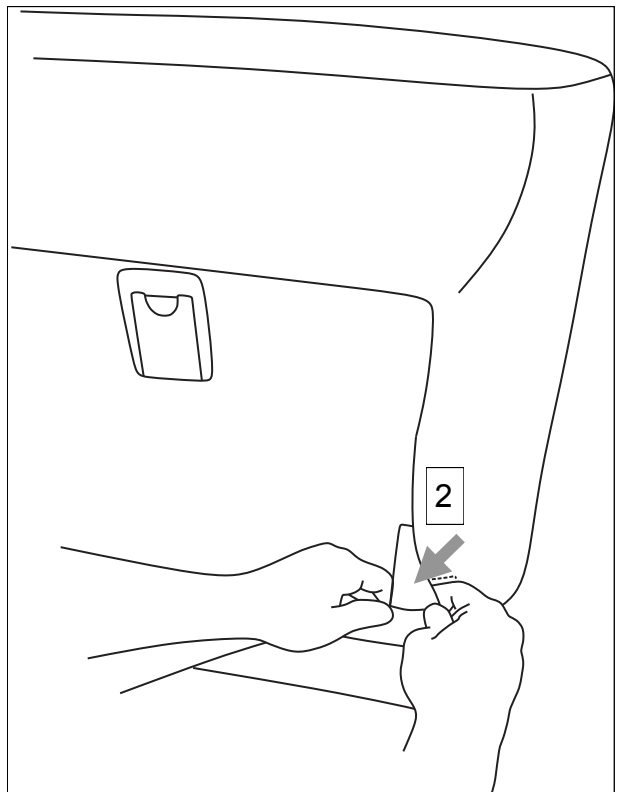
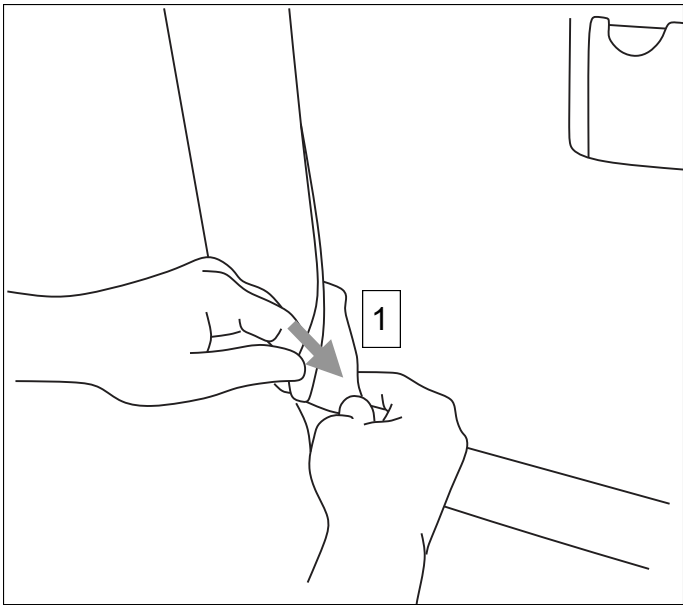

Side Headrest Fitment x 2:

Step 1. Pull headrest cover over headrest from front shorter flap [1] and back flap [2]. Do not pull from the side flaps as the thread may break.

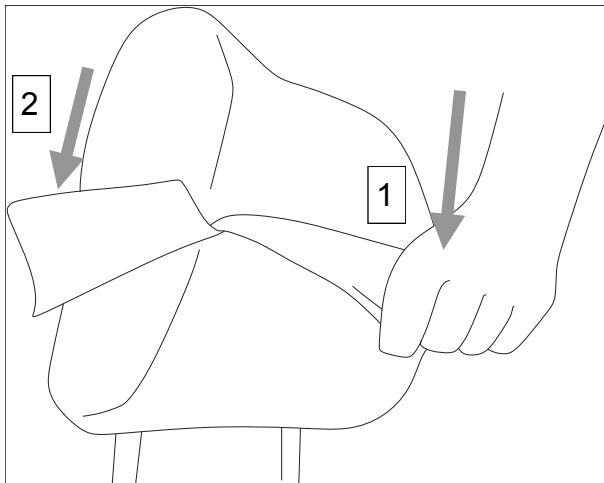

Step 1.1 Tuck side flaps inside around the headrest prongs [3].

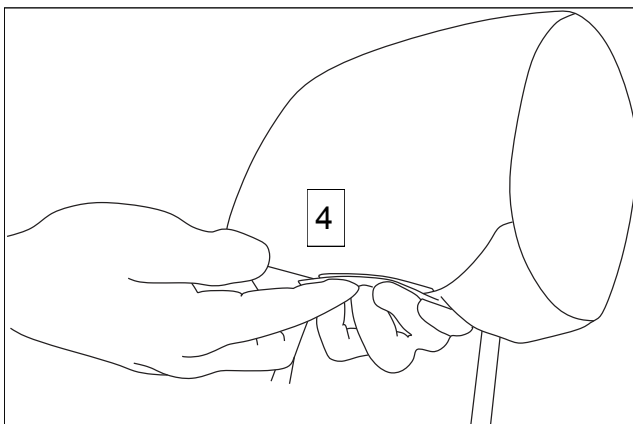
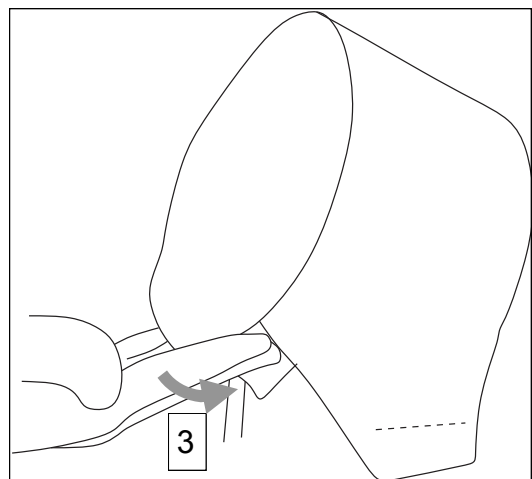

Step 1.3 Attach hook and loop tapes from front and back flaps in the middle underneath the headrest cover [5].

Centre Headrest Fitment:

Step 1. Pull headrest cover over headrest from front [1] (longer flap) and back [2] flaps.

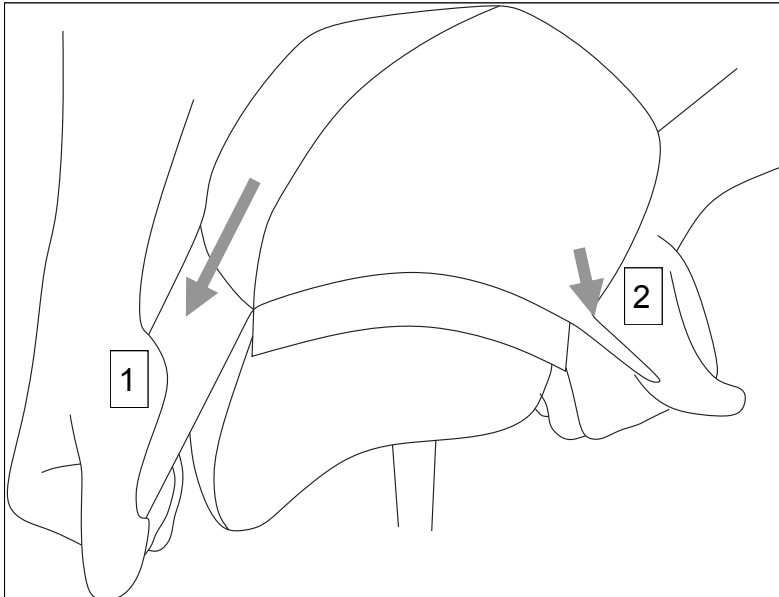

Step 1.1 Attach hook and loop tapes from front flap onto each side flap of the headrest cover [3].

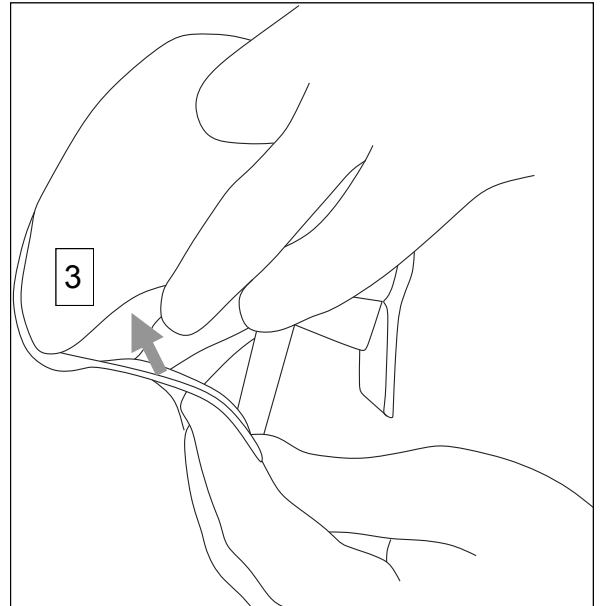

Step 1.2 Attach hook and loop tapes from back flap onto each side flap of the headrest cover [4].

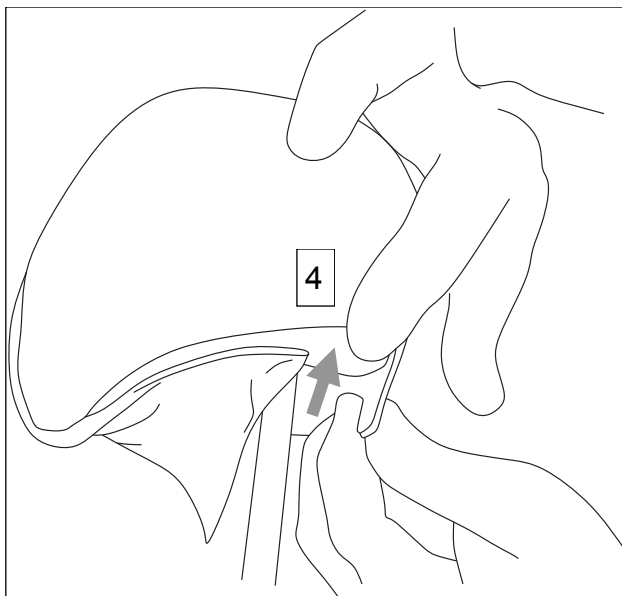

Step 1.3 Attach hook and loop tapes from front and back flaps in the middle underneath the headrest cover [5].

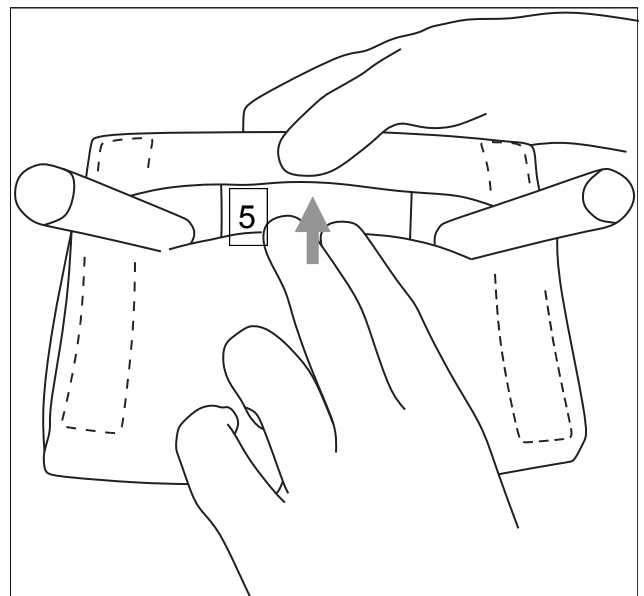

Final Checks

- Check that access to and functionality of all seat belts and buckles is not impeded by the seat covers.
 - Confirm that seat slides freely and locks firmly after adjusting seating position.
- Visually confirm that hook and loop straps are not interfering with wiring harness or mechanical adjustment mechanism through full range of seat adjustment.
 - Adjust the fitment of the seat covers if necessary.