

TOYOTA GENUINE **PARTS, SERVICE & ACCESSORIES**

HILUX

July 2015 Production Onwards
WEATHERSHIELD
 Installation Instructions

Accessory Part No. RH PZQ21-89010 / LH PZQ21-89020
 Accessory Part No. RH PZQ21-89030 / LH PZQ21-89040

Installation Time: Approx. 15 mins

READ INSTALLATION INSTRUCTIONS THOROUGHLY BEFORE COMMENCING INSTALLATION.

PLACE THESE INSTRUCTIONS IN VEHICLE'S GLOVE BOX AFTER INSTALLATION IS COMPLETE

Care Instructions:

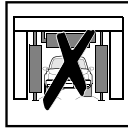

Do not use automatic
car wash.

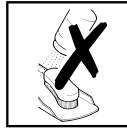

Do not use abrasive,
spirit or solvent
based cleaners.



Clean with a mild
detergent and
water solution.



Do not drive vehicle for
4 hours after installation

Item	Component Name	Qty	Part number
1	SINGLE CAB / EXTRA CAB WEATHERSHIELD - RHS	1	PZQ21-89010
	or		or
	SINGLE CAB / EXTRA CAB WEATHERSHIELD - LHS	1	PZQ21-89020
	or		or
	DOUBLE CAB WEATHERSHIELD - RHS	1	PZQ21-89030
	or		or
	DOUBLE CAB WEATHERSHIELD - LHS	1	PZQ21-89040
2	Front Metal Clip "A"	1	PZQ21-8901A
	Middle Metal Clip "B"	1	
	Rear Metal Clip "C"	1	
	Mirror Sail Clip	1	
	Screw	3	
	Washer	3	
	Hex Nut	3	
	Anti-Abrasive Tape	3	
	Fitment Tool	1	
	Alcohol Wipe	2	
	Adhesion Promoter	1	
	Installation Instruction	1	



Item	Qty		Item	Qty	
A	1	Front Metal Clip "A"	G	3	Hex Nut
B	1	Middle Metal Clip "B"	H	3	Anti-Abrasive Tape
C	1	Rear Metal Clip "C"	I	1	Fitment Tool
D	1	Mirror Sail Clip	J	2	Alcohol Prep Pad
E	3	Screw	K	1	Adhesion Promoter
F	3	Washer	L	1	Installation Instruction

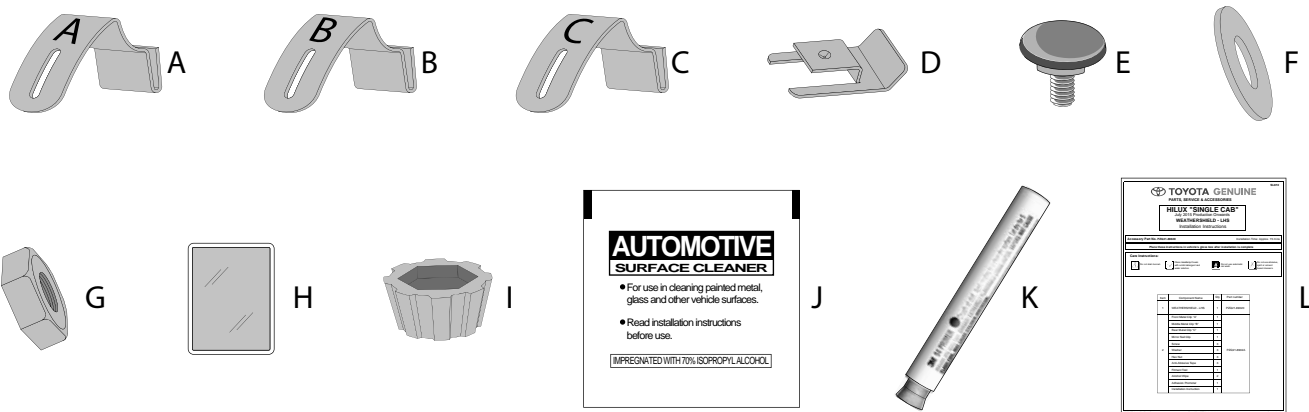

FITTING KIT
PZQ21-8901A

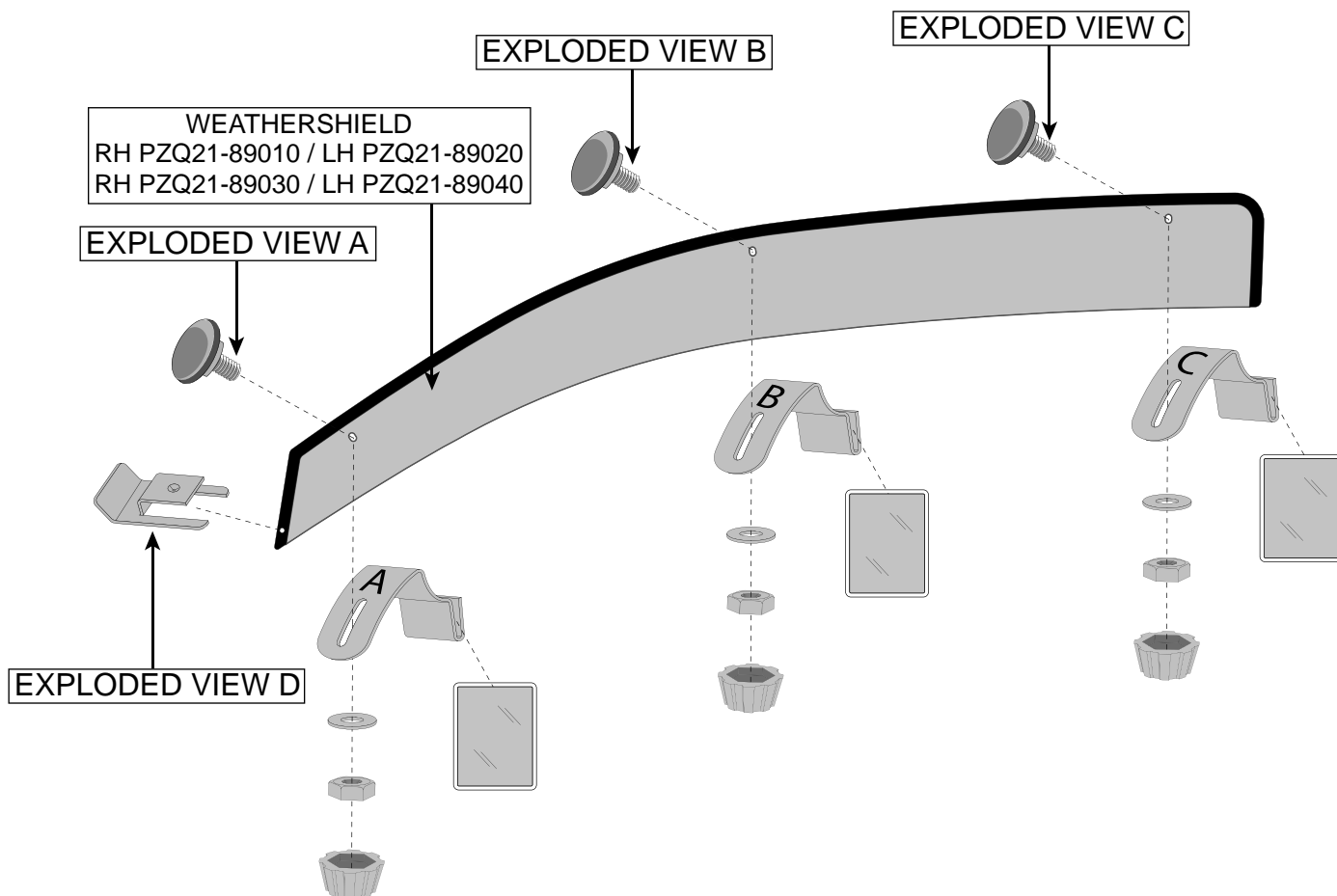
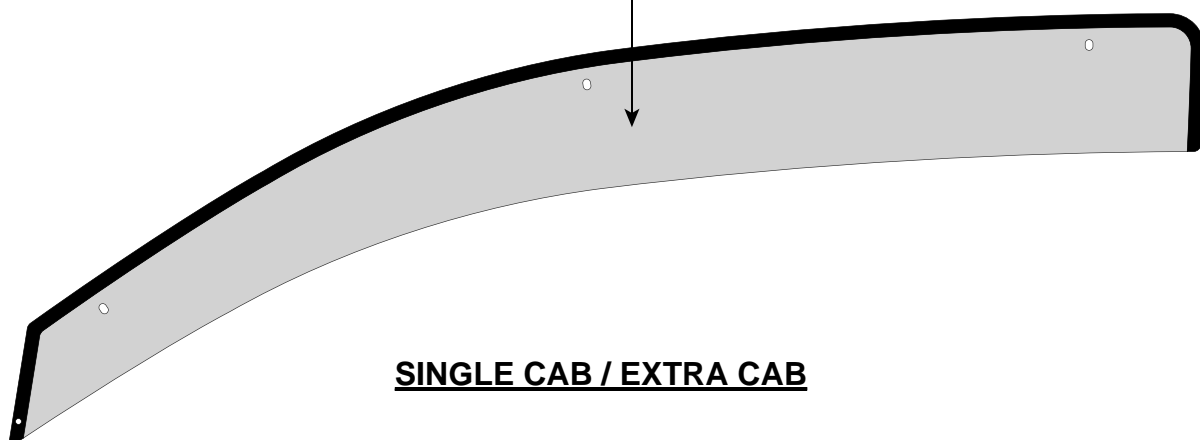

IMAGE IS FOR REFERENCE ONLY



RH PZQ21-89010 / LH PZQ21-89020



SINGLE CAB / EXTRA CAB

RH PZQ21-89030 / LH PZQ21-89040

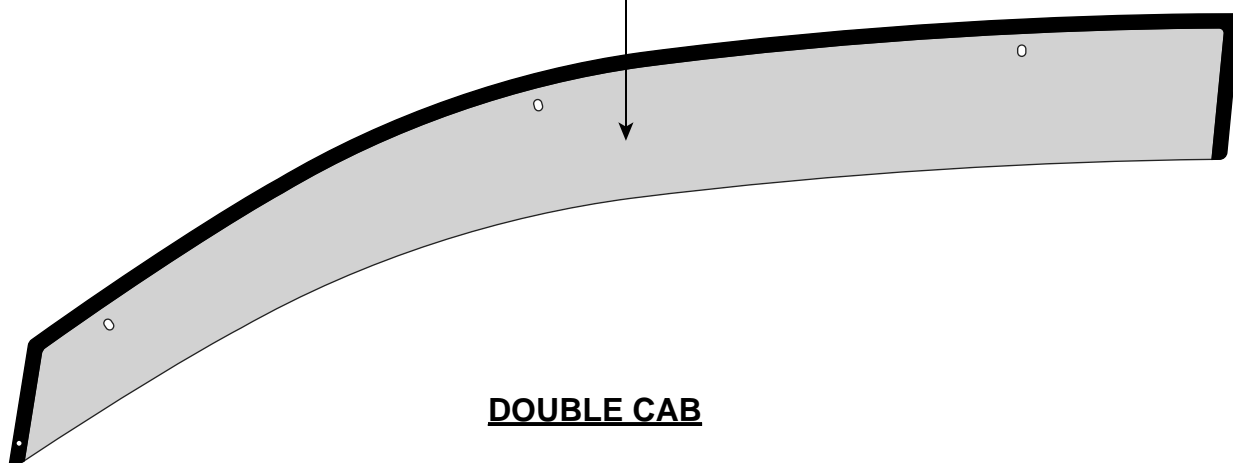

DOUBLE CAB

IMAGE IS FOR REFERENCE ONLY

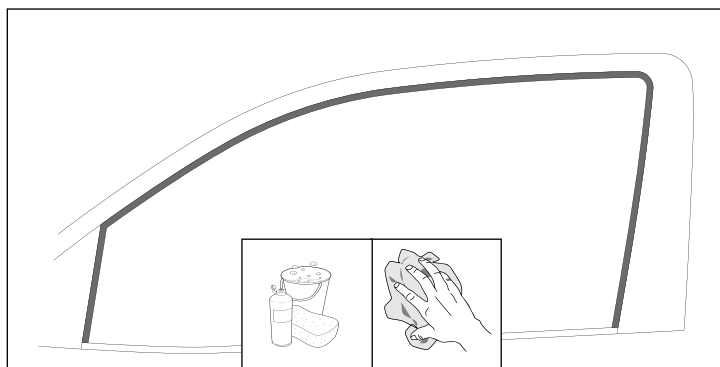
Diagram #: 1

1. Clean and dry the upper door frame. Ensure the surface of the door frame is thoroughly dry.
See Dia #1.

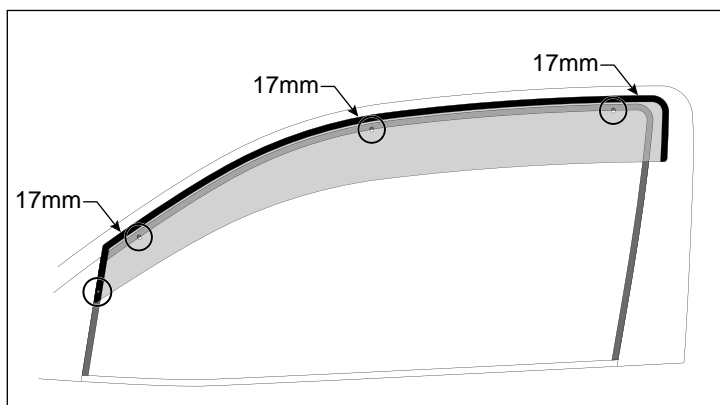
Diagram #: 2

2. Wind the window down and using a ruler, trial fit the Weathershield 17mm from the top edge of the door frame, while locating the front edge of the Weathershield against the mirror sail. Note the four holes on the flange of the Weathershield, and the backing tape attachment areas.
See Dia #2.

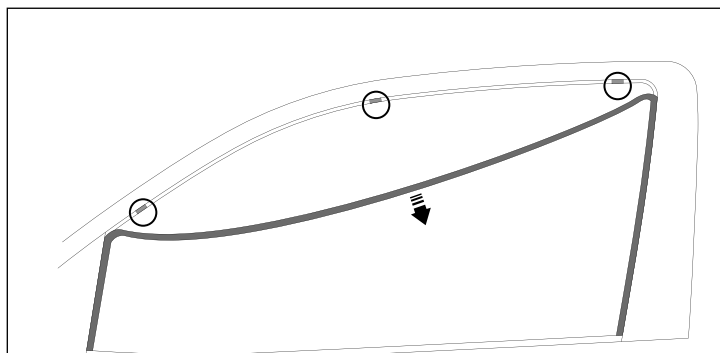

3. Pull the rubber seal out of the door frame channel. At the previously noted and marked locations, clean the door frame with the alcohol wipe provided. Remove any residue with a clean dry cloth. Adhere the anti-abrasive tape strips vertically to the metal clip locations, approximately 1-2mm of the anti-abrasive tape should sit above the rubber seal on the door frame face.
See Dia #3.

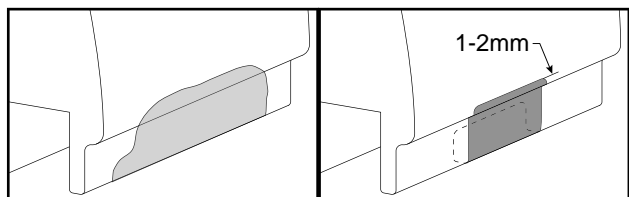
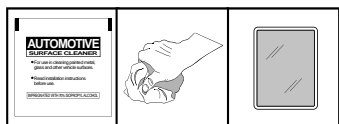
Diagram #: 3

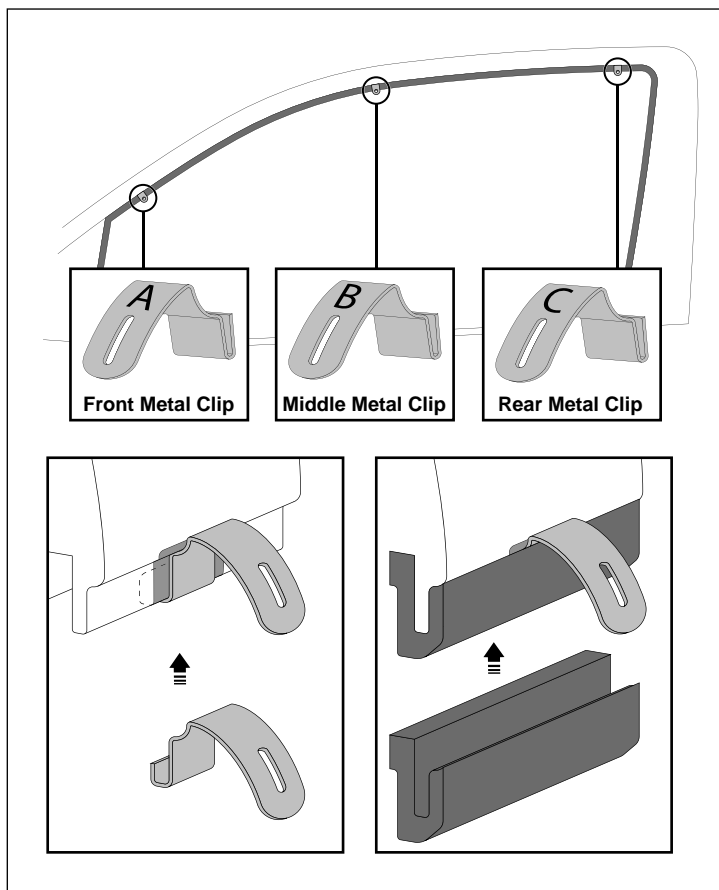

Diagram #: 4

4. Install the metal clips "A", "B" and "C" into the door channel, ensure that the metal clips are located on the anti-abrasive tape strips and not on the door frame. Push the rubber seal back into the door frame channel securing the metal clips.

See Dia #4.

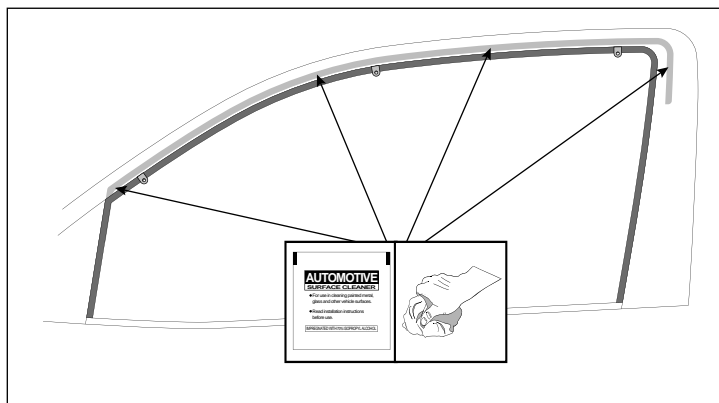

Diagram #: 5

5. Clean the tape attachment area on the door frame thoroughly with the second alcohol wipe provided. Remove any residue with a clean dry cloth.

See Dia #5.

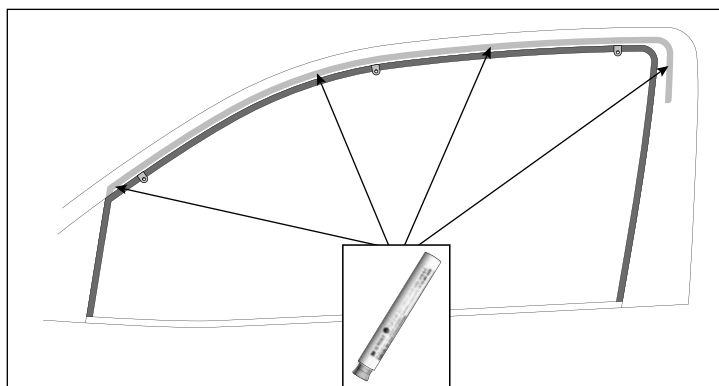
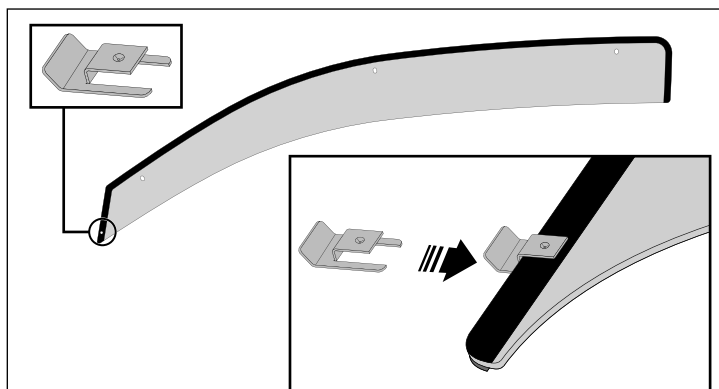

Diagram #: 6

6. Apply adhesion promoter directly onto the tape attachment areas of all four door frames. Allow the Adhesion Promoter 5 minutes drying time once applied.

See Dia #6.

Important: Keep out of contact with eyes, skin etc. Do not inhale.

Diagram #: 7

7. Carefully attach a mirror sail clip to the front edge of the Weathershield, as shown. Ensure the metal clip is positioned over the previously noted hole.
See Dia #7.

See Dia #7.

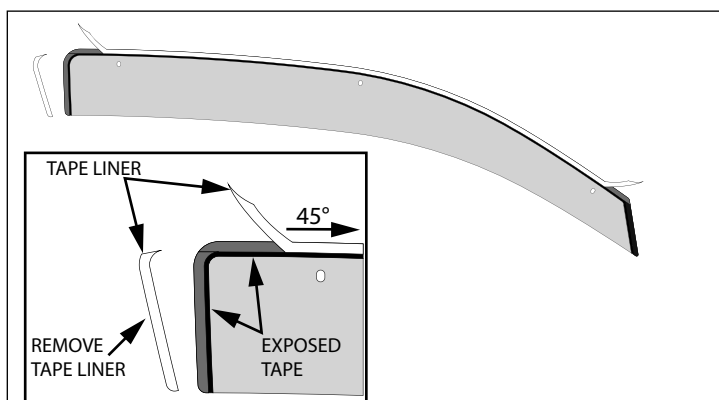
Diagram #: 8

8. Peel back approximately 50mm (2") of the backing tape liner from each of the tape sections and fold at 45° to the outside of the Weathershield, fully remove the vertical tape liner, as shown.

See Dia #8.

Important: Do not touch the exposed surface of the backing tape.

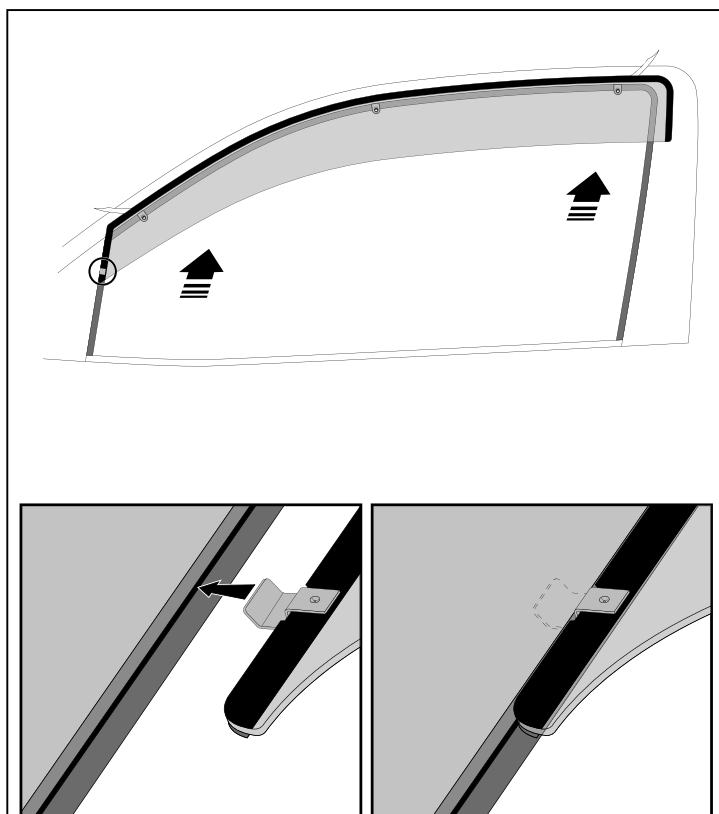
Diagram #: 9

9. Insert the mirror sail clip between the mirror sail and window rubber, ensure the front edge of the Weathershield sits firmly against the mirror sail. Position the Weathershield on the door frame following the positioning in Step 1. Double check the positioning of the Weathershield, then apply light pressure to the tape areas.

See Dia #9.

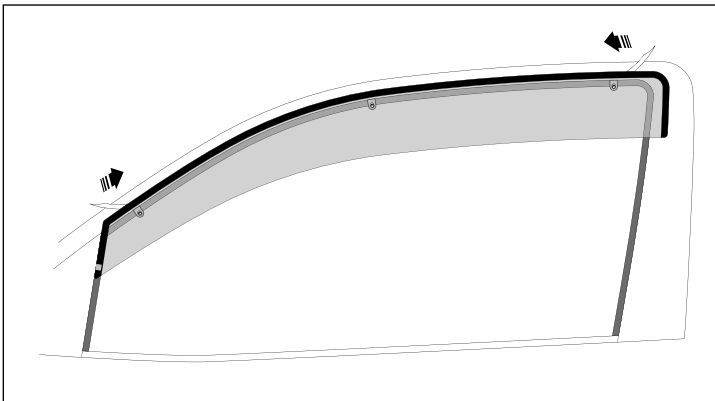

Diagram #: 10

10. Peel the remaining backing tape liner away slowly by pulling on the exposed ends of the liner, apply firm pressure around the attachment areas.

See Dia #10.

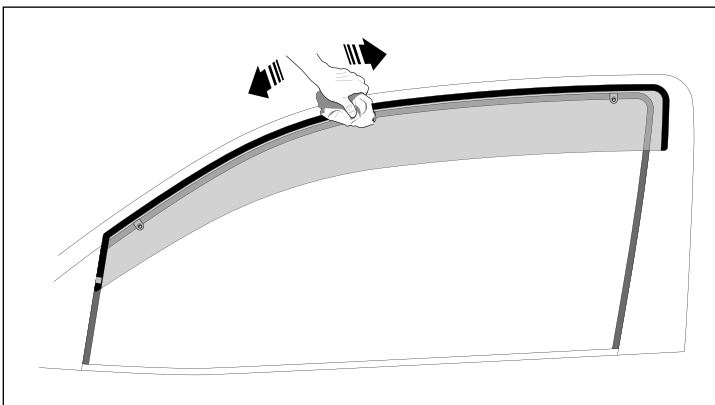
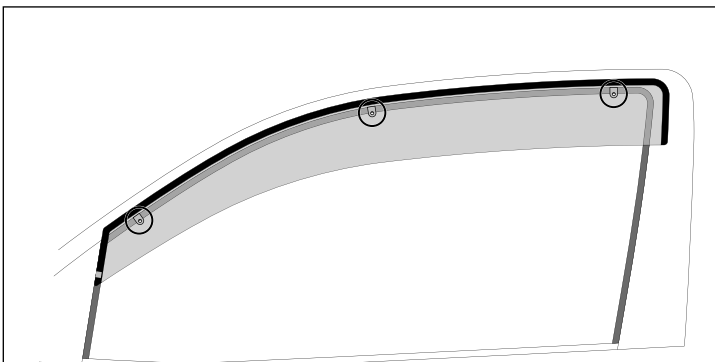

Diagram #: 11

11. Using the clean soft cloth, firmly rub down over the attachment areas a minimum of four times to ensure maximum adhesion.

See Dia #11.



12. Attach screw fixing through the slot in the Weathershield and metal clips "A", "B" and "C". Insert the hex nuts into the fitment tool and fasten Weathershield to the clips using the hex nut and washers provided. Use the supplied fitment tool only to tighten hex nuts.

See Dia #12.

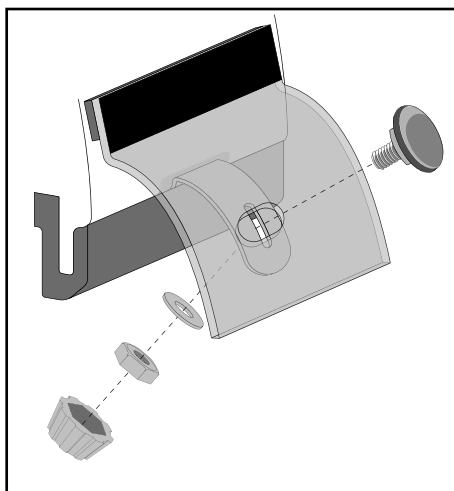

Diagram #: 12