



Hiace LWB Van 6.0
January 2005 Production Onwards
Rear Step
Installation Instructions

Accessory Part No.PZQ64-75081

Installation Time: Approx. 45mins

Place these instructions in vehicle's glovebox after installation is complete.

Important: This step is **very heavy** and requires at least **two people** to lift it to the vehicle. Do not attempt to lift this step without appropriate assistance or serious injury may result.

Parts List

Important: Check contents of kit before commencing fitment and report any discrepancies.

Transit Packaging Notes :*Two each of items 6, 3 and 5 are used to secure the chassis mounts and side arms, Items 13, 14, 15 and 16, and 18 and 19 to the step.

Item	Component Name	Service Part No	Qty
1	M12x1.25x35 Bolt GR 8.8	PZQ64-75081FK	8
2	M12x4.0x2.5 Spring Washer		18
*3	M12 Flat Washer, Ø28ODx3t		26
4	M12x1.25x45 Bolt GR 8.8		8
*5	M12x1.25 Nut		8
*6	M12x1.25x50 Bolt GR 8.8		2
7	M10x1.25x35 Bolt GR 8.8		8
8	M10x3.5x2.2 Spring Washer		8
9	M10 Flat Washer, Ø25.4ODx3t		16
10	Spacer Plate		2
11	M10x1.25 Nut		8
12	Heater Hose 5/8" IDx30		1
*13	RH Lower Chassis Mount		1
*14	LH Lower Chassis Mount		1

Item	Component Name	Service Part No	Qty
*15	RH Side Chassis Mount		1
*16	LH Side Chassis Mount		1
17	Step	PZQ64-75081ST	1
*18	RH Sidearm		1
*19	LH Sidearm		1
20	M8x1.25x30 Bolt GR 8.8	PZQ64-75070DH	6
21	M8 Spring Washer		6
22	M8 Flat washer		6
23	D Handle		2
24	D Handle gasket		2
25	M8 Nutsert	PZQ64-75071SR	6
26	Tekote Sealer/Rust Preventative		1
27	Step Raiser		2

Layout - Figure 1

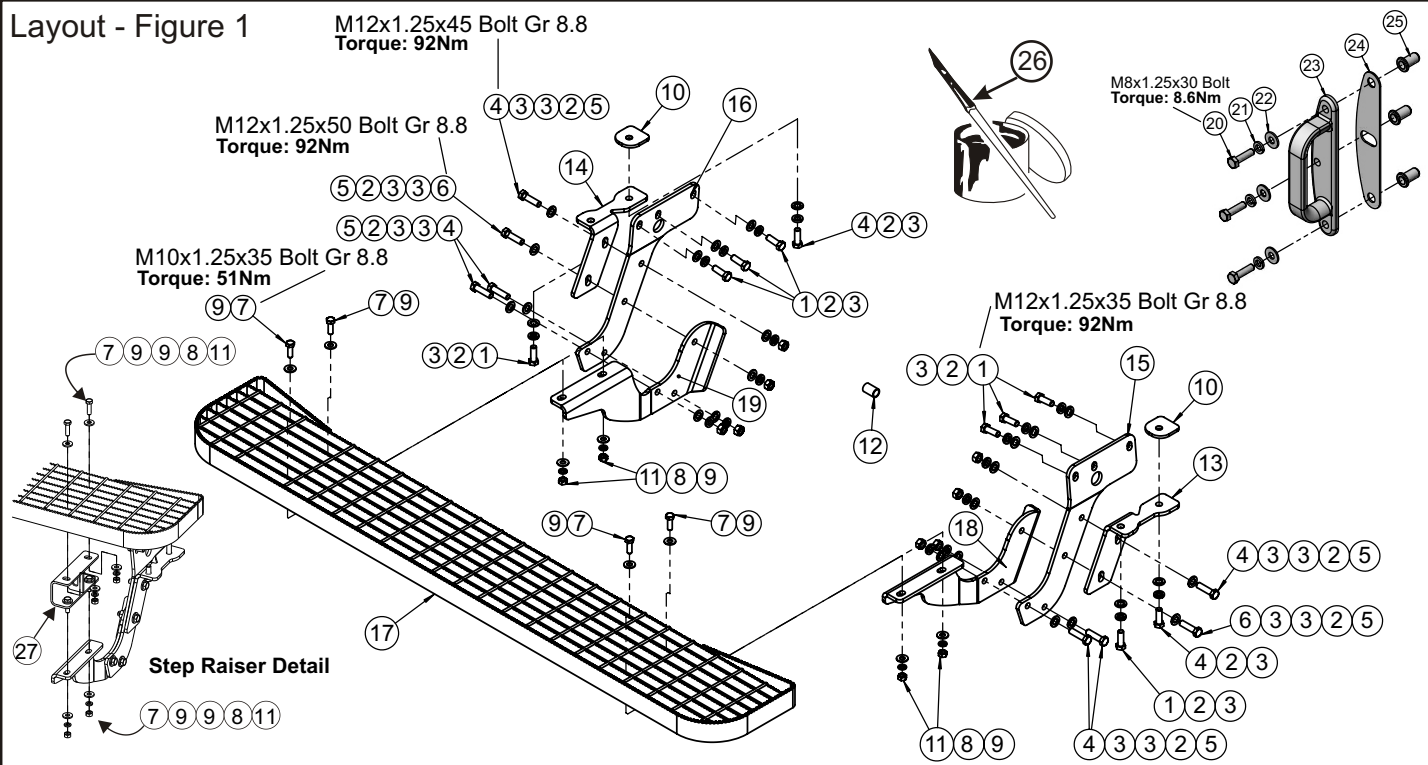

Tools Required:

- 8mm, 17mm, 19mm & 15/16" sockets
- Torque wrench (es) 5Nm to 272Nm

Care Instructions:

Retain the bolts, washers and nuts used for transit packaging. Periodically check bolts for tightness and tighten if necessary.

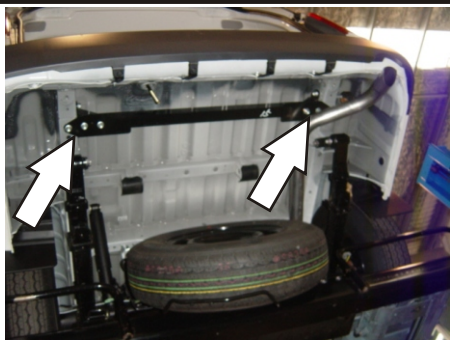

Diagram 1: Remove counter balance beam if present.

Check contents of kit before commencing fitment.

1. Remove counter balance beam from under the rear of the vehicle if present. Discard counter balance beam and attaching bolts* Refer to diagram 1.



***Note: The counter balance beam must be re-fitted if this accessory part is ever removed from the vehicle.**



Warning: Take extreme caution when removing the counter balance beam. It weighs approx 30kg so two people are required to remove it. Failure to do so may result in serious injury.

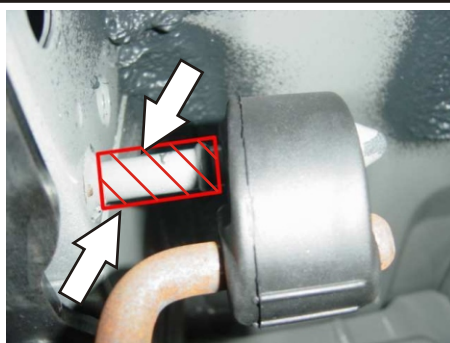

Diagram 2: Secure 5/8" Heater Hose.

2. To prevent the muffler hanger rubber from sliding on the hanger bracket and causing the muffler to foul against the Step, place the 5/8" Heater Hose (*item 12*) over the end of the hanger bracket. Refer to diagram 2.



Diagram 3: Lightly secure Side Chassis Mounts (LH side Chassis Mount shown).

- 3a. Lightly secure RH Side Chassis Mount (*item 15*) to the vehicle with M12x1.25x35 Bolts (*item 1*), M12 Spring Washers (*item 2*) and M12 Flat Washers (*item 3*). Refer to layout diagram on page 1 and diagram 3.

- 3b. Repeat for LH side (*item 16*).

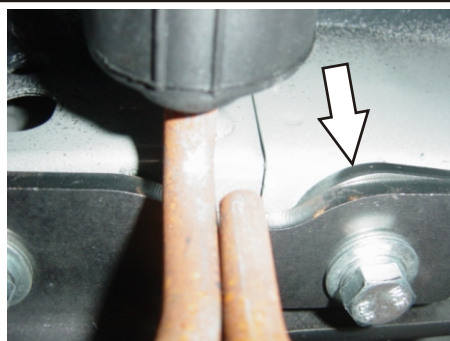

Diagram 4: Ensure Spacer Plate is fitted correctly.

- 4a. Lightly secure the rear most hole of the RH Lower Chassis Mount (*item 13*) to the vehicle with M12x1.25x35 Bolts (*item 1*), M12 Spring Washers (*item 2*) and M12 Flat Washers (*item 3*). Secure the forward most hole with M12x1.25x45 Bolts (*item 4*), M12 Spring Washers (*item 2*) and M12 Flat Washers (*item 3*). Ensure Spacer Plate (*item 10*) is fitted correctly between the body and RH Lower Chassis Mount (*item 13*). Refer to diagram 4 and figure 1 on page 1.

- 4b. Repeat for LH side.

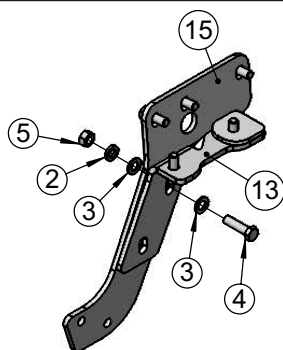

Diagram 5: Lightly secure Lower Chassis Mounts.

5a. Lightly secure the RH Side Chassis Mount (*item 15*) to the upper most slot in the RH Lower Chassis Mount (*item 13*) with an M12x1.25x45 Bolt (*item 4*), M12 Spring Washer (*item 2*), M12 Flat Washers (*item 3*) and M12 Nut (*item 5*) as shown in diagram 5.

5b. Repeat for LH side.

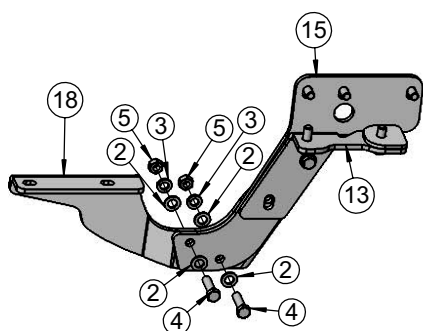

Diagram 6: Secure lower step mounting bolts to chassis mounts.

6a. Lightly secure the two lowest mounting points on the RH Chassis Mount (*item 15*), and the RH Sidearm (*item 18*) with M12x1.25x45 Bolts (*item 4*), M12 Spring Washers (*item 2*), M12 Flat Washers (*item 3*) and M12 Nuts (*item 5*) as shown in diagram 6.

6b. Repeat for LH side.

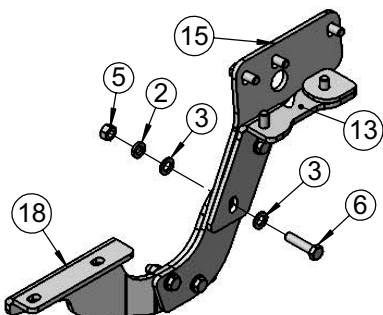

Diagram 7: Secure upper step mounting bolt to chassis mounts.

7. Lightly secure the highest mounting point on the RH and LH Sidearm with M12x1.25x50 Bolts (*item 6*), M12 Spring Washers (*item 2*), M12 Flat Washers (*item 3*) and M12 Nuts (*item 5*) as shown in the layout diagram on page 1 and diagram 7.

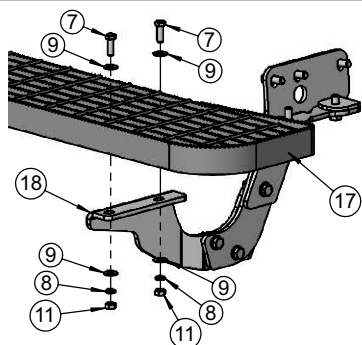

Diagram 8a: Attach Step to vehicle.

8a. If Step Raisers are not being used:

Attach the Step (*item 17*) to the vehicle by using M10x1.25x35 Bolts (*item 7*), M10 Flat Washers (*item 9*), M10 Spring Washers (*item 8*) and M10 Nuts (*item 11*) as shown in the layout diagram on page 1 and diagram 8.

Discard Step Raisers and extra M10x1.25x35 Bolts, M10 Spring Washers, Flat Washers and Nuts.



Important: Tighten all bolts to the correct torque settings as shown in Figure 1, page 1.

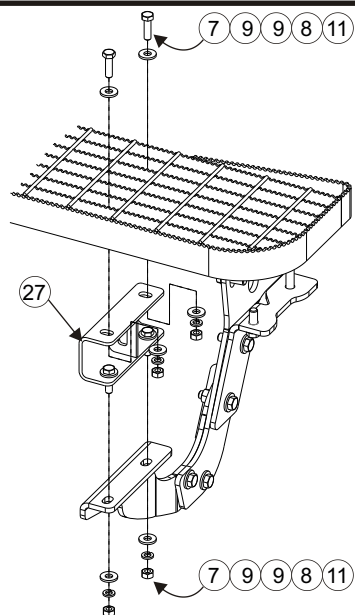

Diagram 8b: Attach Step & Step Raisers.

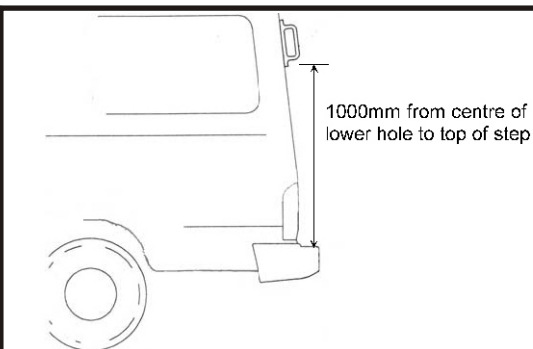

Diagram 9: Mark position of lower hole.

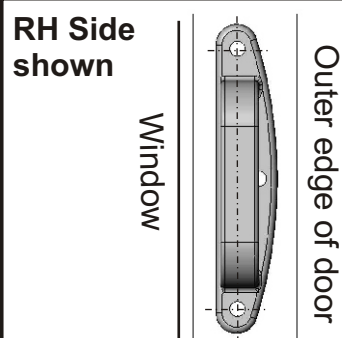

Diagram 10: Use handle as template

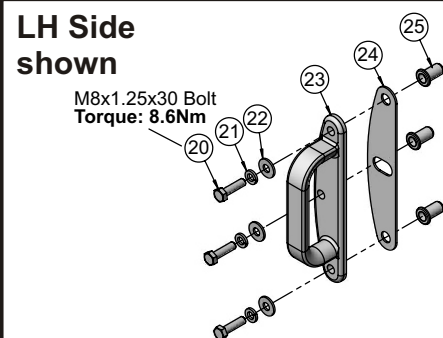

Diagram 11: Secure handles

8b. If using Step Raisers:

Secure the Step Raisers (*item 27*) to the RH and LH Sidearms of the towbar, then secure the Step (*item 17*) to the Step Raisers, using M10x1.25x35 Bolts (*item 7*), M10 Spring Washers (*item 8*), Flat Washers (*item 9*) and Nut (*item 11*) as shown in Diagram 8b.



Important: Tighten all bolts to the correct torque settings as shown in Figure 1, page 1.

9. Align D Handle with centre of window surround. Measure 1000mm from the centre of the lower hole, to the top of the step. Mark hole centre with a felt pen. (Both sides of vehicle).

10. To mark the position of the remaining holes, use the handle as a template. Hold handle with straight side facing towards and parallel with the window. Align the top and bottom holes so they are along the centre line between the window and the outer edge of the door. Lightly centre-punch and drill 5mm pilot hole before re-drilling to 11mm.



Important: Use a drill stop to prevent damage to the struts. Drill through both door skins.

11. To negate the possibility of skin irritation exercise care when applying TEKOTE SEALER/RUST PREVENTATIVE around all nutserts after these have been secured in position.

For best results it is recommended:

- (a) That all visible burrs be removed from drilled holes
- (b) Insert the Nutsert so that the head of the Nutsert is hard against the body panel.
- (c) Secure the Nutserts in position using an appropriate tool.
- (d) Ensure the head of the fitting tool is properly lubricated to maintain in a good condition.

Failure to do so may result in the Nutserts not gripping satisfactorily.

The rubber gasket, item 24, must be placed between the body panel and the handle. Secure the handles with washers and M8 bolts supplied. Tighten to 8.6Nm.

Re-check tension of the handle bolts after approx. 500 kilometres and periodically thereafter.