



# TOYOTA KLUGER

## CARGO BARRIER INSTALLATION INSTRUCTION

### Part # 609600

VEHICLE YEARS OF MANUFACTURE - From March 2014



This cargo barrier is capable of being located in two positions, behind the 2nd row of seats with the seats in an upright position, and behind the 1st row of seats\* with the 2nd row of seats in their folded position. The installation kit contains sufficient components for fitment to the behind 2nd row seats location only. A high degree of technical competence is necessary to correctly install this product.

We recommend this cargo barrier be installed by an authorised outlet to ensure the barrier installation complies with AS/NZS 4034 Standard.

The cargo barrier is designed, manufactured and fitted to decrease the impact hazard in an accident to occupants from cargo carried within the interior cargo space of the vehicle. In the event of an accident, a cargo barrier can reduce injuries caused by cargo intruding into occupant's space.

\*Optional front position kit P/N 609602 is required to install this cargo barrier in the behind 1st row seats position.

**Installation time approximately 1.0 Hour**

"The estimated fitting time is based on an experienced fitter conversant with the fitment procedure"



## WARNINGS

- Strict compliance with fitting instructions is essential for this safety product to meet its rated capacity. Refer user instructions regarding correct usage of the cargo barrier.
- Do not modify cargo barrier in any way.
- Do not use this cargo barrier in any other vehicle for which it is not designed.
- Modifications to the cargo barrier or its fixings or use in any other vehicle for which it is not designed may void the load rating and warranty.
- Do not attach the cargo barrier to the vehicle using seat, seat belt or child restraint anchorage's.
- Where high tensile threaded fasteners are used, the cargo barrier must be installed using the size and grade fasteners specified by Milford Industries.
- Do not drill, rivet, adhere or attach objects to the front or rear of the cargo barrier.
- Do not place smaller items, that may bypass the cargo barrier in the event of heavy braking or collision, near the edges of the barrier.
- Position the load against the cargo barrier.
- When load is positioned against cargo barrier, secure the load with a restraint system.
- During a collision moving cargo may damage seat belts or tether straps of a child restraint device, or its anchorage. Load should be carefully positioned so as not to come in contact with these items.
- Do not obstruct seat belts or child restraints, or their operation.
- Long thin items of cargo should be positioned in the vehicle with the long axis across the vehicle to minimise the penetration risk.
- If involved in an accident or accidentally damaged, the cargo barrier should be replaced and the anchorage's repaired to as new condition.
- Clean with soap and water only. Do not use solvents or chemicals. Discard cargo barrier if it becomes rusted. Do not expose to direct sunlight for long periods.
- It is extremely dangerous to ride in the cargo area of the vehicle behind the cargo barrier. It is recommended that the cargo barrier be removed. In a collision people or children riding unrestrained in these areas are more likely to be seriously injured or killed.
- Never leave a child in the vehicle unattended, particularly in the rear cargo area. The cargo area should never be used as a play area for children.
- The cargo barrier may deform and significantly intrude into occupant's space in an accident.
- Remember that the tailgate cannot be opened from inside the cargo area.
- The fixed labeling should not be removed from the cargo barrier.
- Failure to comply with warning notes may prevent the barrier protecting the occupants.
- Parents should explain to children how and when to use **EMERGENCY ESCAPE HAMMER** attached to cargo barrier.
- Do not remove the rating plaque from the cargo barrier.

## NOTICE TO INSTALLERS & DISTRIBUTORS

**Please ensure User Instructions are left with vehicle owner after installation.**

# TOYOTA KLUGER

## CARGO BARRIER INSTALLATION INSTRUCTION

Part # 609600

VEHICLE YEARS OF MANUFACTURE - From March 2014



**IMPORTANT:** The installation kit contains sufficient components to fit the cargo barrier. A high degree of technical competence is necessary to correctly install this product. We recommend this cargo barrier be installed by an authorised outlet to ensure the barrier installation is correct. These instructions must be read and clearly understood before commencing installation. Check contents of kit before commencing fitment and report any discrepancies or damage.

### Parts List

Item	Component Name	Part No.	Qty
1	Cargo Barrier ASM (see page 9)	609600	1
2	Bracket ASM (Bottom)	753519	2
3	Bracket ASM (Top LHS)	753522	1
4	Bracket ASM (Top RHS)	753524	1
5	Screw - Button Head, M6 x 16mm ZP	912515	2
6	Trim Garnish - Base & Lid	753075	2
7	Garnish Spacer	753076	2
8	Wave Washer - 10mm ZP	932125	6
9	Milbolt - M10 x 14mm	912816	2
10	Milbolt - M10 x 19mm	912820	2
11	Milbolt - M10 x 34mm	912835	2
12	Label - Warning (Orange)	905017	1
13	Marking Pin	906185	1
14	Bush - Pivot Saddle	752680	2
15	Pivot Saddle	752700	2
16	Screw - Hex Head, M10 x 1.5 x 20mm ZP	912205	2
17	Hex Nut - M10 x 1.5 Nyloc ZP	922090	2
18	End Cap (Bottom strap ends)	904040	2
19	Strap—Bottom RHS	776844	1
20	Strap—Bottom LHS	776845	1
21	Strap—Top	776846	2

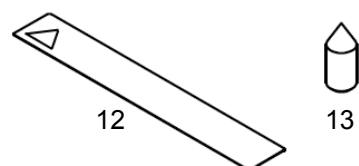
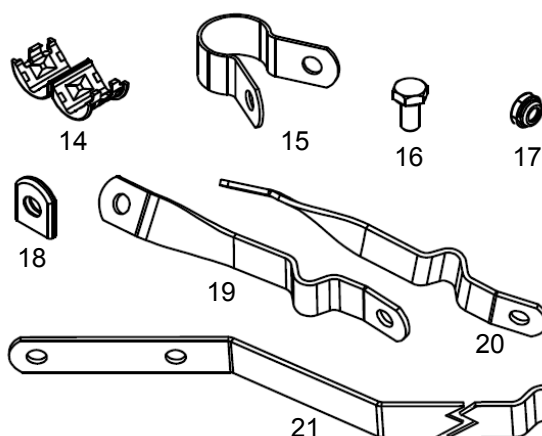
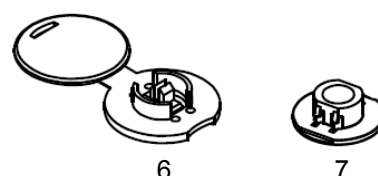
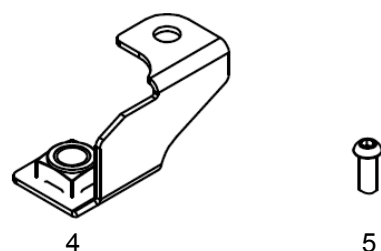
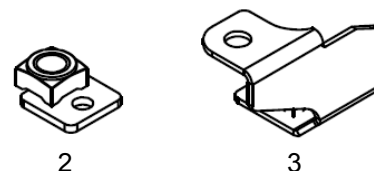

**E and OE—Errors and Omissions Excepted**



## ADVICE TO FITTER

**Note:** To fit the cargo barrier the following is essential: (where applicable)

- ☐ Always drill perpendicular to surface (Unless stated otherwise).
- ☐ A positive drill stop should always be used to prevent accidental damage to external panels, fuel lines etc.
- ☐ Ensure Safety Eye Protection and Gloves are worn as required when using cutting tools.
- ☐ When cutting metal panels be very careful of sharp edges, for risk of skin cuts etc.
- ☐ Care should be taken when applying Rust Preventative sealer to all holes drilled, to negate the possibility of skin and eye irritation.
- ☐ Check screws in relevant components by hand before installation. Should there be resistance re-tap threads and re-check.
- ☐ **Before marking or drilling to install this cargo barrier, check vehicle for LPG conversion & non standard fuel tanks. Locate tanks and all lines attached and take EXTREME CARE not to damage whilst installing this cargo barrier.**
- ☐ **Before drilling to install this cargo barrier, check for concealed wiring looms. E.g. tow bar, reversing camera, reversing sensor wiring etc.. Relocate before drilling to avoid damage.**

**CARE SHOULD BE TAKEN NOT TO CROSS THREAD THE FASTENERS DURING  
 INSTALLATION OF COMPONENTS TO THE VEHICLE.**

## TOOLS REQUIRED

- |                      |                             |
|----------------------|-----------------------------|
| ◦ Socket wrench      | ◦ 5mm, Drill Bit            |
| ◦ Metric hex sockets | ◦ Drill stop's              |
| ◦ Metric spanners    | ◦ 20mm Vinyl Cutter         |
| ◦ Trim removal tools | ◦ Hex bits & driver         |
| ◦ Screwdrivers       | ◦ Vacuum Cleaner            |
| ◦ Power Drill        | ◦ Cover sheet / Drop sheet  |
| ◦ Masking Tape       | ◦ Torque Wrench (10Nm/22Nm) |
| ◦ Marker             | ◦ Clean Rag                 |



## INSTALLATION PROCEDURE FOR BOTTOM MOUNTS



1. Identify the area which you will be working in. (D anchors at the sides of the rear cargo area)
2. Lay the 2nd and 3rd row seats down flat.
3. Remove the cargo blind if fitted.



4. Unclip the screw covers from the wheel arch D anchors. These will not be replaced.

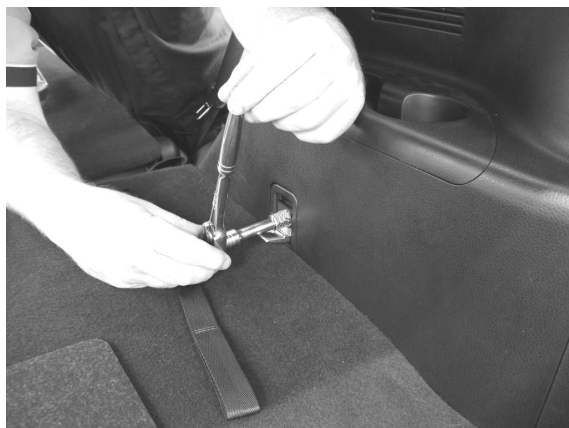

5. Undo the wheel arch D anchor screws and discard.

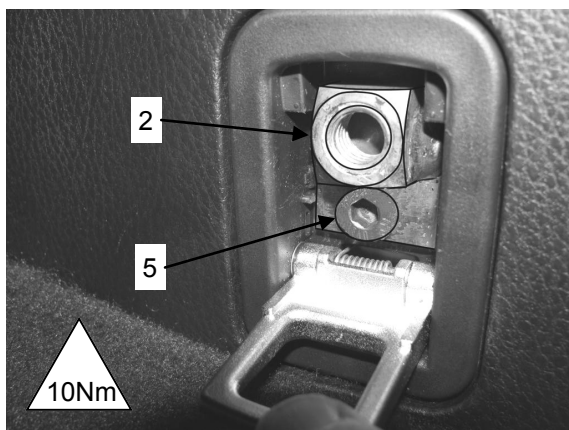

6. Position a bottom bracket ASM (2) inside a D anchor as shown.
7. Secure the bottom bracket ASM and D anchor in place using M6 button head screw (5).
8. Tighten and torque up the screw to 10Nm.
9. Repeat above steps for the other side.



### PREPARATION FOR UPPER MOUNT INSTALLATION

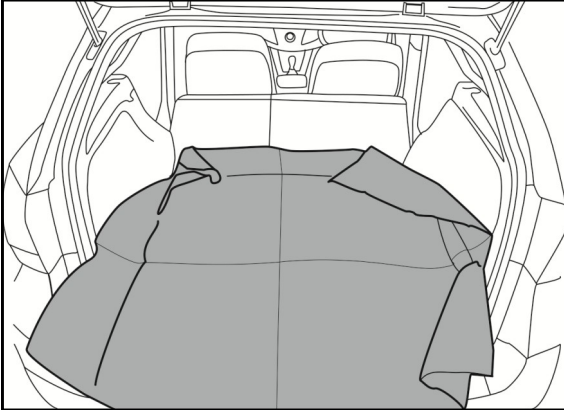

10. Place a drop sheet over the cargo area floor to protect the trim.

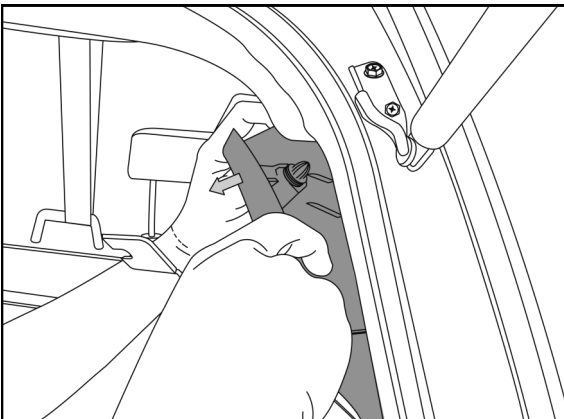

11. Using suitable trim removal tools unclip the top edge of the rear quarter trims, the top edge of the C Pillar trims and the trims above the cargo area side windows.

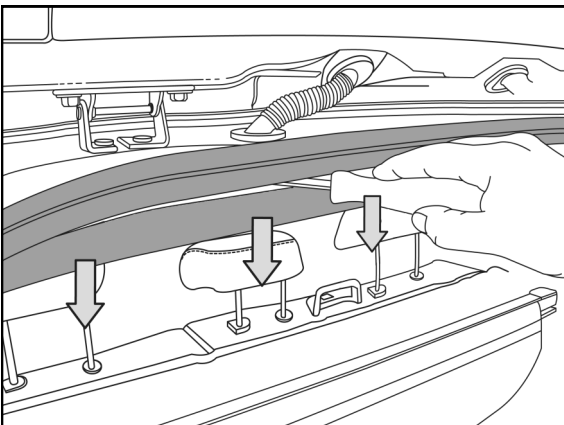

12. Using suitable trim removal tools, unclip the back edge of the roof lining allowing enough space to access the tailgate hinge securing nuts.

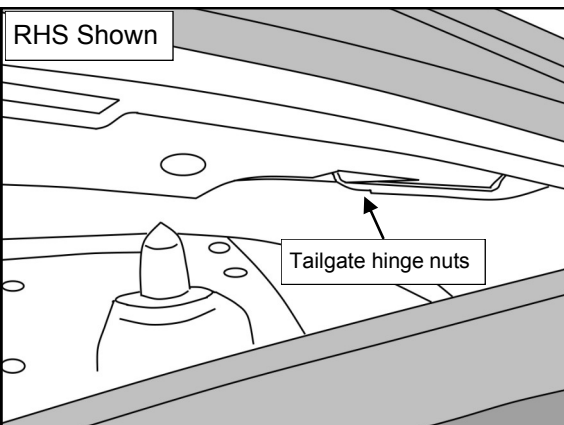

13. Familiarise yourself with the areas where the tailgate hinges are secured to the rear roof member. (oval cut outs in roof panel)



## INSTALLATION PROCEDURE FOR UPPER MOUNTS

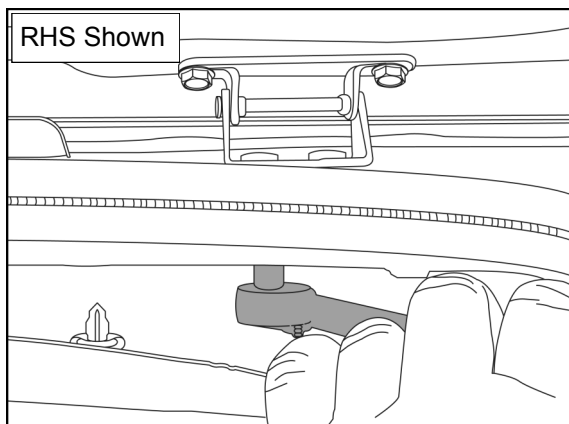

14. Working on one tailgate hinge at a time undo and remove only the hex nut closest the middle of the vehicle.  
(12mm AF socket required)



**Important: Do not remove the 2nd (outer) hex nut securing the tailgate hinge.**

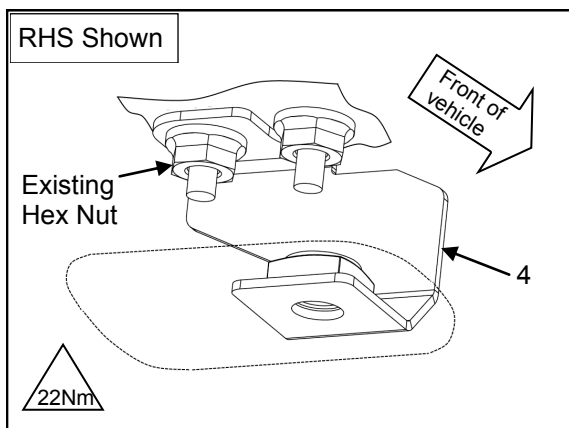

15. Place the correct roof bracket over the vacant tailgate hinge stud as shown then replace the hex nut.
16. Tighten and torque up the hinge nut to 22Nm.
17. Repeat above steps on the other side.

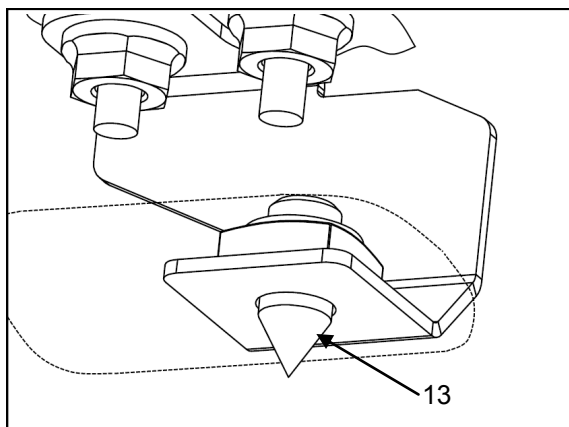

18. Screw a marking pin (13) into one of the captive nuts in roof brackets with approximately 8mm protruding.

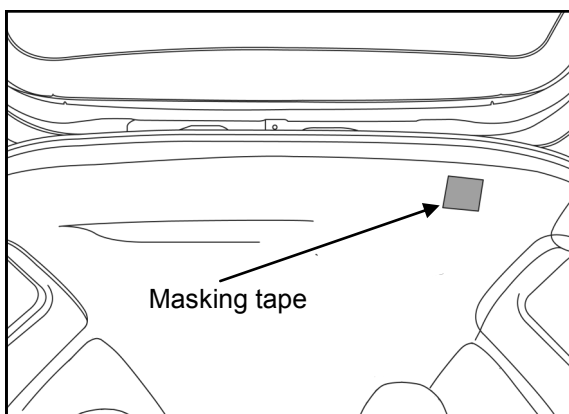

19. Affix masking tape to the cabin side of the roof lining at the approximate location of the marking pin in upper mounting bracket.



## INSTALLATION PROCEDURE FOR UPPER MOUNTS - Cont'd

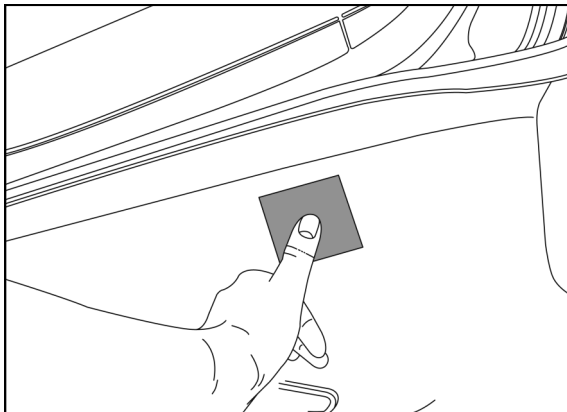

20. Apply pressure to the roof lining at the marking pin locations until the point can be seen on the cabin side of the roof lining. Mark this location if required.
21. Remove the marking pin and repeat the procedure on the other side.

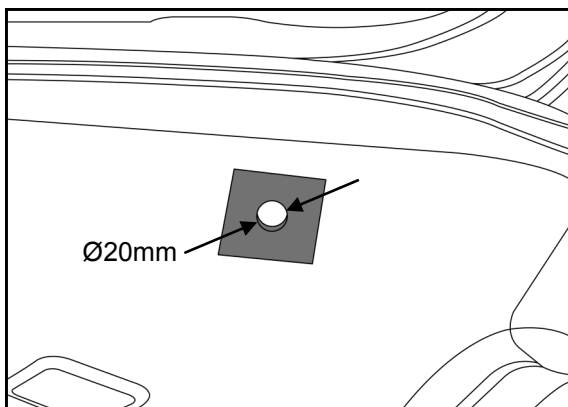

22. At the marked locations carefully drill a Ø5mm pilot hole through roof lining.  
**Use of a drill stop is recommended.**
23. Using a Ø20mm vinyl cutter enlarge the pilot holes through roof lining.
24. Remove the masking tape.

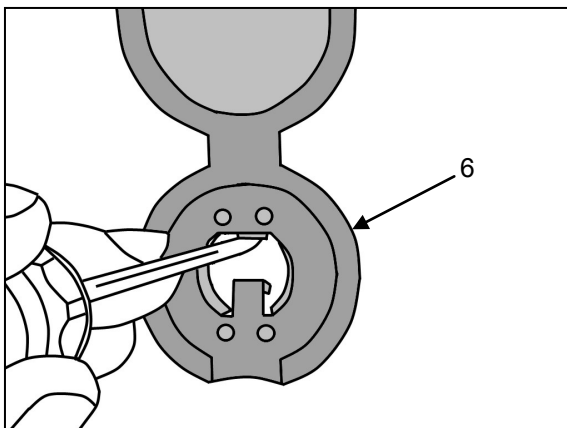
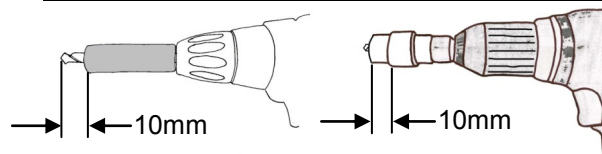

25. Insert a trim plug base (6) into the 20mm hole in trim with the cover positioned towards the front of vehicle.
26. Using a small screwdriver or similar push the trim plugs retention legs outwards to engage them in behind the roof trim.

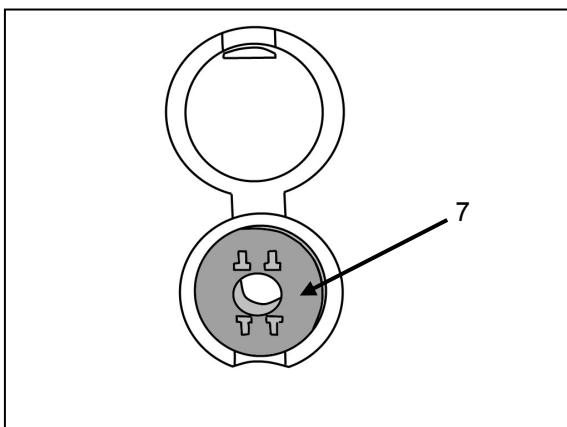

27. Push a trim plug insert (7) into the centre of the trim plug base until it clips in place flush.
28. Repeat the above steps on the other side.



## ASSEMBLY OF THE CARGO BARRIER

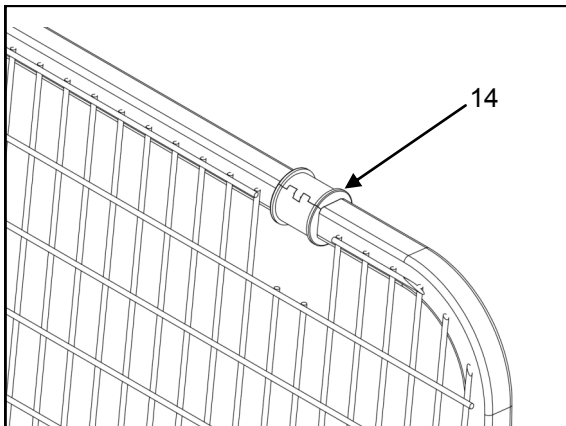

29. Locate the cut outs in the mesh at the top part of the cargo barrier frame.
30. At each cut out place a pivot saddle bush (14) over the frame clipping it shut on the frame.

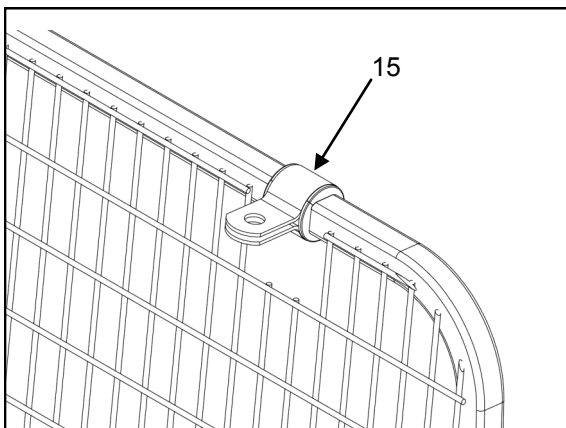

31. Place a pivot saddle (15) over each of the saddle bushes then push the ends together.

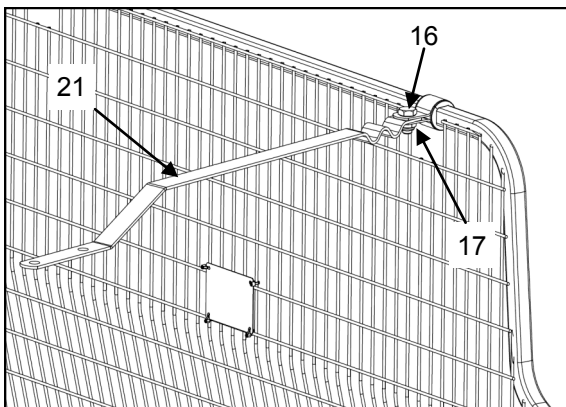

32. Position a strap (21) in between the saddle with the wrinkle facing downward as shown.
33. Secure the strap to the saddle using M10 screw (16) and nyloc nut (17).
34. Tighten the screw until the strap is firm in the saddle but can still be pivoted.
35. Repeat on the other side.

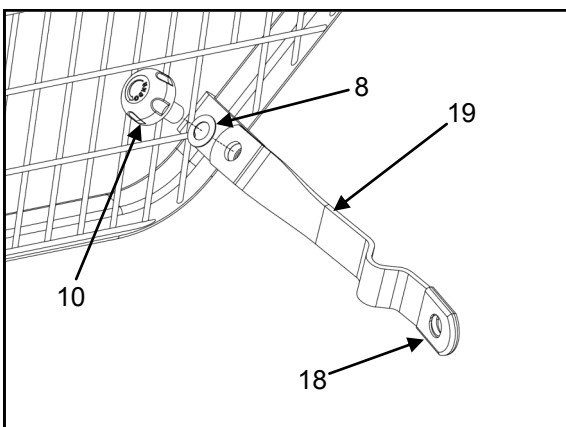

36. On the RHS bottom of the cargo barrier, attach bottom strap (19) to the cargo barrier bracket as shown using 19mm Milbolt (10) with wave washer (8) under head.
37. Repeat on the LHS using strap (20).
38. Push an end cap (18) onto the ends of the bottom straps as shown.





## AFFIXING OF WARNING LABEL

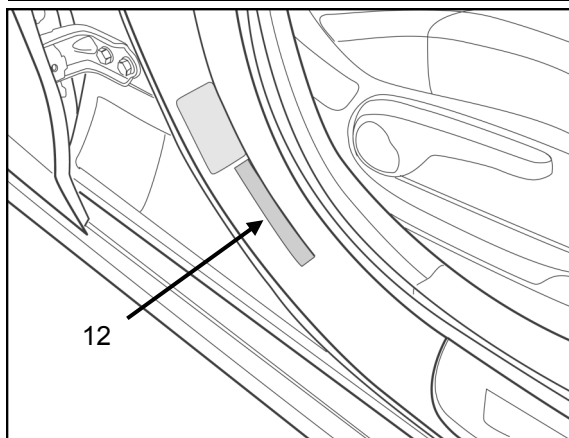

39. Clean the area shown inside the drivers door opening.
40. Affix the orange warning label (12) at that location as shown.

***Please ensure User Instructions are left with vehicle owner after installation.***

## INSTALLATION OF CARGO BARRIER 'Behind 2nd row of seats'

- Place the Cargo Barrier in the vehicle directly behind the 2nd row seats position with the rating label (meshed side of barrier) facing towards rear of the vehicle.
- Attach the top straps to the upper mounts using 34mm Milbolts (11) with the wave washers (8) under heads.
- With the D anchors in their open position, attach the bottom straps to the bottom mounts using 14mm Milbolts (9) with the wave washers (8) under heads.
- Tighten all Milbolts including the ones securing bottom straps to cargo barrier.
- Replace the cargo blind if required.
- Put the 2nd row seats back to their upright position.

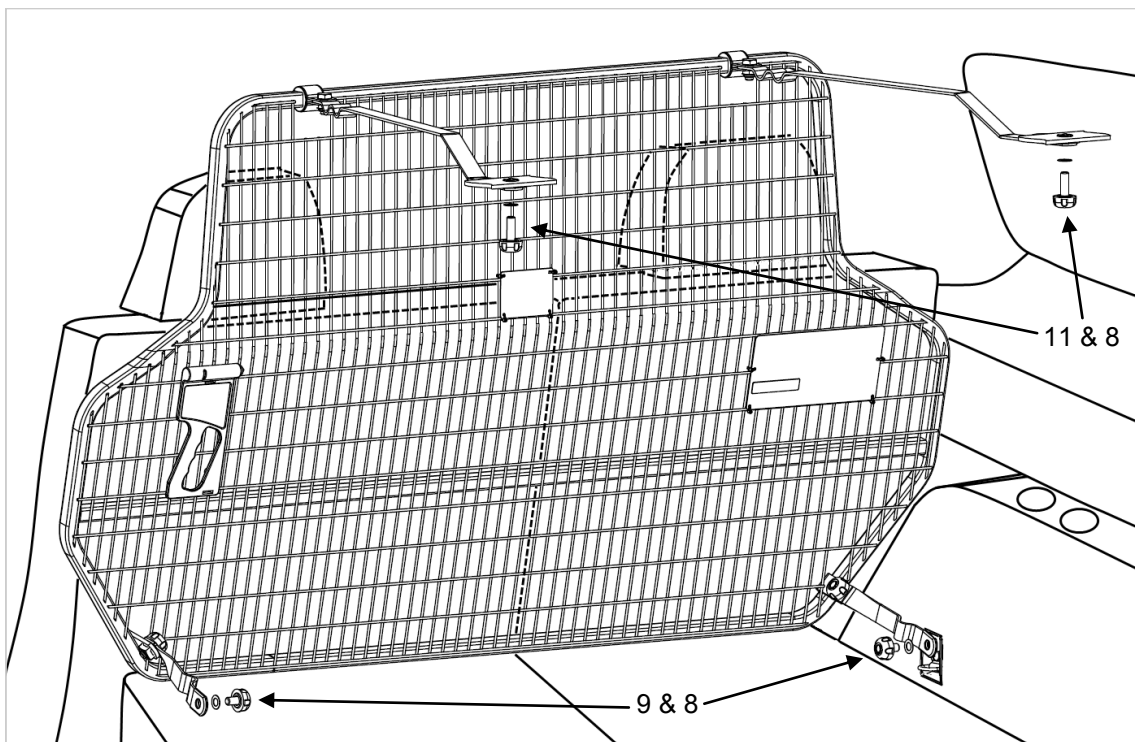

**IMPORTANT NOTE: Check that all bolts and screws are tight and re check periodically.**